

NO.44(1990)
MARCH 2, 1990

George Cross

Reliable A

WESTERN CANADA

CALPINE RESOURCES INC. (CLP-V)

STIKINE RESOURCES LTD. (SKZ-V)

MORE ESKAY CREEK ASSAYS - Murray Pezim, president, reports Calpine Resources and 50/50 partner Stikine Resources have received more gold and silver assays from in-fill and step-out diamond drill holes on the Eskay Creek project 40 km north of Stewart, B.C. SEE MAP OVERLEAF PAGE 1 & ASSAYS OVERLEAF PAGES 2 & 3. Most base metal results are pending. Infill drilling is confined to the 21B deposit within the bounds of the probable/possible reserves with step-out drilling beyond. (SEE GCNL No.34, 16Jan90 FOR MORE DATA)

104B 8

p. 1 of 4

CALPINE RESOURCES INCORPORATED

INFILL DRILL HOLE ASSAY RESULTS

HOLE #	SECTION (Metric)	INTERVAL (Feet)	LENGTH (Feet)	GOLD (oz/t)	SILVER (oz/t)	LEAD %	ZINC %	COPPER %
CA90-215	7+75N (-45°)	488.7-577.3	88.6	0.307	62.99			
		including 505.1-524.8	19.7	0.761	256.98			
		610.1-657.0	46.9	0.127	3.75			
CA90-216	7+75N (-60°)	341.1-354.2	13.1	0.294	62.18			
CA90-217	7+75N (-73°)	354.3-396.9	42.6	3.83	102.56			
CA90-218	7+75N (-86°)	377.2-442.8	65.6	0.096	8.13			
		including 377.2-390.3	13.1	0.229	1.36			
		410.0-426.4	16.4	0.093	23.87			
CA90-224	5+25N (-45°)	265.7-269.0	3.3	0.032	2.23	4.33	8.73	
CA90-225	5+25N (-83°)	265.7-321.5	55.8	1.85	116.42			
CA90-226	5+25N (-65°)	226.3-239.4	13.1	2.39	184.00			
		321.4-328.0	6.6	0.632	0.09			
CA90-227	8+00N (-45°)	373.9-383.7	9.8	0.263	93.63			
CA90-228	8+00N (-65°)	370.6-387.0	16.4	0.448	15.54			
CA90-229	8+00N (-88°)	357.5-364.1	6.6	0.242	0.23			
		406.7-426.4	19.7	0.176	1.20			
CA90-237	4+75N (-45°)	196.8-206.6	9.8	0.109	0.70			
		216.5-226.3	9.8	0.525	43.45			
CA90-238	4+75N (-65°)	216.5-223.1	6.6	0.729	32.33			
CA90-240	10+25N (-45°)	137.8-141.1	3.3	0.097	7.58			
CA90-242A*	10+25N (-89°)	200.1-209.9	9.8	0.210	16.91			
		262.4-265.7	3.3	0.218	8.82			
CA90-242B*	10+25N (-90°)	206.6-213.2	6.6	0.130	4.10			
		259.1-275.5	16.4	0.119	2.80			
		380.5-387.1	6.6	0.162	11.50			
		446.1-462.5	16.4	1.12	84.20			
CA90-243	8+25N (-50°)	226.3-246.0	19.7	0.060	6.14			
		354.2-370.6	16.4	0.194	36.41			
CA90-244	8+25N (-72°)	288.7-298.5	9.8	0.059	4.83			
		324.7-331.3	6.6	0.549	27.70			
		495.3-510.1	14.8	0.546	0.33			
CA90-245	8+25N (-90°)	305.1-314.9	9.8	0.067	14.82			
		373.9-390.3	16.4	2.16	111.67			
CA90-251	4+25N (-71°)	370.6-396.9	26.3	1.412	42.52			
CA90-252	4+25N (-82°)	396.9-485.5	88.6	0.600	17.26			
		including 403.4-419.8	16.4	2.38	74.06			
CA90-262	4+00N (-45°)	328.0-344.4	16.4	0.116	29.32			

104B 8
P. 2 of 4

CALPINE RESOURCES INCORPORATED

HOLE #	SECTION (Metric)	INTERVAL (Feet)	LENGTH (Feet)	GOLD (oz/t)	SILVER (oz/t)	LEAD ‡	ZINC ‡	COPPER ‡
CA90-263	4+00N (-59°)	341.1-364.1	23.0	0.525	23.12			
		449.3-455.9	6.6	0.420	0.15			
CA90-264	4+00N (-73°)	357.5-406.7	49.2	0.988	32.46			
CA90-265	4+00N (-84°)	393.6-442.8	49.2	0.867	25.50			
		400.2-416.6 including	16.4	2.22	66.38			
CA90-266	10+25N (-80°)	275.5-288.6	13.1	0.303	1.14			
CA90-267	10+25N (-60°)	144.3-164.0	19.7	0.296	32.90			
		337.8-341.1	3.3	0.139	41.50			
CA90-280	9+75N (-45°)	334.6-383.8	49.2	1.127	36.87			
		429.7-433.0	3.3	0.115	1.20			
		567.4-570.7	3.3	0.208	0.77			

* Hole CA90-242A was lost prior to reaching the Contact Zone mineralization of the 21B Deposit. Intervals reported for CA90-242A represent Hanging Wall Mineralized Zones. Hole CA90-242B, drilled from the same collar, as CA90-242A, intersected similar Hanging Wall Zones in addition to reaching the Contact Zone mineralization which returned the 16.4-foot interval of 1.12 ounces per ton gold and 84.2 ounces per ton silver as reported above.

STEP-OUT DRILL HOLE ASSAY RESULTS

HOLE #	SECTION (Metric)	INTERVAL (Feet)	LENGTH (Feet)	GOLD (oz/t)	SILVER (oz/t)	LEAD ‡	ZINC ‡	COPPER ‡
CA90-235	7+50N (-66°)	180.4-226.3	45.9	0.327	1.11			
CA90-247	7+50N (-88°)	236.1-242.7	6.6	0.184	4.48			
CA90-248	7+50N (-66°)	167.3-173.9	6.6	0.081	2.22			
		219.8-223.1	3.3	0.118	2.16			
CA90-253	7+75N (-69°)	442.8-462.5	19.7	2.58	220.41			
CA90-255	7+75N (-89°)	406.7-416.5	9.8	0.120	5.03			
CA90-257	8+25N (-78°)	426.4-429.7	3.3	0.160	0.07			
CA90-260	8+00N (-67°)	259.1-262.4	3.3	0.146	3.25			
CA90-261	7+50N (-55°)	508.4-515.0	6.6	0.112	0.12			
CA90-269	7+50N (-84°)	406.7-423.1	16.4	0.317	7.68			
CA90-270	7+50N (-78°)	455.9-462.5	6.6	0.328	3.98			
CA90-272	7+75N (-62°)	508.4-511.7	3.3	0.100	0.09			
		600.2-603.5	3.3	0.125	0.90			
CA90-279	8+25N (-80°)	419.8-459.2	39.4	0.168	5.78			

104B 8
p. 3 of 4

NO. 44(1990)
MARCH 2, 1990

George Cross
Reliable &

WESTERN CALIFORNIA

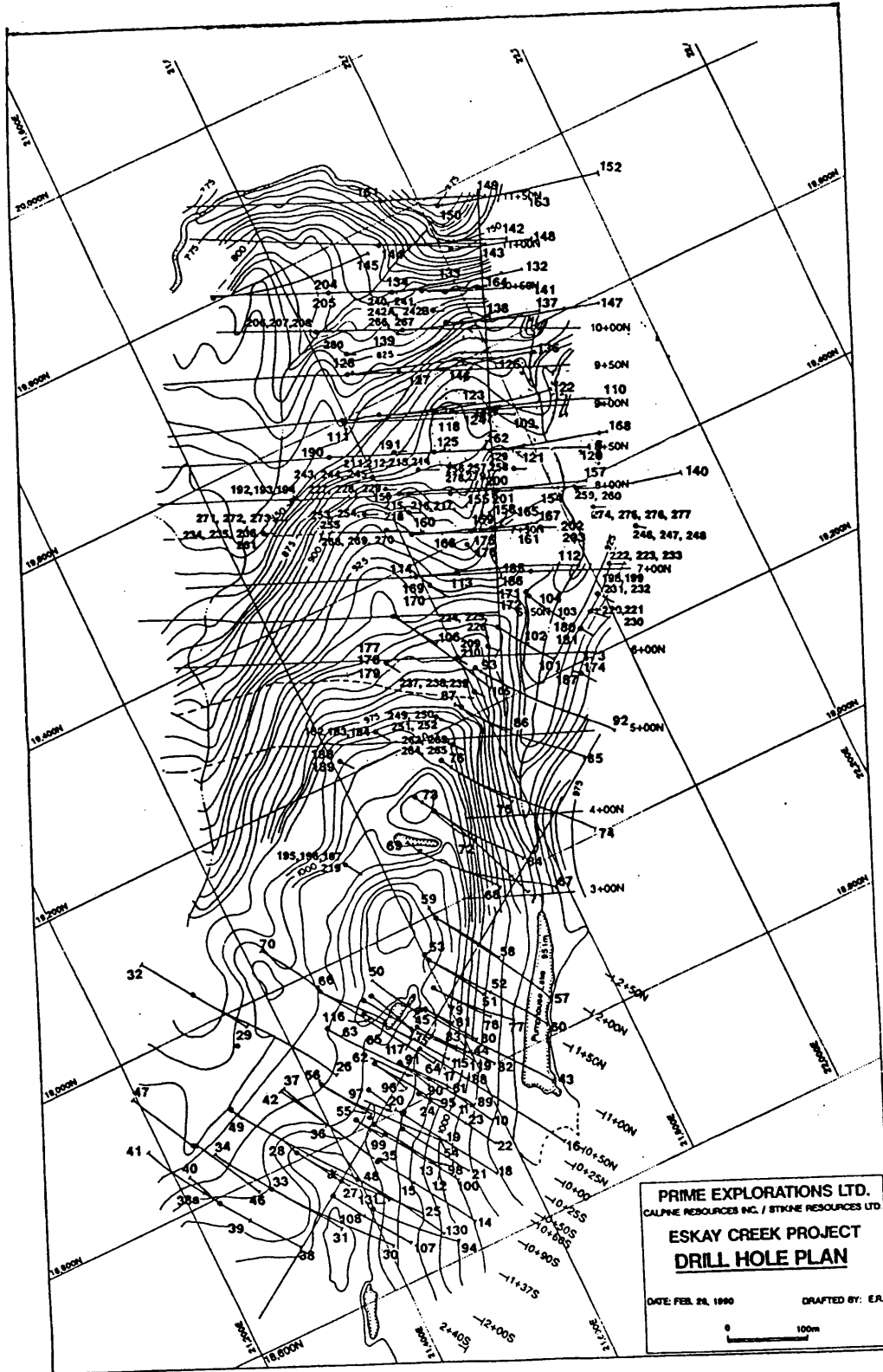

104B 8
p. 4 of 4