

George Cross News Letter

NO.174(1988)
SEPTEMBER 9, 1988

SYMES RESOURCES LTD. (SYI-V)

LILLOOET VALLEY GOLD SHOW - Corona Corp. has completed TO BE FURTHER TESTED collection and analysis of 115 check soil samples on the Easy and Jo claims of Symes Resources. These samples have confirmed the previously reported samples that assayed a high of 0.3 oz.gold/t. Symes Resources holds an option to earn a 50% interest in the Easy claims, 65 km southwest of Pemberton, B.C., by spending \$550,000 on exploration by July 31,1991. Recent soil samples from the property ranged as high as 9740 parts gold per billion, or 0.28 oz.gold/t. Hillside Energy Ltd. and Corona Corp. each retain a 25% interest in the property after Symes Resources has earned its 50% interest.

Under a recent second agreement, Corona Corp. agreed to pay the costs of a detailed geological, geochemical and prospecting program and to accept treasury shares of Symes in payment. Symes has reached an agreement to issue 145,000 treasury shares at 20¢ each for this work, subject to regulatory approvals. Corona has completed the collection of 120 soil samples and 9 rock samples with assays expected August 29,1988. Symes now plans to proceed with a detailed investigation of the 300 meter long anomalous zone.

YANKS PEAK RESOURCES LTD. (YPR-V)

PLACER TEST PLANNED- J.F. Andrusko, president of Yanks Peak Resources Ltd. reports that a 2,000 cubic yard per shift wash plant has been installed on its 100% owned Snowshoe placer properties in the Snowshoe/Keithley Creek area 70 km east of Quesnel, B.C. A production test is planned for mid-September, in an area that has been tested and ranges from 0.01 to 0.2 oz.gold per cubic yard. The production target is to maintain a 0.02 oz. gold per yard or better feed to the wash plant. The present indicated reserves are 500,000 cubic yards, with new areas being developed by logging, stripping and testing.

CORONA CORPORATION(ICR.A,ICR.B-V,T,M,AMEX)

HUNTINGTON RESOURCES INC.(HUN-V)

| HOLE | SECTION | DIP | INTERVAL FT. | WIDTH | OZ.GOLD/TON |
|--|---------|------|--------------|-------|-------------|
| RC88-17 | 8+20N | -90d | 55 - 80 | 25 ft | 0.224 |
| | | | includes | 10 | .470 |
| Comments: hanging wall 20 feet west of Main Shear | | | | | |
| | | | 380 - 410 | 30 | .335 |
| | | | includes | 20 | .467 |
| Comments: footwall andesite 65 feet east of Main Shear | | | | | |
| RC88-18 | 7+88N | -90 | 160 - 175 | 15 | .032 |
| | | | 220 - 225 | 5 | .165 |
| | | | 295 - 305 | 10 | .088 |
| Comments: hanging wall andesite footwall | | | | | |
| RC88-19 | 7+30N | -90 | 135 - 140 | 5 | .270 |
| | | | 190 - 220 | 30 | .055 |
| | | | includes | 5 | .110 |
| | | | 320 - 325 | 5 | .065 |
| RC88-21 | 9+52N | -86 | 50 - 55 | 5 | .124 |
| Comments: quartz veined hanging wall volcanics | | | | | |

ASSAYS FROM BRETT - Corona Corporation 51% and Huntington
CLAIMS REPORTED Resources Inc. 49% reported assays
from the recently completed reverse
circulation drilling program on the Brett claims, located 35 km west of Vernon, B.C. The results continue to show strong dissemination of the gold values in both hanging wall and footwall volcanics for some distance from the main shear zone. Assays for reverse circulation holes 20, 22, 23 and 24 are not available at this time. Diamond drilling on the New Discovery zone is expected to start later this month. (See GCNL No.160, 140, 129, 118, 113, 110 for previous assay results, and No.153, p.2, 10Aug88 for New Discovery zone).

PIONEER METALS CORPORATION(PSM-V,T)

Premier Gold project at Stewart, B.C., which is on schedule towards production start-up in April 1989.
(SEE GCNL NO.152, P.1, 9AUG88 FOR PREVIOUS ARTICLE).

VISCOUNT RESOURCES LTD. (VIS-V;VISRF-Nasdaq)

Production at Viscount's 50% owned O.B. Silver Mine at Greenwood, B.C. continues at 120 tons per day.

MIKADO RESOURCES LTD. (MKO-V)

GOLDEN ARCH RESOURCES LTD.

(formerly TURNER ENERGY & RESOURCES LTD.)

MASSIVE SULPHIDE ASSAYS AWAITED - Twelve diamond drill hole intersections

have now been completed and sent for assay in the new massive sulphide, zinc, lead, silver, discovery in the area of the Abbott zone on the Mt. Templeman property, located in the Kootenay Arc mineralized belt, 60 miles southeast of Revelstoke, B.C. The new zone is within the favourable Index formation approximately 30 feet from the limestone contact. Massive sulphides have been encountered in all holes over zone widths of 65, 30, 50, 84, 48, 71, 14, 14, 69, 40, 10, and 30 feet, along a 185 foot strike length at 35 foot intervals and to about 300 feet below surface. Assays from these intersections are expected to be published about Sept.13,1988. Drilling is continuing to test the zone along strike in both directions and to depth. (SEE GCNL NO.169, Sept.1, 1988 for assay results from drilling in the Abbott zone.)

Road access has been completed to the Bannockburn and Superior claims in the property. Surface sampling on a 5 foot wide by 100 foot long outcrop on the Superior claim produced:

| <u>SAMPLE</u> | <u>OZ. GOLD/T</u> | <u>OZ. SILVER/T</u> | <u>LEAD</u> | <u>ZINC</u> | <u>COPPER</u> |
|---------------|-------------------|---------------------|-------------|-------------|---------------|
| Chip | 0.589 | 9.04 | 22.0% | 0.33% | 0.19% |
| Float | .274 | 6.65 | 12.3 | 19.0 | .7 |

Bannockburn trench and shaft stockpile grab samples:

| | | | | | |
|-----------|------|------|------|------|------|
| Trench | .023 | 2.89 | 4.35 | 45.3 | 1.28 |
| Stockpile | .041 | 45.2 | 67.2 | .22 | - - |

The Bannockburn showing is 1,500 feet along strike to the north from the Superior.

Interests in the property are 70% Mikado and 30% Turner Energy & Resources which has been consolidated on the basis of three old shares for one new share so that there are now 1,400,000 shares issued, prior to a private placement of 500,000 shares at 50¢ that has been negotiated and awaits regulatory approval. The name change to Golden Arch Resources Ltd. also awaits approval along with the removal of a trading suspension.

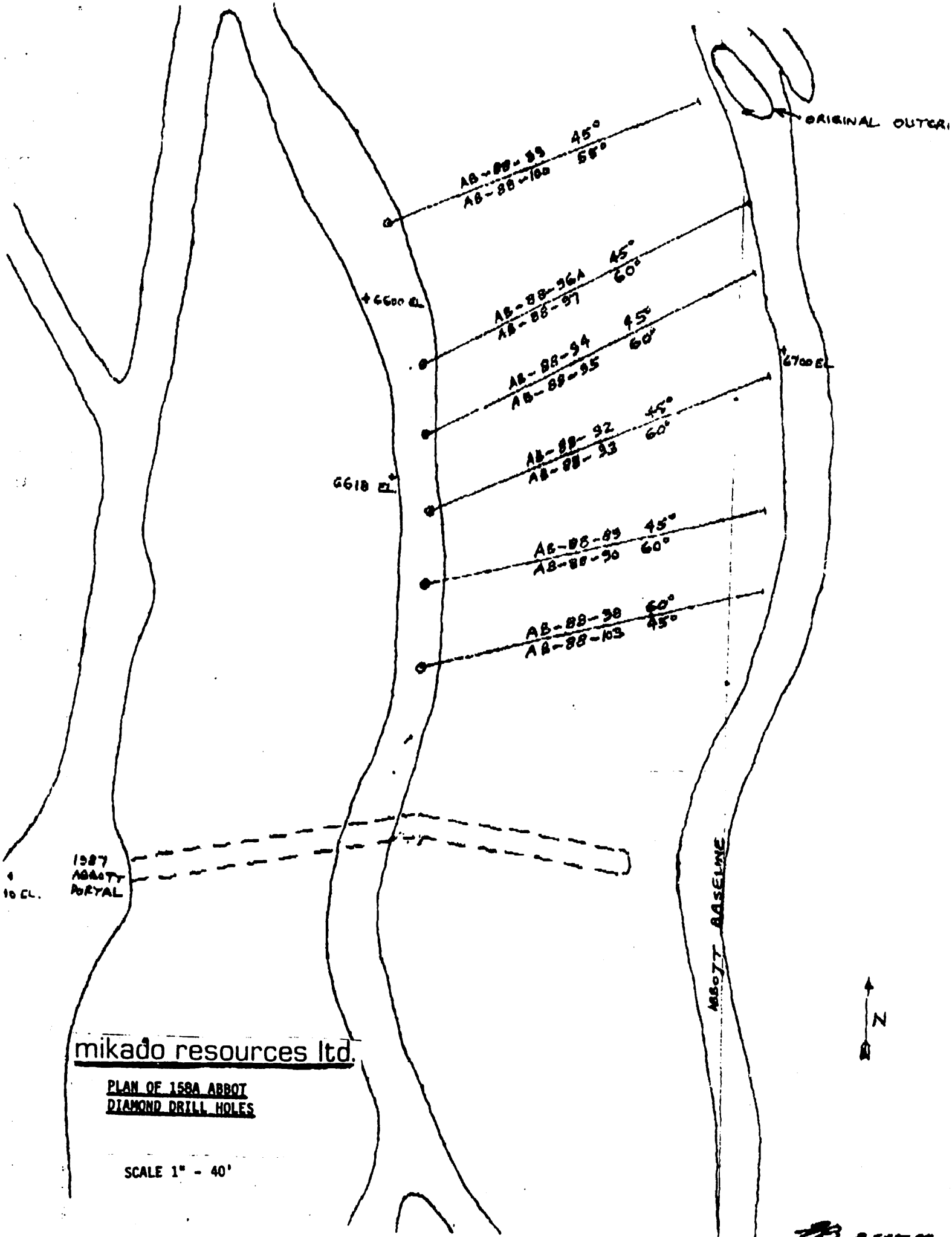

mikado resources ltd.

**PLAN OF 158A ABBOT
DIAMOND DRILL HOLES**

SCALE 1" = 40'

22 0 SEPT 88