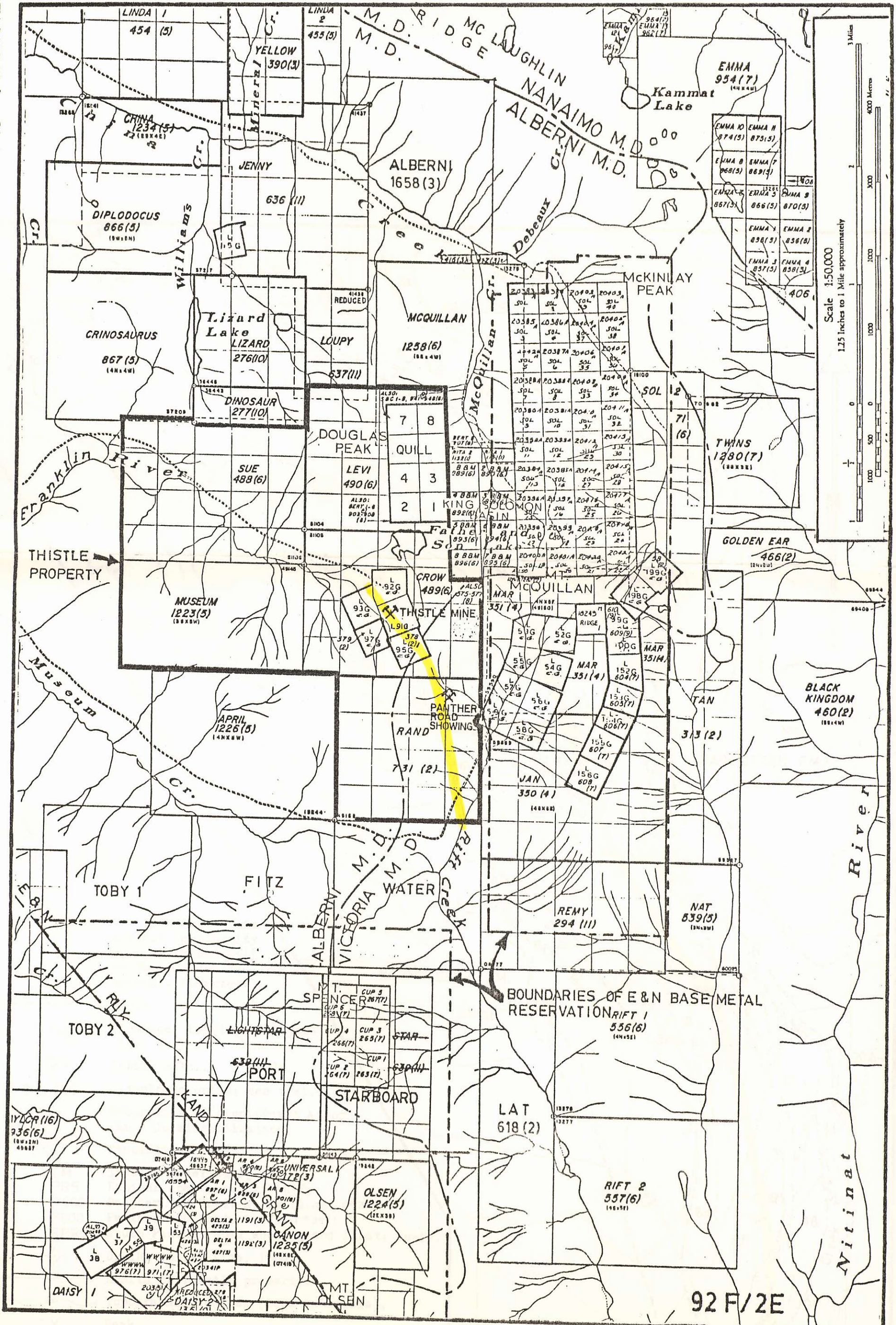

FIGURE 4: Claims map



827244  
Thistle  
92F/2

92 F/2E

FIGURE 5: Summary, schematic geologic map of the Thistle property showing the main lithologic units described in Appendix B (see following pages).

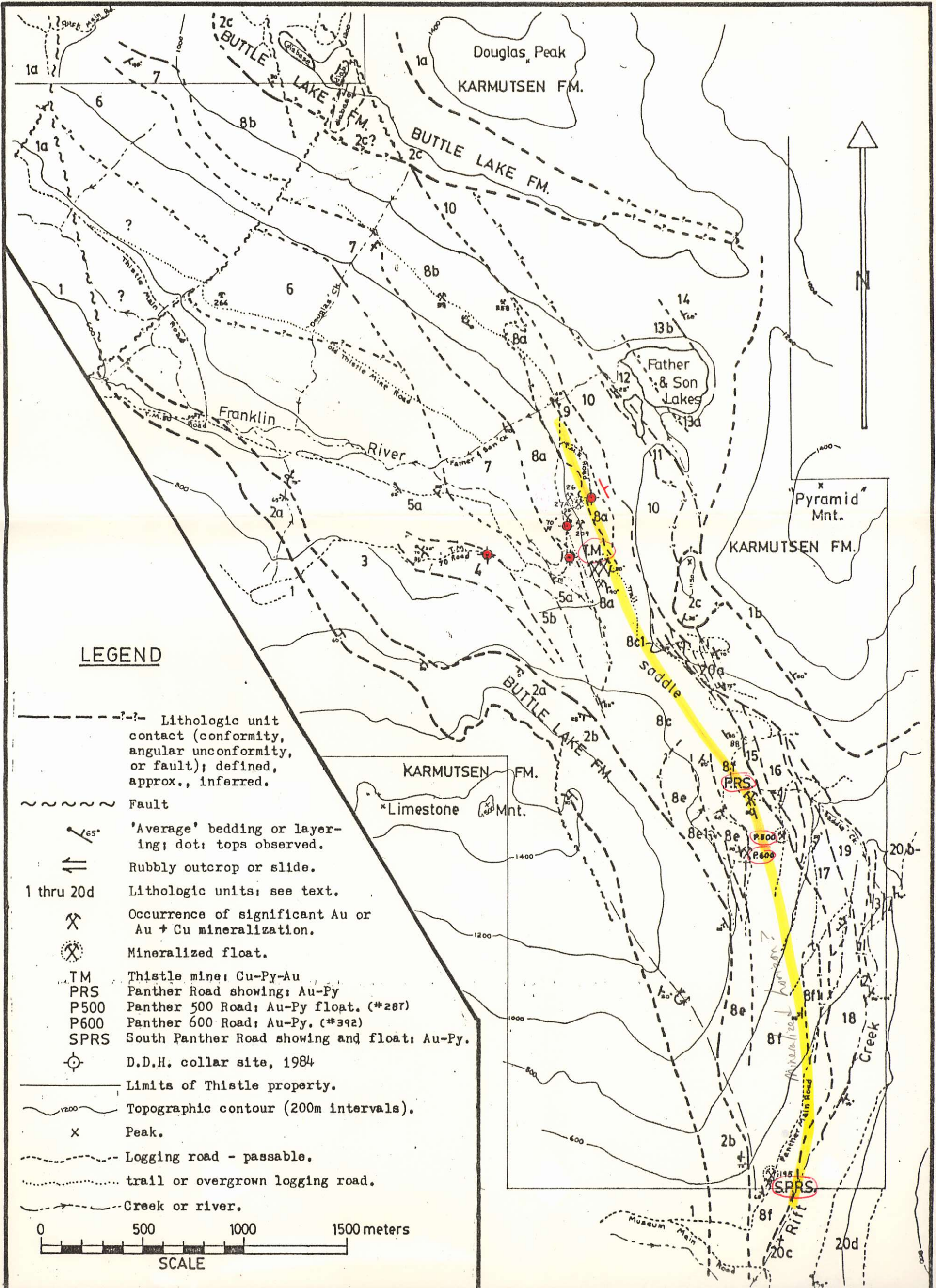

**LEGEND**

- Lithologic unit contact (conformity, angular unconformity, or fault); defined, approx., inferred.
- ~~~~~ Fault
- ↘<sup>65°</sup> 'Average' bedding or layering; dot; tops observed.
- ⇄ Rubbly outcrop or slide.
- 1 thru 20d Lithologic units; see text.
- ⊗ Occurrence of significant Au or Au + Cu mineralization.
- ⊗ Mineralized float.
- TM Thistle mine; Cu-Py-Au
- PRS Panther Road showing; Au-Py
- P500 Panther 500 Road; Au-Py float. (#287)
- P600 Panther 600 Road; Au-Py. (#392)
- SPRS South Panther Road showing and float; Au-Py.
- ⊙ D.D.H. collar site, 1984
- Limits of Thistle property.
- ~~~~~ Topographic contour (200m intervals).
- X Peak.
- - - Logging road - passable.
- ⋯ trail or overgrown logging road.
- ~ Creek or river.

