

824488

MINNOVA INC.
Samatosum Exploration

Minnova Inc.
P.O. Box 255
Barriere, B.C.
VOE1E0

Telephone: (604) 672-0122
FAX 672-9211

TO: MINNOVA
VANCOUVER

DATE: August 14/90

ATT'N: I. PIRIE

MESSAGE:

Here's a "quick and dirty" sketch of proposed drilling on the CANA. We will have a better idea of the geology after the "fence" is completed on our side of the line. Also, we should get a complete set of the available data (including sections!) on CANA, before a final drillplan is prepared.

NUMBER OF PAGES FORWARDED INCLUDING THIS ONE: 2

FROM: AL HILL

IF YOU DO NOT RECEIVE ALL THE PAGES, PLEASE CALL THE FOLLOWING NUMBER AS SOON AS POSSIBLE: (604) 672-0122.

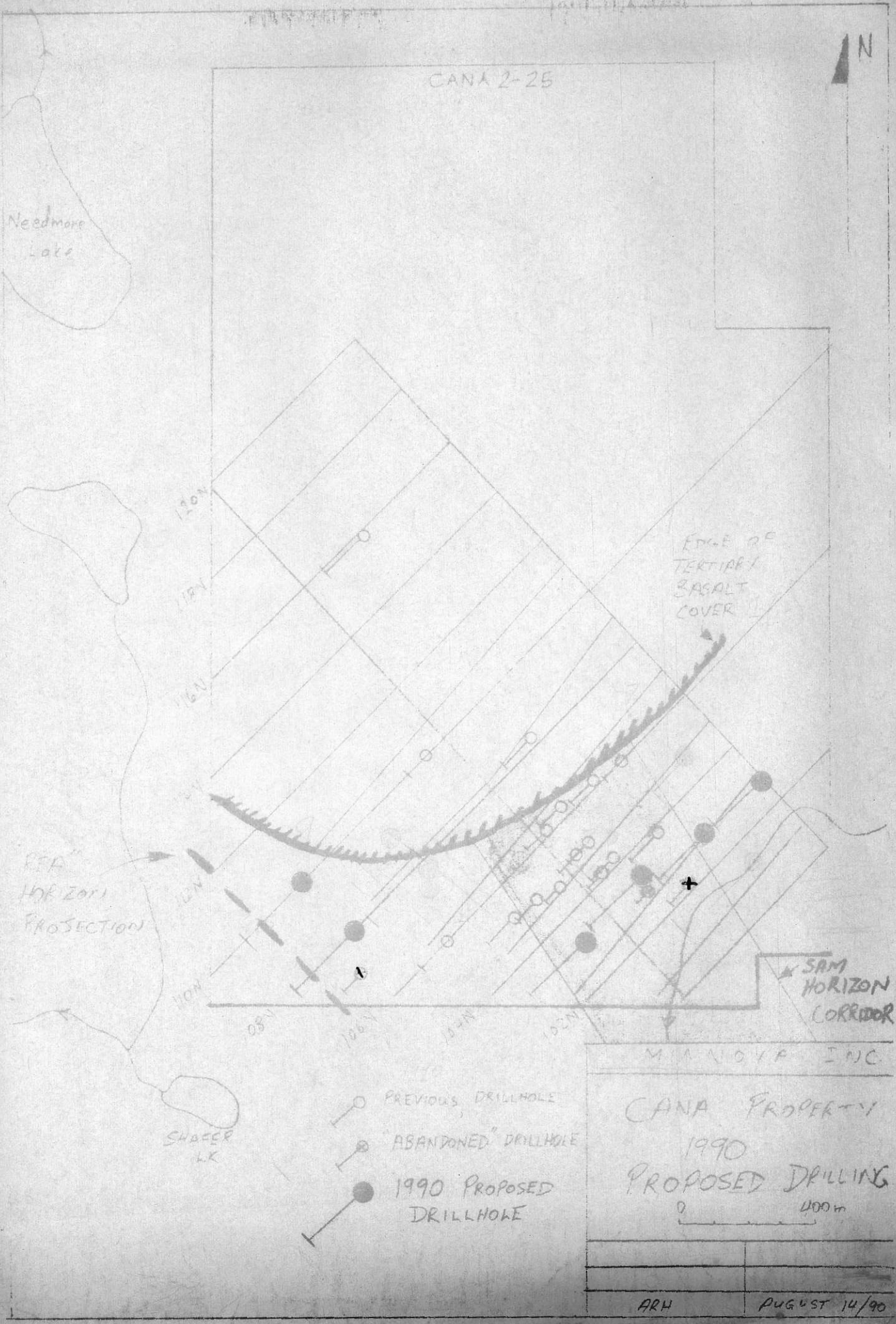

MANOYA INC.
 CANA PROPERTY
 1990
 PROPOSED DRILLING
 0 400m

ARH AUGUST 14/90