

Blackdome 1

25/10/84 330 PM  
Engineers Club

Bert Reeves

1957 Haileybury  
61 MIT  
69-84 → Barrier Reef  
N of Big Bar  
S of Gang Rang.  
Halfway between  
Relay Mn + Gang Rang.  
140 Air mile N. of BC  
90 mile from Clinton via gang  
Discovered 1947  
1977 - Barrier reef  
\$7 x 10<sup>6</sup>  
45 000 ft DSH  
8000 ft Drift + Raiso  
7300 ft Top of Mn.  
6500 ft Trochlo  
Camp Main Portal 1960 level  
6500 ft p 5 Au Sample  
Tert. + Cretaceous  
age

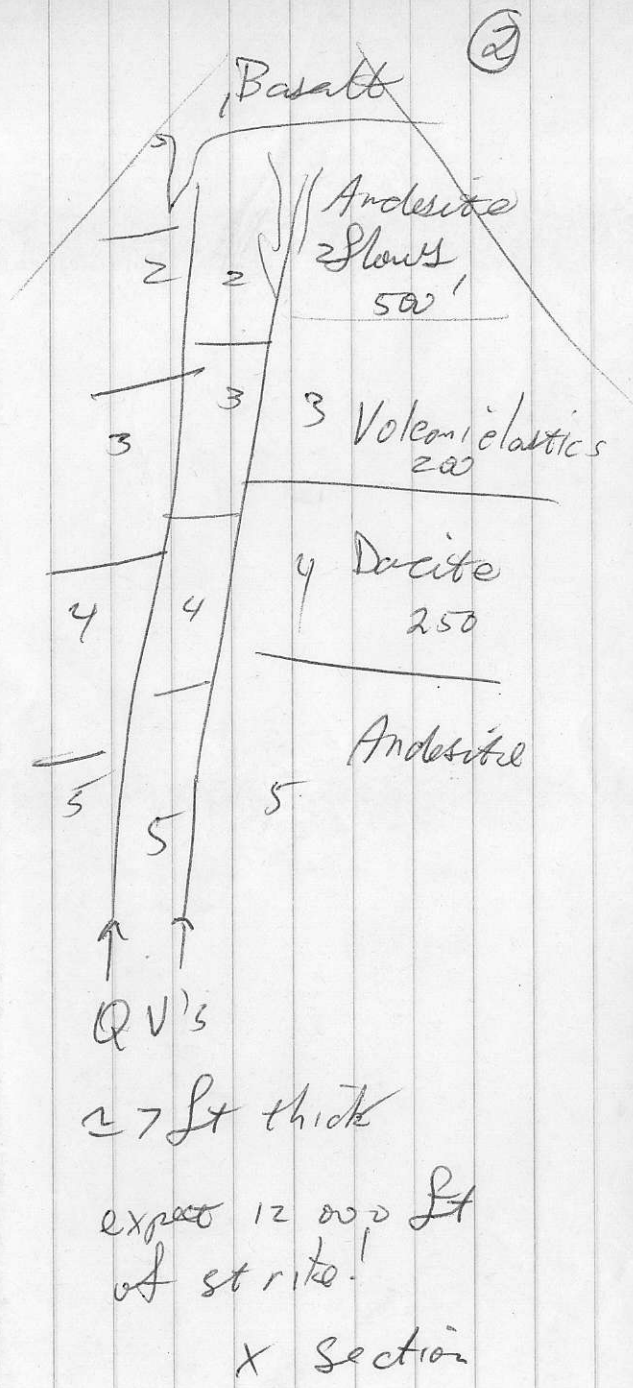

(3)

0920/7E Blackdome  
820727

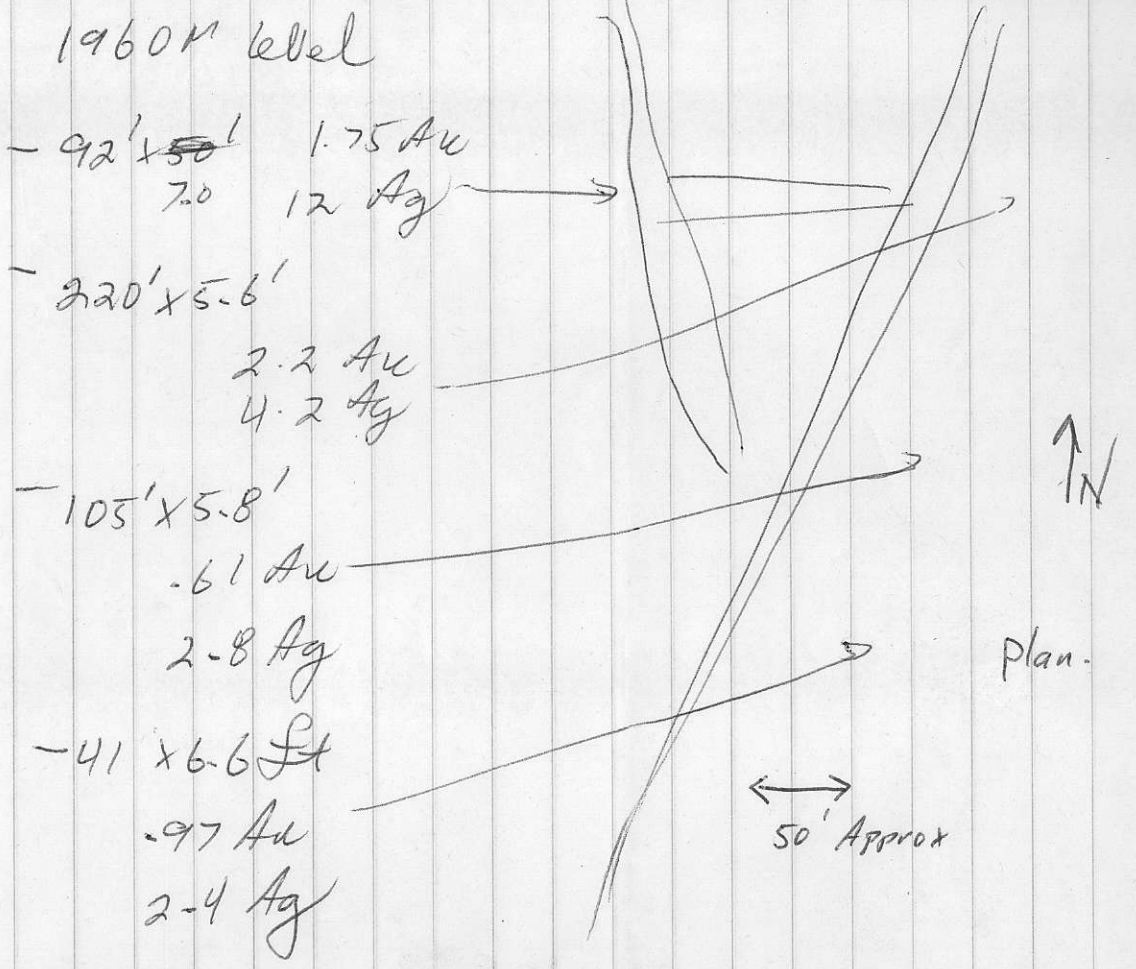

(4)

Au = Ag  
1 : 5 Ag.

Minor tetrahedrite

Conclusion

Vertical zonation  
of mineralized  
fault structures

Reserves - week ago.  
Cut off (20/10/87)

Au 0g .25  
166,000 T  
- 85 Au  
5.23 Ag  
= Au 0g .97

(5)

Questions

Good indicator Au

- 20-1 to 1:1 Au - Ag
- No other sulphide
- Pyrite in veins ~~and~~ and in wall rock
- ↗ Not mappable.

Wall rock

- argillic alteration  
25 ft int walls away from veins.
- silic alteration

Soil GC

2000-3000 ppb  
100 ppb significant

(6)

220' Horiz  
250' Surf (Vertical)

BQ Core.

NQ last year  
Better recovery