

22  
38  
60

$N.W. = 12,500 \text{ D}'$   
0.753% Ni; 0.61% Cu  
0.84% Ni; 0.63% Cu

~~Lower Ni. = 6000 D'~~  
0.413 Ni; 0.57% Cu

8300E

30' x 200'

12500 N.

S SIDE

8250E

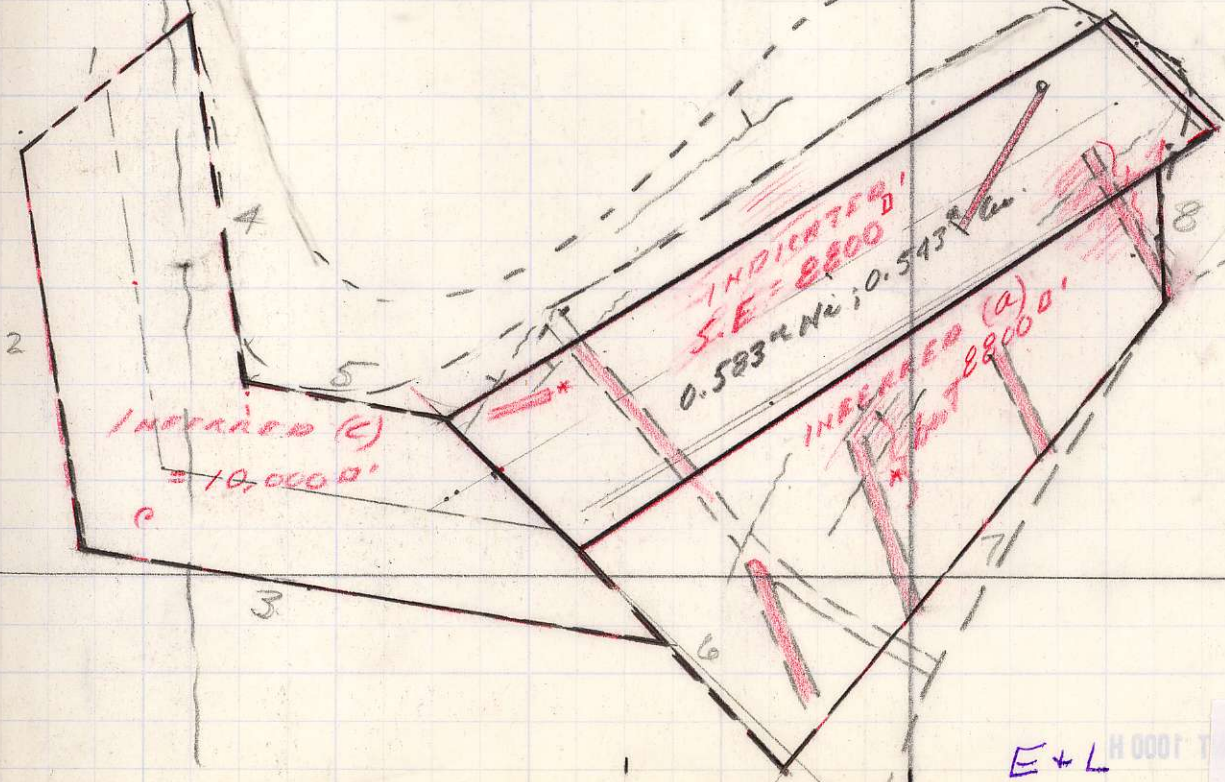

12500 N.

E+L

800981