

RUTHERFORD DAY  
ATTORNEY AT LAW

1203 ROSS DRIVE, S.W. VIENNA, VIRGINIA 22180  
703/938-2853 - 301/652-7748

*See'y here  
Mrs. Betty Placard*

800749

November 9, 1972

Correspondence  
B/W  
~~Re~~ W. M. Sharp  
& R. Day  
Re: Atlin Area  
Properties

William M. Sharp  
Geological Engineer  
171 W. Esplanade N  
Vancouver  
BRITISH COLUMBIA  
CANADA

*air photos may assist re eval of  
following prospects.*

Dear Bill:

✓ Sorry I missed you while I was in Vancouver last week. I gave Jerry Jerome copies of two prospects near Quesnel which I believe I mentioned to you on the telephone not so long ago. I would appreciate it if you could make arrangements with him for a duplicate of those. ✓

Enclosed herewith please find a copy of some material on the Lucky Mineral claims 1 through 20 which I am currently interested in. These have been staked by T. O. Connolly from whom I have obtained a lease grant on the placer claims on Wright Creek at Surprise Lake near Atlin. As you can see the Lucky claims involve two Crown grants, Nos. 5644 and 5643. These appear on the Atlin B.C. Topographic Map No. 104 N/12 East Half (Scale 1:50,000). Wright Creek appears on No. 104 N/11 West Half (Scale 1:50,000). The whole area is on Topo No. 104N of Atlin (Scale 1:250,000). I have both the placer claim map and mineral claim map for 1054 N/11W and 104 N/12E and will be referring to these in subsequent correspondence. On the mineral claim map 11W there are a large group of forfeited claims between Wright Creek and Otter Creek.

*Lucky 1-20  
104 N/12 E  
Placer  
104 N/12 E (M)*

Mr. Connolly also has claims along Otter Creek and has suggested my staking possibly both placer and mineral claims between the two creeks. This will be one of the questions I would like you to help me answer after you have had a chance to visit the property and make an evaluation. The placer claims appearing on placer map 11W are the 7 claims Nos. 1605, 1684, 1685, 1698, 1686, 1701 and 1700. The last claim upstream, No. 1679, has not been acquired by me at present, being in different ownership from the others. This will be the second question to be determined, i.e., whether to pick up this extra claim, or possibly to stake claims upstream from it, in turn. The

*is placer  
staking allowed  
at present.*

*Wright Cr*

*Adv. R. Day  
a bigger  
creek than  
Wright Cr*

William M. Sharp  
Page 2  
November 9, 1972

third item of primary importance to me is whether to go forward with the Lucky 1-20 claims, which are mineral claims. I have been offered a very favorable lease assignment on these which would only involve my making the lease payments and doing the assessment work, although an end price would be payable from royalties out of any production which might develop. Fourth: I have had preliminary discussions with Mr. Archie D. McCutcheon, President, Canadian Mine Services, Ltd., Vancouver, regarding hiring that company to do the earth removal work and contract mining on Wright Creek and the possibility of such on the Lucky claims after evaluation and testing. I have given him a copy of Geological Survey Memoir 307 of Atlin Map Area 104N by J. D. Aitken (1959), together with the placer and topo maps of the area. Since CMS (Canadian Mine Services) did some work for Kerr-Addison Company on Ruby Creek on the north side of Surprise Lake, they are obviously serious candidates to assist us in the Atlin area.

I have formed a B.C. corporation known as Surprise\* Resources Ltd. (N.P.L.). The directors of this company are: myself, Dudley L. Davis, Geologist, George Stevens, Esq., Vancouver attorney, and Dr. Stanley E. Jerome. This is a private company at present and may or may not be taken public at a future date. However, this will be the entity to which you will address your reports on the Atlin and Quesnel properties. I would suggest you acquire the various maps ~~in~~ the memoir referred to so that you can start preparing a file on the Atlin area and I would hope that you can obtain any memoirs or any other background material on the Quesnel area which you may find useful. I would appreciate it if you can send me three copies of any maps, memoirs, etc., on Quesnel which are available from Geological Survey or the Gold Commissioner's office.

With best personal regards and hopes to see you on my next visit to Vancouver, I am

Sincerely,

Rutherford Day

Rutherford Day  
EMP

RD/emp  
Encl.

cc: Dr. Stanley E. Jerome

Lucky  
Op!

could  
sent  
xerox of  
G.S.C.  
Summary  
R.D.

WILLIAM M. SHARP, P.ENG.  
CONSULTING GEOLOGICAL ENGINEER

171 WEST ESPLANADE  
NORTH VANCOUVER, B.C.

FEBRUARY 14, 1973

MR. RUTHERFORD DAY,  
ATTORNEY AT LAW,  
1203 ROSS DRIVE S.W.,  
VIENNA, VIRGINIA 22180

DEAR RUDDY:

RE SEPERATE PACKAGE OF MAPS MAILED.

AS IT'S ONLY ABOUT 3 MONTHS TO BREAK-UP TIME  
IN NORTHERN B.C. THIS LOOKS LIKE A GOOD TIME TO  
SEND ALONG THE VARIOUS MAPS REQUESTED IN YOUR LETTER  
OF NOVEMBER 9<sup>TH</sup> LAST. THESE COMPRISE THE REQUESTED  
THREE PRINTS OF EACH OF:

MAP 93A/12E (M) PLACER - COVERING QUESNEL FORKS AREA.  
MAP 93A/12W (M) PLACER - " " RIVER "  
MAP 93A, "QUESNEL LAKE", TOPOG. @ 1" = 4 MI.  
MAP 3-1961, "GEOLOGY, QUESNEL LAKE, W-HALF" @ 1" = 4 MI.  
MAP 1-1963, "GEOLOGY, " " , E- " " @ 1" = 4 MI.

OTHER REPORTS AND MAPS, WHICH MIGHT BE OF INTEREST,  
ARE OUT OF PRINT.

I NOW HAVE THE SUGGESTED MAPS PERTAINING TO YOUR  
ATLIN, B.C. PROSPECTS. HOWEVER GOVERNMENT REPORTS  
ON THE AREA ARE, FOR THE MOST PART, OUT OF PRINT -  
EXCLUDING G.S.C. MEMOIR 307 (HAVE THIS).

JERRY NOTES THAT SURPRISE RESOURCES IS READY TO  
HIT FOR THE HILLS AS SOON AS THE WEATHER PERMITS!

WITH BEST REGARDS,

YOURS SINCERELY

Bill

W. M. Sharp.

RUTHERFORD DAY  
1118 SOUTHWEST 8TH TERRACE  
FORT LAUDERDALE, FLORIDA 33315

305 / 527-0368

March 6, 1973

William M. Sharp, P.Eng.  
171 West Esplanade  
North Vancouver, B.C.

Dear Bill:

This is to acknowledge, with thanks, your letter of Feb 14 and the maps and material on the Quesnel area you sent.

As you can probably see from the literature I sent you on the two Quesnel properties, the deal being offered in 1966 by Mr. Abrams was nothing to get very excited about. However, the area is of interest since it was formerly a placer area, and the other claims might have some promise. Before the new moratorium on placer claim staking, I had sort of intended to stake a few claims up there in the area, but now that option is out.

The Atlin area is, of course, serious business and I would like to get you up there as soon as possible after your review of the information I am now in the process of getting from a company which did a study of the properties on Wright and Otter Creek. Otter Creek has also been tentatively offered me by its owner to be developed in connection with Wright Creek-the same manwh sold me the Wright Creek option. He also, as I told you, is manager of a small corporation which has the Union Mountain Mine claims, so these three properties, plus one or two others in the area, ought to be enough for us. I am, however, probably going to acquire one further property in a different section of the Province with the information on Wright Creek. When I get data on this, I'll let you know, so you can keep informed on all activities for my corporation, Surprise ! Resources, Ltd., which has been organized in B.C.

If you want to get in touch with me, I'll be at this address until about mid-April.

With best personal regards, I am,

Sincerely,

Rutherford Day

Bill -  
It's remarkable how are  
many people there Canada  
is this area from Toronto  
mainly Quebec and I see a lot of  
RD:rd maple leaf R.

**RUTHERFORD DAY**  
1118 SOUTHWEST 8TH TERRACE  
FORT LAUDERDALE, FLORIDA 33315

305 / 527-0368

April 3, 1973

Mr. Bill Sharp  
171 West Esplanade  
North Vancouver, B.C.  
CANADA

Dear Bill,

I have asked Tom Connolly up at Atlin to call you when the weather breaks so you can have as much time as possible to work out your schedule to get up there. I still have not gotten the earlier test results which I have been attempting to get all winter. However, I still have high hopes that this will become available in time for your trip to Atlin. However, if I do not get it, I would want you to go to Atlin anyway.

I must apologize that you have not yet received your C \$120.28 which I have authorized George Stevens to spend out of the bank account of Surprise! Resources, Ltd. George has the check book there at Lawrence and Shaw but has been out of town on vacation the past two or three weeks. I have sent him a copy of your bill and expense receipts for prompt action.

Sincerely,

*Ruddy*  
Rutherford Day  
RD/jh

*Hope to see you  
before very much longer.*

WILLIAM M. SHARP, M.A.Sc., P.Eng.  
CONSULTING GEOLOGICAL ENGINEER  
171 W. ESPLANADE, NORTH VANCOUVER, B.C.

APRIL 9, 1973

MR. RUTHERFORD DAY,  
1118 SOUTHWEST 8TH TERRACE,  
FORT LAUDERDALE, FLORIDA 33315,  
U.S.A.

DEAR RUDDY:

I RECEIVED YOUR APRIL 3 AND APRIL 7, 1973 LETTERS IN  
TODAYS MAIL.

I AM REASONABLY CERTAIN THAT I WILL HAVE SOME TIME  
AVAILABLE FOR DISCUSSIONS WITH YOU AND JERRY ON APRIL 15  
AND/OR 16, NEXT - WHICH WOULD BE NEXT SUNDAY AND MONDAY.

BEFORE MAKING THE SCHEDULED FIELD TRIP TO ATLANTA, IT  
WOULD BE BEST TO HAVE AS MUCH SPECIFIC INFORMATION AS  
MIGHT BE OBTAINABLE ON THE DEPOSITS. TO THIS END, AND  
WHILE YOU ARE IN ASPEN, COLO., WOULD YOU TRY TO OBTAIN  
INFORMATION ON THE FOLLOWING:

1. STRATIGRAPHY (A CROSS-SECTIONAL DEPICTION OF THE  
DEPOSIT WITH INFERRED PLAN OF SAME) OF THE DEPOSIT(S).
2. MINERALOGY OF THE MINERABLE (GOLD-BEARING) HORIZON(S)  
OF THE DEPOSIT - PARTICULARLY RE. POSSIBLE ASSOCIATED MAGNETITE <sup>or wolframite or pyrite in deposits.</sup> ("BLACK SAND")
3. RANGE OF (VERT.) DEPTHS TO PAY-LAYER(S).
4. PREVIOUS EXPLORATION (LOCAL OR BULK TESTING?) - INCL. METHODS,  
RESULTS AND EVALUATIONS OF METHODS AND RESULTS.
5. LOCAL ACCESSIBILITY RE. EXPLORATION AND TESTING.

IT IS POSSIBLE THAT HIGH-WATER CONDITIONS AT AN  
EARLY STAGE OF THE SPRING RUN-OFF MIGHT HAVE SOME  
EFFECT ON THE TIMING OF A FIELD EXAMINATION; HOWEVER, I  
WOULD GUESS THAT TOM CONNELLY WILL HAVE THIS IN MIND  
WHEN HE CALLS - AS INDICATED IN YOUR APRIL 3RD LETTER.

I WILL BE LOOKING FORWARD TO SEEING YOU AGAIN -  
SUN-TAX AND ALL.

YOURS SINCERELY,

Bill

(W.M. SHARP, P.ENG.)

**RUTHERFORD DAY**  
1118 SOUTHWEST 8TH TERRACE  
FORT LAUDERDALE, FLORIDA 33315

305 / 527-0368

April 7, 1973

Mr. William Sharp  
171 West Esplanade, North  
Vancouver, B.C.  
CANADA

Dear Bill:

I am planning to come to Vancouver on Saturday, April 14 and plan to see Jerry the next day, Sunday the 15th regarding the Atlin, BC placer property. I am coming VIA Aspen, Colorado where the mining company is, which has the information and background on the property. We have made a deal in principle for this information and I hope to have it available for you when I am in Vancouver the 15th and 16th. I would appreciate it if you would be available sometime on those two days so that I may see you and go over the material with you. With best personal regards I am,

Sincerely,



Rutherford Day  
RD/jh

WILLIAM M. SHARP, M.A.Sc., P.Eng.  
CONSULTING GEOLOGICAL ENGINEER  
171 W. ESPLANADE, NORTH VANCOUVER, B.C.

JULY 14, 1973

MR. ROTHERFORD DAY,  
ATTORNEY AT LAW,  
1203 ROSS DRIVE, S.W.,  
VIENNA, VIRGINIA 22180.

DEAR RUDDY:

WITH THIS MY REPORT, FINALLY, ON THE ATLIN PROSPECTS, MY APOLOGIES FOR NOT GETTING IT OUT SOONER. HOWEVER, ITS PREPARATION DEMANDED QUITE A LOT OF SUPPLEMENTARY 'RESEARCHING' AND CHECKING OF THE AVAILABLE, RATHER GENERAL INFORMATION ON THE PLACER PROPERTIES - MUCH MORE THAN I HAD ORIGINALLY ANTICIPATED.

IN REFERENCE TO THE PLACER PROSPECTS, THE SPARSITY OF DETAILED INFORMATION ON PAST OPERATIONS SHOWS UP IN CURRENT ATTEMPTS TO ESTIMATE POTENTIAL VOLUMES AND GRADES OF PAY-GRAVEL. CONSEQUENTLY, MY PRESENT RECOMMENDATIONS ARE PRIMARILY DIRECTED TOWARDS THE DELINEATION AND TESTING OF THE INDICATED BEDROCK CHANNELS / PAY-GRAVELS.

ON MY LAST VISIT I FOUND IT NECESSARY TO SPEND A CONSIDERABLE AMOUNT OF TIME ON CHECKING OUT ACTUAL CLAIM COVERAGES. AS A RESULT, I CAN POSITIVELY STATE THAT THIS WILL STILL BE NECESSARY DURING THE RECOMMENDED FOLLOW-UP SURVEYS. HOWEVER, I AM SURE THAT TOM, SHIRLEY, AND DON ARE NOW QUITE AWARE OF THIS PROBLEM, AND NOW HAVE A BETTER UNDERSTANDING OF HOW THESE CHECKING PROCEDURES SHOULD BE CARRIED OUT.

YOURS SINCERELY,

Bill.

ENCL.

WILLIAM M. SHARP, M.A.Sc., P.Eng.  
CONSULTING GEOLOGICAL ENGINEER  
171 W. ESPLANADE, NORTH VANCOUVER, B.C.

MR. RUTHERFORD DAY,  
1118 S.W. 8<sup>TH</sup> TERRACE,  
FT. LAUDERDALE, FLORIDA 33315

AUGUST 7, 1973

DEAR RUDDY:

THANK YOU FOR YOUR JULY 25<sup>TH</sup> PARCEL OF DRAWINGS AND COVERING LETTER RECEIVED ON MY RETURN FROM OUR SATURDAY MEETING. ALL OF THIS WILL BE MOST HELPFUL, BUT IS NOT SUCH AS TO REQUIRE A ~~SA~~ SIGNIFICANTLY DIFFERENT APPROACH TO THE ONE I SUGGESTED IN THE RECENT REPORT. WHAT THE DATA WILL DO IS PROVIDE MORE ACCURATE DIRECTION OF OUR EXPLORATORY SURVEYS-- AFTER AT LEAST SOME OF THE 'LANDMARKS' SHOWN ON THE A.F. DAILY PLAN & LONG PROFILE ARE LOCATED IN THE FIELD. THE DRILLING LOGS WILL FACILITATE VALUE-ESTIMATES AT A MUCH EARLIER STAGE THAN WOULD BE POSSIBLE WITHOUT THEM!

THE B.C. DEPT OF MINES INFORMED ME THAT GEOLOGICAL, GEOPHYSICAL, AND PHYSICAL EXPLORATORY WORK WILL BE ACCEPTED AS ASSESSMENT CREDITS - JUST AS THEY DO ON HARDROCK EXPLORATION & DEVELOPMENT.

I <sup>have learned</sup> DISCOVERED THAT THE GEOPHYSICIST THAT I EMPLOY FREQUENTLY WILL BE IN ATLIN WHILE YOU ARE THERE. CONSEQUENTLY I SUGGESTED TO PHIL NIELSEN THAT HE INTRODUCE HIMSELF TO YOU AND, POSSIBLY, GET SOME IDEAS ON THE LOCAL GEOLOGY AND TERRAIN. WITH THIS HE WILL BE BETTER ABLE TO FURNISH THE NECESSARY FIGURES FOR AN ESTIMATE OF TIME / COST FACTORS IN A PRELIMINARY SEISMIC AND/OR RESISTIVITY SURVEY OF WRIGHT AND/OR OTTER CREEKS.

THE BREAKFAST WAS MOST WELCOME AND ENJOYABLE. ALSO, I HOPE THAT YOU AND MAX DAY ENJOYED YOUR ATLIN VISIT.

WITH BEST REGARDS TO BOTH OF YOU.

Bill

*Rutherford Day*  
Director of Companies

1118 S.W. 8th Terrace  
N. Lauderdale, Florida 33315  
(305) 527-0968

1730 M Street, N.W. Suite 606  
Washington, D. C. 20036  
(202) 293-3350

July 25, 1973

Mr. William M. Sharp, P. Eng.  
171 West Esplanade  
North Vancouver, British Columbia  
CANADA

Dear Bill:

Per my telephone conversation with you of the 23rd, enclosed please find the following material on Otter Creek:

- \* 1. Plan and Profile, A.F. Daly, 1947.
- 2. Plan showing contours around lower pit, Gold Field Placers, Ltd., 1939 (reduced from original scale). *had this in mail white*
- " 3. Detail from above at original scale.
- 4. Composite plan of old drift, showing values per cubic yard, 1" = 50' (reduced) showing results during 1937 through 1939.
- 5. Field Logs, lines 1-5, dated 1939, 1940, "October 26".
- 6. Digest of History, (18 pages) 1899 - 1924. — *already have this*

Dudley Davis has the originals of all these up at the site where he is now working. I am sending him a copy of your report and expect he will call you when he passes through Vancouver again. When you have had a chance to review this information it might be well to drop me a note supplementing your report dated July 13 on the June, 1973 reconnaissance.

With best personal regards and thanks for your help and sympathy I am,

Sincerely,

*Ruthly*  
Rutherford Day  
RD/jh

Enc.

*note this is impression of mine as to ability of his own plane.*  
P.S. I'm sending a copy of the preliminary Report to Dudley today, with request he call you so you can clear up any questions you may have based on the material enclosed or other matters he may want you to include. Afterwards there might be a revision of the Otter Creek section, which could be substituted for your original.

Best regards —

*later this fall, not urgent to do right now.*  
R

LOOK U/S. (- SOUTH)

(3-abandoned)



DRILL HOLE No 1 - 89.5 TO 100.5' - 2010 MGS. - 15.60/CU.YD. - 53.60  
DRILL HOLE No 4 - 88.0' TO 101' - 3153 MGS. - 18.80/CU.YD. - 64.00  
DRILL HOLE No. 2 73.0' TO 83' - 160 MGS. - 1.36/CU.YD. - 4.60  
at day - - \$43/cy.\*

CROSS-SECTION DRILL LINE No.1 - DRILLED 1951-52

\* NOTE NO BEDROCK IN HOLE No. 4  
4190 MGS. WERE RECOVERED FROM HOLE No. 4 - 1047 MGS WERE ELIMINATED TO ALLOW FOR SLUFFING WHEN CASING WAS PULLED AND REDRIVEN AFTER CHANGING BROKEN DRIVE SHOE

Prob 4 X actual

RATIO 1973 Aug 120 = 3.4 (under a Conserv. 3.0)  
1954 Aug 35 2/105/05  
(85 fine?)

WRIGHT CREEK  
AT LIN B.C  
SCALE 1" = 20  
FEB 11, 1954

SKL 19

FIELD LOG

COMMENCED DRILLING 3 PM Aug 13, 1951  
FINISHED DRILLING  
FINISHED PULLING  
FINISHED MOVING

PROPERTY Wright Creek  
LINE NO. 1  
HOLE NO. 1 (potted)  
ELEVATION 3 ft above Crc  
CLAIM Hodger (??)  
WITH X WITHOUT CASING

TIME OF PUMPING	DEPTH OF PUMPING OR CASING	CORE		Measured Volume Loose	COLORS			Est. Value or Weight	CHARACTER MATERIAL FORMATION	REMARKS
		Before Pumping	After Pumping		1 Coarse	2 Med.	3 Fine			
3.00	5 FT	24	-	400	-	-	-		Tailings	
	9 "	-	-	-	-	-	-		"	Casing sank 4 ft drilling out core
Aug 14	11 "								"	
	12-6						Tr		" Sm C	Bottom of Tailings
	15								CG & S in	Very Sediment
	17						Tr		" " " "	" " "
	20								" " " "	" " Very Hard
	22-6								" " " "	" " " "
	25								" " " "	" " " "
	27-6								CG & B	" " " "
	28-6								" " " "	" " " "
Aug 15	30						Tr		CG & B in Hard Clay	" " "
	32								" " " "	" " "
	34								" " " "	" " "
	36								" " " "	" " "
	38-6						Tr		" " " "	" " "
Aug 16	38-6 to 45						Tr		B & CG in Hard Clay	Very Hard Driving
Aug 17	46						Tr		B & CG in Clay	" " "
	48								" " " "	" " Little Looser Form
	50								" " " "	" " "
	50 to 55						Tr		B & Clay	Hard drilling & Dr
Aug 18	55 to 59						Tr		CG & Sand in Black Clay	Looser & Dr
Aug 20	59 to 64						Tr		CG & B	" " "
Aug 23	75				1	2	12M		" " "	" " "
	79				2	1	10M		" " "	" " "
ROCKER	79 to 89						15M		" " "	" " "
TOTALS										WATER LEVEL

GOLD, ACTUAL WEIGHT	MGS.	FROM	TO	WEIGHT	MGS.	BEDROCK	FT.
FROM	TO			BY	TO	GRAVEL	FT.
FROM	TO			TO	2130	TOTAL	FT.
FROM	TO			FROM	TO	DRED. SECT.	FT.
FROM	TO			FROM	TO	PER CU. YD.	

- ABBREVIATIONS TO BE USED -			Time of Drilling -- Hrs.		DRILLMEN	
S. Sand	B. Boulders	St. Sticky	Time of Pulling -- Hrs.			
F. G. Fine Gravel	T. Tailings	M. Much	Time of Moving -- Hrs.		PANNERS	
M. G. Medium Gravel	C. Clay	L. Loose	Time lost - - - - Hrs.			
C. G. Coarse Gravel	V. Very	Sm. Some	Total Time - - - - Hrs.		CHECKED BY	
	Ca. Caliche	Ce. Cement			In Charge.	

# FIELD LOG

PROPERTY

LINE NO.

HOLE NO.

ELEVATION

CLAIM.

WITH

### WITHOUT CASING

COMMENCED DRILLING.

## FINISHED DRILLING.

## FINISHED PULLING

## FINISHED MOVING.

[illegible]

# FIELD LOG

COMMENCED DRILLING Aug 30 230 PM, 1951  
 FINISHED DRILLING \_\_\_\_\_  
 FINISHED PULLING \_\_\_\_\_  
 FINISHED MOVING \_\_\_\_\_

PROPERTY Wright Creek  
 LINE NO. 1  
 HOLE NO. 2 (pulled)  
 ELEVATION 3 ft Below Hole 1  
 CLAIM Hodges  
 WITH 8 WITHOUT CASING

TIME OF PUMPING	DEPTH OF PUMPING OR CASING	CORE		Measured Volume Loose	COLORS			Est. Value or Weight	CHARACTER MATERIAL FORMATION	REMARKS
		Before Pumping	After Pumping		1 Coarse	2 Med.	3 Fine			
										Hole 2. 48 ft to left of Hole 1 Facing UP's Trcam.
Aug 30	10			(40' on sketched)						Tr Loose Tailings
Aug 31	15									Tr C.G. & S in Black Clay
	20							" "	" "	" "
	27							" "	" "	" "
Sept 1st	30									Tr C.G. & B " "
	35							" "	" "	" "
	40							" "	" "	" " Very Hard.
Sept 2	45							" "	" "	" " " "
										Engine trouble 5-hrs
Sept 3	47-6							Tr " "	" "	" "
	50							1 10M	C.G. & B in Black Clay	" "
	58								" "	" "
Sept 4	60								" "	" "
	65							Tr	" "	" "
	68							Tr	Green Boulders Hard Drilling	" "
Sept 5	70								" "	" "
	75							6 10 40M	C.G. & S in Hard Clay	" "
	79							4 8 30M	" "	" "
Sept 6	80							6	Green Boulder	" "
	82								" "	" "
	82-6							4	C.G. & S SM Broken Bedrock	" "
	83								Broken Bedrock	" "
	84								" "	Black Slai
	86								" "	" "
	87								" "	" "
										Top of Bedrock 83 ft
Sept 7										Pulled Casing & moved. 40 ft to left of Hole 1
ROCKER										
TOTALS										WATER LEVEL 20 ft from Sur.

GOLD, ACTUAL WEIGHT	NOT WEIGHED	MGS.	FROM	TO	MGS.	BEDROCK	FT.
FROM	TO	MGS.	FROM	TO	MGS.	GRAVEL	FT.
FROM SURFACE TO BEDROCK	167.30	MGS.	FROM	TO	MGS.	TOTAL	FT.
FROM WEIGHT TO BY HANKS		MGS.	FROM	TO	MGS.	DRED. SECT.	FT.
FROM	TO	MGS.	FROM	TO	MGS.	PER CU. YD.	

—ABBREVIATIONS TO BE USED—			Time of Drilling --	Hrs.	DRILLMEN	
S. Sand	B. Boulders	St. Sticky	Time of Pulling --	Hrs.		
F. G. Fine Gravel	T. Tailings	M. Much	Time of Moving --	Hrs.	PANNERS	
M. G. Medium Gravel	C. Clay	L. Loose	Time lost - - - -	Hrs.		
C. G. Coarse Gravel	V. Very	Sm. Some	Total Time - - - -	Hrs.	CHECKED BY	
Ca. Caliche	Ce. Cement					In Charge.

# FIELD LOG

PROPERTY Wright Creek

LINE NO. 7

HOLE NO. 3 - abandoned - repl. by Hole No 4  
(26' 41/2")

ELEVATION 2 ft below HGLB1

CLAIM Hodges.

WITH                      WITHOUT CASING

COMMENCED DRILLING.....1951

## FINISHED DRILLING

FINISHED PULLING.....

## FINISHED MOVING

[illegible]

GOLD, ACTUAL WEIGHT		MGS.	FROM	TO	MGS.	BEDROCK	FT.
FROM	TO	MGS.	FROM	TO	MGS.	GRAVEL -	FT.
FROM	TO	MGS.	FROM	TO	MGS.	TOTAL -	FT.
FROM	TO	MGS.	FROM	TO	MGS.	DRED. SECT.	FT.
FROM	TO	MGS.	FROM	TO	MGS.	PER CU. YD.	

—ABBREVIATIONS TO BE USED—

S. Sand	B. Boulders	St. Sticky
F.G. Fine Gravel	T. Tailings	M. Much
M.G. Medium Gravel	C. Clay	L. Loose
C.G. Coarse Gravel	V. Very	Sm. Some
	Ca. Caliche	Ce. Cement

Time of Drilling - - - - - Hrs.

Time of Pulling - - -----Hrs.

Time of Moving - - ----- Hrs.

Time lost - - - - - Hrs.

Total Time - - - - - Hrs.

DRILLMEN \_\_\_\_\_

## PANNERS

CHECKED BY \_\_\_\_\_

**In Charge.**

FIELD LOG

COMMENCED DRILLING 1951  
FINISHED DRILLING  
FINISHED PULLING  
FINISHED MOVING

PROPERTY Wright Creek  
LINE NO. 1  
HOLE NO. 4 (e 6' 4" SHARPEND. HOLE #3)  
ELEVATION 2 ft Below Hole  
CLAIM Hodges  
WITH WITHOUT CASING

TIME OF PUMPING	DEPTH OF PUMPING OR CASING	CORE		Measured Volume Loose	COLORS			Est. Value or Weight	CHARACTER MATERIAL FORMATION	REMARKS
		Before Pumping	After Pumping		1 Coarse	2 Med.	3 Fine			
										Moved 6 ft UP stream From Hole 3.
Sept. 13	8									Tailings
	15									C.G. & S in Gray Clay.
	20									" " " " " "
	25									" " & B " " "
	30									" " " " " " Hard Drill
Sept 14	35									Green Boulders " "
	40									" " " " "
Sept 15	45									C.G. & B in Black Clay.
	50							Tr	" " " " " "	
	52							Tr	" " " " " "	
Sept 16	55									Boulder & Clay Very Hard.
	60								" " " " " "	
	64							Fr	" " " " " "	
Sept 17	70									Drilled 4 hrs Sharpen " Bits " " "
" 18										
Sept. 19	75							Tr		Boulders & Clay. Hard Drilling
	80							Tr	C.G. & B in Gray Clay	
	82							Tr	" " " " " "	
Sept 20	83									Green Boulder Casing Cracked.
	83.6									Casing Cracked Here to Pull & Short
										Shot & drove back to 83 ft
Sept 21	84									Boulder
	89							1 10 20m		C.G. & S in Gray Clay Looser For
	90							1 1 6 100m		" " " " " "
	94							2 10 40m		C.G. & B. " " " "
	95							1 2 6 100m		" " " " " "
	96							1 7 8 125m		" " " " " "
	97							1 2 6 40m		" " " " " "
ROCKER	98							1 3 25 100m		Green Boulder Casing Cracked
TOTALS	99							4 20 50		" " " " " " WATER LEVEL " " "

GOLD, ACTUAL WEIGHT		1814 ?	MGS.	FROM ACT. TO L. WEIGHT		MGS.	BEDROCK	FT.
FROM	TO		MGS.	FROM	BY TO HANKS	MGS.	GRAVEL -	FT.
FROM	TO	1 DWT 286RS	MGS.	FROM	1951 TO 1105	MGS.	TOTAL -	FT.
FROM	TO	4 GRS.	MGS.	FROM	TO	MGS.	DRED. SECT.	FT.
FROM	TO		MGS.	FROM	TO	MGS.	PER CU. YD.	

-ABBREVIATIONS TO BE USED-			Time of Drilling --	Hrs.	DRILLMEN	
S. Sand	B. Boulders	St. Sticky	Time of Pulling --	Hrs.		
F.G. Fine Gravel	T. Tailings	M. Much	Time of Moving --	Hrs.	PANNERS	
M.G. Medium Gravel	C. Clay	L. Loose	Time lost - - - -	Hrs.		
C.G. Coarse Gravel	V. Very	Sm. Some	Total Time - - - -	Hrs.	CHECKED BY	In Charge.
	Ca. Caliche	Ce. Cement				

# FIELD LOG

## PROPERTY

LINE NO.....

HOLE NO. 4

### ELEVATION

### CLAIM

WITH

### WITHOUT CASING

COMMENCED DRILLING.....1951

## FINISHED DRILLING

## FINISHED PULLING

## FINISHED MOVING

[illegible]

# FIELD LOG

PROPERTY Hodges

LINE NO. 1

COMMENCED DRILLING Aug 23, 1952

HOLE NO. 4

FINISHED DRILLING

ELEVATION

FINISHED PULLING

CLAIM

FINISHED MOVING

WITH X WITHOUT CASING

TIME OF PUMPING	DEPTH OF PUMPING OR CASING	CORE		Measured Volume Loose	COLORS			Est. Value or Weight	CHARACTER MATERIAL FORMATION	REMARKS
		Before Pumping	After Pumping		1 Coarse	2 Med.	3 Fine			
										Hole 4 drilled last Fall to 99 ft (lost shoe) no Bedrock. Will try driving casing back down with new shoe in same hole.
Aug 23										Drove casing to 50 ft.
Aug 24										" " " 76 ft. Hole caved in from 50 ft.
Aug 25										Drilled to 98.6 400m Driving on old shoe
Aug 26	100'									600m Driving on old shoe
										" " " "
Aug 27	101'									800m " " " "
	100'									800m " " " "
										Had 1 ft of core left in casing. Casing cracked.
										Hole was drilled to 99 ft, Sept 1951
										Eliminate gold to 99' all of gold to 98.6 & 1/3 of gold from 98.6" to 100' 400 mgs + 600 = 600 mgs.
										3
										Estimated weight above = 1800 mgs = 600 mgs = 1/3 of gold recovered
										Actual weight = 3140 3140 = 1047
										3
										3140 - 1047 = 2093 mgs recovered from 99' to 100'
ROCKER										2093 + 1105 = 3208 mgs = Total calculated wt. of gold
TOTALS										WATER LEVEL from hole 0' to 100'

GOLD, ACTUAL WEIGHT	3140	MGS.	FROM	TO	MGS.	BEDROCK	FT.
FROM W.T. OF GOLD OBTAINED		MGS.	FROM	TO	MGS.	GRAVEL	FT.
FROM FROM TO 1951 DRILLING 1105		MGS.	FROM	TO	MGS.	TOTAL	FT.
FROM TO		MGS.	FROM	TO	MGS.	DRED. SECT.	FT.
FROM TO		MGS.	FROM	TO	MGS.	PER CU. YD.	

## —ABBREVIATIONS TO BE USED—

S. Sand	B. Boulders	St. Sticky
F. G. Fine Gravel	T. Tailings	M. Much
M. G. Medium Gravel	C. Clay	L. Loose
C. G. Coarse Gravel	V. Very	Sm. Some
	Ca. Caliche	Ce. Cement

Time of Drilling --	Hrs.
Time of Pulling --	Hrs.
Time of Moving --	Hrs.
Time lost - - - -	Hrs.
Total Time - - - -	Hrs.

DRILLMEN	VAL. O'LOI'
	VAL. 88' 101'
PANNERS	
CHECKED BY	
In Charge.	

Atlin Drill Logs Wright  
Creek

GLACIER

2 miles  
" "

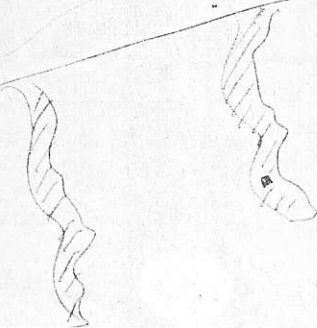

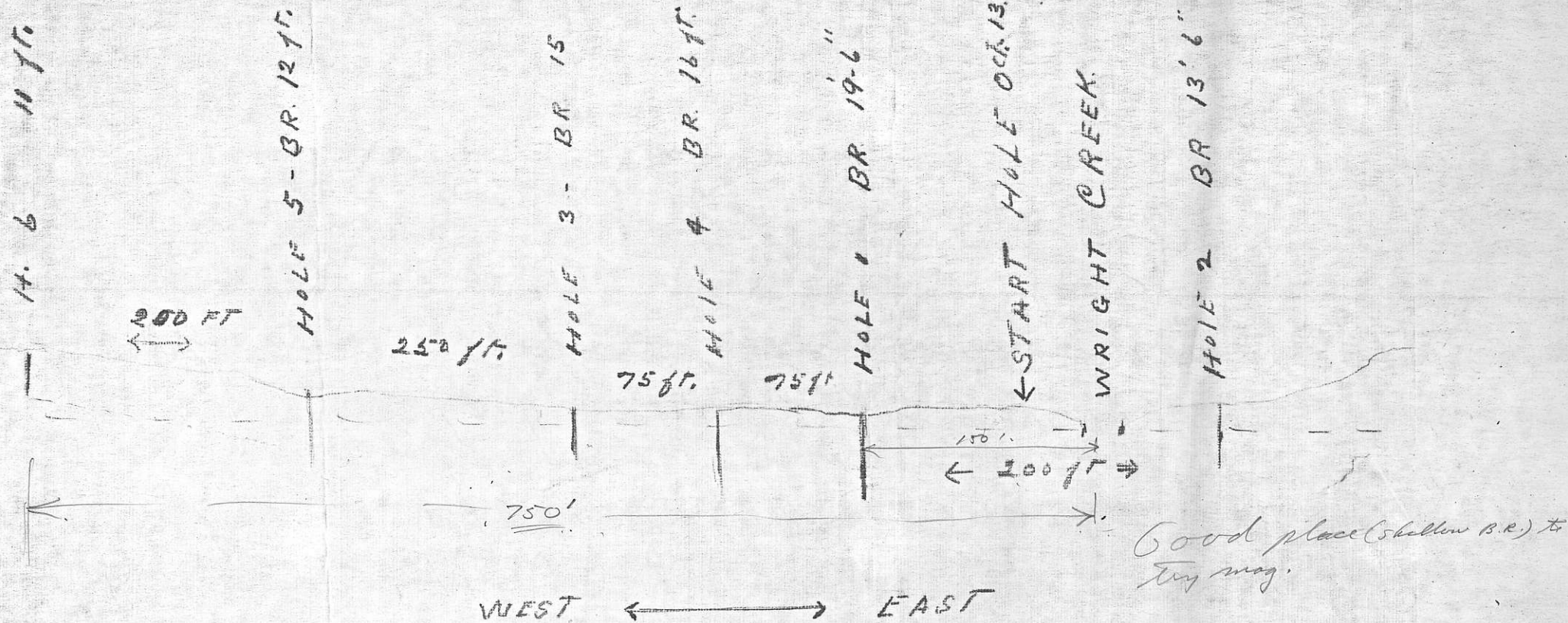

1792  
6  
4752

NO VALUES IN HOLES SO FAR.

DRILL LINE ABOUT 1800 FT BELOW <sup>which bridge?</sup> BRIDGE  
ON WRIGHT CREEK - Log states line no 2 just below Aspen Gulch. (where?)

ALL HOLES DRILLED 5 FT INTO BED. ROCK. all drilled 1952

This location much in doubt as area 1800' up of ~~Shay~~ <sup>Shay</sup> ~~Thoma~~ <sup>Thoma</sup> bridge is a broad flat w. apparent depth of gravel  $\approx 100'$  rather than the 11' - 19.5' depths noted; Probably Aspen Gulch much further down stream or directly above E-W vent of old road on W. side of Wright Creek.

# FIELD LOG

PROPERTY Hodges.  
LINE NO. 2  
HOLE NO. 1  
ELEVATION \_\_\_\_\_  
CLAIM \_\_\_\_\_  
WITH \_\_\_\_\_ WITHOUT CASING \_\_\_\_\_

COMMENCED DRILLING Aug 20 1952  
FINISHED DRILLING WRIGHT CREEK. JUST  
FINISHED PULLING BELOW ASPEN GULCH  
FINISHED MOVING \_\_\_\_\_

TIME OF PUMPING	DEPTH OF PUMPING OR CASING	CORE		Measured Volume Loose	COLORS			Est. Value or Weight	CHARACTER MATERIAL FORMATION	REMARKS
		Before Pumping	After Pumping		1 Coarse	2 Med.	3 Fine			
Aug. 24	27-2							-	Loose Grs in Grey Clay.	
" 30	40 -							-	CG & Boulders.	" "
Sept. 1	53 -							-	" " " "	" "
Sept. 2	70							-	" " " Hard.	" "
" 3	78							-	" " " "	" "
" 4	90							-	" " " "	" "
" 5	101							Tr	" " " "	" "
" 6	111							Tr	" " " "	" "
" 8	118							Tr	" " " "	" "
" 9	127							-	" " " "	" "
" 10	137							Tr	" " " "	" "
" 11	143-6							Tr	" " " "	" "
" 12	150							Tr	" " " "	Looser Formation
" 13	160							Tr	" " " "	" "
Had to quit Hole Lack of Coring										
" 15										Pulled 20ft Hard Pulling
" 16										" 60 "
" 17										Finished Pulling & Moved
Guth										
ROCKER										
TOTALS										
										WATER LEVEL

GOLD, ACTUAL WEIGHT		MGS.	FROM	TO	MGS.	BEDROCK	FT.
FROM	TO	MGS.	FROM	TO	MGS.	GRAVEL -	FT.
FROM	TO	MGS.	FROM	TO	MGS.	TOTAL -	FT.
FROM	TO	MGS.	FROM	TO	MGS.	DRED. SECT.	FT.
FROM	TO	MGS.	FROM	TO	MGS.	PER CU. YD.	

- ABBREVIATIONS TO BE USED—
- |                     |             |            |
|---------------------|-------------|------------|
| S. Sand             | B. Boulders | St. Sticky |
| F. G. Fine Gravel   | T. Tailings | M. Much    |
| M. G. Medium Gravel | C. Clay     | L. Loose   |
| C. G. Coarse Gravel | V. Very     | Sm. Some   |
|                     | Ca. Caliche | Ce. Cement |

Time of Drilling -- Hrs.  
Time of Pulling -- Hrs.  
Time of Moving -- Hrs.  
Time lost - - - - Hrs.  
Total Time - - - - Hrs.

DRILLMEN \_\_\_\_\_  
PANNERS \_\_\_\_\_  
CHECKED BY \_\_\_\_\_ In Charge.

FIELD LOG

COMMENCED DRILLING Sept 18<sup>th</sup> 1952

FINISHED DRILLING WRIGHT CR. JUST

FINISHED PULLING BELOW ASPEN GULCH

FINISHED MOVING \_\_\_\_\_

PROPERTY \_\_\_\_\_

LINE NO. Line 2 Hole 2.

HOLE NO. 2

ELEVATION same level as Hole 1

CLAIM \_\_\_\_\_

WITH \_\_\_\_\_ WITHOUT CASING \_\_\_\_\_

TIME OF PUMPING	DEPTH OF PUMPING OR CASING	CORE		Measured Volume Loose	COLORS			Est. Value or Weight	CHARACTER MATERIAL FORMATION	REMARKS
		Before Pumping	After Pumping		1 Coarse	2 Med.	3 Fine			
Sept 18	6								Fine Silt	
	12								CG & S in	
	20								Tr " " in Dark Clay. Loose Driving	
	25								" " " " " " " "	
Sept. 19	50								" " " " " " " "	
Sept. 20	70								" " " " " " " "	
Sept 21	75								CG & B in Very Hard Clay	
	81								" " " " " " " "	
" 22	85								Casing Crooked Shot Boulder	
Sept 23	90								Hard Boulder Had to Blast	
	2495								" " " " " " " "	
	1598								Broke shaft in Transmission Blast Boulder Casing Crooked.	
	29101								<del>2 in 20m.</del> Boulder & CG in Hard Clay.	
Sept 30	107								Casing Crooked Have to Pull to change Shoe.	
Oct 1st									Pulled Casing out Shoe badly battered Last Casing Bent	
Oct 2									Drove Casing to 47 Hole caved	
Oct 3									" " " 86 " "	
	4								107 " CG & B	
									<del>1011</del> CG & B in Grey Clay.	
Oct. 5	112.	18		350	1	50		40M.	CG & S " " "	
	113	20		200			6	Tr	" " " " " "	
	114	18		300				Tr	" " " " " "	
	116	40		800				Tr	" " " " " "	
	118	30		600				Tr	" " " " " "	
	120	36		500				Tr	" " " " " "	
	122	36		600				Tr	" " " " " "	
	125							Tr	" " " " " "	
Oct 6	135							Tr	" " " " " "	
ROCKED										
Oct 7	143							Tr	" " " " " "	
TOTALS	150 ft.								" " " " " "	WATER LEVEL

GOLD, ACTUAL WEIGHT	90' To 112'	54	MGS.	FROM	TO	MGS.	BEDROCK	FT.
FROM	TO 112' To 124'	44	MGS.	FROM	TO	MGS.	GRAVEL	FT.
FROM	TO 124' To 134'	26	MGS.	FROM	TO	MGS.	TOTAL	FT.
FROM	TO 134' To 150'	18	MGS.	FROM	TO	MGS.	DRED. SECT.	FT.
FROM	TO		MGS.	FROM	TO	MGS.	PER CU. YD.	

—ABBREVIATIONS TO BE USED—

S. Sand	B. Boulders	St. Sticky
F.G. Fine Gravel	T. Tailings	M. Much
M.G. Medium Gravel	C. Clay	L. Loose
C.G. Coarse Gravel	V. Very	Sm. Some
	Ca. Caliche	Ce. Cement

Time of Drilling -- Hrs.  
Time of Pulling -- Hrs.  
Time of Moving -- Hrs.  
Time lost - - - - Hrs.  
Total Time - - - - Hrs.

DRILLMEN \_\_\_\_\_  
PANNERS \_\_\_\_\_  
CHECKED BY \_\_\_\_\_  
In Charge.

*Rutherford Day*  
*Director of Companies*

1118 S.W. 8th Terrace  
Ft. Lauderdale, Florida 33315  
(305) 527-0968

1730 M Street, N.W. Suite 606  
Washington, D. C. 20036  
(202) 293-3350

July 25, 1973

Mr. L. G. White  
Exploration Services, Limited  
850 West Hastings Street, Suite 202  
Vancouver 1, British Columbia  
CANADA

Dear Mr. White:

Bill Sharp told me he had spoken to you and that you would be in Vancouver, very probably, during the first half of August which is a time I plan to be there myself and would like to meet you. I shall telephone you in advance to make more definite arrangements when my itinerary is better established.

I shall look forward to meeting you as I have heard many favorable and pleasant things about you.

Very truly yours,

*Rutherford Day*

Rutherford Day  
RD/jh

✓ CC: Bill Sharp

Letterhead

OCTOBER 22, 1973

MR. RUTHERFORD DAY, PRES.,  
SURPRISE RESOURCES LTD.,  
C/O 1118 S.W. 8TH TERRACE,  
FORT LAUDERDALE, FLORIDA 33315

DEAR RUDDY:

THANK YOU VERY MUCH FOR THE RECENT CHEQUE!

WHILE ACKNOWLEDGING THE ENCLOSED COPY OF YOUR OCT. 3RD LETTER TO A.D. MCUTCHEON, I SHOULD NOTE THAT THERE HAVE BEEN NO WORD OR ENQUIRIES FROM THAT QUARTER - - - HOWEVER, I MUST ADMIT THAT I HAVE BEEN SOMEWHAT OUT OF REACH DURING THE PAST COUPLE OF WEEKS.

YOUR RECENT ACQUISITION OF THE DRAIN LEASE SHOULD MAKE ALL THE DIFFERENCE IN RESPECT OF THE ULTIMATE SUCCESS OF YOUR OTTER CREEK PROGRAM. IT GIVES YOU A PRIME PIECE OF GROUND TO DEVELOP, AND ALSO THE BEST APPROACH FOR EXPLORATION AND DEVELOPMENT OF THE UP-STREAM CLAIMS.

PURSUANT TO HIS LETTER REQUESTING MORE DETAIL ON TOM CONNOLLY'S REPORTED EXPENDITURE OF \$436.00, I HAVE FURNISHED E.J. BOWLES, CHIEF GOLD COMMISSIONER, A BREAKDOWN OF THIS - SIMILAR TO THAT GIVEN IN LETTERS FROM YOU AND TOM. ALSO, I HAVE ADVISED HIM, AS HE HAS REQUESTED, THAT THE COMPANY'S VANCOUVER ADDRESS IS C/O LAWRENCE & SHAW, 8TH FLOOR, BANK OF CANADA BUILDING. BOWLES NOTES THAT THE ABOVE INFORMATION IS REQUIRED SO THAT THE DEPT. OF MINES "MAY PROCEED WITH APPROVAL OF ISSUANCE OF CERTIFICATES OF WORK".

I HAVE REVIEWED PHIL NIELSEN'S ESTIMATES PERTAINING TO THE PROPOSED GEOPHYSICAL TEST WORK. AS A RESULT, I FEEL THAT IT WOULD BE BEST TO OBTAIN COMPARATIVE ESTIMATES FROM A COUPLE OF OTHER CONTRACTORS BEFORE DECIDING HOW SUCH CONTRACT WORK SHOULD BE ARRANGED AND CARRIED OUT.

WITH BEST REGARDS,

Bill,

(W. M. Sharp)

WILLIAM M. SHARP, M.A.Sc., P.Eng.  
CONSULTING GEOLOGICAL ENGINEER  
171 W. ESPLANADE, NORTH VANCOUVER, B.C.

JUNE 17, 1974

MR. RUDOLPH KLIMKE,  
RESIDENT SALES REPRESENTATIVE,  
WESTERHÜTTE  
8548-86 AVENUE,  
EDMONTON, ALBERTA.

DEAR RUDY:

PLEASE FIND ENCLOSED TWO PRINTS OF DRAWING  
NO. D-1, "LOWER OTTER CREEK", ATLIN, B.C. PER MR. R. DAY'S  
INSTRUCTIONS.

ALSO, I MIGHT POINT OUT THAT THE LOWER PIT ON THE  
DRAIN LEASE IS SHOWN IN APPROXIMATE OUTLINE ONLY - WHICH  
WAS SUFFICIENT FOR OUR (PRELIMINARY EXAMINATION) PURPOSES  
IN 1973.

I BELIEVE THAT YOU MADE ARRANGEMENTS WITH MR. DAY  
TO MAIL HIM YOUR PROPOSALS CONCERNING EXCAVATION BY  
BUCKET-WHEEL. CONSEQUENTLY, I WILL LOOK FORWARD TO  
RECEIVING THESE FROM HIM AT A LATER DATE.

I CERTAINLY APPRECIATED RECEIVING YOUR VIEWS ON  
THE EXCAVATION PROBLEMS AT ATLIN, AND LOOK FORWARD  
TO ACTUALLY SEEING YOUR EQUIPMENT IN OPERATION.

WITH BEST REGARDS,

YOURS VERY TRULY,  
(Sill)

W M Sharp.

ENCL.

SURPRISE LAKE, M.W.L. @ EL. 2985'



**LEGEND:**

- APPROXIMATE BROW OF PIT WALL OR CLIFF
- ROAD
- BEDROCK OR 'RIM'
- ATTITUDE OF BEDDING/SCHISTOSITY
- AVERAGE ELEVATION OF BENCH OR FLAT
- PRELIM. INTERPRETATION OF AXIS OF OLD CHANNEL

**ABBREVIATIONS:**

- ARGILL. (ARG.) ARGILLACEOUS QUARTZITE
- SERP. SERPENTINE
- B.R. BEDROCK
- P.H. POWER HOUSE
- P.M.L. PLACER MINING LEASE
- H.P. HARDPAN

**NOTE:** OUTLINE OF 'LOWER PIT AREA' IS ONLY APPROXIMATE

**GEOLOGICAL CROSS-SECTIONS**

SCALE: 1" = 100'

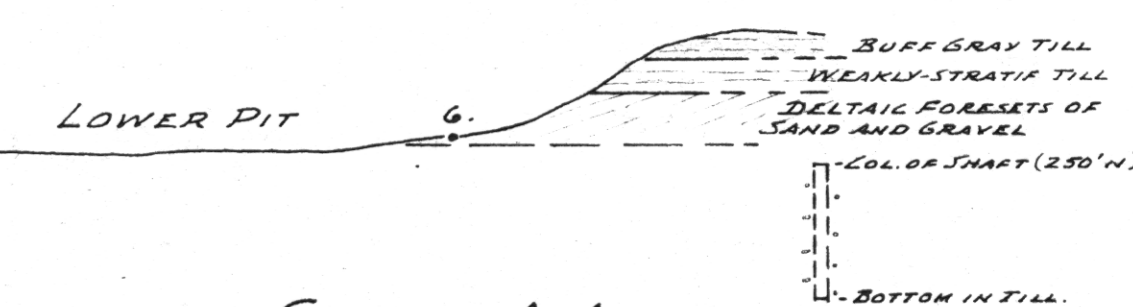

**SECTION A-A**

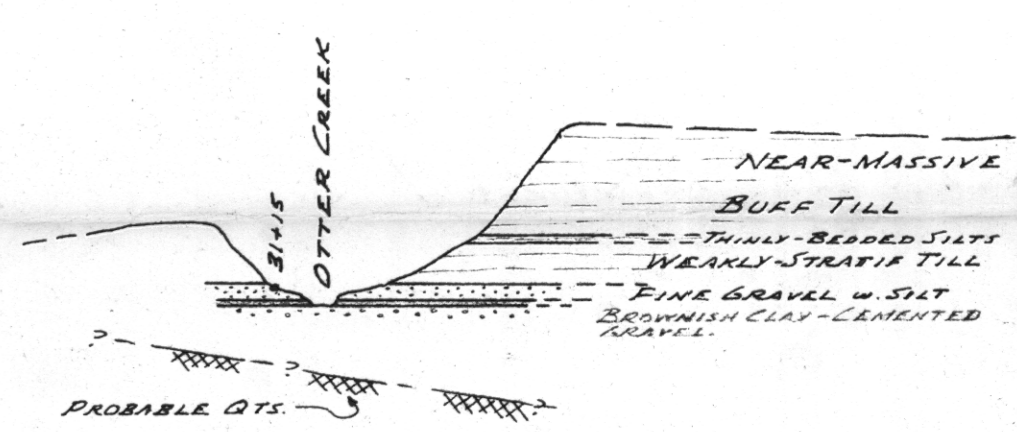

**SECTION B-B**

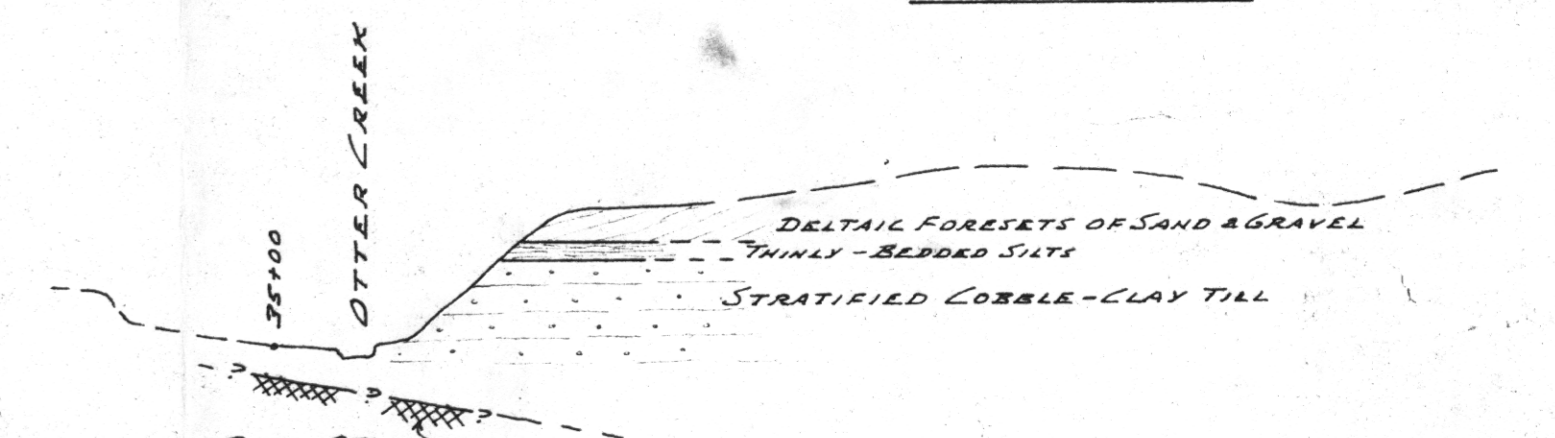

**SECTION C-C**

W. M. SHARP, P.Eng. CONSULTING GEOLOGICAL ENGINEER  
NORTH VANCOUVER, B.C.

**SURPRISE RESOURCES LTD.**

**LOWER OTTER CREEK**

**ATLIN, B.C.**

**PLACER CLAIMS**

**TOPOGRAPHY, WORKINGS & GEOLOGY**

PRINCIPAL REP. GOLDFIELD PLACERS, NOV. 1939

Scale: 1" = 200' Date: JUNE 1973

Dep. No. D-1

**RUTHERFORD DAY**  
1118 SOUTHWEST 8TH TERRACE  
FORT LAUDERDALE, FLORIDA 33315

305 / 527-0368

July 29, 1974

Mr. William M. Sharp  
Consulting Geological Engineer  
171 West Esplanade  
North Vancouver, British Columbia  
CANADA V7M 1A1

*Require sketch & note  
Require bulldozer prep of some (bench) drill  
sites along edge of pit. (2 days D-7?)*

Dear Bill:

As it seems obvious now that placer gold will not be subjected to the super royalty provisions of Bill 31, I would appreciate your dropping me a note, which I could use together with Dick McIntyre, in order to commence our projected plan for Otter Creek and Drain Lease. What I have in mind is a statement of the required drill pattern and number of holes necessary to establish the existence of sufficient placer material to justify the program with General Enterprise. I believe you stated that a series of 20 to 30 keystone drill holes would be necessary on a grid plan to be laid out by you based upon your field investigations, magnetometer survey and discussions with persons in the area who were knowledgeable of the property.

There may be some further help available, since Allan Mattson has some drill results available which are in addition to those already obtained by me and presently in your possession. I believe you stated that the costs of the initial drill program to cover the area underneath the over-burden to be removed by General Enterprises would cost approximately \$25,000. However, my memory is hazy of this, and the notes I took at the time have become misplaced. If you could give me a little statement of what would be required to prove up the first portion of the property to be worked, I would much appreciate it, as it is getting late in the year and Dick McIntyre feels it would be advisable to prepare the program for the tax shelter investing season, September 15 through December 1, 1974. I would appreciate your sending him a copy of your letter answering this, because I will be traveling fairly extensively within the next three weeks and I wish to have our requirements detailed as quickly as possible.

Thanking you very much for your kind attention to this matter and with best personal regards I am,

Sincerely,

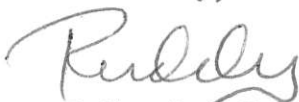
  
Rutherford Day  
RD/jtd

cc: Richard W. McIntyre  
Suite 1000  
3050 Biscayne Boulevard  
Miami, Florida 33137

RUTHERFORD DAY  
1118 SOUTHWEST 8TH TERRACE  
FORT LAUDERDALE, FLORIDA 33315

305 / 527-0368

July 29, 1974

Mr. Clive Boyd  
Construction Manager  
General Enterprises Limited  
117 Industrial Road  
Whitehorse, Yukon  
CANADA

Dear Mr. Boyd:

Since it has been some time since we met at your home, I would like to bring you up to date on my progress at Atlin. As I explained then, I am attempting to secure funds in order to go forward with the program we discussed. The impact of Bill 31 held up everything until the present time, but it looks as if I have lucked out and Bill 31 will not apply to placer gold. Accordingly, I am writing Bill Sharp, the geologist whom you met with me, to outline what will be necessary by way of preliminary drilling in order to prove up that portion of Otter Creek which would be the initial area to be worked.

I shall keep you informed of my progress in the matter and hope that we will be able to get together in the near future.

Very truly yours,

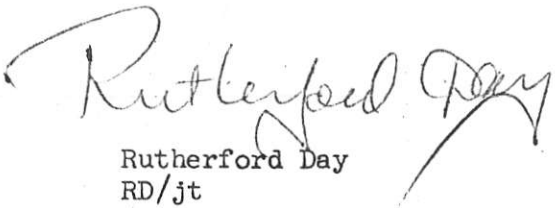
  
Rutherford Day  
RD/jt

✓ cc: Bill Sharp

WILLIAM M. SHARP, M.A.Sc., P.Eng.  
CONSULTING GEOLOGICAL ENGINEER  
171 W. ESPLANADE, NORTH VANCOUVER, B.C.

August 15, 1974

Mr. Rutherford Day,  
1118 Southwest 8th Terrace,  
Fort Lauderdale, Florida 33315,  
U.S.A.

Dear Ruddy:

In order to provide a statement of the required drill pattern and number of holes necessary to establish the existence of sufficient placer material to justify the program with General Enterprises, I have compiled our more pertinent data on a suitably-scaled set of working drawings - No's 1-D/S and 1-U/S (1-down-stream and up-stream, respectively). On these, the proposed drill-holes are detailed on co-ordinated plans and cross-sections; elevations are based on the included long-profile (longitudinal vertical-section) following our base-lines. Churn-drill holes are indicated where the pay-zones and old workings have been fairly well delineated; O.D. (overburden-drill) holes are suggested where a cheaper method of preliminary bedrock or channel-delineation is required. Pending the results of a more detailed control-survey, I would recommend the pattern of churn-drill and overburden-drill holes shown on Dwgs. No's 1-D/S and 1-U/S, and summarized via the following schedule:

CROSS-SECT. NO.	TYPE OF HOLE	NO. OF HOLES ON X-SECT.	RANGE, TOTAL FT. LENGTHS ON X-SECT.		ESTIM. COST PER FT.	ESTIM. COST @ X-SECT.
9 + 00	Churn	6	65'-125'	525	\$10.00	\$ 5,250
10 + 20	Churn	5	65'-105'	430	10.00	4,300
11 + 90	Churn	5	70'-155'	505	10.00	5,050
G.F.P.2400	Churn	4	120'-160'	570	10.00	5,700
G.F.P.2600	Churn	2	160',165'	325	10.00	3,250
G.F.P.2800	Churn	2	165',180'	345	10.00	3,450
		24	SUB-TOTAL, CHURN-DRILL TEST HOLES			\$27,000
G.F.P.2400	O.D.	1	160'	160	3.00	480
G.F.P.2600	O.D.	4	160'-170'	670	3.00	2,010
G.F.P.2800	O.D.	4	160'-180'	675	3.00	2,025
		9	SUB-TOTAL, O.D. TEST HOLES		-----	\$ 4,515
			Total Churn & O.D.		-----	\$ 31,515

Churn-drill holes would be 5½" or 6" diameter, inside the casing.

The O.D. equipment would probably drill a 3½" diam. hole, via a 2" diam. bit operating inside a casing pipe with a 3½" diam. ring-bit or shoe. Based on general experience, a gross drilling cost of about \$3.00 per ft. would be expected.

Estimate of Churn-Drill Costs:

- Equipment:
- (a) Churn-drill, tools (drill-string), and casing.
  - (b) Service vehicle (pick-up truck).
  - (c) D-7 Cat., as required for site-prep. and moving.
  - (d) Hand-tools.
  - (e) Tentatively, a Denver 'Gold-Pan' to handle samples.

Drilling Rate - estimated at an over-all average of 15' per 8-hour drill-shift - subject to revision via actual operating experience. The field-established cost will bear directly on the scope of the currently-recommended program.

Costs: Wages, driller @ \$5.50/hr. <sup>8.00</sup> ~~\$44.00~~ <sup>64.00</sup> /shift  
 sampler @ \$4.00/hr. <sup>6.00</sup> ~~\$32.00~~ / "  
 Pay-roll charges @ 15% <sup>16.80</sup> ~~\$11.40~~ / "  
 Gross wages, drill crews <sup>128.80</sup> ~~\$87.40~~ / " <sup>8.58</sup> \$ 5.83/ft.  
 Churn-drill & tools rental (local) \$30.00/day 2.00/ "  
 Truck rental, based on mileage - allowance to a local owner \$ 7.50/day 0.50/ "  
 Fuel, based on 10 gal./shift 0.50/ "  
 D-7 Cat, occasional use 0.25/ "  
 Drill repairs & maintenance 0.15/ "  
 Gen. supervision & engineering 0.50/ "  
 Contingencies and extras 0.27/ "  
 Total Drilling Cost - - - - - <sup>12.75</sup> ~~\$10.00~~ / "

*Changes per discussion w/ Allan Mattson Sept. 18/74*

*Allow for (pullable) casing To top. 2.50 - 3.50/ft. 15.25 - less 2.50/ft.*

As drilling proceeds, some substitutions within, and/or additions to the currently-recommended program should be anticipated.

*if competent drillers available*

Respectfully submitted,

W. M. Sharp, P.Eng.

*Sept. 18 Note Allan Mattson concurs in WMS proposal to try 10" O.D. drill, using largest regular bit size available plus modified bit for more efficient overburden drilling. poss. \$3-4/ft. plus sample handling charges.*

WILLIAM M. SHARP, M.A.Sc., P.Eng.  
CONSULTING GEOLOGICAL ENGINEER  
171 W. ESPLANADE, NORTH VANCOUVER, B.C.

AUG 16, 1974

DEAR RUDDY:

FIRST, MY APOLOGIES FOR NOT GETTING THIS REPORT TO YOU SOONER, BUT I HAD A FAIRLY LENGTHY PROJECT 'IN THE MILL' AT THE TIME I RECEIVED YOUR LETTER. ALSO, THE MATTER OF PROVIDING A GENERAL DRILL PLAN WHICH WOULD BE OF REAL USE AND VALIDITY REQUIRED THAT I TAKE SOME TIME TO PROPERLY FIT THE RELEVANT PARTS OF THE EXISTING DETAIL VIA A SUITABLY SCALED SET OF DRAWINGS.

EVEN THOUGH THE LAYOUTS ARE, NECESSARILY, PRELIMINARY, I WANTED TO BE SURE THAT THEY WOULD BE ESSENTIALLY VALID; ALSO, THAT A MINIMUM PART OF THE DRILL FOOTAGE MIGHT BE WASTED VIA INTERSECTIONS ~~##~~ DECIDEDLY OFF-STRUCTURE, OR WITHIN OLD DRIFTS - PARTICULARLY BEDROCK DRIFTS.

BEFORE MAKING AN A START ON THE ACTUAL DRILLING, WE SHOULD OBTAIN ALLAN MATTSON'S DRILL-HOLE DATA AND APPLY IT TO THE ENCLOSED DRAWINGS -- AND MAKE WHAT CHANGES AS MAY BE INDICATED.

I HAVE MAILED A COPY OF THE TYPED REPORT ONLY TO DICK MCINTYRE. I WILL LEAVE IT TO YOU TO MAIL HIM PRINTS OF DIS-1 AND UIS-1, IF YOU THINK HE MIGHT WANT THEM.

REGARDING THE MATTER OF DIFFERENCES DUE TO U.S.-CAN. EXCHANGE RATES, I WOULD BE SATISFIED TO 'SPLIT' THESE ON CURRENT & FUTURE INVOICES (I.E. 50% OF DIFF AS A DEBIT OR CREDIT) AS LONG AS THE DIFFERENCE IS NOT ALL THAT GREAT -- RE. THE \$39.50 DIFFERENCE ON THE MOST RECENT CHEQUE.

FINALLY, MY THANKS FOR YOUR LETTER OF JULY 24<sup>TH</sup>, WITH YOUR CHEQUE AND VERY KIND COMMENT WHICH, I ASSURE YOU, I APPRECIATED VERY MUCH.

WITH BEST REGARDS,

YOURS SINCERELY,

Bill.

Encl Report  
Map  
Photos.

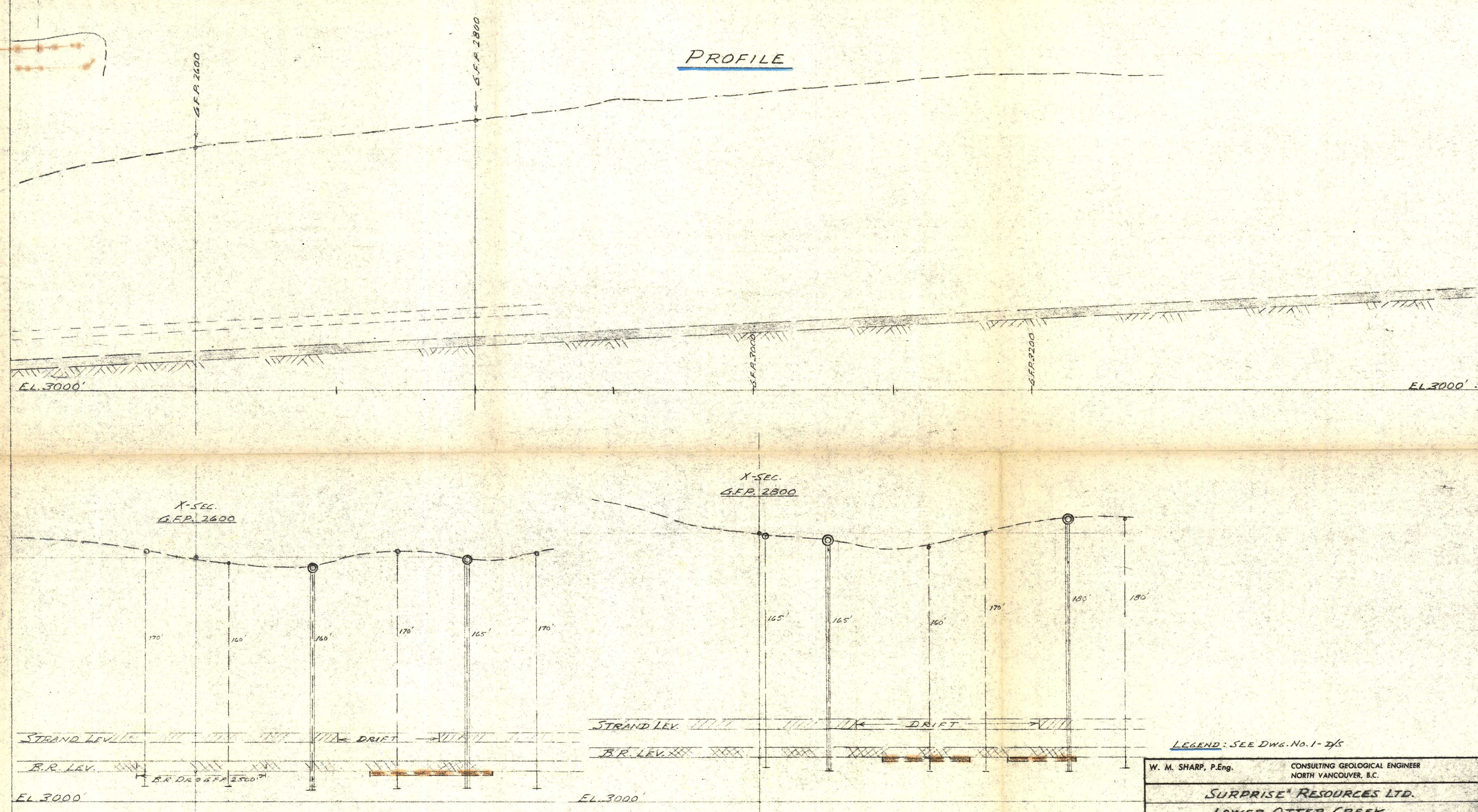
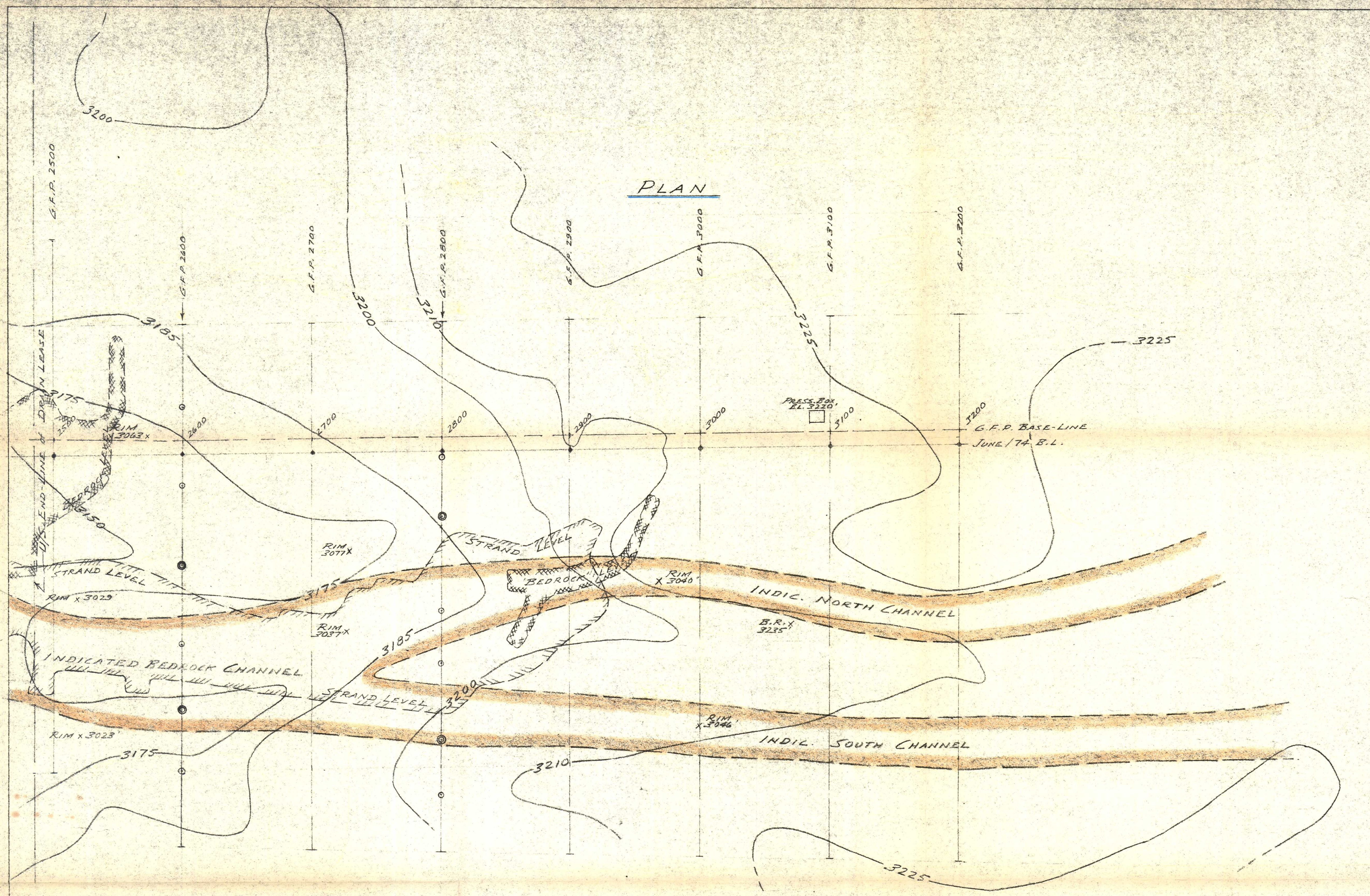

**LEGEND: SEE DWG. NO. 1-2/5**

W. M. SHARP, P.Eng. CONSULTING GEOLOGICAL ENGINEER  
NORTH VANCOUVER, B.C.

**SURPRISE RESOURCES LTD.**

**LOWER OTTER CREEK**

**ATLIN, B.C.**

**DRILL-HOLE LAYOUTS--PLAN & SECTIONS**

**GOLD-PLACER EXPLORATION & EVALUATION**

**PRINCIPAL REE GOLDFIELD PLACER, NOV. 1993**

Scale: 1" = 40' Date: AUG. 1974 Revision: Dep. No. 1-0/5

This reference scale for the map is shown in the original image. It is not to be used as a reference for the original map.



**LEGEND**

- INDICATED BOUNDARY OF BEDROCK CHANNEL
- BED ROCK LEVEL - KNOWN AND INDICATED
- OVERBURDEN DRILL (O.D.) HOLE
- CHURN-DRILL HOLE
- B.R. - BEDROCK
- U/S - UP-STREAM
- D/S - DOWN-STREAM
- G.F.P. - GOLD-FIELD PLACER (CO.)

W. H. SHARP, P. Eng. CONSULTING GEOLOGICAL ENGINEER  
NORTH VANCOUVER, B.C.

**SURPRISE RESOURCES LTD.**  
LOWER OTTER CREEK  
ATLIN, B.C.

**DRILL-HOLE LAYOUTS - PLAN & SECTIONS**  
GOLD-PLACER EXPLORATION & EVALUATION  
PRINCIPAL RIVER-GOLD-FIELD PLACER, NOV. 1933

Scale: 1" = 40' Date: AUG 1974

*Rec'd Sept 3/74  
mail*

RUTHERFORD DAY

1118 SOUTHWEST 8TH TERRACE  
FORT LAUDERDALE, FLORIDA 33315

305 / 527-0368

August 26, 1974

William M. Sharp  
Consulting Geological Engineer  
171 West Esplanade  
North Vancouver, British Columbia  
CANADA V7M 1A1

Dear Bill:

I spoke with Tom Connolly last night and he told me that Allan Mattson will be down in Vancouver in the next two weeks for a few days and that he has a very long, detailed map of the Otter Creek area. Since I previously mentioned that I would like you and he to get together this Winter, this note is to suggest that if you have time to visit him when he calls in the next two weeks, we can get things moving right along. It may be that we can develop some information that will allow us a greater understanding of what is or is not in Otter Creek. I assume he will want some money for this information and have written him about it, sending him a copy of your latest drill hole pattern on 40' centers.

Since my last letter, I have been informed by Dick McIntyre that he would like to try to make a financial placement on the Drain Lease section of Otter Creek this year. This would be based on our proposed program with General Enterprise. I don't exactly know whether the 500 yards set forth in your letter to me of June 24th is entirely on the Drain Lease or whether it goes onto some of the other Otter Creek leases. When you have a chance to sit down with Allan Mattson, please give me a call so we can keep in touch, since there is a certain amount of motion going on now and I would rather have some idea of his information relating to Otter Creek as soon as I can get it, rather than wait for a leisurely appraisal this Winter.

*2nd 1697  
1000' on  
Drain Lease  
+ 500' on  
Dam 1697  
1782*

With best personal regards I am,

Sincerely,

*Ruddy*

Rutherford Day  
RD/jt

*Rec'd Sept 3/74 accum-  
mail*

**RUTHERFORD DAY**  
1118 SOUTHWEST 8TH TERRACE  
FORT LAUDERDALE, FLORIDA 33315

305 / 527-0368

August 22, 1974

William M. Sharp  
Consulting Geological Engineer  
171 West Esplanade  
North Vancouver, British Columbia  
CANADA V7M 1A1

Dear Bill:

Thank you very much for yours of August 16 with the enclosures including your report of August 15 on the drill costs for Otter Creek which I assume will total \$31,515.00. *(O.K. = 27,000 + 4,515 = 31,515)*

Enclosed find herewith my check in the amount of \$39.50 for the exchange rate difference between U.S. dollars and Canadian funds on your bill. Enclosed also please find a copy of Leo Nimsick's letter to Atlin Placer Miners Association of July 16 to the effect that for the time being, at least, Bill 31 does not designate placer gold as one of the minerals coming under the royalties act. This is very good news, but alas, can only be left to the future with hopes the Government is going to keep things that way.

I have discovered that the small interest formerly belonging to Statesman Mining Company has been merged, with other assets, into Minerals Engineering Company of Denver, Colorado. Passing through Denver recently I had a discussion with Charles Melbye, President of Minerals, which is quite active in exploration for gold and silver and has a number of leases on the Comstock Lode at Virginia City, Nevada, as well as a 300 ton per day mill on a silver property at Creedy, Colorado which is scheduled to go into operation within the next month or so. Minerals is a public company and has left the allocation of interest to it up to my discretion. The point of mentioning all this to you is that they have a 30" diameter clamshell digger, which they have offered to lease to me with a crew of three men at \$50 per hour. I suggested we might need them for about 60 days during the period May through June, 1975. He told me that they can do about 30 feet per shift with this rig, which is mounted on a truck. Dudley Davis has some familiarity with it and recommends it highly, since a man can get down into the hole. I was hoping to raise about \$25,000 for the use of this rig and its crew and to supplement this drill program with the keystone drill which is still up at Atlin, but not yet rehabilitated, although Tom Connolly says he got it a new motor it is still not in usable condition. I pass this along so you will be able to use this in your thinking about the proposed program to block out the gold in the Drain Lease/lower Otter Creek area for the proposed program with General Enterprise Company.

The only viable alternative I can think of would be a hydraulic operation such as the one John Harvey has in the neighborhood and a picture of which was in the Northern Miner of August 8th. John has not done terribly well with his hydraulic set up, but I am informed by Tom that under Allan Mattson's supervision, the Gold

William M. Sharp

-2-

August 22, 1974

Run operation has produced at least 1,000 ounces of gold this Summer so far. This is good news indeed, and I have written Allan per the enclosed letter copy. I would hope that when the Atlin area shuts down for the Winter and Allan returns to his family in Vancouver, that you and he can get together and do a little planning on what might be necessary both at Otter Creek and at Spruce and Pine as well.

Tom Connolly reports that he has a good looking set up on Otter Creek, but that he has not been getting gold, although he expects to before the Summer is over. Currently he is moving over to Wright Creek to do the assessment work there and will follow that with some assessment work on the claims at Pine Creek on which we have no information except that in the 1936 B.C. Minister of Mines report. However, the success of the operation at Gold Run, on a different section of Pine Creek might make this lease group much more attractive especially in view of the 1936 report.

With best personal regards and hopes of talking with you before long I am,

Sincerely,

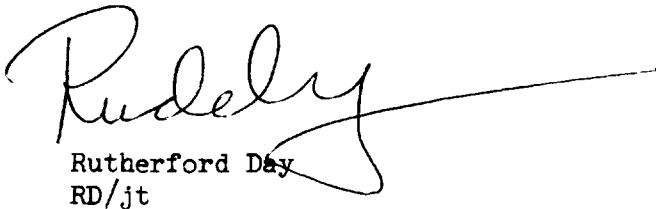
A handwritten signature in cursive script, appearing to read 'Rudely', with a long horizontal line extending from the end of the signature to the right.

Rutherford Day  
RD/jt

Encs.

RUTHERFORD DAY  
1118 SOUTHWEST 8TH TERRACE  
FORT LAUDERDALE, FLORIDA 33315

-  
305 / 527-0368

August 22, 1974

Mr. Allan Mattson  
#102 - 1835 Comox Street  
Vancouver, British Columbia  
CANADA

Dear Allan:

I am enclosing a copy of Bill Sharp's suggested drill pattern together with his drawings based on the 1939 sections of Otter Creek. I would appreciate it if you would look this over and drop me a note when you have time so I can make plans how to proceed on Otter Creek next year. I believe when I was at Atlin earlier this year you mentioned that your brother had some other drill or test results available on Otter Creek and I don't know whether you have obtained these from him or not. Tom Connolly seemed to think you would want to compensate him for these in some way and I would appreciate your letting me know if this is the case and if so, how much you would want for these.

I have not yet gotten the work promised by Messrs Klimke and Kullick, from Germany, but would assume this will arrive in due course later.

Connolly tells me that Gold Run is doing very well and I am quite pleased to hear this both for your sake and for the whole area's sake. Incidentally, I have some of the old logs, etc. on Gold Run which I got in a package from Statesman Mining Company. I don't know whether you have these or whether they are any good to you, but Dudley Davis currently has them and I don't have copies. Maybe we can work out a trade or something for your material on Otter. I plan to write Dudley about them in any event and perhaps you can call him some time and see whether you want them, as they are useless to me and I would want to help you in any way I can.

Jim Mason is planning to make some lay-outs on Spruce Creek, although he hasn't gotten around to doing so yet. I am still hoping to put together a venture there and go forward with the plans we discussed in his office which were killed by Bill 31.

Enclosed also find a few of the pictures I took. There are some more which I will send along later if they turn out.

With best personal regards I am,

Sincerely,

Rutherford Day  
RD/jt

Encs.

✓cc: William M. Sharp

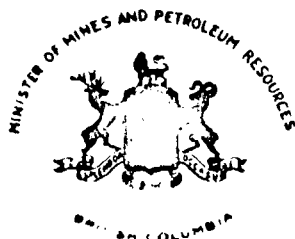

VICTORIA

VBV 452

July 16th, 1974.

Mr. John R. Harvey,  
Chairman,  
Atlin Placer Miners Association,  
ATLIN, B.C.

Dear Mr. Harvey:

I am writing in reply to your letter  
of July 4th regarding my telephone call to you.

We did not amend Bill 31 to exclude  
placer mining but we are not designating placer gold as  
one of the minerals coming under the Mineral Royalties Act  
at the present time.

I am very pleased that your group is  
happy with our decision and I wish to thank you for the way  
in which you handled the situation while I was in Atlin.  
Both Mrs. Nimsick and I were pleased with the little gifts  
you gave us when we left, especially the tie tack showing  
the pick and shovel.

Wishing you the best of luck,

Yours sincerely,

Leo T. Nimsick,  
MINISTER.

WILLIAM M. SHARP, M.A.Sc., P.Eng.  
CONSULTING GEOLOGICAL ENGINEER  
171 W. ESPLANADE, NORTH VANCOUVER, B.C.

SEPTEMBER 4, 1974

MR. RUTHERFORD DAY,  
1118 SOUTHWEST 8TH TERRACE,  
FORT LAUDERDALE, FLORIDA 33315

RE: LOWER OTTER CREEK PROGRAM.

DEAR RUDDY:

THE FOLLOWING IN REPLY TO YOURS OF AUGUST 22 & 26, 1974

FIRST, AS REGARDS THE USE OF A CLAMSHELL EXCAVATOR TO CARRY OUT TEST-WORK AT OTTER CREEK, I MUST ADMIT THAT I AM SKEPTICAL. MY PRINCIPAL DOUBTS INVOLVE COST, DEPTH VARIABILITY, SAMPLING EFFICIENCY, GENERAL EFFICIENCY, AND THE COMPANY'S POSSIBLE LIABILITY POSITION IN EVENT OF POSSIBLE ACCIDENTS-IF CREW ARE SENT DOWN THE HOLE FOR DIRECT INSPECTIONS, BLASTING, OR SAMPLING.

(A) COST: 30" CLAMSHELL DIGGER + CREW OF THREE (+ FUEL, LUBES, REPAIR PARTS?) @ \$50/HR = \$400 PER 8-HR SHIFT  
BORING (OR HOLE) COST =  $\frac{400}{30 \text{ ft.}}$  = \$13.33 PER FT.

TO THIS WOULD BE ADDED THE COST OF RE-USEABLE(?) LACING FOR WALL-SUPPORT AND WHICH I DOUBT COULD BE PROVIDED FOR LESS THAN \$2-3 PER FT.

- (B) DEPTH VARIABILITY COULD BE SEVERELY RESTRICTED BY WATER BEARING ZONES IN THE OVERBURDEN.
- (C) SAMPLING EFFICIENCY ALSO SUBJECT TO LIMITATION BY WATER.
- (D) GENERAL EFFICIENCY COULD BE SEVERELY AFFECTED BY BOULDERS. THESE WOULD REQUIRE SPECIAL BLASTING METHODS.
- (E) CLIENT LIABILITY: THIS COULD BE REDUCED BY HAVING THE WORK DONE ON AN INDEPENDENT-CONTRACT BASIS RATHER THAN ON THE CONTEMPLATED LEASE-BASIS.

BEFORE I WOULD RECOMMEND THE METHOD, I WOULD WANT A LOT MORE SPECIFIC DATA CONCERNING PAST APPLICATIONS OF THE EQUIPMENT. FOR THE TIME BEING, I WOULD BE MUCH HAPPIER STAYING WITH THE EQUIPMENT AND METHODS OUTLINED IN MY AUGUST 15<sup>TH</sup> 1974 LETTER, WITH POSSIBLE SUBSTITUTIONS OF MORE EFFICIENT DRILLING - SAMPLING EQUIPMENT THAT MIGHT BECOME AVAILABLE.

2 - SEPT 4/74

TO ANSWER YOUR QUESTION CONCERNING THE 500-YD FIGURE IN MY JUNE 24/74 ESTIMATE, TWO THIRDS OF THIS WOULD LIE WITHIN THE 'DRAIN' LEASE (P.M.L. 1697), AND ONE-THIRD IN THE UP-STREAM-ADJOINING 'DAN' CLAIM (P.M.L. 1782). HOWEVER, THE CENTER-LINE OF EXCAVATION WOULD PARALLEL THE DRAIN LEASE LOCATION-LINE AND ITS UP-STREAM PROJECTION - THUS DEPARTING FROM THE 'DAN' LOCATION-LINE IN THE U/S DIRECTION.

REGARDING A MEETING WITH ALLAN MATTSOON DURING HIS FORTHCOMING VISIT TO VANCOUVER, I WOULD BE PLEASED TO DO THIS, IN THIS CONNECTION. I WOULD APPRECIATE IT IF YOU AND HE COULD SPECIFY JUST WHEN HE MIGHT ARRIVE IN VANCOUVER AND LET ME KNOW IN ADVANCE. I HOPE THIS WOULD BE AFTER A FIELD TRIP CURRENTLY BEING DISCUSSED WITH ONE OF MY CLIENTS.

JOHN HARVEY APPEARS TO HAVE REAL POTENTIAL AS A DIPLOMAT. PERHAPS WE SHOULD KEEP HIM IN MIND FOR FUTURE NEGOTIATIONS - IF SUCH APPEAR NECESSARY!

WILL LOOK FORWARD TO HEARING FROM YOU -

WITH BEST PERSONAL REGARDS,

YOURS SINCERELY,

Bill

(W.M. Sharp, P.Eng.)

1342  
38/404

Sept 4/74.

P.S. Transfer cheque for \$29.50 -

30" diam clamshell digger <sup>crew of three</sup> @ 50/hr. - \$400/8hr shift  
Reported performance - 30'/shift  
Estimated cost - - \$13.33 per ft.

Q. does this cost include a provision for wall support to preclude the strong possibility of

- (a) burying a man down the hole by reason of collar or wall sluffing?
- (b) Exposing the man to injury by falling cobbles or boulders which would be expected within at least some sections of the overburden?

I would suggest that you ask Dudley for a full description of the physical characteristics of the ground, and depth of holes excavated where he has presumably seen the clamshell-boring method employed, and also what means were employed to assure that a man could get in and out of the hole safely. Having this, we could ascertain the applicability of the method to the Otter Creek job, and whether or not it could be expected to return better results at lower costs than the conventional churn-drilling.

In reply to your Aug 26 letter, Paddy, I would be pleased to meet with Alan Matheson during his next visit to Vancouver; and I will certainly try to fit this in with my current field schedules if I know when he plans to be in town.

P.S. John Harvey appears to have read pt'l of a different

RUTHERFORD DAY  
1118 SOUTHWEST 8TH TERRACE  
FORT LAUDERDALE, FLORIDA 33315

305 / 527-0368

October 22, 1974

Mr. William M. Sharp  
3280 Chesterfield Avenue  
North Vancouver, British Columbia  
Canada V7N 3M9

Dear Bill:

Thank you for the copy of the assessment report for the Drain Lease and Lower Otter Creek. I would appreciate it if you would burn off sepias of your drawings numbers O-1, O-2, 1-D/S and 1-U/S. With the sepias I can duplicate as many drawings as necessary here in Florida.

At the recent American Mining Congress Meeting in Las Vegas I bumped into Dick Norton from Canadian Mine Services who was very friendly and asked for some help on a matter. I told him that I would still be happy to make a deal with his company on a joint venture basis for placer mining on any of the creeks near Atlin. I believe the previous discussions between me and Canadian Mine Services related only to Wright Creek, but it seems Wright Creek would be either second or third to be developed. Therefore, if they should ask, please give them access to any of your reports as I will be writing them very shortly and will be sending them a package on the three main creeks.

With best personal regards and hopes this letter will find you well and happy I am,

Very truly yours,

*Ruddy*

Rutherford Day  
RD/jt

p.s. I notice your return address has been changed from 171 West Esplanade to the above Chesterfield Avenue address. Please let me know where you would like future correspondence directed.

PPS - I notice on your reports you don't have an estimate of amt of cu. yds on Upper & Lower Otter/Drain Lease. I remember you estimated lower Otter/Drain @ 58 cu yds @ PAY STAK - Give me a Ball Park over -

WILLIAM M. SHARP, M.A.Sc., P.Eng.  
CONSULTING GEOLOGICAL ENGINEER  
~~171 W. ESPLANADE, NORTH VANCOUVER, B.C.~~  
3280 CHESTERFIELD AVE., NORTH VANCOUVER, B.C.  
VTN 3M9

Nov. 5, 1974

Mr. Rutherford Day, Pres.,  
Surprise Resources Ltd., (N.P.L.),  
1118 Southwest 8th Terrace,  
Fort Lauderdale, Florida 33315

Mar/75 - See also Daily report of Oct/74

Dear Ruddy:

The following estimates of Otter Creek placer reserves are based on churn-drill and underground sample data provided by the old company map-prints #1 and #4. Grade estimates are based on a gold price of \$160 per oz.

A) Probable Reserves

1. Within Drain Lease, over base-line interval 13+00- 25+00:  
(= the up-stream half of the claim)  
Below pit-floor =  $(60 \times 27 \times 400)$  yds. = 648,000 c.y. @ \$12.34 per c.y.  
*(Using Daily X-sec. = 720,000 c.y. - 28,309 = 691,691 c.y. @ \$4.35/cy)*
2. Up-stream of Drain Lease @ 25 + 00 - 31 + 00:  
Below pit - floor horizon =  $(60 \times 27 \times 200)$  yds = 324,000 @ \$12.34/c.y.  
Above " " " =  $(100 \times 30 \times 200)$  yds = 600,000 @ \$0.686/c.y.  
Total Probable Reserves = 1,572,000 c.y. @ \$7.90 per c.y.  
*(Using Daily X-sec. = 720,000 c.y. @ \$0.686/cy)*

B) Possible Reserves

(Based on gross X-sect. @  $3000 \times 0.686 + 1620 \times 12.34$ , for \$4.77/c.y.)  
For channel-interval 31 + 00 - 55 + 00,  
=  $(4620 \times 800)$  c.y. = 3,496,000 c.y. @ \$4.77 per c.y. *(or 2.00/c.y. per Daily)*

SUMMARY

Estimated gross reserves over 13 + 00 - 55 + 00 (0.8 mi.) = 5,068,000 c.y.  
The gross-length of the drilled-interval, or area, is about  $1\frac{1}{2}$  mi.  
For this, Mr. Dudley Davis (Feb., 1974) has estimated a total potential of 8,153,820 c.y. - which, on the basis of the above estimates and the additional length of only superficially-tested ground, appears very reasonable.

Respectfully submitted,

W.M. Sharp, P.Eng.

copy these pages

NOV 5/74

DEAR RUDDY:

RE LETTER ESTIMATES OF THIS DATE

THESE, AS PREVIOUSLY, ARE BASED ON THE DATA CONTAINED IN THE OLD MAP-PRINTS PROVIDED. WHEN THE RECOMMENDED DRILLING HAS BEEN CARRIED OUT, I EXPECT WE WILL BE ABLE TO SEGREGATE THE CURRENT VOLUME-GRADE FIGURES, AND PROVIDE MORE ADEQUATELY-BASED FEASIBILITY ESTIMATES.

YOU NOTED THAT MY REPORTS DO NOT HAVE AN ESTIMATE OF CU.YDS. ON UPPER AND LOWER OTTER / DRAIN LEASE (?).

I PURPOSELY EXCLUDED THESE FROM MY RECENT ASSESSMENT REPORT, BECAUSE THEY ARE NOT FORMALLY REQUIRED ON THESE AND BECAUSE MOST CLIENTS DON'T WANT THEM TO BECOME COMPLETELY 'PUBLIC' AS THEY WOULD AS A MATTER OF COURSE. HOWEVER, YOU WILL REMEMBER <sup>I RECENTLY PROVIDED</sup> THAT A VOLUME-GRADE ESTIMATE FOR THE 15400-30400 INTERVAL OF THE BASE-LINE INCL. UP-STREAM HALF ~~+ 500 FT. OF~~ OF THE DRAIN LEASE PLUS AN ADDITIONAL 500 FT. OF CHANNEL-LENGTH - COMRAISING THE INTERVAL WHICH HAS BEEN MOST ADEQUATELY DELINEATED BY PAST EXPLORATION AND MINING.

I WOULD LIKE TO HEAR, FROM YOURSELF OR TOM AND SHIRLEY, AS TO HOW THE LATTER MADE OUT IN SUBMITTING MY SEMI-GEOPHYSICAL REPORT - JUST FOR FUTURE GUIDANCE. WISHING YOU THE BEST IN REGARD TO YOUR EFFORTS AT FINDING A GOOD JOINT-VENTURER!

YOURS SINCERELY, Bill

(W. M. Sharp)

ENCL

WILLIAM M. SHARP, M.A.Sc., P.Eng.  
CONSULTING GEOLOGICAL ENGINEER  
171 W. ESPLANADE, NORTH VANCOUVER, B.C.

(Nov. 4/74)

DEAR RUDDY:

WITH THIS THE REQUESTED SERIA PRINTS - PRINTED IN 'REVERSE' TO FACILITATE ALTERATIONS OR CHANGES, IF SUCH SHOULD BE NECESSARY AT A LATER DATE. MY SLIGHTLY SMUDGY AND FAINT PENCIL-ORIGINALS OF 1-D/S AND 1-U/S WOULD NOT SUFFICE, SO I INKED BOTH PRIOR TO HAVING THE SERIAS MADE. SO - WHAT WAS SAVED ON THE ORIGINALS WAS SPENT IN PRODUCING ADEQUATE PRINTS. ALSO, SOME PERTINENT DETAIL WAS ADDED AND MINOR CHANGES MADE TO 1-D/S DURING THE PROCESS. D-1 & D-2 WERE O.K. AS-IS (INKED ORIGINALS).

I WILL PROVIDE THE REQUESTED (U-D) ESTIMATES BY SEPARATE LETTER, AND AS SOON AS I CAN FASE INTO THE APPROPRIATE 'BALL-PARK' FRAME OF REFERENCE/PERSPECTIVE.

THUS FAR, NO WORD FROM THE CONNOLLYS AS TO HOW THE MAPS OUT WITH THE MINING RECORDER (NEWELL?) IN SUBMITTING MY REPORT FOR ASSESSMENT CREDITS. THE FACT THAT ~~THAT~~ A SEMI-GEOPHYSICAL REPORT WAS PREPARED AND SIGNED BY A GEOLOGICAL ENGINEER MAY HAVE CAUSED THAT PARTICULAR GENTLEMEN TO HESITATE.

Bill

WILLIAM M. SHARP, M.A.Sc., P.Eng.  
CONSULTING GEOLOGICAL ENGINEER  
3280 CHESTERFIELD AVENUE  
NORTH VANCOUVER, B.C. V7N 3M9

February 22, 1975

Mr. Rutherford Day, Pres.,  
Surprise Resources Ltd., (N.P.L.),  
1118 Southwest 8th Terrace,  
Fort Lauderdale, Florida 33315

Dear Ruddy:

With this, some comments relevant to your Atlin program.

Firstly, I wrote for and received the literature mentioned by you. Since then, I have made several enquiries in regard to the relative capabilities of the two types of drills furnished by the Becker organization - in respect of the evident and probable overburden/bedrock sections that exist on your Otter and Wright Creek placer prospects. As a result, I would judge that Becker's 'C.S.R.' type of drill would have superior sampling capabilities. Also, I would guess that the associated unit drilling costs would be less than those for churn-drilling - except on a very limited drilling program. On the basis of Becker's own specifications, I would judge that their C.S.R.-250 model would be adequate.

Secondly, I responded to Tom Connelly's request for "a little sketch of Spruce, outline what you think the extent of the pay is, on Ruddy's claims, values as you recall them from Mattson's reports, depth to bedrock, etc." by sending him a note and a print of the map contained in the 1936 Minister of Mines' Report. With this I observed (as he should fully realize) there is no way, short of stealing or photographing Mattson's maps, that I could possess any more specific data than is contained in the 1936 map - lacking a built-in depth-sensor or an amazing degree of "photographic recall!" As you will realize, he was (inadvertently) expressing the "exploration problem", and the desirability of acquiring Mattson's data, via his letter!

Thirdly, I have just recently been able to have a satisfactory talk with Len White, relevant to your pre-Christmas phone-call. He has indicated a cordial interest in looking at our existing Otter Creek data, my interpretations of these, and my proposals concerning exploration of your Atlin properties. Consequently, I will pursue this matter - probably during the first week of March, if such course of action still seems favourable to all concerned.

Tomorrow, I am departing Vancouver for a week's field work in southern California and a nearby part of Arizona.

With best regards, *Bill*

(W.M. Sharp)  
W.M. Sharp, P.Eng.

*copy this*

Invoice attached (under)

TEL: BUS. 987-5322  
RES. 987-9520

WILLIAM M. SHARP, M.A.Sc., P.Eng.  
CONSULTING GEOLOGICAL ENGINEER  
1680 LLOYD AVENUE  
NORTH VANCOUVER, B.C. V7M 1R6

NOVEMBER 12, 1975

MR. RUTHERFORD DAY, PRES.  
SURPRISE RESOURCES LTD.,  
1118 SOUTHWEST 8TH TERRACE,  
FORT LAUDERDALE, FLORIDA 33315

DEAR RUDDY:

PLEASE FIND ENCLOSED A PRINT OF DWG. NO. G.P.-1  
PER YOUR REQUEST AT ATLIN. I HAVE ALSO SPOTTED  
(RED CIRCLES) THE LAYOUTS OF THE 2 HOLES - REQUESTED  
AT THE SAME AS THE ABOVE NOTED DETAIL.

I HAD HOPED TO HAVE MY ATLIN NOTES (LOANED TO  
JIM WALLIS) PLUS J. WALLIS' COMPILATIONS OF THEM ON  
HAND TO AID IN SPOTTING THE UP-STREAM HOLE AT LEAST.  
HOWEVER, I NEVER DID GET ANYTHING FROM HIM - IN  
SPITE OF THE FACT THAT HE HAD 6 WEEKS IN WHICH TO  
INTERPRET AND MAIL THIS INFORMATION BEFORE THE  
START OF OUR CURRENT NATIONAL MAIL STRIKE.

ON OCTOBER 2, 1975 YOUR SECRETARY (JILL A. TERRELL)  
SENT ME A LETTER ACKNOWLEDGING THE RECEIPT OF  
MY SEPT. 18TH/75 LETTER AND ENCLOSED INVOICE. IN THIS  
SHE NOTED THAT YOU WOULD BE RETURNING FROM  
WASHINGTON, D.C. AROUND OCTOBER 15, 1975, AT WHICH  
TIME YOU WOULD CONTACT ME. ??

WITH BEST REGARDS,

YOURS TRULY, 'Bill'

(Wm Sharp)

ENCL.

SURPRISE  
LAKE  
(MEAN WATER LVL. 2985')

4 1/2' SHAFT #249  
40' DEEP P. 3019 EL.  
SUBSIDIARY  
15' VIA DRAIN-HOLE  
DEBRIS NOT  
ENCOUNTERED.

U.S. LIM. OF WORKING  
(BEDROCK LEVEL)

ARBITRARILY ESTABLISHED CHANNEL-BEDROCK  
CUT-OFF (LATE PLEISTOCENE EROSION) 5150

INDICATED

INDICATED

INDICATED

INDICATED

INDICATED

INDICATED

INDICATED

INDICATED

INDICATED

B.H.

FRENCH  
CAMP

B.H.

C.H.

DWG No. GP-1  
GOLDFIELD PLACERS LTD.  
PLAN SHOWING  
CONTOURS AROUND MAIN PIT  
AT  
OTTER CREEK, ATLIN AREA, B.C.  
SCALE: 1"=100' NOV. 15, 1939  
ENLARGED BY PANTOGRAPH-MAY, 1974  
CHECKED, INKED, & PRINTED NOV, 1975  
LEGEND:  
BEDROCK OR RIM  
TOE OF PIT WALL  
OUTLINE OF BEDROCK LEVEL  
CONTOUR LINE (3200' ELEV.)  
BROW OF BEDROCK DROP-OFF  
ABBREVIATIONS:  
B.R. BEDROCK ELEV.  
U.S. UP-STREAM  
GFP GOLDFIELD PLACERS LTD. (BASE-LINE STA.)  
W. H. Sharp, P. Eng.

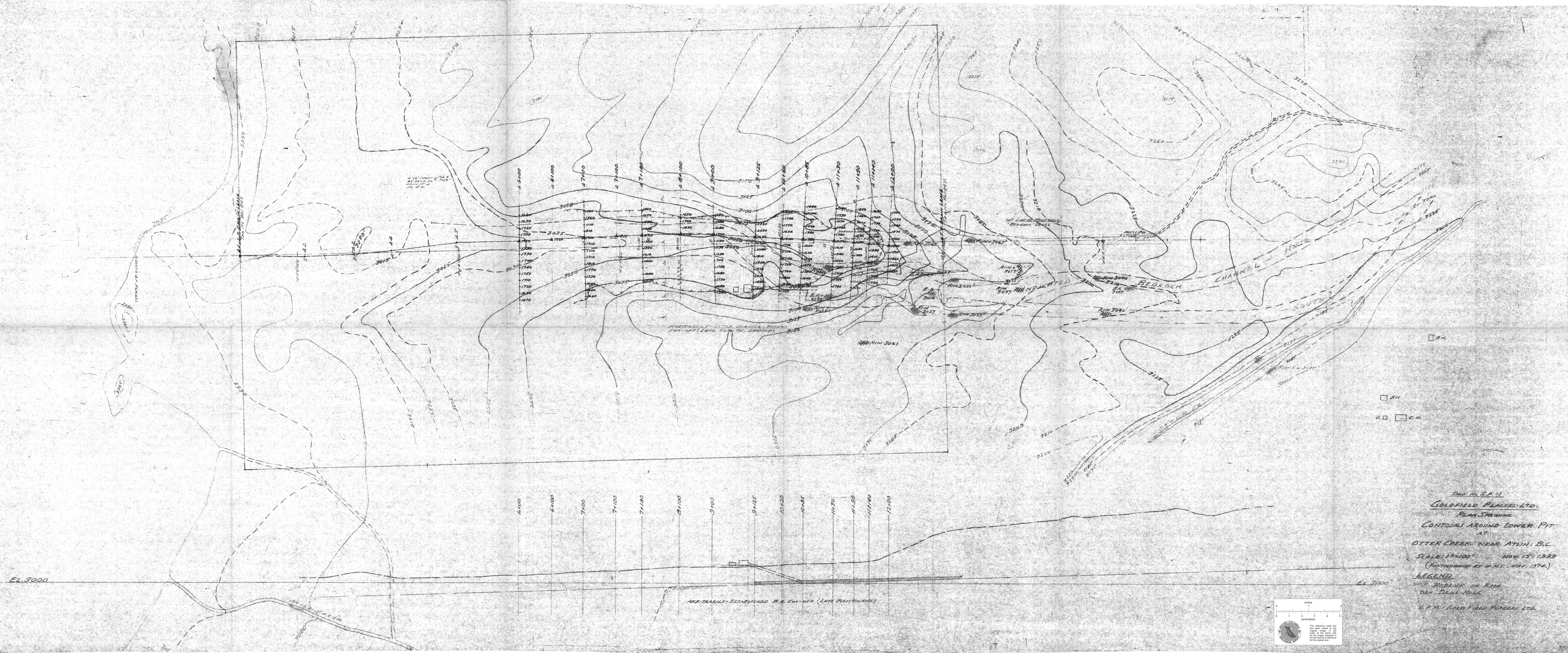

DWG No. G.P.P.-1  
GOLD FIELD PLACERS LTD.  
PLAN SHOWING  
CONTOURS AROUND LOWER PIT  
AT  
OTTER CREEK, NEAR ATLIN, B.C.  
SCALE: 1"=100' NOV 15, 1939  
(REWORKED BY W.M.S. MAY 1974)  
LEGEND:  
BEDROCK OR RIM  
DRILL HOLE  
G.P.P. GOLD FIELD PLACERS LTD.

