

CROW PAT MINERALS LTD  
 DIAMOND DRILL HOLE No 2  
 CLEAR WATER B.C.  
 SCALE 50' = 1"

680288

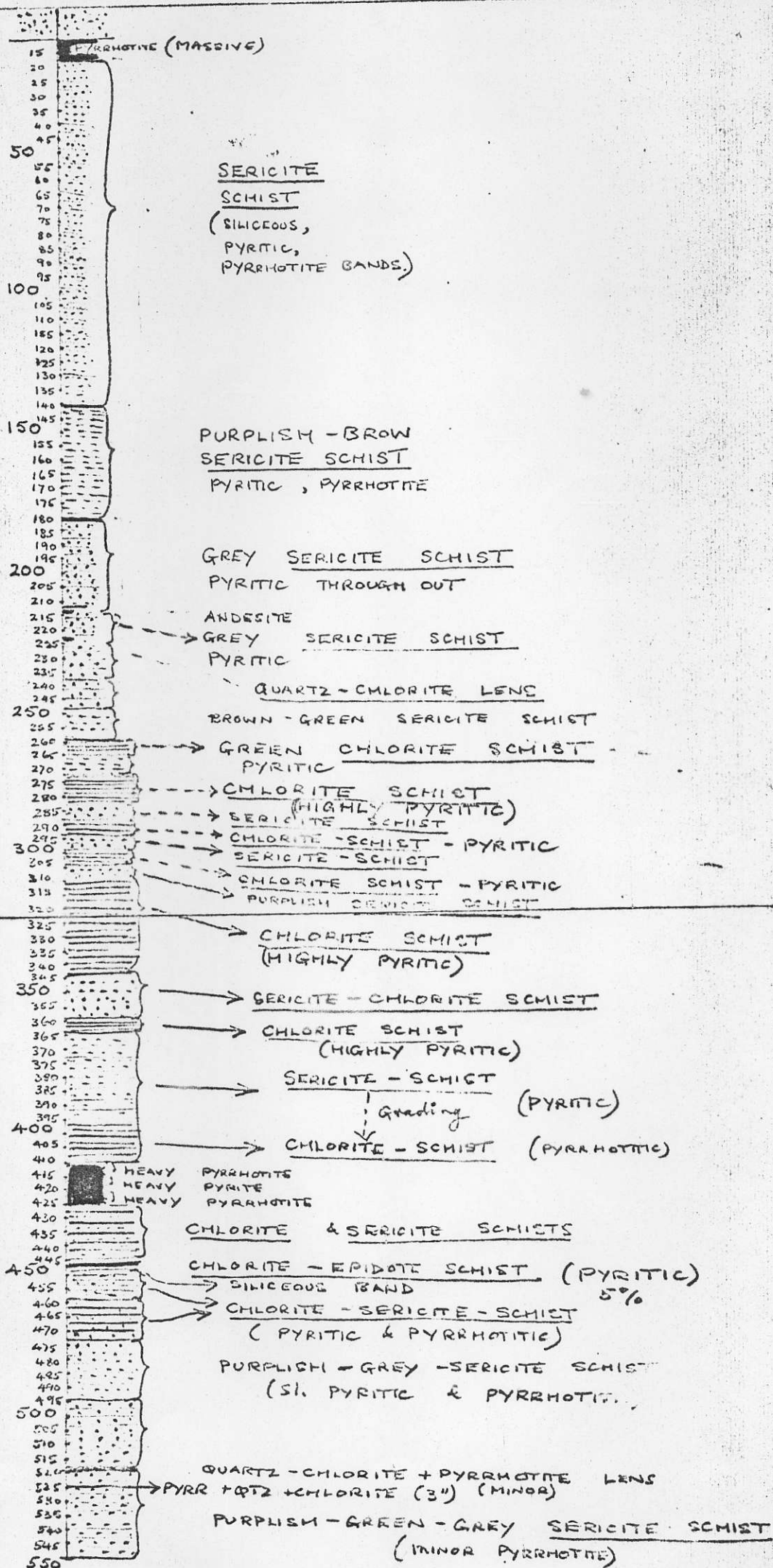

NORTH

BASE LINE

SOUTH

COLLAR D.D.H. No 3

COLLAR D.D.H. No 2

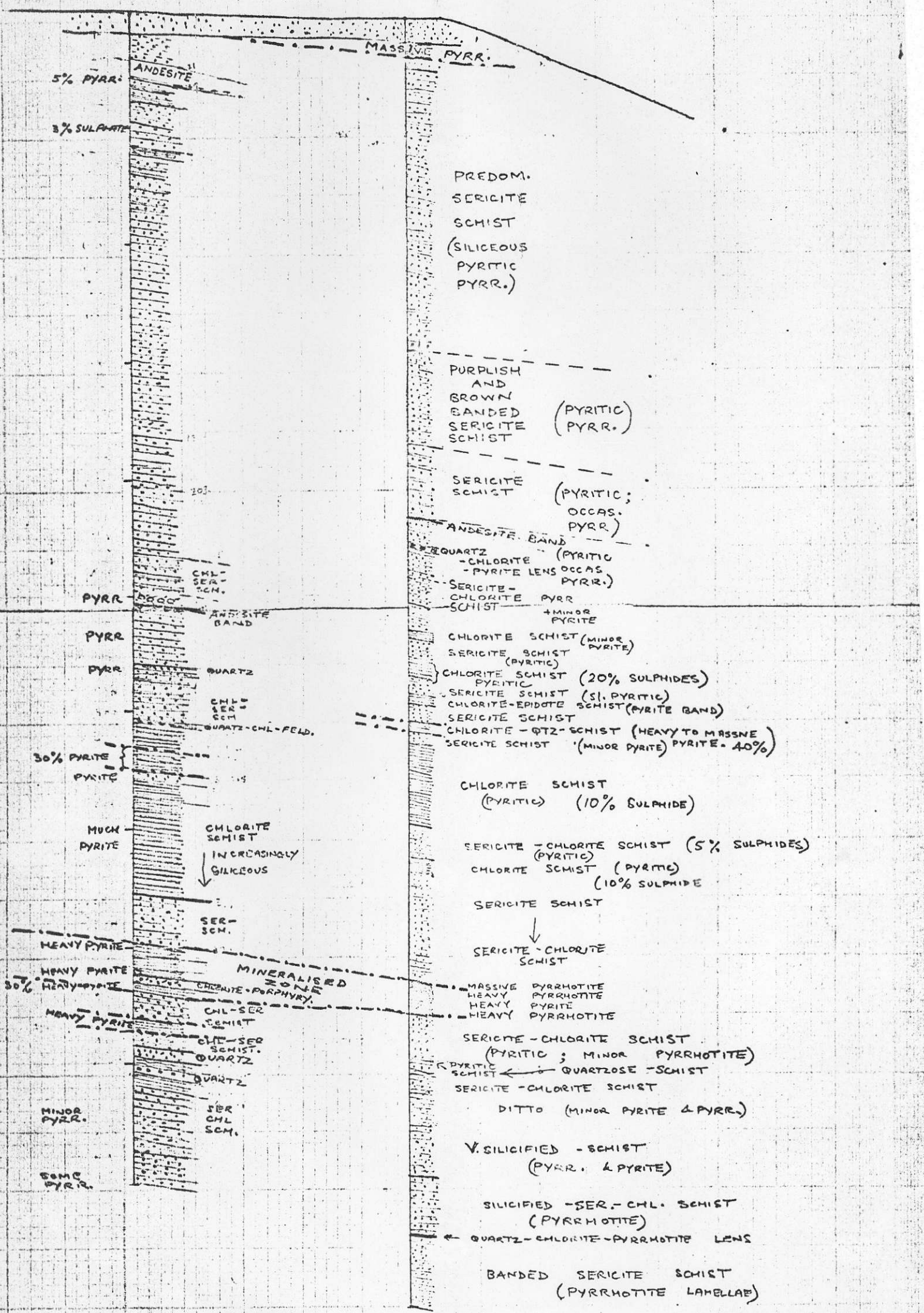

CROWPAT MINERALS LTD  
 SECTION OF DRILL HOLES  
 No 2 AND 3.  
 DECEMBER 1966 DRAWN: T.B.S.  
 SCALE 1" = 50'



L  
N

1" = 2 UNITS

• CROWPAT DRILL HOLES

1966 - CROWPAT 2000' DRILLING  
1971 - CALRAY 1200' DRILLING (BUILT MILL?)  
1975 - STAKED BY KEIR-DAWSON.

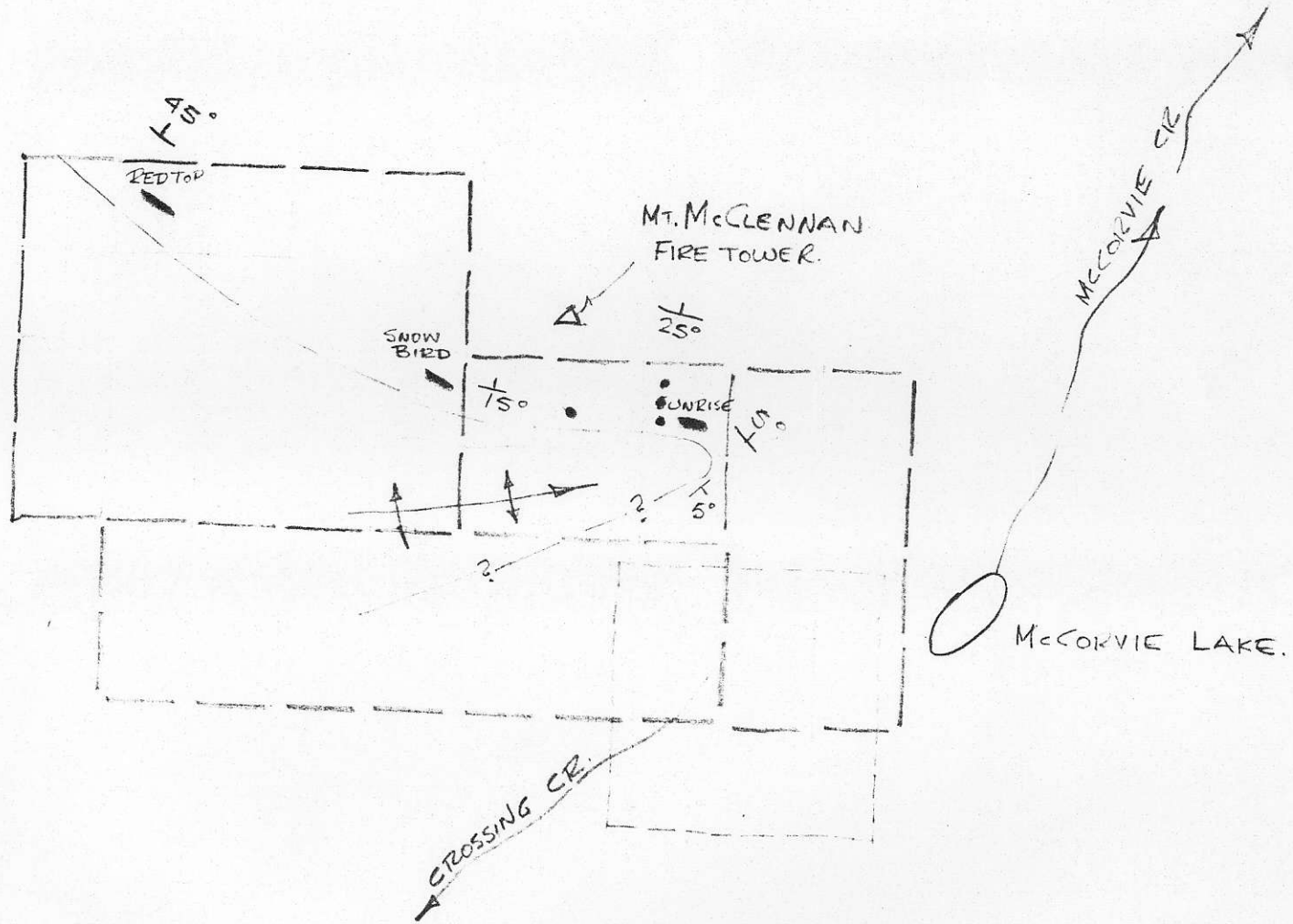

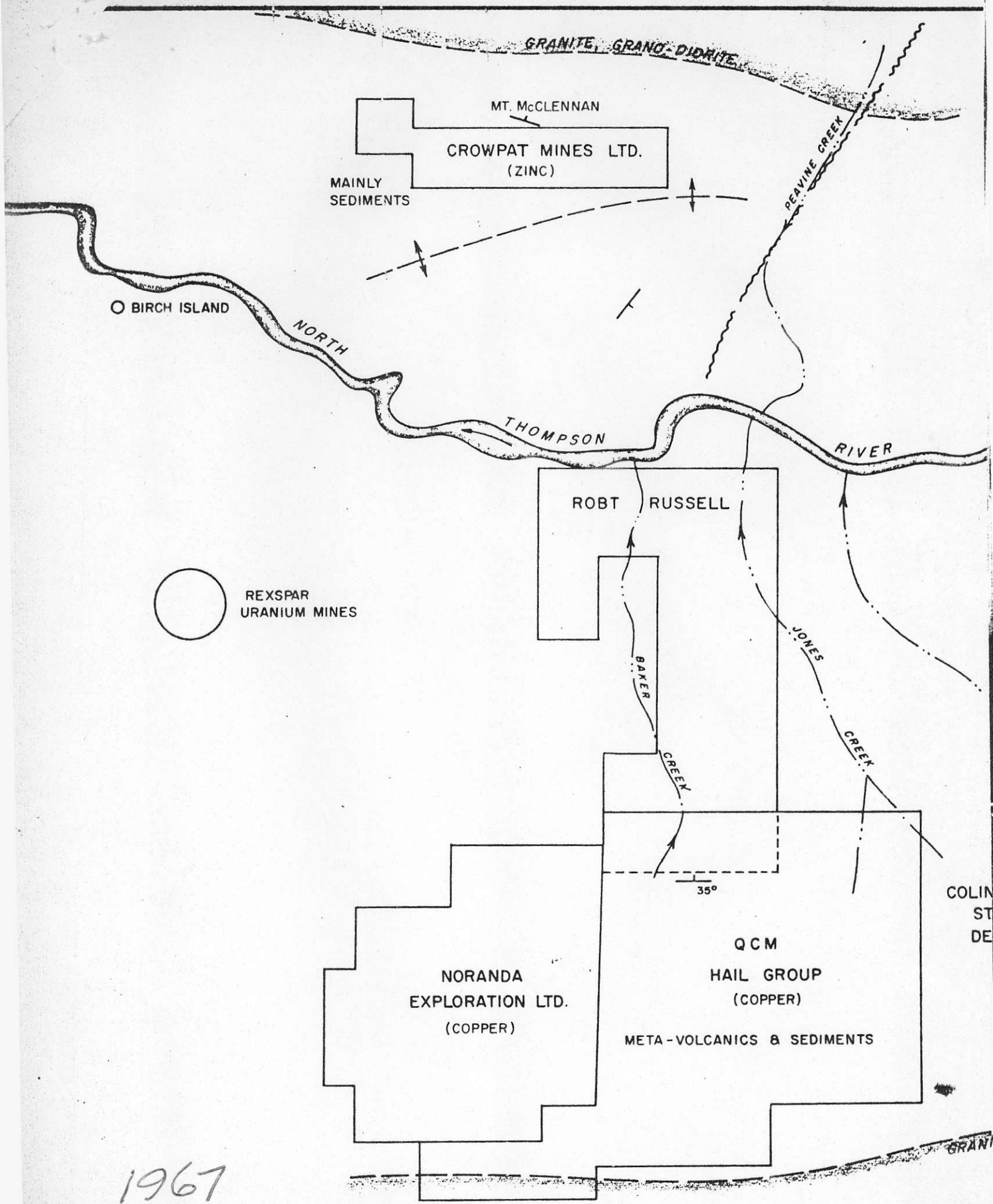

1967