

676129  
93H/4**INTERNATIONAL WAYSIDE GOLD MINES LTD.**7305, 455 Granville Street  
Vancouver, British Columbia, V6C 1T1Telephone (604) 669-6463  
Toll Free: 1-800-663-9688  
e-mail: [info@wayside-gold.com](mailto:info@wayside-gold.com)Fax (604) 669-3041  
[www.wayside-gold.com](http://www.wayside-gold.com)  
CDNX Symbol: "IWA"**News Release 01-10  
Bonanza Ledge Extended**

June 6, 2001

Godfrey Walton P. Geo., VP Exploration has reported to the Board of Directors that the Company has started the 8<sup>th</sup> hole of its 2001 drill program at the Cariboo Gold Project near Wells, BC. The first 4 holes of the program were designed to drill beneath soil gold anomalies and establish the stratigraphic section, structural setting, alteration and mineralization from the hanging wall of the BC Vein through the Bonanza Ledge zone to the Canusa Vein, which is directly grid south of the Bonanza Ledge. Drill holes 5 through 7 were step outs from the known mineralization at Bonanza Ledge. The location of the holes and the intersections are outlined on the attached plan and summarized in the table (set out below).

Holes BC01-1 through 4 on section 20200E, intersected dolomite and/or muscovite altered zones over a distance of 1000 feet from the edge of the Bonanza Ledge (see map). These intersections appear to be similar to the peripheral alteration seen at the Bonanza Ledge. These areas of alteration are being evaluated and further drilling is planned. In addition, two intersections in BC01-3 were obtained from the Canusa Vein (0.16 oz/ton Au over 1.7 feet) and an adjacent vein (1.13 oz/ton Au over 1 foot). The Canusa Vein, a strike vein similar to the B.C. Vein, is 9.5 feet wide in drill hole BC01-3.

Hole BC01-5, on section 20500E, drilled grid north towards the BC Vein was a 100-foot step-out to the southeast from the previously defined limit of the Bonanza Ledge and is on the same section as BC2K-35, 36 and 37. Although holes BC2K-35, 36 and 37 returned weak alteration and anomalous gold values, hole BC01-5, contained blocks of Bonanza Ledge style alteration and mineralization. BC01-05 was drilled at an acute angle into a fault, which was intersected for over 300 feet. The strongest altered and mineralized intersection is 0.38 oz/ton Au over 2 feet. Company geologists are encouraged with this intersection, as it demonstrates the Bonanza Ledge mineralization extends beyond previously defined limits. The orientation and offset of this fault is not known at this time, however it is believed to be similar to other faults in the camp. Once the altitude of the fault has been established, future drill holes will be targeted with a higher level of confidence. In addition, the BC Vein was intersected in drill hole BC01-5 at approximately 400 feet below surface and contained 4.5 feet with anomalous gold values. The BC Vein has now been traced for over 2800 feet along strike.

Drill Hole	Interval(ft)	Length(ft)	Assay g/t Au	Assay oz/t Au	Northing	Easting	Elevation	Azimuth	Inclination	DIT Length
BC01-01			No significant assays		2395	20202	4775	227 <sup>0</sup>	-69 <sup>0</sup>	720
BC01-02			No significant assays		2393	20202	4775	223 <sup>0</sup>	-45 <sup>0</sup>	1260
BC01-03	75.7-76.7	1	38.84	1.133	1910	20190	4718	222 <sup>0</sup>	-45 <sup>0</sup>	590
	294.0-295.7	1.7	5.37	0.157						
BC01-04			No significant assays		2801	20206	4849	223 <sup>0</sup>	-80 <sup>0</sup>	410
BC01-05	101.8-103.8	2	13.04	0.38	2396	20500	4756	43 <sup>0</sup>	-38 <sup>0</sup>	700
BC01-06			Sampling in progress		2770	21000	4780	224 <sup>0</sup>	-49 <sup>0</sup>	590
BC01-07			Logging and sampling in progress		2770	21000	4780	224 <sup>0</sup>	-70 <sup>0</sup>	920
BC01-08			Drilling		2770	21000	4780	43 <sup>0</sup>	-50 <sup>0</sup>	

\*All collars have not been surveyed.

On behalf of the Board of Directors,

  
J. Frank Callaghan  
President

The Canadian Venture Exchange has neither reviewed nor accepts responsibility for the adequacy or accuracy of this release.

# INTERNATIONAL WAYSIDE GOLD MINES LTD

# CARIBOO GOLD PROJECT

## BONANZA LEDGE ZONE

## BC2K DRILL PLAN

## ASSAYS BC2K-15 TO 19

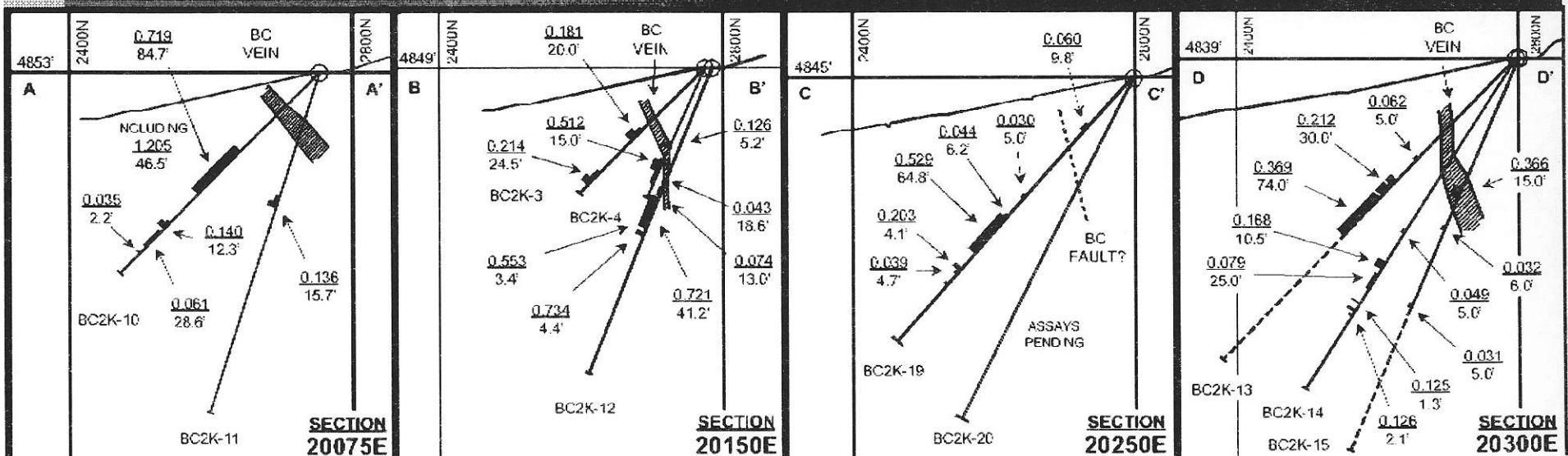
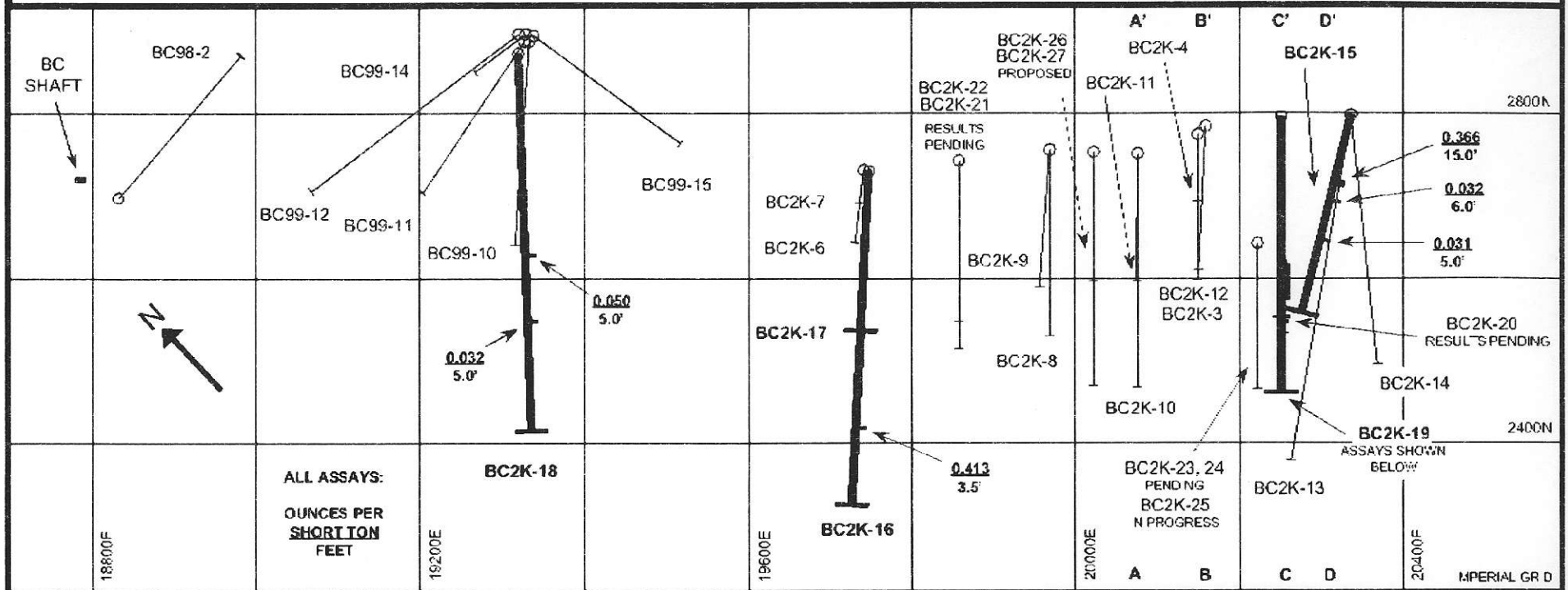

# INTERNATIONAL WAYSIDE GOLD MINES LTD

# CARIBOO GOLD PROJECT

BONANZA LEDGE ZONE

BC01-01 to 08 DRILL PLAN

News Release, June 6, 2001

