

936/154 PE

Map of Mineral Claims staked in Ahbau lake district of Cariboo Mining Division 1933

Paul Jensen

Legend:

- Creek
- Cabin
- Especially good outcroppings
- Claim boundary
- Placer lease
- Trail

Compass bearing for Line A Due W.
 - - - Line B N50°W.
 - - - Line C N 5°E.



Scale:

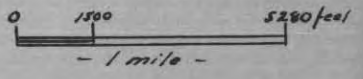

The area from Nixon Creek to 1/2 mile N.W. of Lodi Lake is staked.

Maxwell Creek Canyon staked by Major Haggarty party from Williams Lake

About 60 claims staked between Lodi Lake and Willow River

4 placer leases (stakings) Holders: Taylor and Johnson from Prince George

Ross pass from Ahbau Lake to Willow River is staked for placer and partly for hard rock

The E. side of Ahbau Lake is supposed to be covered with about 70 claims

Old tunnel in this area. All staked.

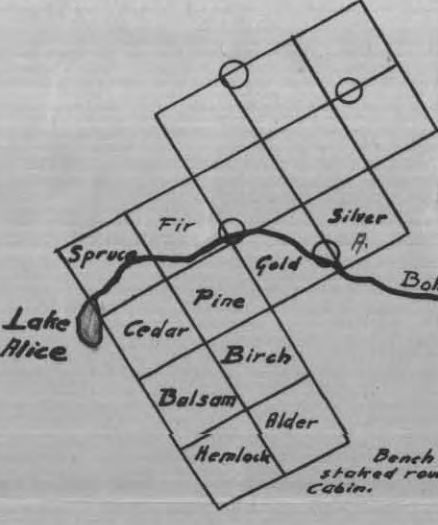
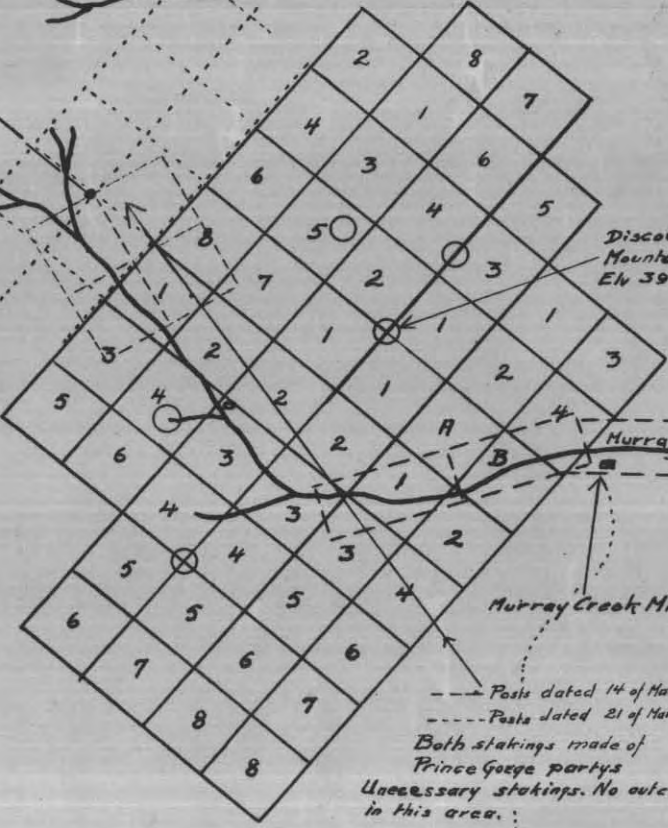
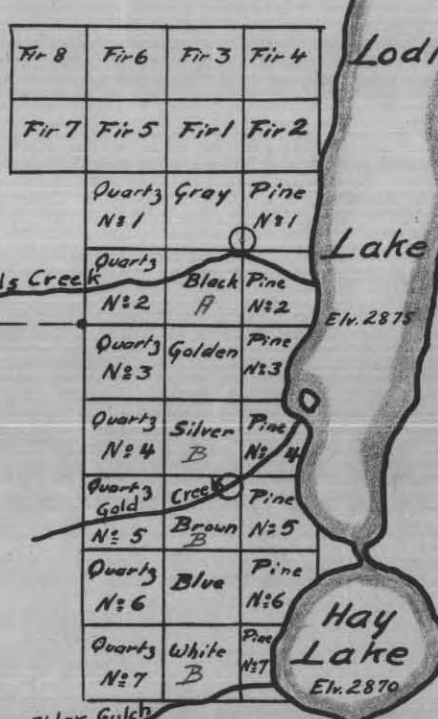
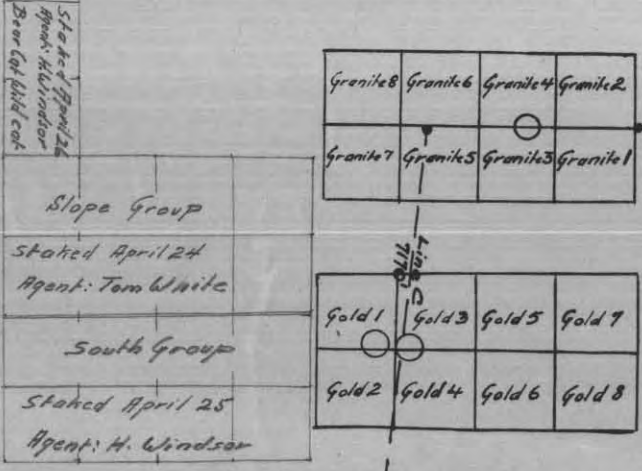

The area from the south and of Ahbau Lake in N.W. direction to Canyon Creek is supposed to be staked

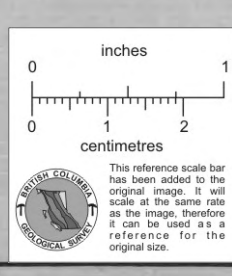

936057. PROPERTY FILE

014695