

NAME *01 BIBLIO*

**MINISTRY OF ENERGY, MINES AND  
PETROLEUM RESOURCES**  
VICTORIA, BRITISH COLUMBIA

SUBJECT

RIVERSIDE

82ESE114

*SUB*  
FILE No. *01*

**001276**

**PROPERTY FILE**

~~original and opportunity~~ *Jan 9/76*

MINERAL DEPOSIT INVENTORY

Map No. 82 E/SE-114

Property No. \_\_\_\_\_

Metal  Industrial Mineral  Placer  Coal  Lapidary

Name: RIVERSIDE

Claim Mineral lease 415 (may also cover?)  
Operator ALBERNI MINES LTD. Owner ALBERNI MINES LTD. Year(s) 1976

Claim Consists of Riverside L. 1031  
Operator "H.R." L. 1033 Owner \_\_\_\_\_ Year(s) \_\_\_\_\_  
Riverside No. 2 Fr. L. 2605A

Claim \_\_\_\_\_ Owner \_\_\_\_\_ Year(s) \_\_\_\_\_  
Operator \_\_\_\_\_

Location: N.T.S. 82 E/RW Lat. 49° 07' Long. 118° 58' U.T.M. \_\_\_\_\_  
M.D. Greenwood In park \_\_\_\_\_ E. & N.  El. 800 M  
Loc. plot. \_\_\_\_\_ Source \_\_\_\_\_ Prec. 1

Status: Producer  Dev. Prospect  Prospect  Showing

Production: Tons \_\_\_\_\_ Grade: Au \_\_\_\_\_ Ag \_\_\_\_\_ Cu \_\_\_\_\_ Pb \_\_\_\_\_ Zn \_\_\_\_\_  
Others \_\_\_\_\_ Year(s) 1907, 1913, 1933 *see bluebook*  
Reserves: Tons \_\_\_\_\_ Grade \_\_\_\_\_ Year \_\_\_\_\_  
Tons \_\_\_\_\_ Grade \_\_\_\_\_ Year \_\_\_\_\_  
Tons \_\_\_\_\_ Grade \_\_\_\_\_ Year \_\_\_\_\_

Development: Surface \_\_\_\_\_  
Underground adit (260'), 2 shafts, 2 stopes; 1 adit (?)  
Drilling \_\_\_\_\_  
Surveys: Geol. \_\_\_\_\_ Geophys. \_\_\_\_\_ Geochem. \_\_\_\_\_

References: M.M.A.R. 1913, 1922, 1921-186, 188; 1938, D 23  
G.E.M. 1976-E22, 1977-E17, Expl. Form (10-11 form March 1976.); 1976  
As. Rpt.: L.C. \_\_\_\_\_ Prosp. \_\_\_\_\_ D.D. \_\_\_\_\_ Other 1766 type? 2882  
Geol. \_\_\_\_\_ Geophys. \_\_\_\_\_ Geochem. \_\_\_\_\_  
Geol. and maps GCNL #24 (1976); GSC Map 1957-61

Summary description Consists of 2 vein systems.  
\_\_\_\_\_  
\_\_\_\_\_  
\_\_\_\_\_

Attitude of deposit: Strike \_\_\_\_\_ Dip \_\_\_\_\_ Azimuth \_\_\_\_\_ Plunge \_\_\_\_\_  
Size: Length \_\_\_\_\_ Width \_\_\_\_\_ Depth \_\_\_\_\_

Minerals \_\_\_\_\_  
Economic minerals \_\_\_\_\_  
Assays see GCNL # 24 (1976)

Remarks Located 3 1/2 miles north of Rock Creek on the east bank of the Kettle River.  
Up to 1921, 2 veins had been partly developed + mined.  
- see GCNL # 24 Feb 5th, 1976 for further information regarding report on property.

Recorded by TR. Revised by \_\_\_\_\_ Lib. Res. Comp. \_\_\_\_\_  
18/8/76

Product(s) Ag-Au, Pb, Zn

Map No. 82 E/SE-114

Property No. \_\_\_\_\_

MINERAL DEPOSIT INVENTORY

Property No. 1223 Metal.  Industrial Mineral.  Placer.  Coal.  Lapidary.  Number of cards.

Name: Current Riverside Previous \_\_\_\_\_

C.G. lot name Riverside No. 1031

Owner \_\_\_\_\_ Operator \_\_\_\_\_

Location: Map No. 82E/5E-11A N.T.S. Sheet 82E/2W L.L.Q. 49°18'S.W. Claim \_\_\_\_\_ El. \_\_\_\_\_

M.D. Greenwood In park \_\_\_\_\_ E. & N.  Phys. subd. Monashee Mountains

Isolated deposit.  Mineralized region.  Mining camp \_\_\_\_\_ Locality Kettle River

PREC1

Discovery: Date \_\_\_\_\_ Method \_\_\_\_\_

Status: Producer  Active.  Intermittent.  Inactive.  Exhausted.  L.+  L.  M.  S.  S.-

Non-producer : Pot. prod.  Under exploration.  Prospect.  Occurrence.

Reserves: L+.  L.  M.  S.  S-.  Tons \_\_\_\_\_ Grade \_\_\_\_\_

Est. potential: L+.  L.  M.  S.  S-.  Grade \_\_\_\_\_

Development: Surface \_\_\_\_\_ Surveys: Geophys.  Geochem.  Geol.

Underground Incl. shaft, 40 ft.; adits 570 ft., winze 35 ft.

Diamond drilling \_\_\_\_\_ Other drilling \_\_\_\_\_

Reports on Property: M.M. A.R. 1900, 879; 1901, 1057, 1146; 1903, 168; 1905, 181; 1907, 109, 215; 1913, 153;

Dept. expl. forms \_\_\_\_\_

Assessment reports: Geological \_\_\_\_\_ Geophysical \_\_\_\_\_ Geochemical \_\_\_\_\_

Geological and maps ~~\_\_\_\_\_~~ \_\_\_\_\_

Reports on Region: Geological G.S.C. Maps ~~550, 529, 6-1957~~

Geophysical \_\_\_\_\_

Geochemical \_\_\_\_\_

Recorded by \_\_\_\_\_ Date \_\_\_\_\_ Revised by \_\_\_\_\_ Date \_\_\_\_\_

Summary description Shear zone in impure, dolomitic limestone, altered in places to near serpentinite. Two parallel veins strike nearly north-south and dip flatly to near 45° N.E. Veins are replacements along fracture planes by silica and lesser calcite and contain inclusions of limy rock.

Category of deposit shear zone

Wallrock(s) \_\_\_\_\_ Formational name \_\_\_\_\_

Attitude of deposit: Strike \_\_\_\_\_ Dip \_\_\_\_\_ Azimuth \_\_\_\_\_ Plunge \_\_\_\_\_

Size: Length \_\_\_\_\_ Width 2 ft - 4 ft. Depth \_\_\_\_\_

Character of mineralization \_\_\_\_\_

Main elements Ag, Au, Pb, Zn.

Mineralogy quartz; calcite; galena, sphalerite, pyrite; chalcocopyrite

Assays \_\_\_\_\_

Production: Tons 196 Grade Au, 0.06 g/t; Ag 40.6 g/t; Pb 0.18%; Zn 0.13%.

Remarks 1907, 1913, 1933

See Ass. Rpts. 1766, 2882

Product(s) Au, Ag, Pb, Zn, Cu

Property No. 1223

82E/5E-11A

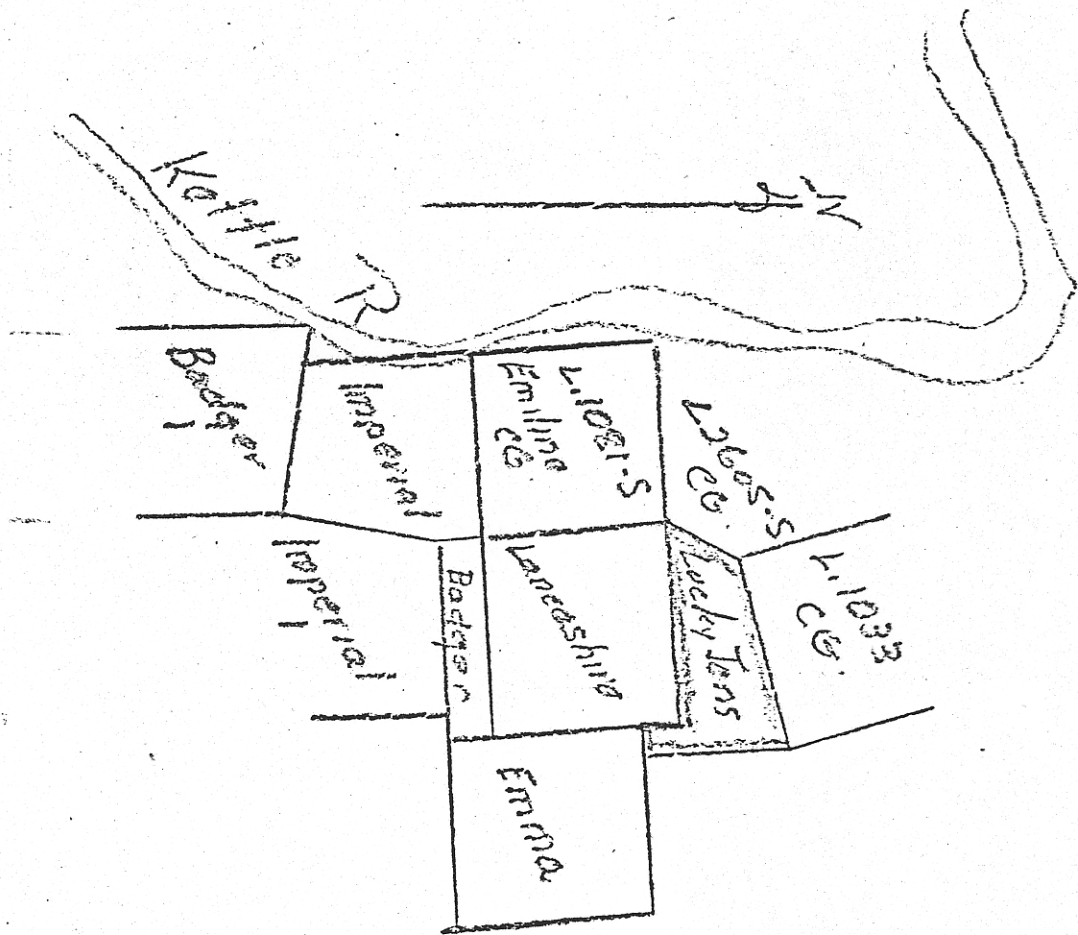

12759 June, 1952

← 4 miles to Rock Cr. Pa. Gre

82 E / SE - 113, 114, 115

82 E / 2W