

1710 - 609 GRANVILLE ST
 PO BOX 10363
 VANCOUVER BC
 CANADA V7Y 1G5
 (604) 683-7265 FAX 683-5306
 BBS 683-7206

George Cross News Letter

"Reliable Reporting"

WESTERN CANADIAN INVESTMENTS

COPYRIGHT
 ALL REPRODUCTION
 RIGHT RESERVED
 PUBLISHED DAILY
 SUBSCRIPTION RATE
 \$350.00 + G.S.T.
 PER YEAR

NO. 130 (1995)
 JUNE 7, 1995

NO. 130 (1995)
 JUNE 7, 1995

LA ROCK MINING CORPORATION

[LAR-V] 13,834,397 SHS.

MORE HIGH GRADE GOLD INTERCEPTED - Dr. Robert E. Lee,
 president, La

Rock Mining Corp., has reported gold values from Hole DP95-15 (-90°), located 90 feet north west of Hole DP95-14 on the 100%-owned, subject to 0.5% NSR, Brandywine gold property, 30 miles north of Squamish, B.C. SEE MAP OVERLEAF P.5.

Hole DP95 - 15 (-90°)		
INTERVAL	WIDTH	GOLD (uncut)
FEET	FEET	OZ/T
27 - 33 Ft.	5 Ft.	0.133
93 - 98	5	0.013
98 -103	5	0.607
103 -108	5	0.001
108 -113	5	0.001
113 -118	5	0.318
118 -123	5	0.006
123 -128	5	1.224
128 -133	5	0.021
93 -133	40	0.274
287 -296	9	6.178

La Rock is assessing the results from the DP Zone program, including the importance of the rich zone at depth in Hole DP-15. (SEE GCNL NO.122, 26Jun95, P.4 FOR PREVIOUS DRILL RESULTS)

MAJOR GENERAL RESOURCES LTD.

[MGJ-V] 16,688,310 SHS.

DRILLING PLANS SCHEDULED - William J. Coulter, president,
 Major General Resources Ltd.,

reports a 5,000-metre drill program to cover three base-precious metal properties will start in late July.

Hart's Lake, New Brunswick - Major General recently completed a 10-line, 14-km detailed induced polarization geophysical survey over its Bathurst Camp, New Brunswick base metal property. This survey has outlined an 800-metre long anomalous zone with chargeability values ranging from five to 10 times background values. In addition, the chargeability highs are associated with resistivity lows, which is consistent with zinc-rich massive sulphides.

Major General intends to test this induced polarization anomaly with a five-hole, 1,000-metre diamond drilling program planned for late July, 1995. The geological setting of the Hart's Lake property, owned two-thirds by the company, is within the Tetagouche Felsic Volcanics, which is the same setting as that of the large Bathurst Camp zinc-lead deposits currently in production 30-40 kilometres to the east.

Previous work on the property by Umex and Shell Minerals included groundwork and eight diamond drill holes which intersected a best value of 30 metres grading 1.5% zinc and 0.5% lead. The strongest portion of this new chargeability anomaly was not tested by any of these holes.

Sabin, Ontario - Noranda has notified Major General they will be drilling two deep (+300-metre) diamond drill holes to search for high grade, volcanogenic copper-zinc deposits at the Sabin property in northwest Ontario. Work earlier this year by Noranda included a detailed review of previous work, various ground and down-hole geophysical surveys, detailed geological mapping and whole rock geochemistry.

92JW 1
 p. 1 of 2

SECTION 1

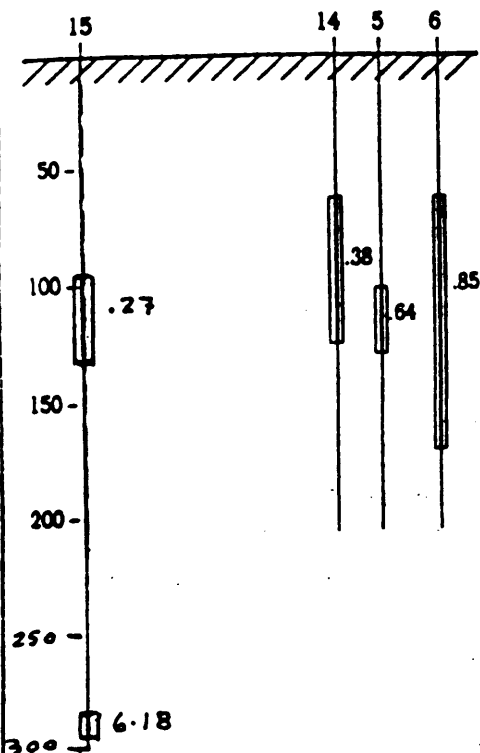

SECTION 2

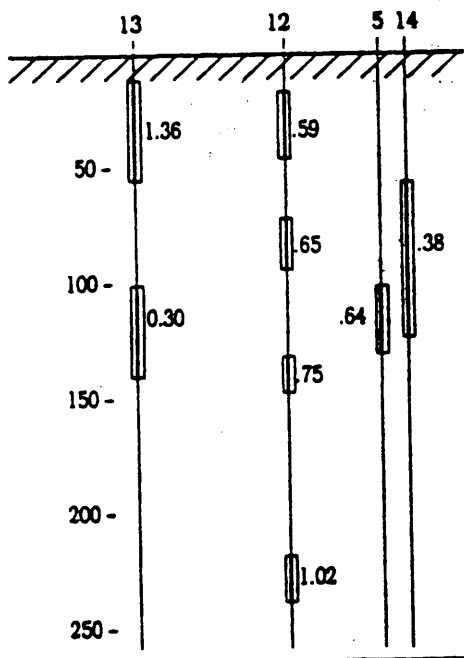

**LA ROCK MINING CORP. LAR-V
 DP ZONE 1995 DRILLING HIGHLIGHTS**

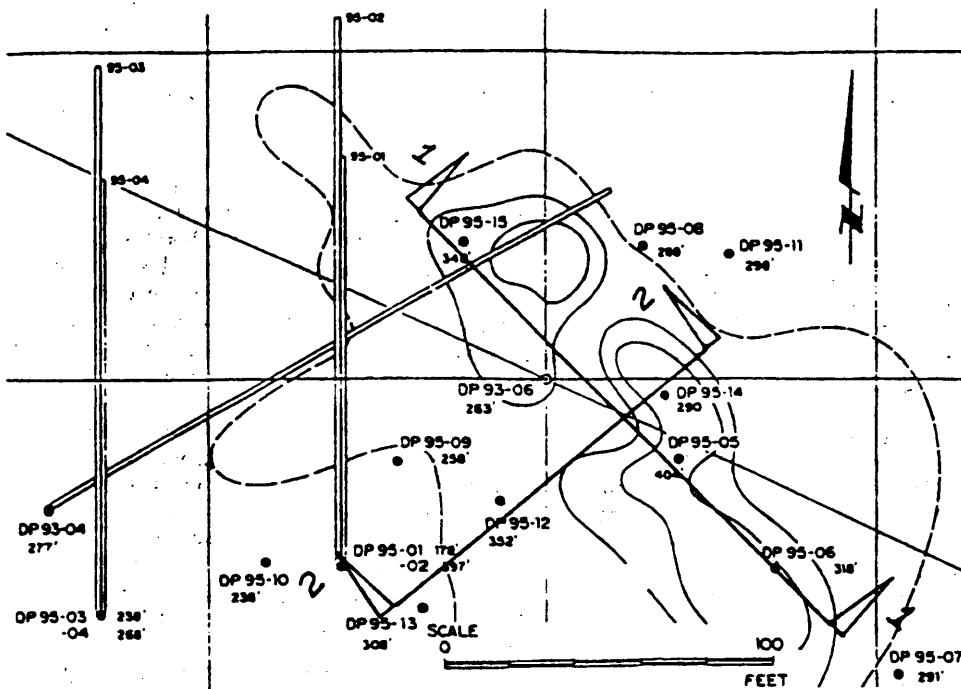

Hole	Depth (ft.)	Interval (ft.)	Average Gold Grade (oz/ton)
95-14	68-128	60	0.384
95-13	18-53	35	1.360
95-13	98-138	40	0.300
95-12	23-48	25	0.590
95-12	73-93	20	0.650
95-12	128-143	15	0.750
95-12	228-243	15	1.020
95-6	66-168	102	0.853
95-5	103-133	30	0.640

92JW1 p. 2 of 2