

1710 - 609 GRANVILLE ST
PO BOX 10363
VANCOUVER BC
CANADA V7Y 1G5
(604) 683-7265 FAX 683-5306

George Cross News Letter

"Reliable Reporting"

WESTERN CANADIAN INVESTMENTS

COPYRIGHT
ALL REPRODUCTION
RIGHTS RESERVED
PUBLISHED DAILY
SUBSCRIPTION RATE
\$350.00 + GST

NO. 126 (2000)
JUNE 30, 2000

NO. 126 (2000)
JUNE 30, 2000

INT'L WAYSIDE GOLD MINES LTD.
[IWA-CDNX] 38,454,998 SHS.

**65 FEET OF HALF-OZ GOLD IN NEW HOLE
TRADING TO RESUME AFTER 48 DAYS CDNX HALT**

Frank Callaghan, president, International Wayside Gold Mines Ltd., reports assay results for diamond drill holes BC2K-16 to 19 inclusive from the 100% optioned Cariboo Gold Project in the Wells/Barkerville area 100 km east of Quesnel, central BC. Holes BC2K-16, 17 and 18 were drilled to test the northwestern extension of the Bonanza Ledge zone. Muscovite-dolomite alteration and pyritic bands were intersected in these holes, but contained less than 0.5 grams gold/tonne. The occurrence of minor pyrrhotite in these holes suggests they are peripheral to the gold zone. Holes BC2K-15 and 19 were drilled to further define the known gold zone. The attached diamond drill hole plan and sections OVERLEAF P.2 shows the location of BC2K 1 through 19 for which assays have been reported. BC2K-20 through 24 have been drilled and are currently being logged with assay results pending. Drill hole BC2K-25 is in progress and the proposed locations for BC2K-26 & 27 are also indicated. These locations have been chosen on Panterra Geoservices Inc.'s recommendation to enhance the understanding of the geometry/geology of the Bonanza Ledge Zone. SEE ASSAYS FOR HOLES BC2K-19, 15, & 16 OVERLEAF P.1.

In hole BC2K-19 the BC Vein was not intersected. Narrow quartz-carbonate-pyrite veins occur at 60 to 80, and 91 to 110 feet. Muscovite-pyrite alteration was intersected from 136 to 235, and 261.8 to 374, and pyritic alteration from 374 to 442.7 feet.

In hole BC2K-15, the BC Vein and fault structure was intersected from 183.5 to 234.4 feet. The interval from 200 to 215 feet is associated with fine to medium grained pyrite in white vein quartz. Muscovite with weak pyritic alteration was cut 234.4 to 303.1 and 330.3 to 470.2 feet. This hole is underneath the gold cut in BC2K-13 of 0.639 oz.gold/t over 74.0 feet and 0.212 oz/t over 30.0 feet.

The BC Vein and fault structure was cut from 20 to 80.1 feet. Muscovite and weak pyritic alteration was cut from 85 to 141.5, 147 to 165.5, and 214.9 to 250 feet. All assay values are less than one gram/t. The mineralized interval, 440 to 443.5 feet, is associated with a narrow quartz-carbonate-pyrite vein in unaltered rock.

In hole BC2K-17, the BC Vein/fault was cut from 30 to 90 feet. Muscovite alteration was cut from 90 to 141.8 and 236 to 372.2 feet, and a large zone of peripheral weak-pyrite alteration was cut from 372.2 to 575 feet. All assay values are less than one gram/tonne.

In hole BC2K-18, TABLED OVERLEAF P.3, the BC Vein and fault structure was cut from 201.2 to 258.7 feet. Mineralization occurs in pyritic fault gouge on the hanging wall margin of the vein. Weak muscovite-pyrite alteration was intersected from 311.8 to 409 and 465.1 to 698.5 feet. Mineralization at 425 to 430, and 565 to 570 feet is associated with quartz carbonate-pyrite veins.

The company has been advised by the CDNX its shares will be reinstated for trading at the opening of trading 30Jun2000. (SEE GCNL NO.125, 29Jun2000, P.1 FOR PREVIOUS PROJECT DATA)

93H 19
p. 10F4

1710 - 609 GRANVILLE ST
PO BOX 10363
VANCOUVER BC
CANADA V7Y 1G5
(604) 683-7265 FAX 683-5306

George Cross News Letter

"Reliable Reporting"

WESTERN CANADIAN INVESTMENTS

COPYRIGHT
ALL REPRODUCTION
RIGHTS RESERVED
PUBLISHED DAILY
SUBSCRIPTION RATE
\$350.00 + GST

NO. 126 (2000)
JUNE 30, 2000

NO. 126 (2000)
JUNE 30, 2000

INT'L WAYSIDE GOLD MINES LTD. CARIBOO GOLD PROJECT WELLS/BARKERVILLE REGION, CENTRAL BC

Drill Hole BC2K-18 Northing 2874 Easting 19319 Elevation 4958' Inclination -55° Azimuth 221° Length 800 FEET Core Recovery% 96.5

CORE		Au	
Interval	Length (ft)	Assay (g/T)	Assay (oz/st)
200-205	5.0	1.72	0.050
425-430	5.0	1.08	0.032
565-570	5.0	1.49	0.043

93H 19
p. 2 of 4

INTERNATIONAL WAYSIDE GOLD MINES LTD

CARIBOO GOLD PROJECT

BONANZA LEDGE ZONE

BC2K DRILL PLAN

ASSAYS BC2K-15 TO 19

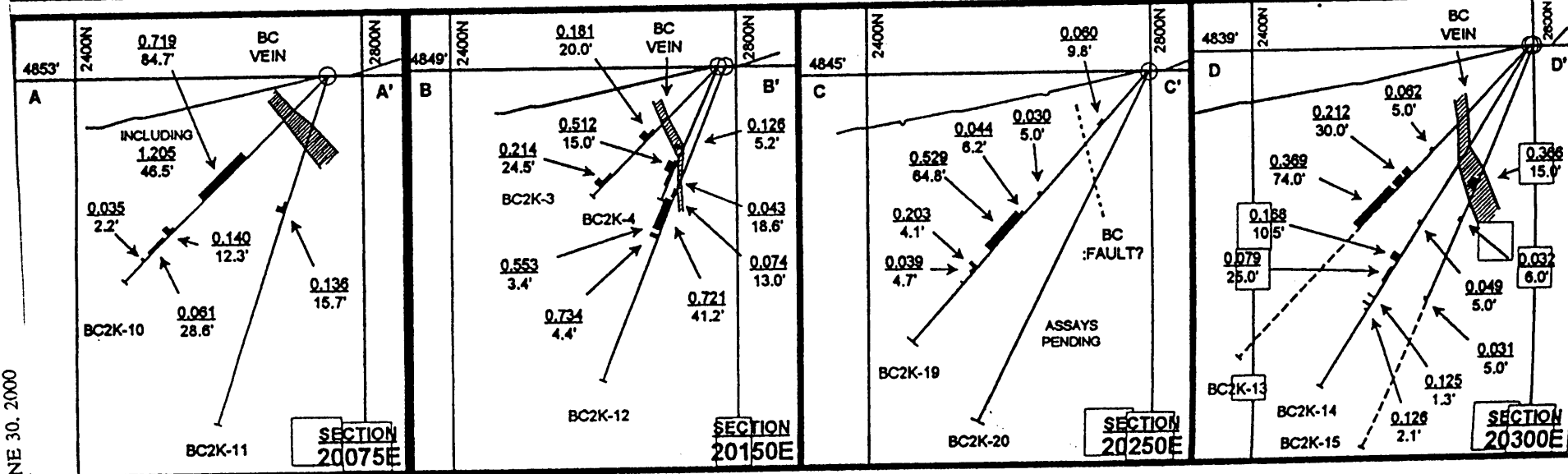
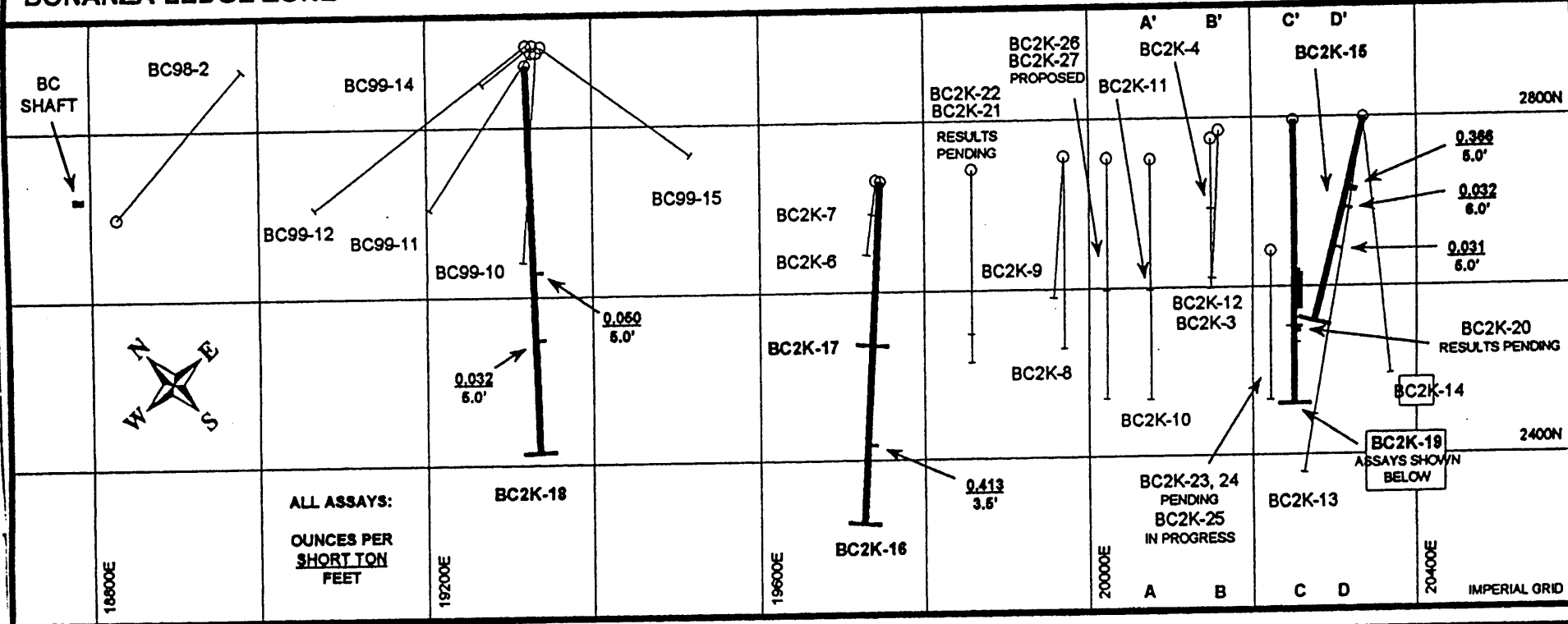

93H 19
 P. 3 of 4

INT'L WAYSIDE GOLD MINES LTD.
CARIBOO GOLD PROJECT
WELLS/BARKERVILLE REGION, CENTRAL BC

Drill Hole BC2K-19 Northing 2796 Easting 20251 Elevation 4845' Inclination -48° Azmith 223° Length 500 FEET Core Recovery % 92.9

CORE		Au	
Interval	Length (ft)	Assay (g/T)	Assay (oz/st)
91.5-101.3	9.8	1.90	0.055
225-230	5.0	1.03	0.030
261.8-268	6.2	1.52	0.044
268-332.8		18.15	0.529
Including			
268-274.9	6.9	41.17	1.201
274.9-280	5.1	14.91	0.435
280-285	5.0	12.45	0.363
285-291.4	6.4	2.32	0.068
291.4-296.1	4.7	19.25	0.562
296.1-300	3.9	36.98	1.079
300-308.8	8.8	15.51	0.452
308.8-310	1.2	41.47	1.210
310-315	5.0	30.10	0.878
315-315.8	0.8	12.36	0.361
315.8-321	5.2	3.04	0.089
321-326	5.0	21.28	0.621
326-332.8	6.8	5.17	0.151
362.5-366.6	4.1	6.96	0.203

NO. 126 (2000)
JUNE 30, 2000

Drill Hole BC2K-15 Northing 2798 Easting 20336 Elevation 4839' Inclination -66° Azmith 237° Length 605 FEET Core Recovery % 90.1

CORE		Au	
Interval	Length/Ft	Assay g/t	Assay oz/st
200-215	15.0	12.56	0.366
Including			
200-205	5.0	31.12	0.908
205-210	5.0	1.48	0.043
210-215	5.0	5.08	0.148
259-265	6.0	1.09	0.032
380-385	5.0	1.05	0.031

Drill Hole BC2K-16 Northing 2731 Easting 19747 Elevation 4879' Inclination -45° Azmith 226° Length 575 FEET Core Recovery % 85.4

CORE		Au	
Interval	Length (ft)	Assay (g/T)	Assay (oz/st)
440.0-443.5	3.5	14.17	0.413

NO. 126 (2000)
JUNE 30, 2000

93H 19 p. 4 of 4