

889175

UDUK Lk.

Mon. Sept. 12th

- with Bob Lane Quebec Election Day
- new logging rd. Overcast/Rain +12°C
- @ 34.5 km - small backhoe trail
to west ~ 2 km to area
of trenches

Tr. 5 @ 140° in gtz-eye
 obs'd Gp. rhyolite with gtz. veins
 plus trace black gtz = py.
 - spec. hom + Mn.

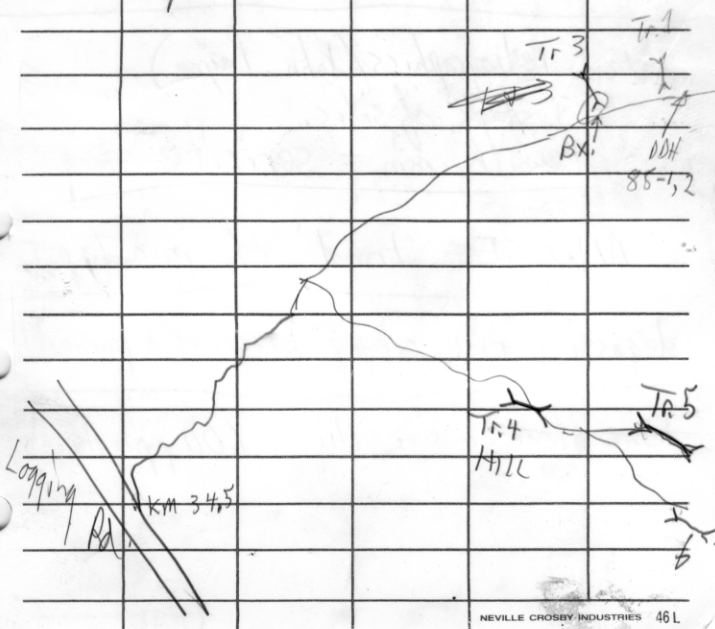

Old DDH-5 core - small step ridge @ 055°
- Tr-3 - nice chalcocite + py breccia - "Best looking"

Tr-2 - covered - beside DDH-88-1
- beautiful spherulitic 'beds'
- small step ridge @ 060°
- photo - Bob + core

DDH⁸⁸-2 and 3

Van. Petrographics (John Payne)

= 3 stages of silic.

- greenish min = sericite ⇒ 'propylitic'

NW-SE 'trend' of min. (esp. Tr 4)

degassing "rice crispy" breccias = permeable

1.5m shear zone + silic. = 600 ppb Au along 40m