

Ministry of Employment & Investment Energy & Minerals Division

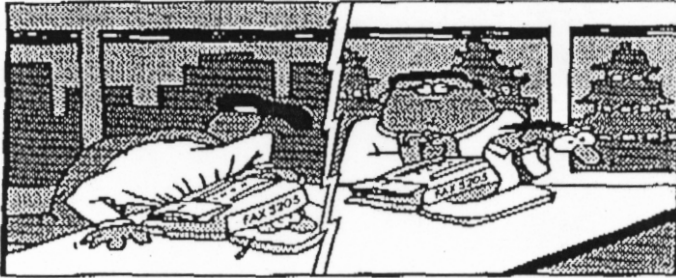

Bag 5000
Smithers, BC V0J 2N0
Phone: (250) 847-7383
Fax: (250) 847-7603

RedCap
886352

Date: Sept 1/98 Time: 12:00

Fax #: _____

Please deliver message to:

Tom Schreier

- | | | | |
|--------------------|-------|-----------------|-------------------------------------|
| From: Wally Bergen | _____ | Bruce Graff | _____ |
| Esther Burchett | _____ | Daryl Hanson | _____ |
| Catherine Daniel | _____ | Elaine Konschuh | _____ |
| Sandra Ennis | _____ | Mary Lou Malott | _____ |
| Doug Flynn | _____ | Jill Pardoe | _____ |
| Bryan Good | _____ | Bill Price | _____ |
| | | Paul Wojdak | <input checked="" type="checkbox"/> |

Comments: Explorer Gold's
Drill Program is all
being carried out on KAP4
(325568) We have a large
map with ^{more} specific
locations

No. of pages (including this one):

2



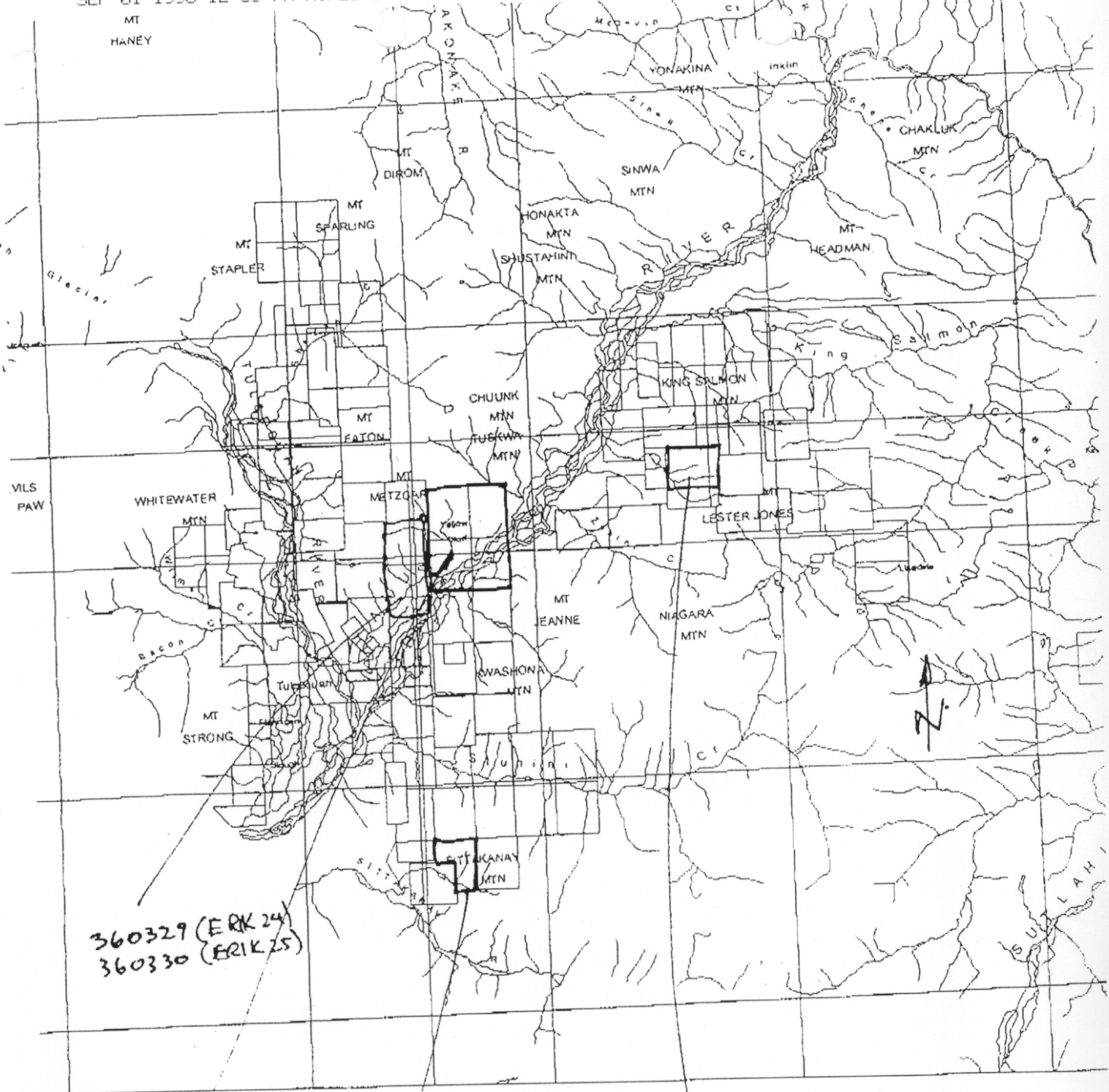

360329 (ERIK 24)
360330 (ERIK 25)

360606 (ERIK 14)

325568 (KAP 4)

4 claims
359665 (ERIK 4)
359666 (" 5)
360315 (" 6)
360316 (" 7)

XPLORER GOLD CORP.
RED CAP; TAKU STAR
1:250,000