

886711



Province of British Columbia Ministry of Energy, Mines and Petroleum Resources

Reclamation Permit **MX-7-57**

MINERAL RESOURCES DIVISION
INSPECTION AND ENGINEERING BRANCH

MINISTRY OF ENERGY, MINES
AND PETROLEUM RESOURCES
Number **14675-30**

NOTICE OF WORK AND RECLAMATION PROGRAM
ON A MINERAL PROPERTY

Rec'd **OCT 10 1989**

1. NAME OF PROPERTY **QUET CLAIMS**

Number of claims **10 CLAIMS (184 units)** Principal Claim Group **QUET CLAIMS**
2. LOCATION: Mining Division **NEW WESTMINSTER** NTS Map Sheet (e.g., 82E/9E) **92G/9+16**

Lat. **49. 45.** Long. **121. 21.** UTM: E. N.

Access via **SLOQUET CREEK LOGGING ROAD TO EDGE OF CLAIMS either from Pemberton or Harrison Mills.**
3. OWNER: Name **ARANLEE RESOURCES LTD.** FMC No. **285193 ARAREL**

Address **548 BEATTY ST.** City **VANCOUVER**

Province **BRITISH COLUMBIA** Postal Code **V6B 2L3** Telephone No. **684-4039**

FAX - 684-3854
4. OPERATOR: Name **ARANLEE RESOURCES LTD.** FMC No. _____

Address **5** City _____

Province _____ Postal Code _____ Telephone No. _____
5. EXPLORATION WORK: Indicate PROPOSED or COMPLETED .

Duration of Exploration Work: From **NOVEMBER 1 1989** to **NOVEMBER 30 1989**

Name of Field Manager **J.T. (JOE) SHEARER** No. of men employed **8**

Geophysical: **Magnetometer + VLF** Geochemical: **400 SOIL SAMPLES**

Linecutting (distance, width, method) **10 km, axe + chainsaw** m²
6. SURFACE DISTURBANCE OFF MINERAL CLAIMS

Road Access Construction: Total length **DONE IN August/Sept - see previous notice of work MAY 16/89** m Approximate width _____ m Area _____ m²

Campsites: No. of men **8** Size **ON ROAD** m²

Other (specify) _____ m²
7. SURFACE DISTURBANCE ON MINERAL CLAIMS

(a) Road Construction: Total length **2000** m Approximate width **8** m Area **16,000** m²

(b) Drilling: No. of sites **6** Maximum dimensions: Width **10m** Length **10m**

Depth _____ m Total disturbed area of drill sites **600** m²

Water source **North Sloquet** Method of drill mud disposal **Local containment**

(c) Trenches: No. **4** Maximum dimensions: Width **2** Length **400** m

Depth **1** m Total disturbed area of trenches **3200** m²

(d) Test Pits: No. _____ Maximum dimensions: Width _____ Length _____ m

Depth _____ m Total disturbed area of test pits _____ m²

7. SURFACE DISTURBANCE ON MINERAL CLAIMS (CONTINUED)

(e) Camp Area: No. of men 8 Width ON EXISTING ROAD m Length ON EXISTING ROAD m Aream²

(f) Underground Exploration: Area of surface facilities NONEm²

(g) Other (specify) NONEm²

TOTAL OF SURFACE DISTURBANCE ON MINERAL CLAIMS 19,000m²
 (1 ha = 10 000 m²) 1.98ha

8. EQUIPMENT TO BE USED IN EXPLORATION PROGRAM (List size, capacity, and number.)

(a) 450 John Deere Dozer (d)

(b) JKS 300 diamond drill (e)

(c) 2 chainsaws for limbing during tree cutting (f)

9. PRESENT STATE OF THE LAND ON WHICH EXPLORATION IS PROPOSED

Present land use (agriculture, forestry, ranching, recreation, etc.) 2nd growth + Alpine Forestry

Type of vegetation slide Alder / 2nd growth

Access roads (present use and condition) OLD logging roads

Campsites, old workings (location, condition)

10. RECLAMATION PROGRAM (Prescribed reclamation treatments are outlined in Guidelines for Mineral Exploration.)

Camp sites

Trenches, drill sites, and major excavations BACKFILL + SEED

Roads OPEN FOR FORESTRY USE

Seeding: Mixture

Rate of application kg/ha Date

Area seeded ha Quantity of seed kg

Fertilizer: Type

Rate of application kg/ha

Area fertilized ha Quantity of fertilizer kg

11. SUMMARY OF AREAS DISTURBED AND RECLAIMED

Area disturbed current year Previous years Total to date

Area reclaimed current year Previous years (final) Total to date

12. DATE FOREST SERVICE ADVISED BY OPERATOR

OCTOBER 6/89 left message

Name and Title of Forest Official in continual contact with R. Templeman (Pemberton)

Address OLiver Thomae (Squamish) District Silviculturist, Squamish Forest Dist. Box 1970, Squamish, B.C. V0N 3G0.

S Shearer MANAGING DIRECTOR
 Signature of Applicant Title

J. T. (JOE) SHEARER OCTOBER 6 1989

see Attached 1:10,000 scale Map.



Aranlee Resources Ltd.
QUET PROPERTY
 Bloquet Creek Area New Westminster M.D., B.C.

CLAIM LOCATION MAP

	Scale: 1:50,000	NLS 92-0(9/16) Figure: 2
	Date: November 1987	
	Drawn by:	

* Please refer to attached 1:20,000 scale map for details and airphotos

PLAN

Indicate claim boundaries, permanent watercourses, access road and distance to nearest town, proposed surface disturbances including roads, test pits, trenches, portals, drill sites, and camp sites.

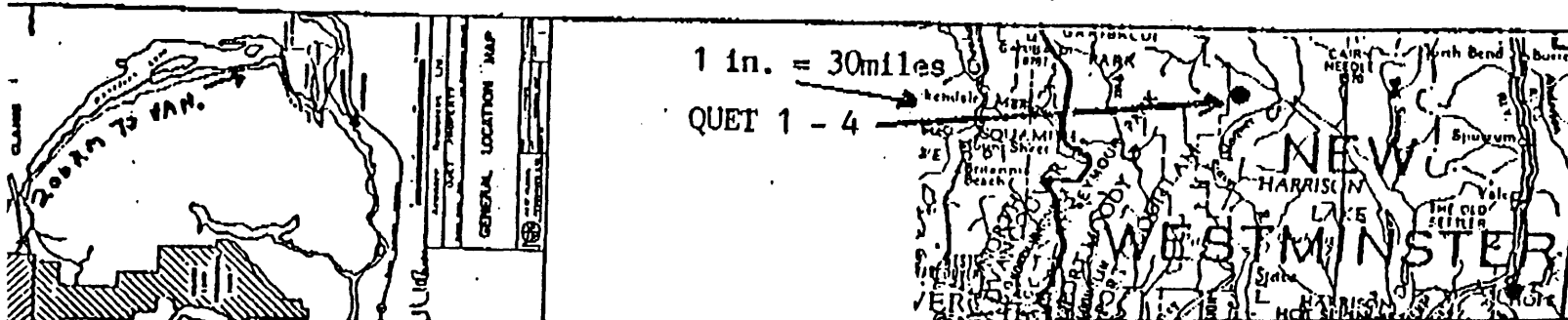

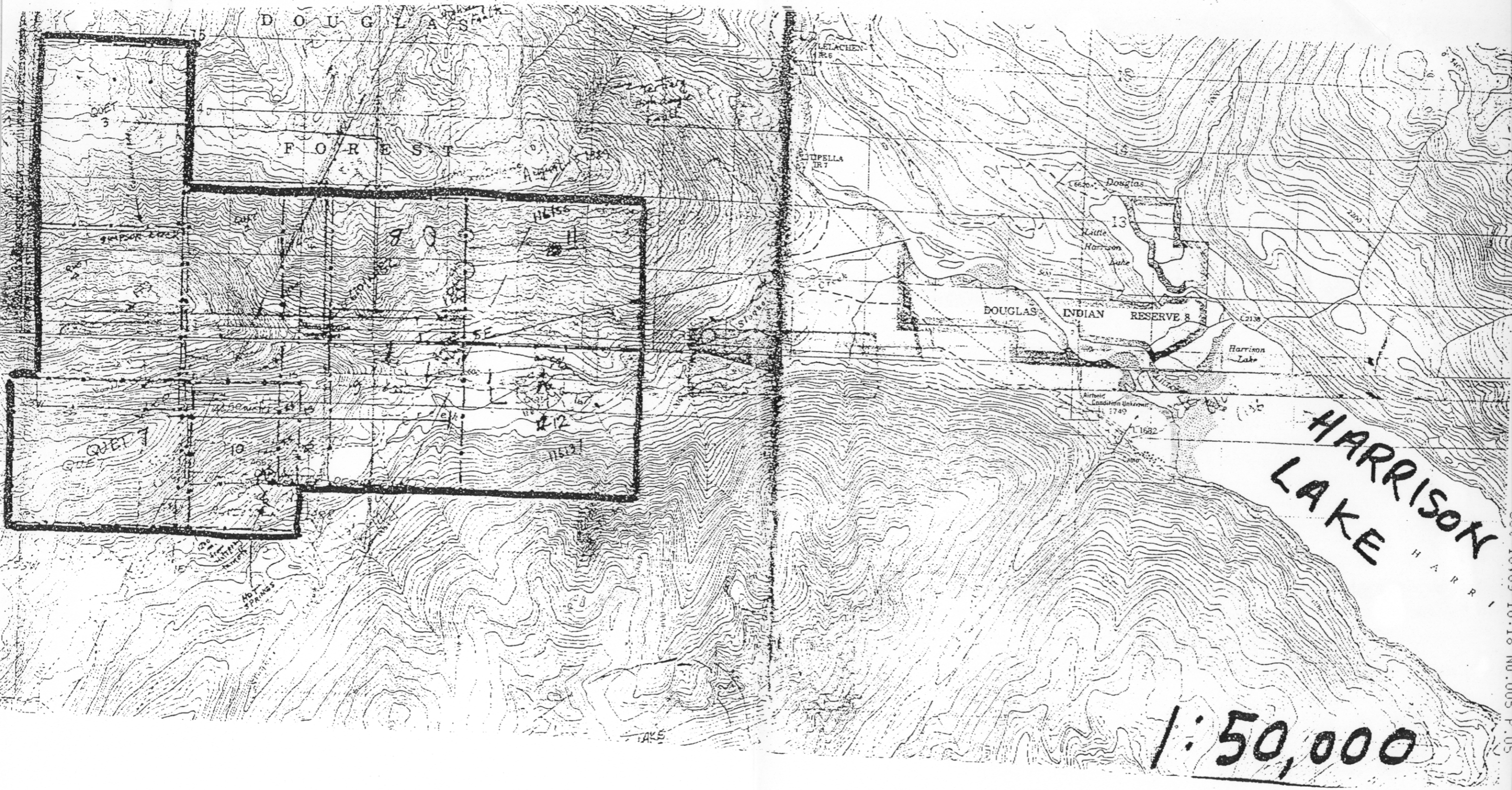

D O U G L A S

F O R E S T

D O U G L A S I N D I A N R E S E R V E

HARRISON
LAKE

1:50,000