

# POPLAR

Oct. 12/00

- met with Barry Price & Frank Oucki (in Island Arc office)
- Barry is 'custodian' (on behalf of <sup>Fo</sup>) of all previous Utah + EPAs data.
- BP has converted <sup>drill</sup> data (digital) to Excel files.
- 1991 drilling by Canamin (Gen. Ainsworth) was "too shallow" i.e. only ~~300m~~ <sup>100m</sup> deep → grade was increasing with depth.
- deepest hole on East zone = 600m - stopped in good grade
- deepest hole on Main zone ~ 300m
- I.P. was done on E-W lines (i.e. before East - Main zone 'trend' known) over 1st step (now) ⇒ I.P. survey on N-S lines (est. \$60k).
- Soil geochem. did/does NOT work!
- Utah did pre-fas. study @ 25% Cu cut-off

# POPLAR

Feb. 12/09

- chat with Frank Duck
- Skygold Ventures Ltd., from Calgary, failed to follow thru with "commitments" = property back, 100% to Frank.  
(est. Barry Price out \$30k personally)
- Price did excellent compilation report (Frank to share).
- Looking for option

RESOURCES Oct. 5/00

~ 116 MT @ .32% Cu, 0.19 g/t Au  
+ 0.009% Mo (+sig. Re)  
incl. ~ 40 MT @ .4% Cu (near  
Sunter)  
(+ Mo, Ag, Au, Re)

POPLAR July 8/03

Don Bragg now 'owns'  
property (after 'Frank Onuki'  
- died - July 30/02)  
→ he has all the  
files → avail. for  
option!

POPLAR Dec. 19/02  
Brian Fairbanks to  
option (Barry Price)  
→ declined (in favour of  
geothermal + gold project)

Don Bragg  
604  
321-8897  
Poplar / Hord Dome  
for option

POPLAR Aug. 25/04  
TS talk with Dave Teague (owner)  
→ thinks Andre's kaiki ka  
has staked western (main) part  
of dep.; Bragg et al has  
staked eastern part!  
IC

POPLAR Jan. 22/04  
Don Bragg (owner) /  
Ben Ainsworth (Hather)  
- option soon!

Nov. 9/82

POPULAR

Frank Onuki

~ 110 m tons @ .35 Cu

.035 MoS<sub>2</sub>

.5 g/t Ag

.01 g/t Au

- east side down dropped ~ 180 ft.

- Complete "buy-out" decision by Jan. 1/83

75 million tons

.01 Mo %

- 125 million max.

0.1 g/t Ag

.35% Cu

Andy Schmidt

15,000 tpd

Utah

.46T

Mar. 12/82

POPULAR

---

## Visit to Poplar Lake - July 17/78

Sections (detailed) completed by Peter:

- ① ~~AE-SW~~ section PC-15 → PC-7 (incl. 2, 13, 9, 24)
- ② ~~AE-NW~~ section PC-28 → PC-39

- Traversed west up ridge top with El Paso trenching  
- top is hypabyssal intrusive with phenox. of hbld.  
+ fsp in fn. gr. grey-pink matrix.

## VISIT TO POPLAR LAKE - June 7/77

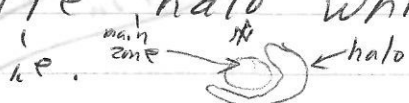
- Driving time from Smithers to camp = 2 hrs. Taksta rd. graded (Forestry + Fisheries) to Nadina - able to travel 40 mph. now!
- Barney Bowen, geologist, and Bob ?, assistant, were logging core + supervising 2 slashers,
- 6 ddh - 2 on East Zone and 4 on MAIN.
- drilling on Main zone (eg. 650' holes) confirmed previous work i.e. zone pretty well defined now - unfortunately it is sub-economic (.38?) and doesn't come close enough to surface. Drilling in area to SE of main zone on good IP gave weaker mineralization and still at depth. I.P. apparently didn't work too well to outline economic min. - although it did delineate pyrite halo which is asymmetrical about main zone, i.e. 

Barney would like to see a couple of deep (1500-2000') holes

EAST ZONE - rd. from main camp easterly 1.8 miles (2800 metres)

- 4 or more trenches - filled back in.
- biotite granodiorite to quartz monzonite host with minor pegmatite in andesitic host.
- min. is py + cpy + mal in intrusive + py. in v.c.
- ddh showed only weak copper values
- strong chloritic alt'n locally.
- Qtz-eye porphyry present with py only.

See Oct. '76 report for photos!

(over)

# East Zone

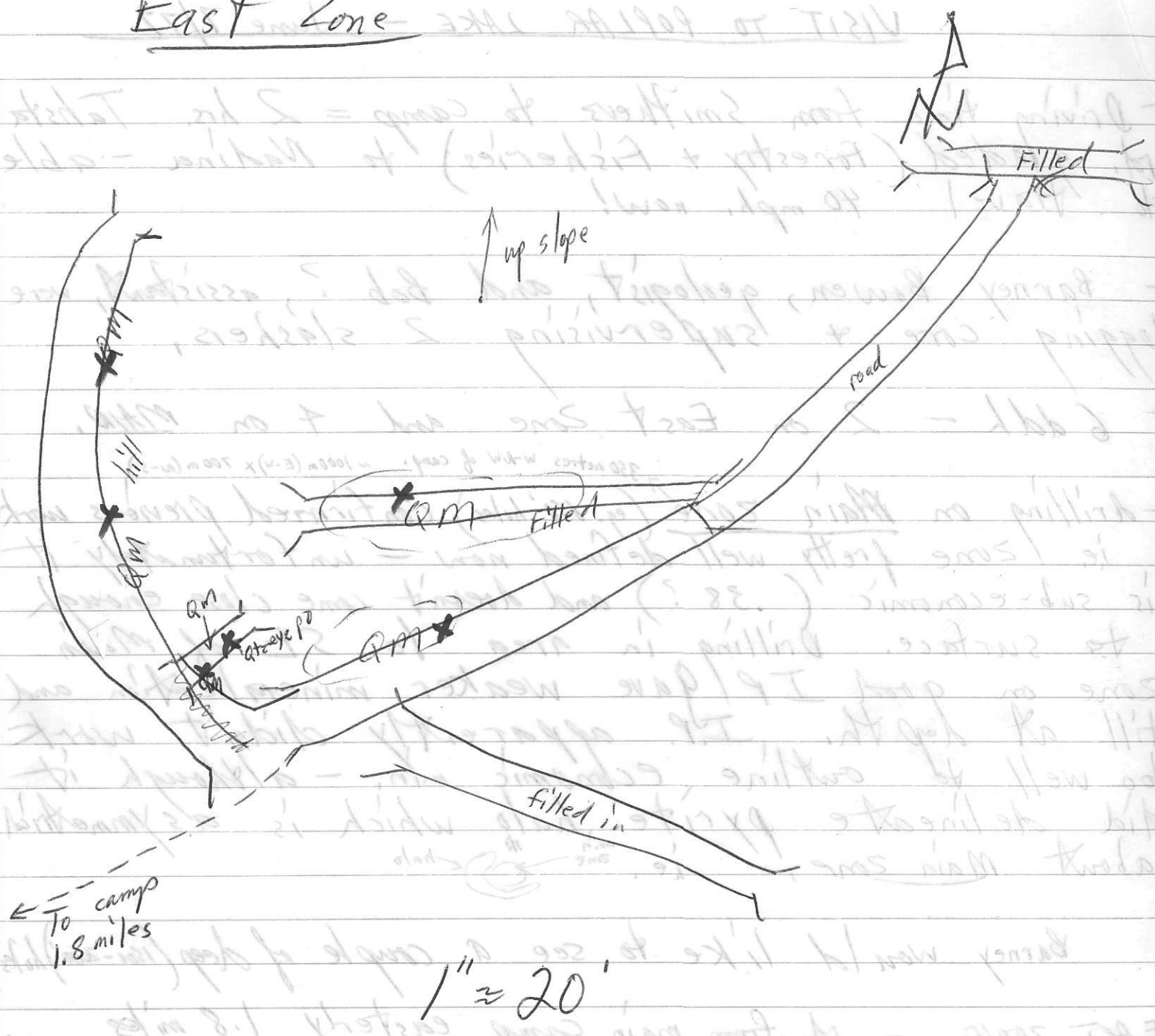

**X** Samples taken.

see Oct. 28  
report for  
protocol