

WD 3.5' Au 1.55 Ag 428 Cu 3.3 Pb 19.8

1979
PAA
Diary
McNulty

PADDYMAC
886293
1037154

3342 - 0.8"

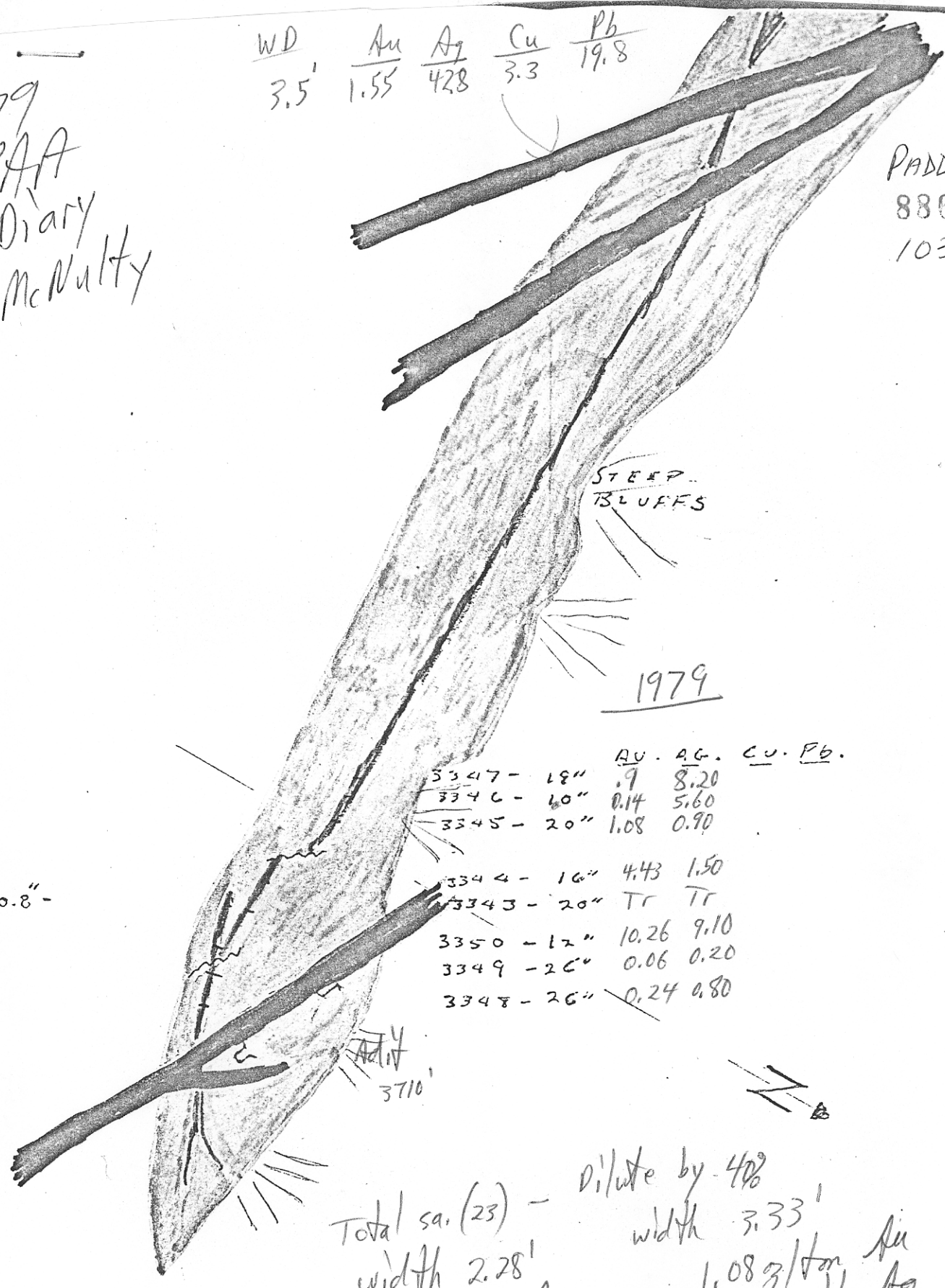

1979

		AU.	AG.	Cu.	Pb.
3347	- 18"	.9	8.20		
3346	- 10"	0.14	5.60		
3345	- 20"	1.08	0.90		
3344	- 16"	4.43	1.50		
3343	- 20"	TR	TR		
3350	- 12"	10.26	9.10		
3349	- 26"	0.06	0.20		
3348	- 26"	0.24	0.80		

Total sa. (23) - Dilute by 40%
width 2.28' width 3.33'
1.86 g/ton Au 1.08 g/ton Au
2.92 g/ton Ag 1.71 g/ton Ag

- LEGEND
- ▣ ARGILLITE
 - PORPHYRY
 - ⊥ ADIT
 - QTL. VEIN

ASSAY PLAN
SCALE 1" = 200'
PLAN 103 I/100 W
S.M.H.

1945 - p. 163 Warrior