







MCKENZIE

-  Diorite dykes
-  Monzonite
-  'Hybrid' monzonite
-  Trachyte flows + pyroch
-  Rainbow low-angle reverse fault
-  'Eventual' pit outline

MBX Stock
DDH #12 = Discovery

885750

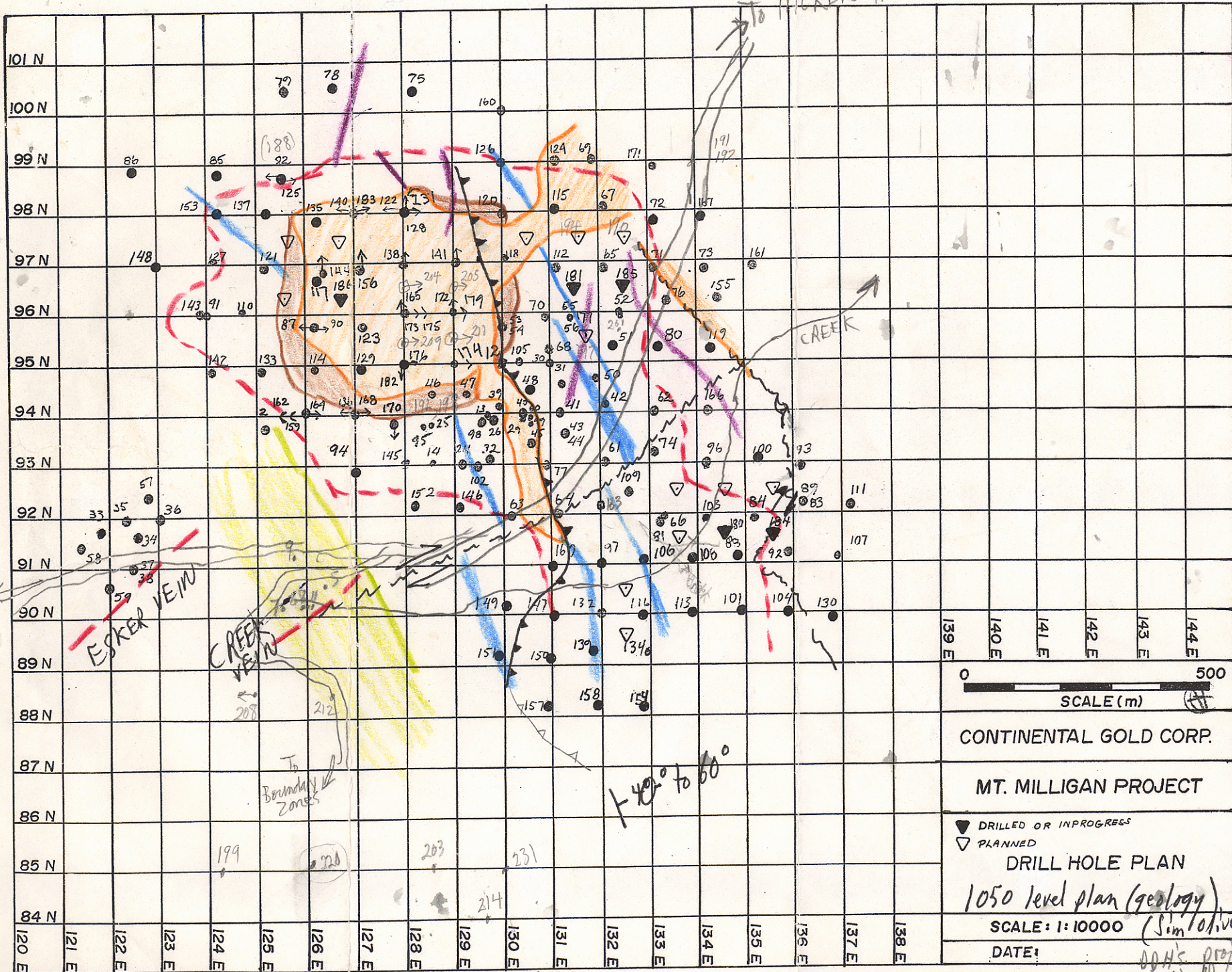

139 E 140 E 141 E 142 E 143 E 144 E

0 500
SCALE (m)

CONTINENTAL GOLD CORP.
MT. MILLIGAN PROJECT

▼ DRILLED OR IN PROGRESS
▽ PLANNED

DRILL HOLE PLAN
1050 level plan (geology)

SCALE: 1:10000 (Sim/oliver)

DATE: JUNE 26

DDH's proposed from source

To CAMP

ESKER VEIN

CREEK VEIN

To BOUNDARY ZONES

40° to 60°

CREEK

207

202 213 210

206

217*