



Province of  
British Columbia

Ministry of  
Energy, Mines and  
Petroleum Resources

Robson Square  
159, 800 Hornby Street  
Vancouver  
British Columbia  
V6Z 2C5

885747

(604) 660-2708  
-2812

GEOLOGICAL SURVEY BRANCH

To: FAX No: 565-6015

TELECOPIER

From: Rapicom (604)660-2653

Date: Mar. 23/90 Time: 3:45 pm



Please deliver the following message:

TO: Ted Faulkner  
GSB  
Prince George

FROM: Tom Schroeter  
GSB  
Vancouver

COMMENTS: Re: Mr. MILLIGAN  
- 2 cross sections  
(originals in mail)

Number of pages 3 include cover sheet.



Province of  
British Columbia

Ministry of  
Energy, Mines and  
Petroleum Resources

Robson Square  
159, 800 Hornby Street  
Vancouver  
British Columbia  
V6Z 2C5

(604) 660-2708  
-2812

GEOLOGICAL SURVEY BRANCH

To: FAX No: 356-8153

TELECOPIER

From: Rapicom (604)660-2653

Date: Mar. 23/90 Time: 3:45 pm



Please deliver the following message:

TO: Vic Preto  
GSB  
Victoria

FROM: Tom Schoeter  
GSB  
Vancouver

COMMENTS:  
Re: Mr. MILLIGAN  
- 2 cross sections  
(originals in mail)

Number of pages 3 include cover sheet.

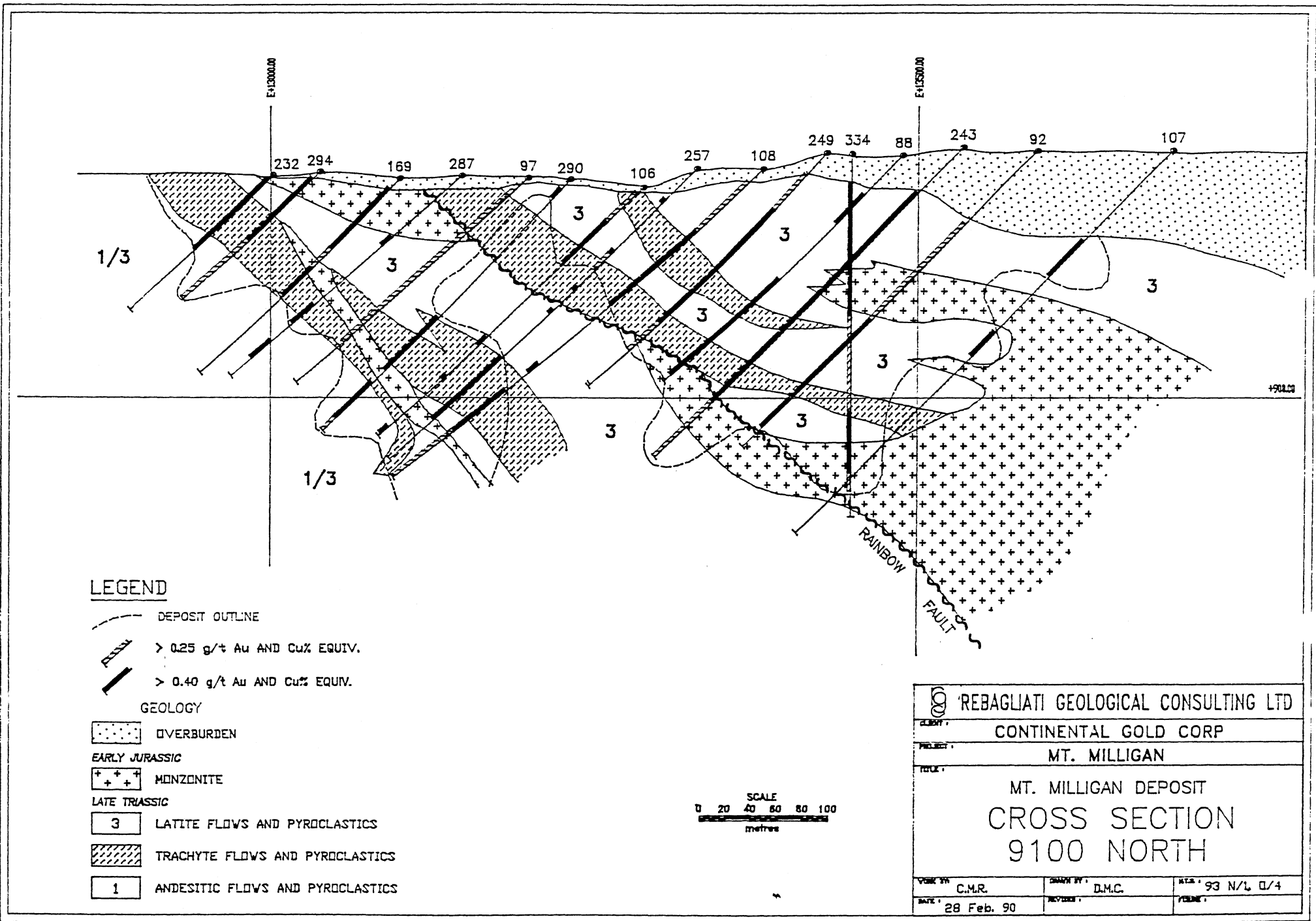

**LEGEND**

- DEPOSIT OUTLINE
- > 0.25 g/t Au AND Cu% EQUIV.
- > 0.40 g/t Au AND Cu% EQUIV.
- GEOLOGY**
- OVERBURDEN
- EARLY JURASSIC**
- MONZONITE
- LATE TRIASSIC**
- 3 LATITE FLOWS AND PYROCLASTICS
- TRACHYTE FLOWS AND PYROCLASTICS
- 1 ANDESITIC FLOWS AND PYROCLASTICS



REBAGLIATI GEOLOGICAL CONSULTING LTD		
CLIENT:	CONTINENTAL GOLD CORP	
PROJECT:	MT. MILLIGAN	
TITLE:	MT. MILLIGAN DEPOSIT CROSS SECTION 9100 NORTH	
DRAWN BY:	C.M.R.	DRAWN BY: D.M.C.
DATE:	28 Feb. 90	REVISED BY:
		DATE: 93 N/L 0/4

