

9311 01E

14
10
13
12
11
10

1215

MUTZ LAKE

MT. MILLIGAN
DEPOSIT

HEAT LAKE

CAMP

CREEK

CARIBOO LAND DISTRICT

37

38

1065

93-01E

S

T

1468

W

1327

1500

1250

1050

885713

Mt. Mulligan

CREEK

Rain

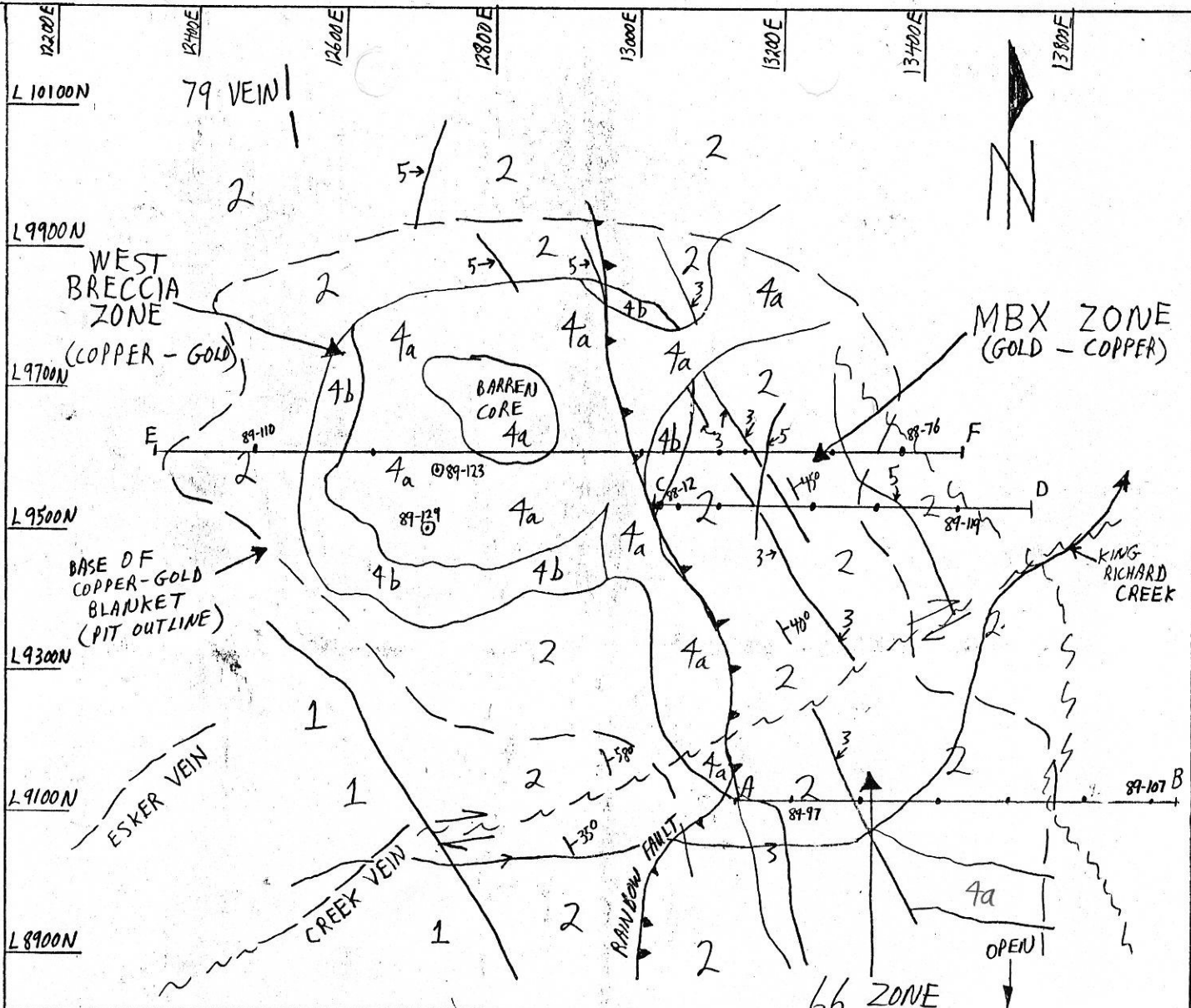

INTRUSIVES

JURASSIC-CRETACEOUS (Post Mineralization)

5 Diorite and Monzonite Dykes

EARLY JURASSIC (Syn-Mineralization)

4 Monzonite 4a. Porphyry
4b. Hybrid/Breccia

SUPRACRUSTAL ROCKS

LATE TRIASSIC (TAKLA GROUP)

3 Latite Flows and Pyroclastics (markers)

2 Trachyte Flows and Pyroclastics

1 Andesitic Flows and Pyroclastics

150°-bedding

~ ~ ~ - normal fault

—|—|—| - reverse fault

○ - drill hole
89-123 location for zircon dating
A B
89-110 89-76
Cross section with drill holes

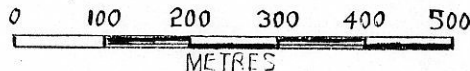

MT. MILLIGAN

1050 LEVEL PLAN

(DDH'S PROJECTED VERTICALLY FROM SURFACE)

(From Company plans)

Tam Schraeter July 4, 1989

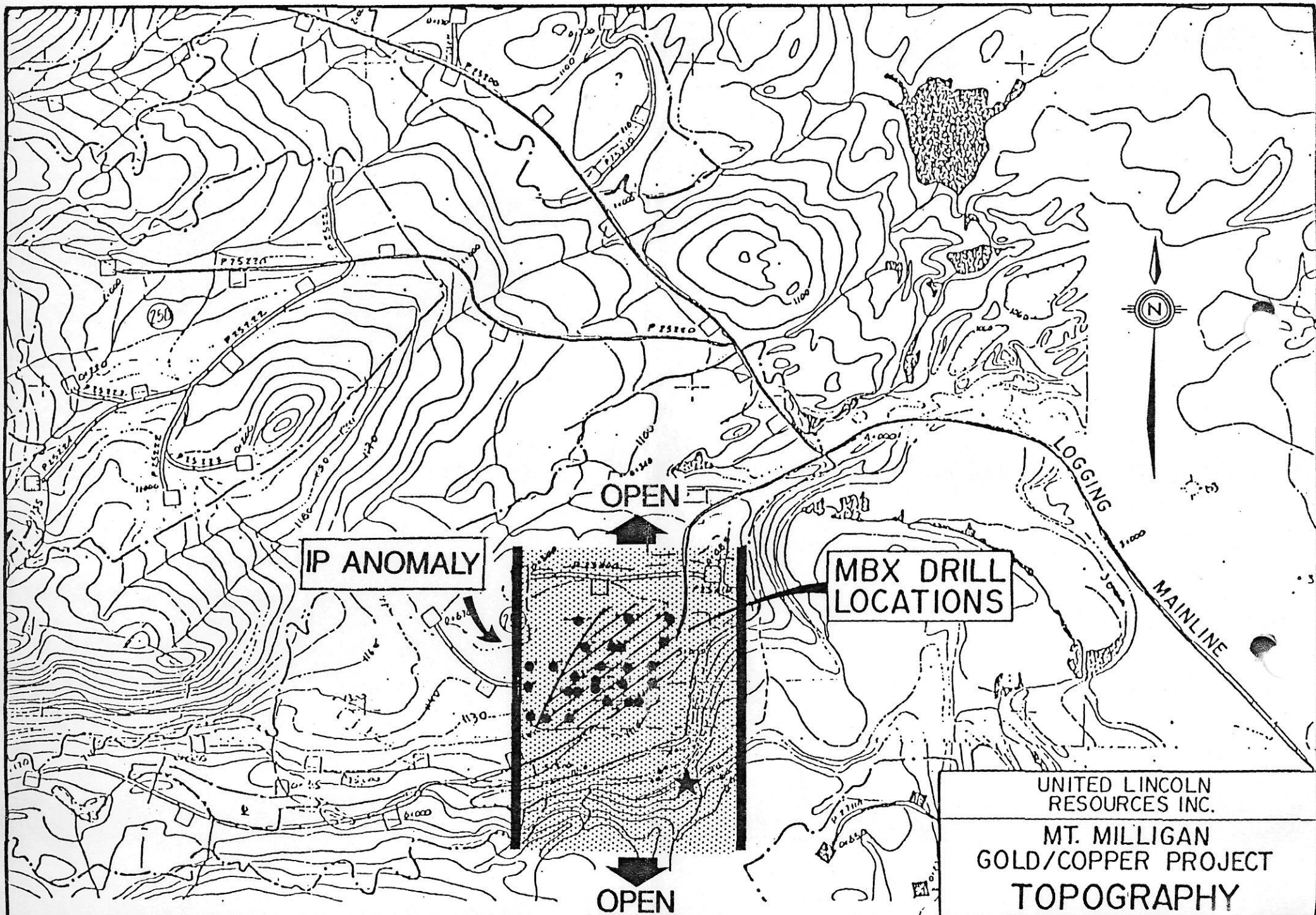

IP ANOMALY

MBX DRILL LOCATIONS

OPEN

OPEN

METRES 0 200 400 800 METRES

UNITED LINCOLN
RESOURCES INC.
MT. MILLIGAN
GOLD/COPPER PROJECT
TOPOGRAPHY

★ copper and gold mineralization in creek

Drawn J.W.	Date Oct. 1988	FIG.
Scale As shown		

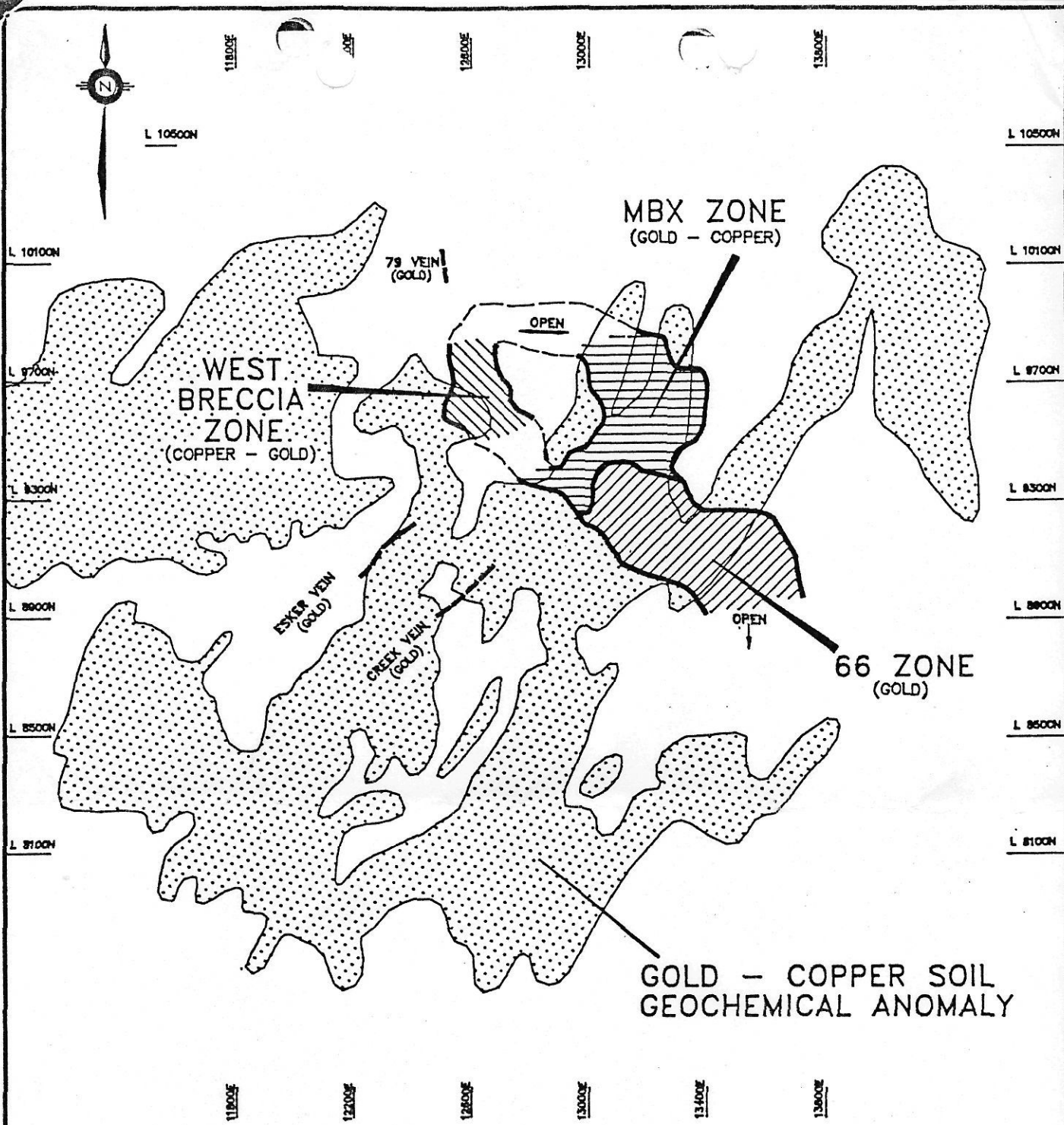
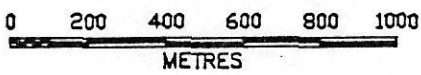
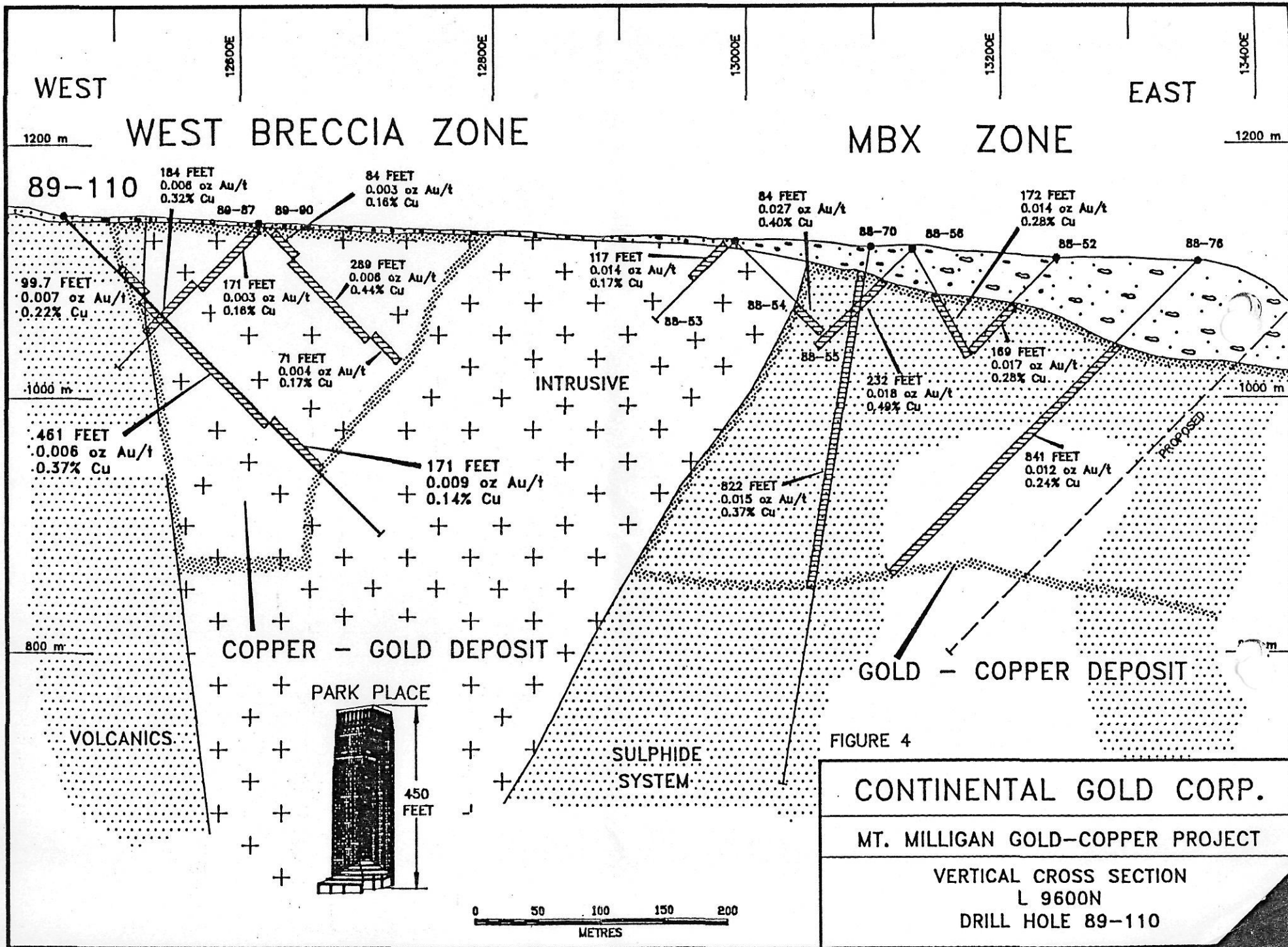

FIGURE 5

CONTINENTAL GOLD CORP.
MT. MILLIGAN GOLD-COPPER PROJECT
GOLD - COPPER DEPOSITS



Prepared by: RWR Mineral Graphics Ltd.



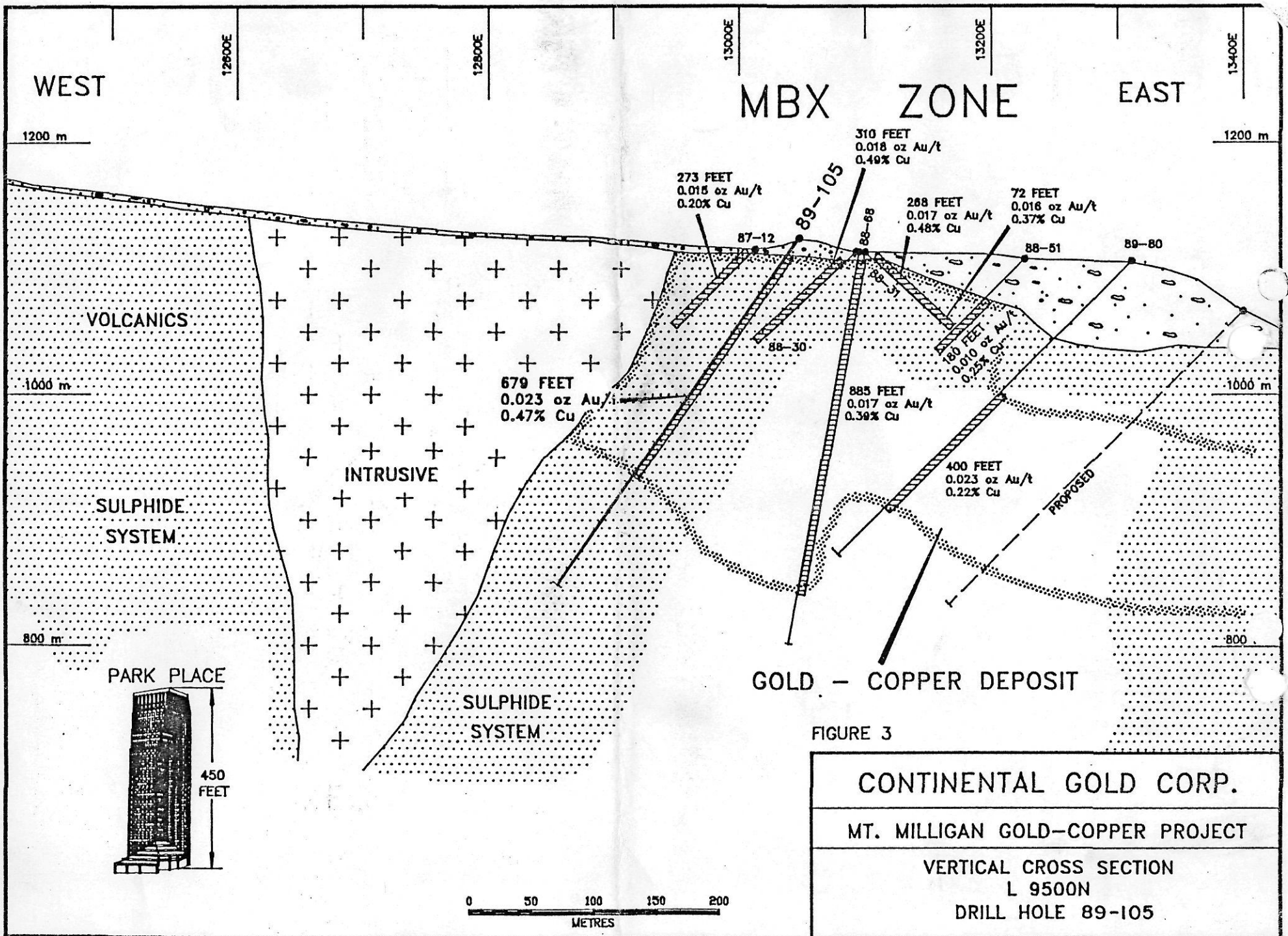

FIGURE 3

CONTINENTAL GOLD CORP.

MT. MILLIGAN GOLD-COPPER PROJECT

VERTICAL CROSS SECTION

L 9500N

DRILL HOLE 89-105

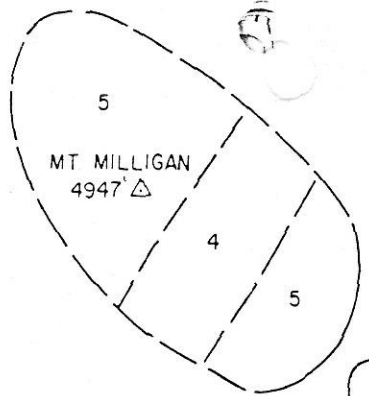

PROPERTY
BOUNDARY

MBX DRILL
LOCATIONS



LEGEND

UPPER TRIASSIC INTRUSIVES

- 7 Quartz Monzonite porphyry Complex
- 6 Diorite Porphyry
- 5 Monzonite
- 4 Diorite

TAKLA VOLCANICS

- 3 Augite Porphyry Flows
- 2 Tufts
- 1 Coarse Breccia

SOIL ANOMALIES

- ≧ 50 ppb Au ————
- ≧ 100 ppm Cu - - - -
- ≧ 25 ppm As ······

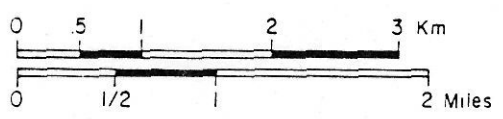

**EXTENSIVE GOLD/COPPER
GEOCHEMICAL ANOMALIES**

UNITED LINCOLN
RESOURCES INC.

**MT. MILLIGAN
GOLD/COPPER PROJECT
COMPILATION MAP**

Drawn. JW.	Date. Oct. 1988	FIG.
Scale. As shown		9

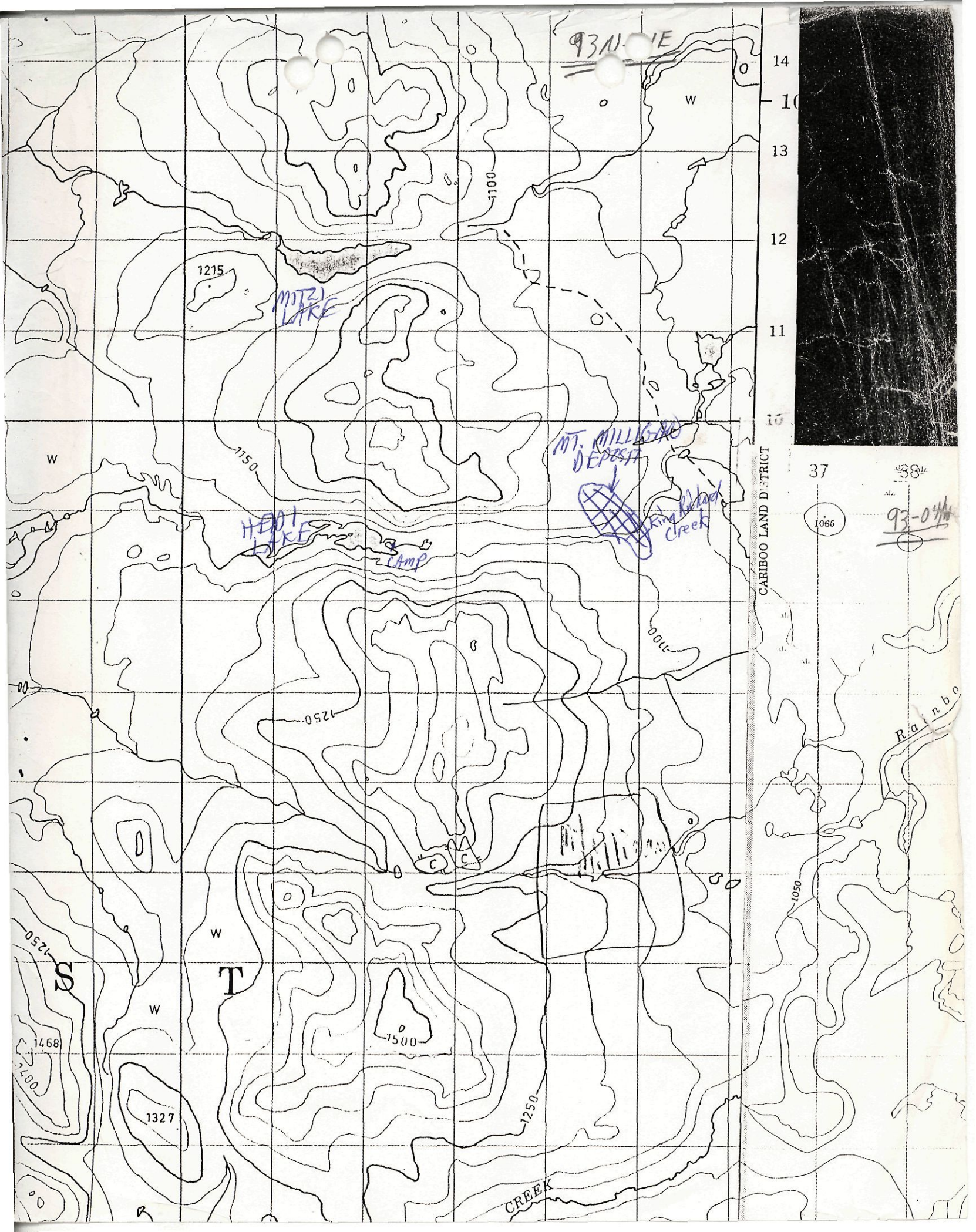

93N-1E

14
10
13
12
11
10

1215

MTZ LAKE

MT. MILLER DEPOSIT

HEAT LAKE

CAMP

King Richard Creek

CARIBOO LAND DISTRICT

37

38

1065

93-0 1/2

S

T

Rainbo

CREEK

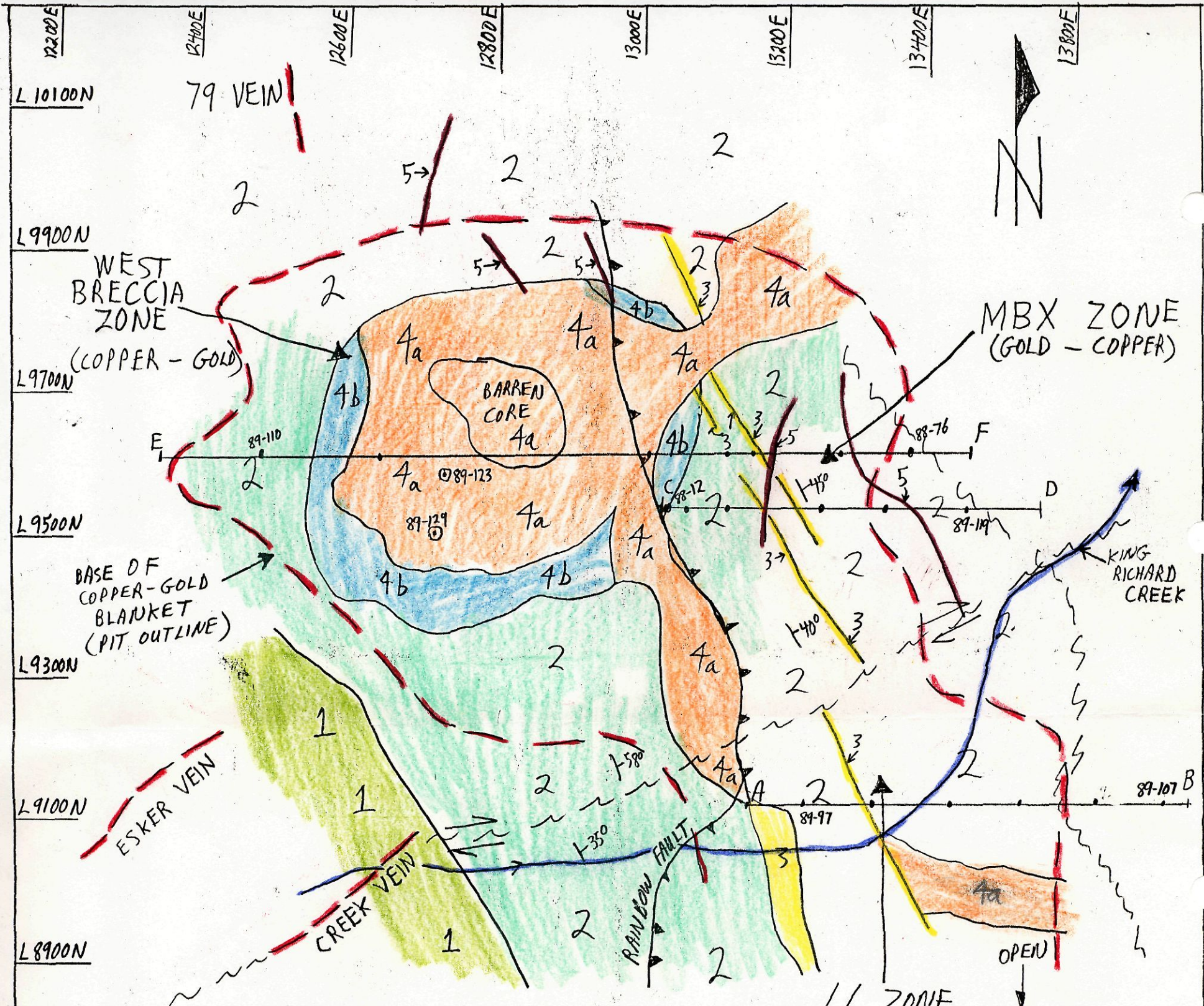

INTRUSIVES

- JURASSIC-CRETACEOUS (Post Mineralization)
- 5 Diorite and Monzonite Dykes
- EARLY JURASSIC (Syn-Mineralization)
- 4 Monzonite 4a Porphyry
- 4b Hybrid/Breccia

SUPRACRUSTAL ROCKS

- LATE TRIASSIC (TAKLA GROUP)
- 3 Latite Flows and Pyroclastics (markers)
- 2 Trachyte Flows and Pyroclastics
- 1 Andesitic Flows and Pyroclastics

- $\sim 50^\circ$ - bedding
- ~~~~~ - normal fault
- |——— - reverse fault
- - drill hole location - for zircon dating
- 89-123
- A — B cross section with drill holes
- 89-110 89-76

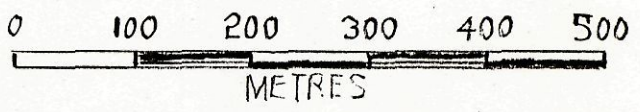

MT. MILLIGAN

1050 LEVEL PLAN

(DDH'S PROJECTED VERTICALLY FROM SURFACE)

(From Company plans)

Tom Schroeter July 4, 1989

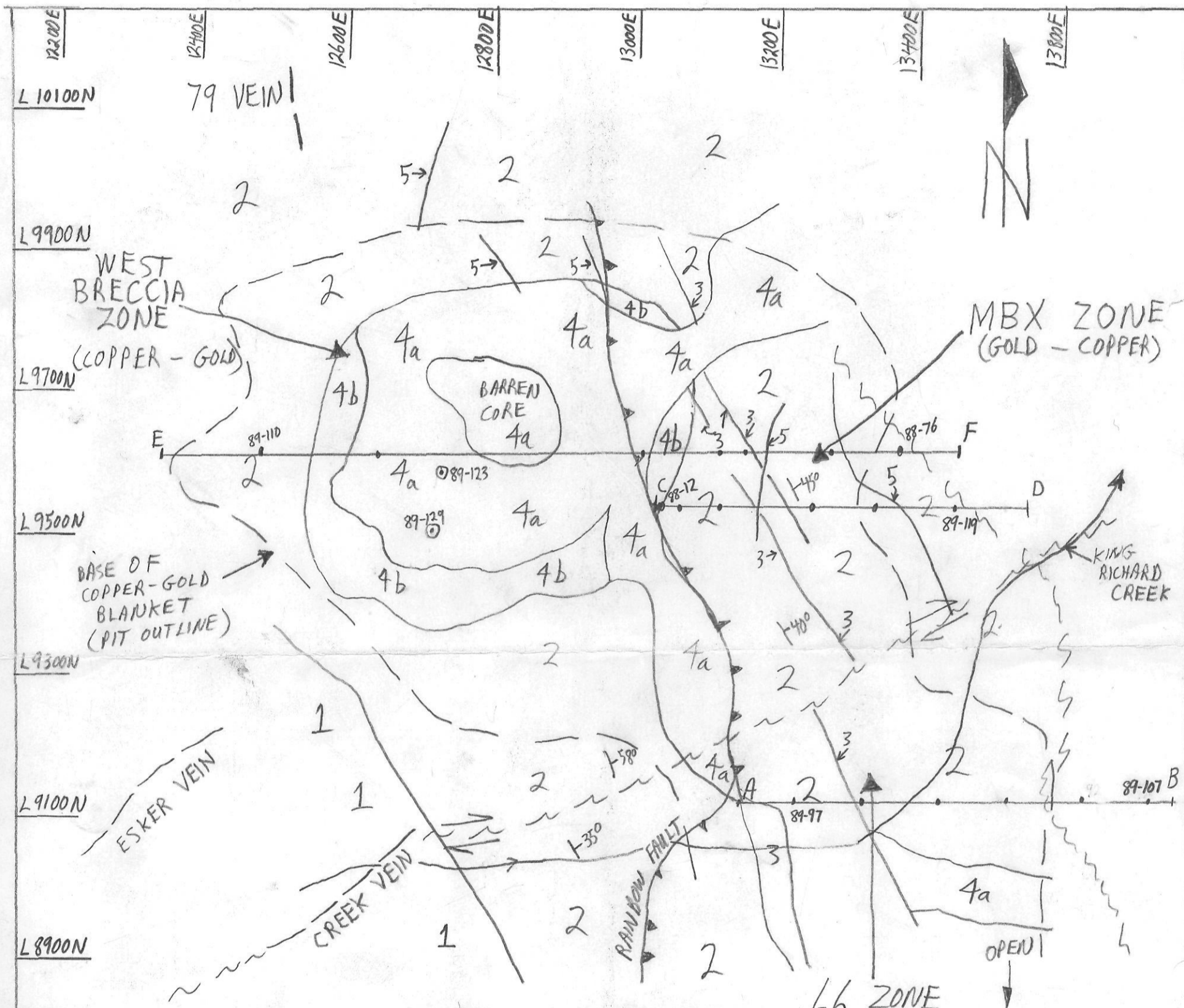

INTRUSIVES

JURASSIC-CRETACEOUS (Post Mineralization)

5 Diorite and Monzonite Dykes

EARLY JURASSIC (Syn-Mineralization)

4 Monzonite 4a. Porphyry
4b. Hybrid/Breccia

SUPRACRUSTAL ROCKS

LATE TRIASSIC (TAKLA GROUP)

3 Latite Flows and Pyroclastics (markers)

2 Trachyte Flows and Pyroclastics

1 Andesitic Flows and Pyroclastics

F50° - bedding

~ ~ ~ - normal fault

▲ - reverse fault

○ - drill hole location - for zircon dating
89-123
A B cross section with drill holes
89-110 89-76

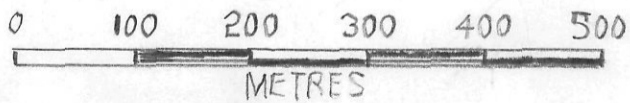

MT. MILLIGAN

1050 LEVEL PLAN

(DDH'S PROJECTED VERTICALLY FROM SURFACE)

(From Company plans)

Tom Schroeter July 4, 1989

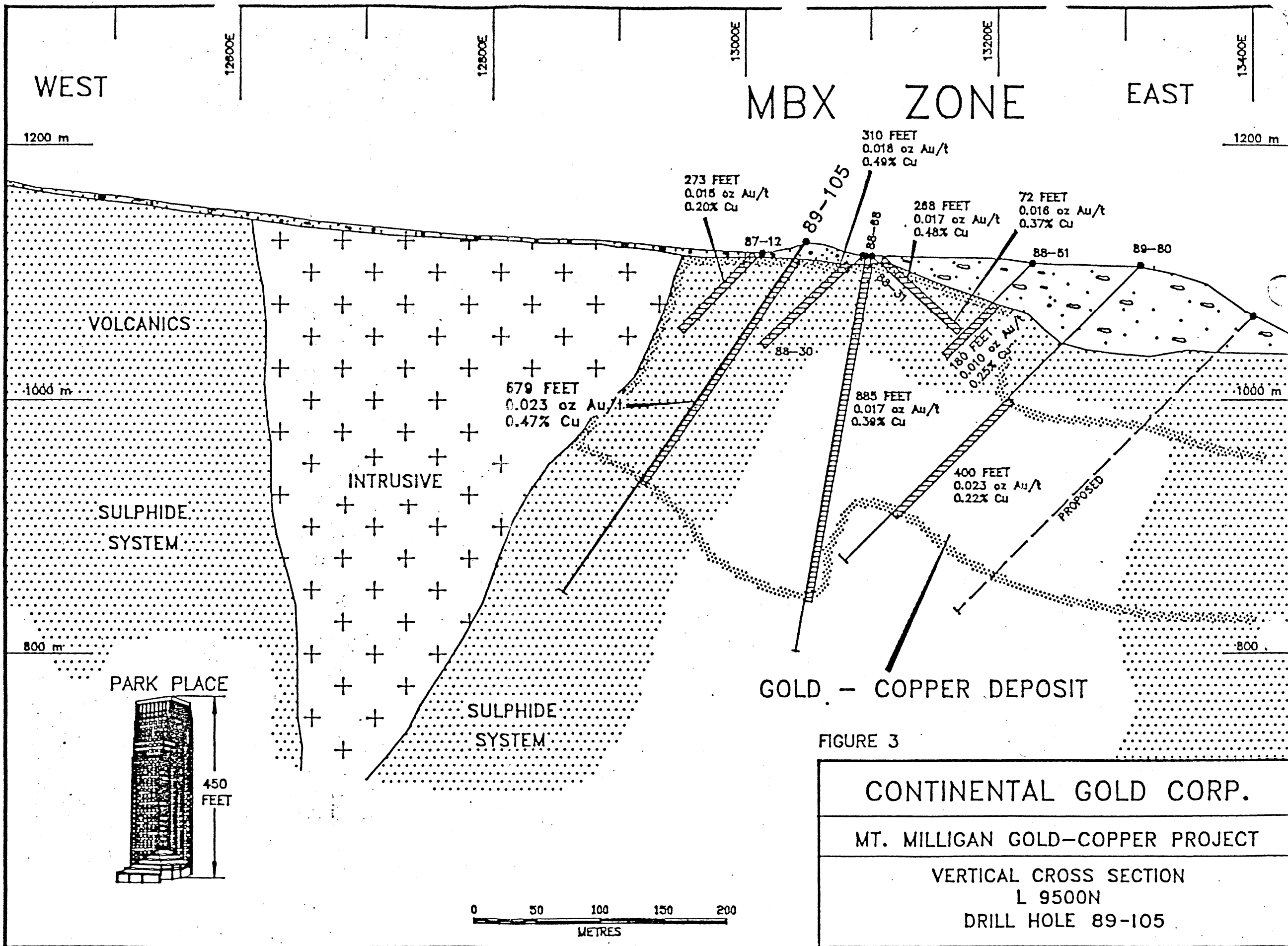

WEST

EAST

66 ZONE

1200 m

1200 m

130

132

1340

1360

1380

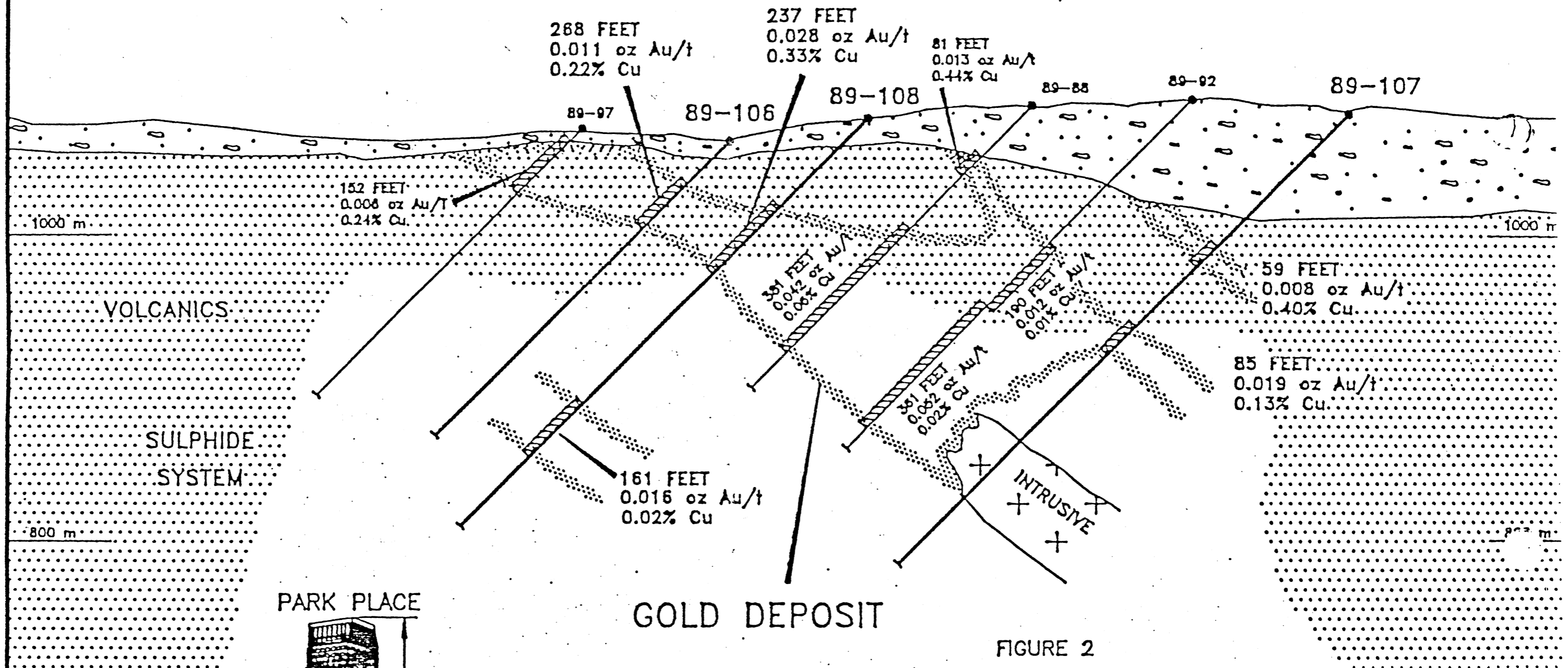

PARK PLACE

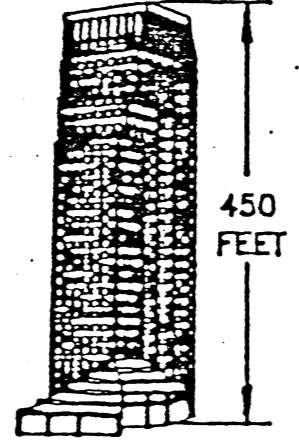

FIGURE 2

CONTINENTAL GOLD CORP.

MT. MILLIGAN GOLD-COPPER PROJECT

VERTICAL CROSS SECTION
L 9100N

DRILL HOLES 89-106, 107 & 108

WEST

EAST

WEST BRECCIA ZONE

MBX ZONE

1200 m

1200 m

12800E

12800E

13000E

13200E

13400E

89-110

184 FEET
0.008 oz Au/t
0.32% Cu

84 FEET
0.003 oz Au/t
0.18% Cu

84 FEET
0.027 oz Au/t
0.40% Cu

172 FEET
0.014 oz Au/t
0.28% Cu

99.7 FEET
0.007 oz Au/t
0.22% Cu

171 FEET
0.003 oz Au/t
0.18% Cu

289 FEET
0.008 oz Au/t
0.44% Cu

117 FEET
0.014 oz Au/t
0.17% Cu

84 FEET
0.027 oz Au/t
0.40% Cu

172 FEET
0.014 oz Au/t
0.28% Cu

1000 m

1000 m

INTRUSIVE

71 FEET
0.004 oz Au/t
0.17% Cu

232 FEET
0.018 oz Au/t
0.49% Cu

169 FEET
0.017 oz Au/t
0.28% Cu

461 FEET
0.006 oz Au/t
0.37% Cu

171 FEET
0.009 oz Au/t
0.14% Cu

822 FEET
0.015 oz Au/t
0.37% Cu

841 FEET
0.012 oz Au/t
0.24% Cu

800 m

COPPER - GOLD DEPOSIT

GOLD - COPPER DEPOSIT

VOLCANICS

PARK PLACE

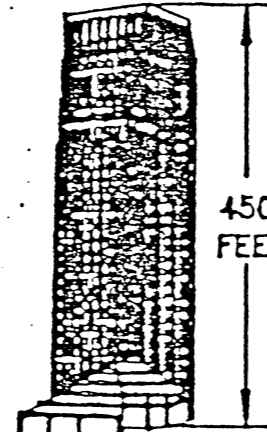

450 FEET

SULPHIDE SYSTEM

FIGURE 4

CONTINENTAL GOLD CORP.

MT. MILLIGAN GOLD-COPPER PROJECT

VERTICAL CROSS SECTION

L 9600N

DRILL HOLE NO. 110

0 50 100 150 200

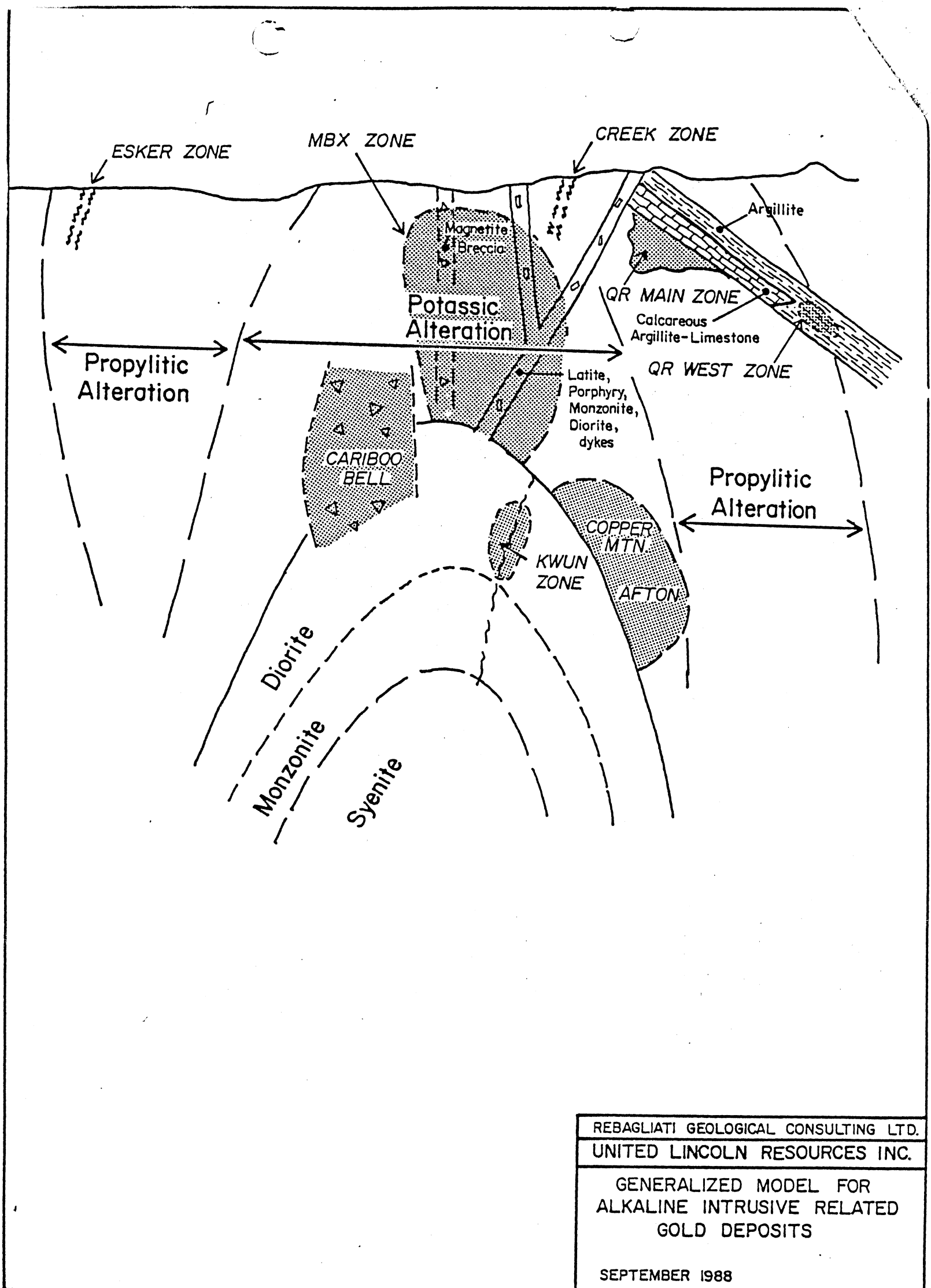

REBAGLIATI GEOLOGICAL CONSULTING LTD.
UNITED LINCOLN RESOURCES INC.
GENERALIZED MODEL FOR ALKALINE INTRUSIVE RELATED GOLD DEPOSITS
SEPTEMBER 1988

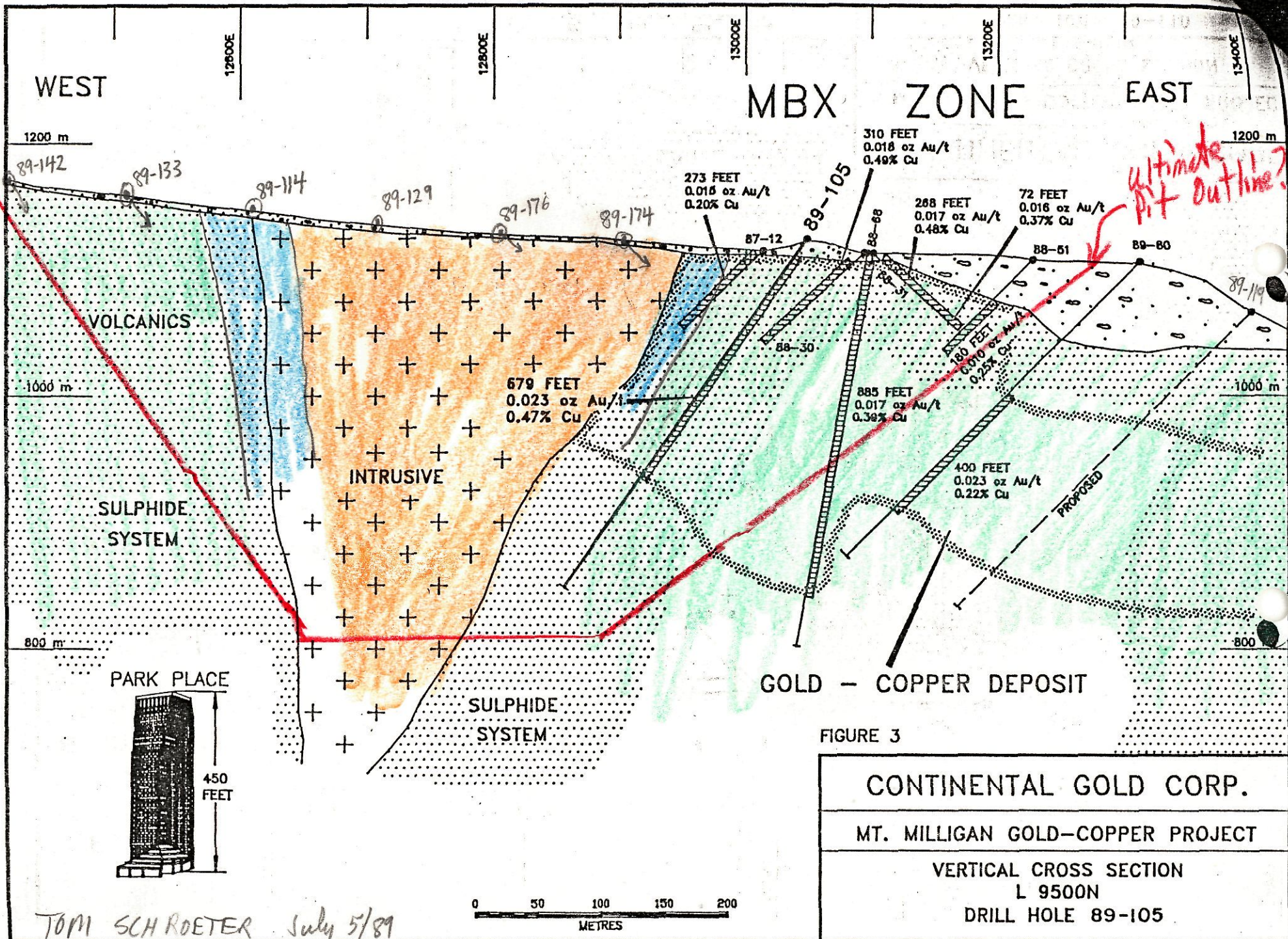

FIGURE 3

CONTINENTAL GOLD CORP.

MT. MILLIGAN GOLD-COPPER PROJECT

VERTICAL CROSS SECTION
L 9500N
DRILL HOLE 89-105

TOM SCHROETER July 5/89

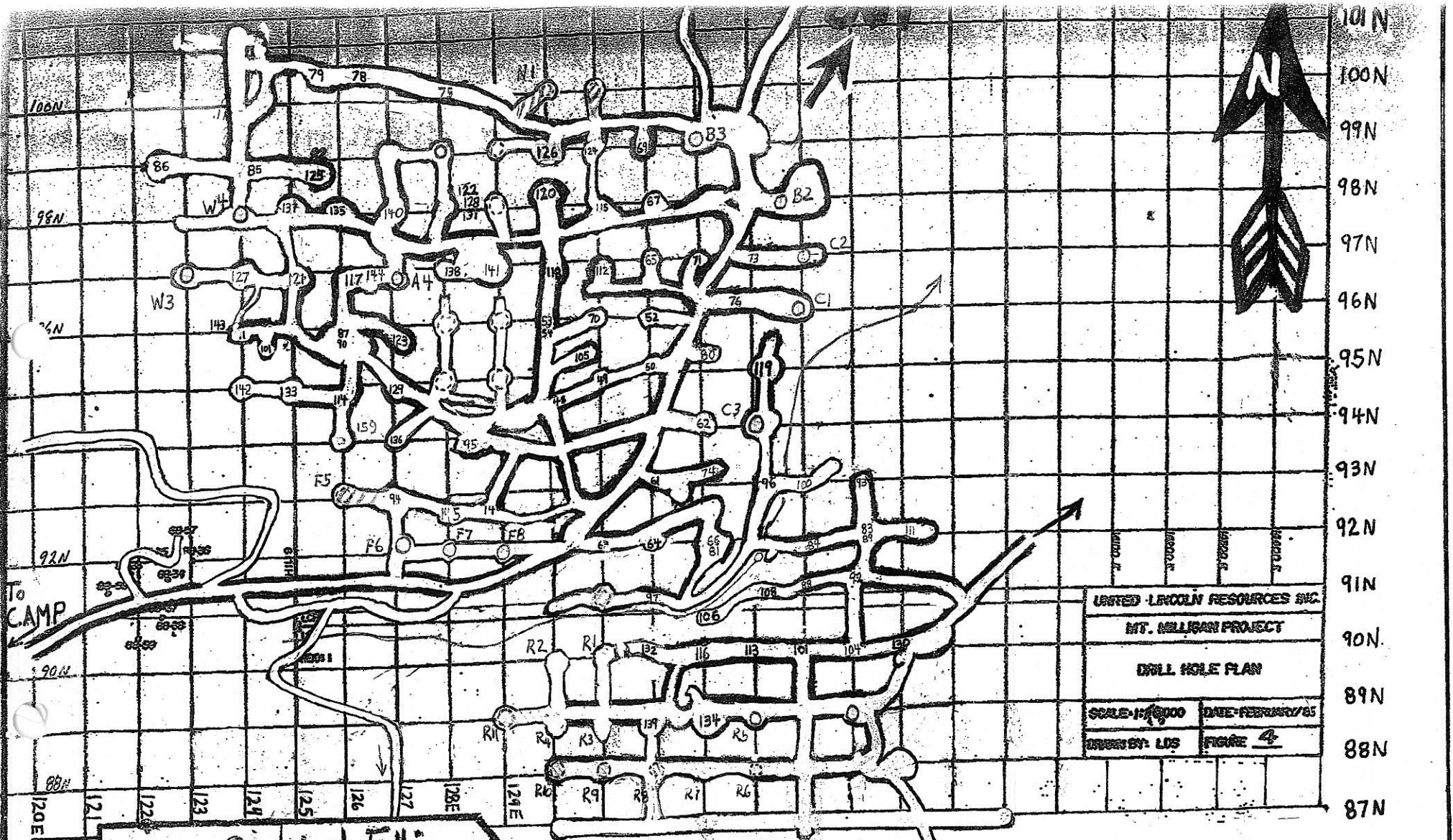

UNITED LINCOLN RESOURCES INC.
 MT. MULLIGAN PROJECT
 DRILL HOLE PLAN
 SCALE: 1:5000 DATE: FEBRUARY/85
 DRAWN BY: LDS FIGURE 4

○	Need Felling
○	Need Skidding
○	Need Dozing
○	Need Survey
○	Need FS, BS, Collar
○	TOTALLY READY

DATE: 16/05/89

BUSHWORKS MAP