

West High Yield (W.H.Y.) Resources

www.whyresources.com

Mineral Project: **ROSSLAND GOLD CAMP**

The camp is one of British Columbia's major gold mining districts with over 3 million ounces of gold and 3.5 million ounces of silver produced from the Le Roi and other mines in the Main belt.

Summary

Location: 3 km Southwest
Rosland BC Canada.

Minerals: Porphyry style and
ultramafic deposit –
hosting gold and silver

Ownership: 100% ownership surface
and underground in 8
crown grants except two
at 51%. All staked
claims at 100%
ownership. 2750
contiguous hectares.

Access: Full infrastructure in
place, electrical power to
mine site and roads
throughout.

Status: Advanced exploration.
Permits in place for
drilling and bulk sample
(10,000 Ton)

Highlights

- Listwanite Lode Gold Deposit in ultramafics.
- Average grade of 0.47 opt gold (Au) and 0.6 opt silver (Ag) and 1.1% copper (Cu.).
- MS-93 R 5 91N – 33 130 ft to 141.5 ft 11.5 ft average of 0.85 oz/ton Au including 3.5 ft of 1.450 oz/ton and 8 ft of 0.477 oz/ton Au

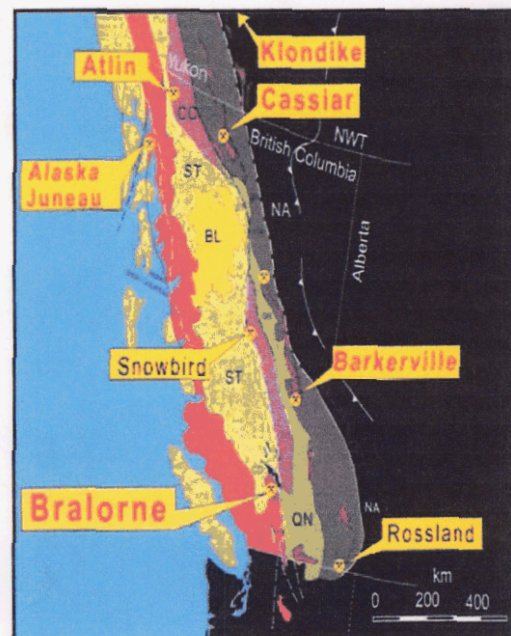

Midnight, IXL and OK (Northern) Ultramafic

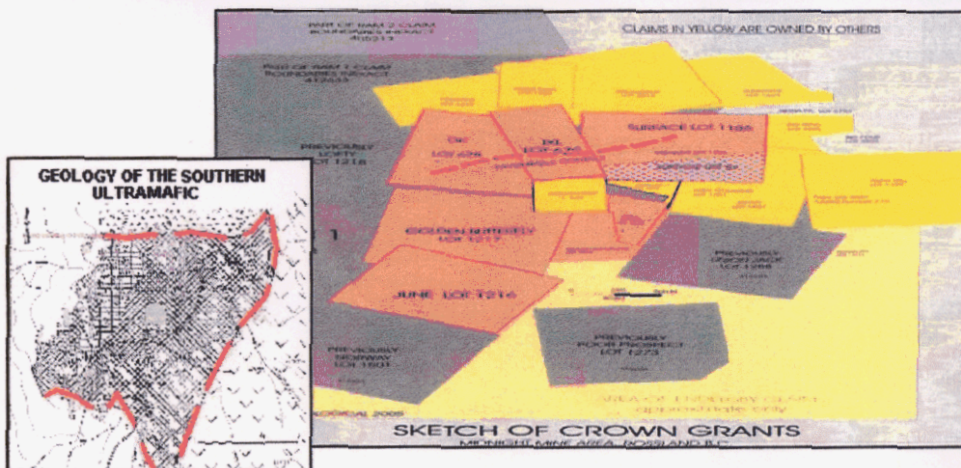

The Southern Ultramafic is 7 times larger than the advanced exploration on the Midnight, IXL and OK (Northern) Ultramafic.

Investor Contact

info@whyresources.com

West High Yield (W.H.Y.) Resources

P.O. Box 68121 Crowfoot Centre
Calgary, Alberta Canada T3G 3N8
Tel: (403) 283-5555 Fax: (403) 206-7159

| | Number of Units | Price to Public |
|------------------|-----------------|-----------------|
| Per Unit | 1 | \$0.40 |
| Minimum Offering | 4,000,000 | \$1,600,000 |
| Maximum Offering | 5,000,000 | \$2,000,000 |

Visited by TGS + DG - Aug. 26/06

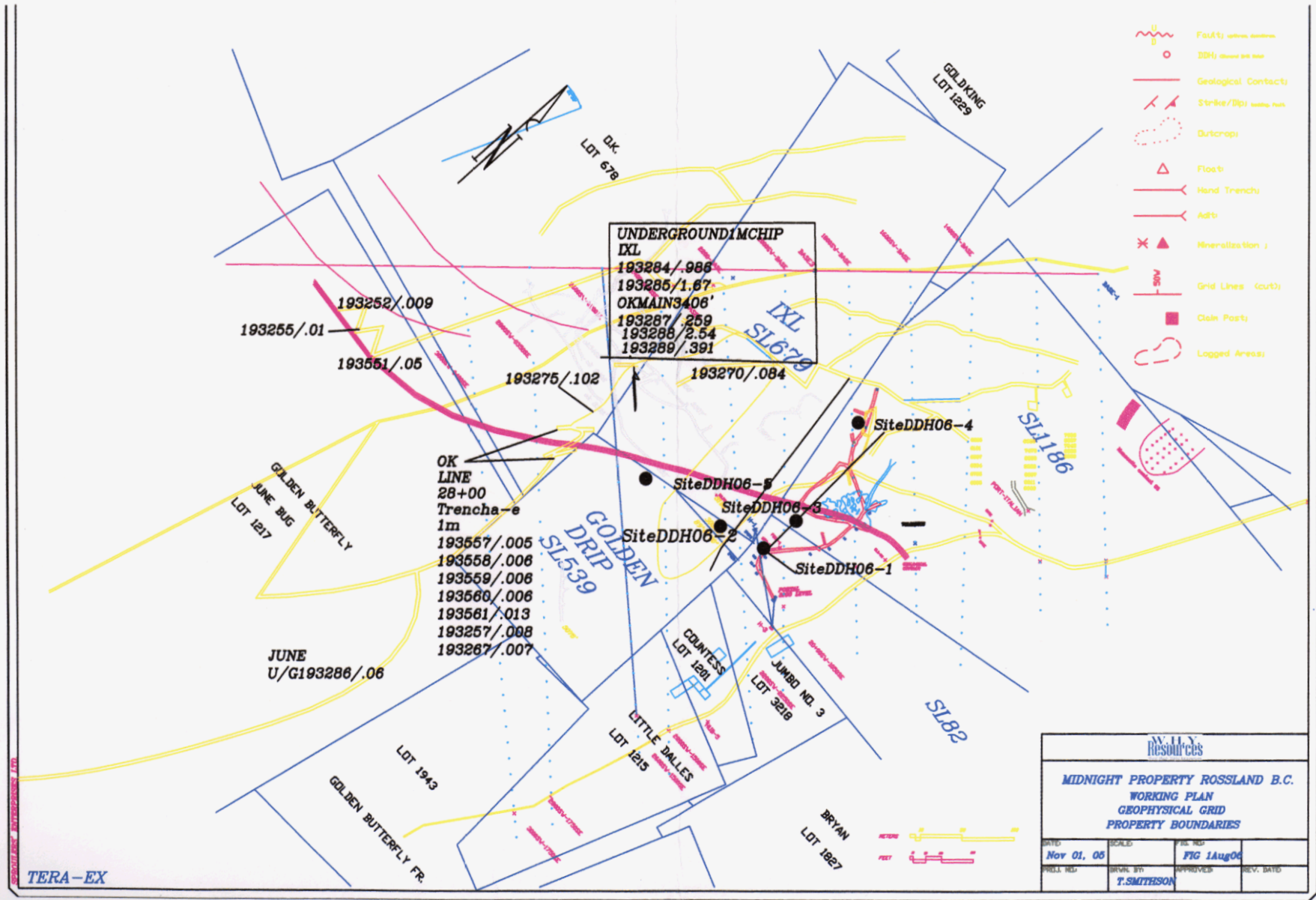

- Fault (with location)
- DBH (with location)
- Geological Contacts
- Strike/DBH (with location)
- Ditch
- Float
- Hand Trench
- Adit
- Mineralization
- Grid Lines (cut)
- Claim Post
- Logged Area

UNDERGROUND MCHIP IXL
 193284/.986
 193285/1.67
 OK MAINS 340'
 193287/.259
 193288/2.54
 193289/.391

OK LINE
 28+00
 Trench - e
 1m
 193557/.005
 193558/.008
 193559/.006
 193560/.006
 193561/.013
 193257/.008
 193267/.007

JUNE
 U/G 193286/.06

| | | | |
|--|----------|--------------|------|
| WILLY Resources | | | |
| MIDNIGHT PROPERTY ROSSLAND B.C. | | | |
| WORKING PLAN | | | |
| GEOPHYSICAL GRID | | | |
| PROPERTY BOUNDARIES | | | |
| DATE | SCALE | FIG. NO. | REV. |
| Nov 01, 06 | | FIG 1 Aug 06 | |
| DRAWN BY | APPROVED | REV. DATE | |
| T. SMITHSON | | | |

TERA-EX