

La Bahia + Khe

Sonora

Sonora Mining Seminar

Vancouver, Canada

November 10, 1992

885017

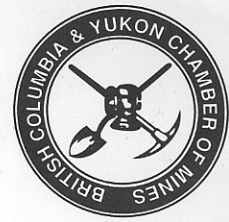

1

LOON — Ed Yarrow

3002 Ag disc.

Jan. 17/94

Best Drill Assay (CONFIDENTIAL)

2.65m @ 6 g/t Au + 34 g/t Ag

- argill. alt'd (not bx) + narrow chaledonic.

40-400 ppb Au

- tuffaceous (cf. flows)

Mo up to 400 ppm (10'-40') 'no' W
As

tested to 30m depth

PY — ab. (>10%)
assoc. with bx.

N-S IP — anomalies.

Boat LK.

5ddh = 775m

NE Anomaly zone — open

94-1

SE Anomaly

94-2

Main zone
(N. of main)

94-3, 4

94-5

ZnS, cpy (in chaledonic vein)

py (after marcasite)

1995

— in to trench/rd. build asap in spring
follow up ddh in fall.

Lucas (W. of Knewstah) — geochem

Snag — S. of Loon
— up to 6 g/t Au

Moss/Naglico

X-ray: no adularia
— illite, kaolinite, smectite



LOON
Jan. 17/95

93·E/9 | 93·F/12
112°00'

2

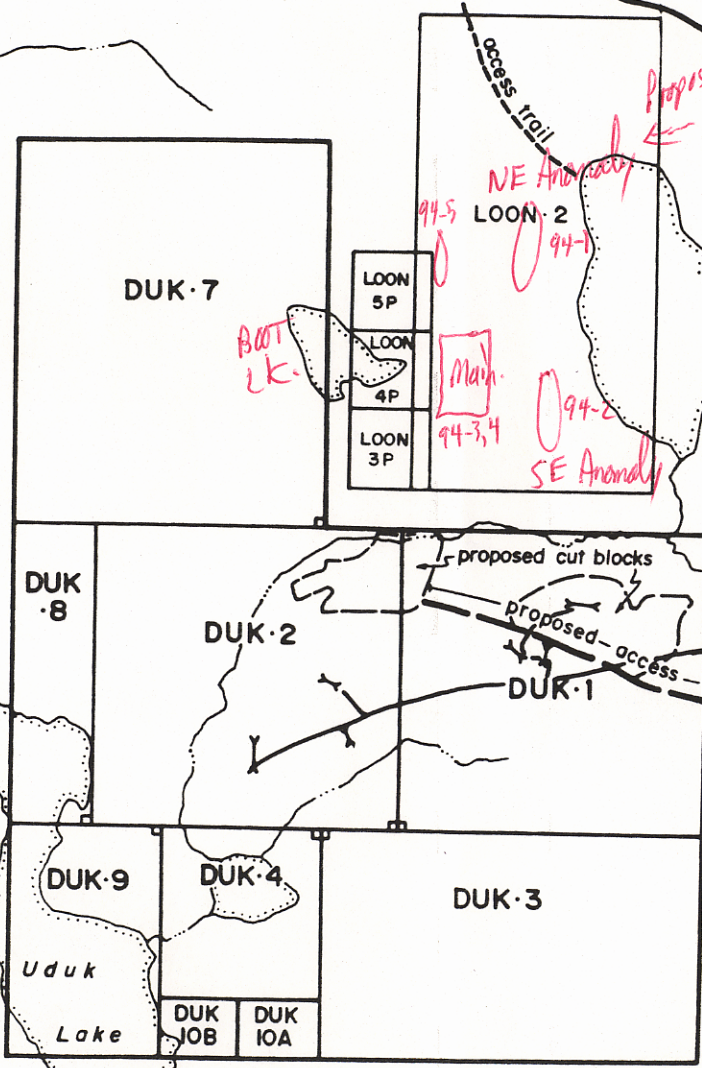

53°36'

SNAG cb. (logema)
- up to 69 ft Au ↓

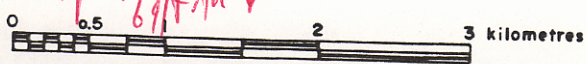

| | | |
|----------------------------|-----------|--------|
| Pioneer Metals Corporation | | |
| UDUK LAKE PROPERTY | | |
| Omineca M.D., B.C. | | |
| Claim Map | | |
| NTS 93·E/9,F/12 | | |
| Scale | Date | Figure |
| 1 : 50,000 | Oct. 1994 | 2 |