

# LAKEVIEW

Sat. Aug. 15/87

with BM + DM

Cloudy 17C

- Linda Dandy - log cabin in Pine Crk. subdivision
- Dave Strain

1) gte-carb vein in ultramafics/mafics shear zone (40 veins) E ~ 200m long lakeview

2) skarns - SW flank of Ruby Mtn (east of Black Diamond tungsten prospect)

- west & east sides of Boulder Crk.

-> no gold but good Ag, Sn, W, Cu, Bi.

Lakeview - at least 4 main vein systems

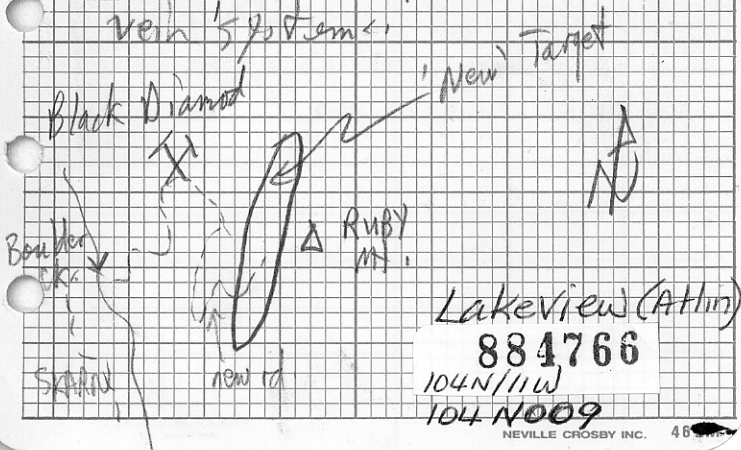

Diphen Survey (enhanced magnetics  
+ total field magnetics)  
show ultramafics + alt'n  
very well!

TARGETS - edge of ultramafics  
(= gtz + leaching).

Photos - Looking NE towards Lakeview  
+ Ruby Mts.

- Looking NE towards Lakeview  
+ Black Diamond.

- Looking W towards Lakeview

- Looking NE over Boulder Ct.  
skarn trenches towards  
new skarn on Ruby Mts.

Thurs. Sept. 1/77

- talk with Bob Hablin in Houston  
re-sibola cls. + also Fenton  
CK area.

LAKEVIEW (with Noranda  
+ John Bot)

2 pics looking N-SE across  
lakes + access rd. to left +  
Houston valley to it,

north end of trench

angular chloritic frags. string out in acid  
pyroclastic  $025^{\circ}$

Dykes of unmin. ands. in  
acid pyroclastics.

Vein pinches + swells

- radiating tremolite xls,

- Upper Trench ~ 1000ft. long - white  
to pink A.P. - ands. dykes. Non-min.

L-5

040°/70°NW

12 ft wide

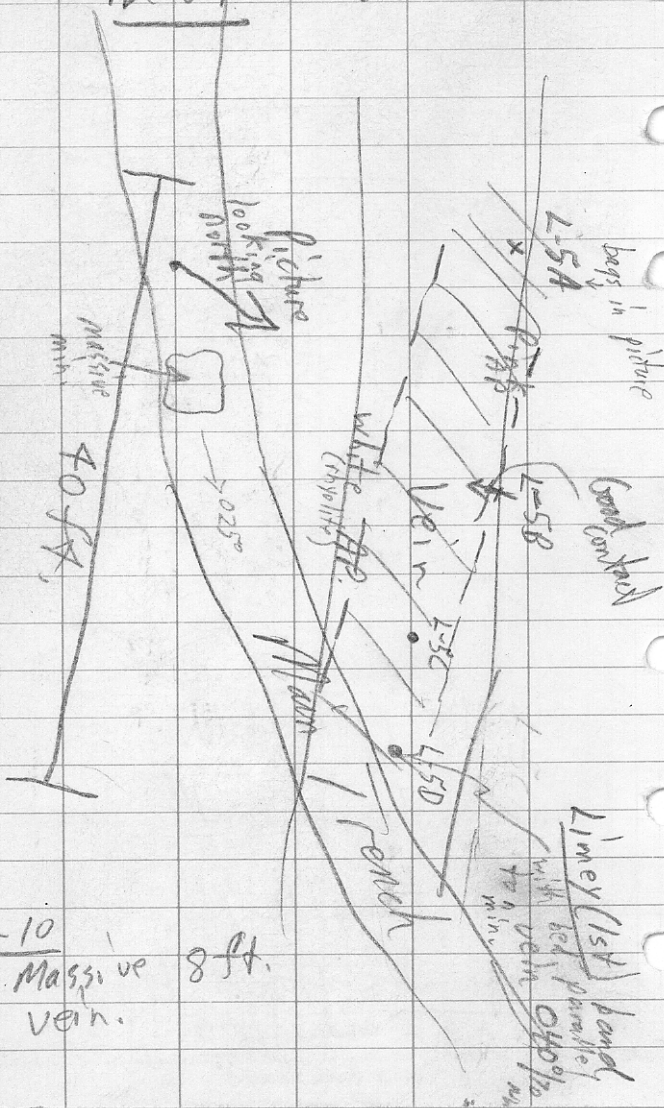

A

025° ↑

400  
300  
200  
100  
0

vein 1/2"  
10-12" vein

Pic. Looking north  
along vein from  
L-10 front  
(winze of round  
of green bush)

MIN.  
Massive hemi  
+ cpv + epidote  
in acid py.

South Dump  
~ 100 tons?

carpi - horn  
acid (pyroxene)  
L-5

upper  
030°  
zone  
of massive  
acid  
in AP

4ft wide  
basic v. vein  
parallel to vein  
160°

150ft. long  
upper  
winze

bedding  
025°

dark veins  
025°

1st hemi  
4ft wide  
025°

Total Distance - north to south ~ 1000 ft

Hanging wall - green acid py.

Footwall - pink-white acid py.

Min. appears to follow contact of above + possibly cpy zone below hematite zone.  
- assoc. with limy beds also.

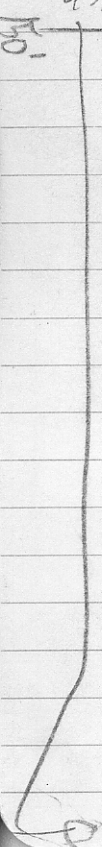

Picture looking SW along 'trench' at winze L-13 showing contact (mal.)

