

PROVINCE OF
BRITISH COLUMBIA

MINISTRY OF
ENERGY, MINES AND
PETROLEUM RESOURCES

MINERAL TITLES REFERENCE

MAP 104A04E

U.T.M. ZONE 9

LAST MAP UPDATE: 1992 JUN 16

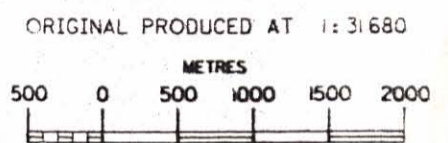

ADMINISTRATIVE AREAS

MINING DIVISIONS: SKENA

LAND DISTRICTS:

*GOAT, ICE,
HUGH*

ALIENATIONS

NO STAKING AREAS -----

NO STAKING RESERVES

PARKS

ECOLOGICAL RESERVES

RECREATION AREAS

INDIAN RESERVES

CONDITIONAL AREAS

SUBJECT TO CONDITIONS RESERVES

SECTION 19 RECREATION AREAS

POST CLAIM AREAS

AREAS SUBJECT TO URANIUM / THORIUM REGULATIONS

MINERAL TENURE

MINERAL CLAIM

MINERAL LEASE

INDUSTRIAL MINERAL CLAIM

CLAIM NAME

TITLE NUMBER

OLD TITLE NUMBER

TAG NUMBER

LEGAL POST

WITNESS POST

FORFEITED TENURE

VERIFIED

SURVEYED

REVERTED C.G. MINERAL CLAIM

CROWN GRANTED

OPEN FOR STAKING

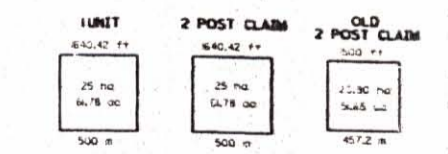

THIS MAP IS PREPARED ONLY AS A GUIDE TO THE LOCATION OF MINERAL TENURE AS SHOWN ON THE LOCATOR'S SKETCHES. FOR CURRENT OR MORE SPECIFIC INFORMATION, APPLICATION SHOULD BE MADE TO THE MINING DIVISION CONCERNED.

| | | |
|---------|---------|---------|
| 104A04E | 104A04E | 104A04E |
| 104A04E | 104A04E | 104A04E |
| 103P03E | 103P03E | 103P03E |

INDEX TO ADJOINING MAPS

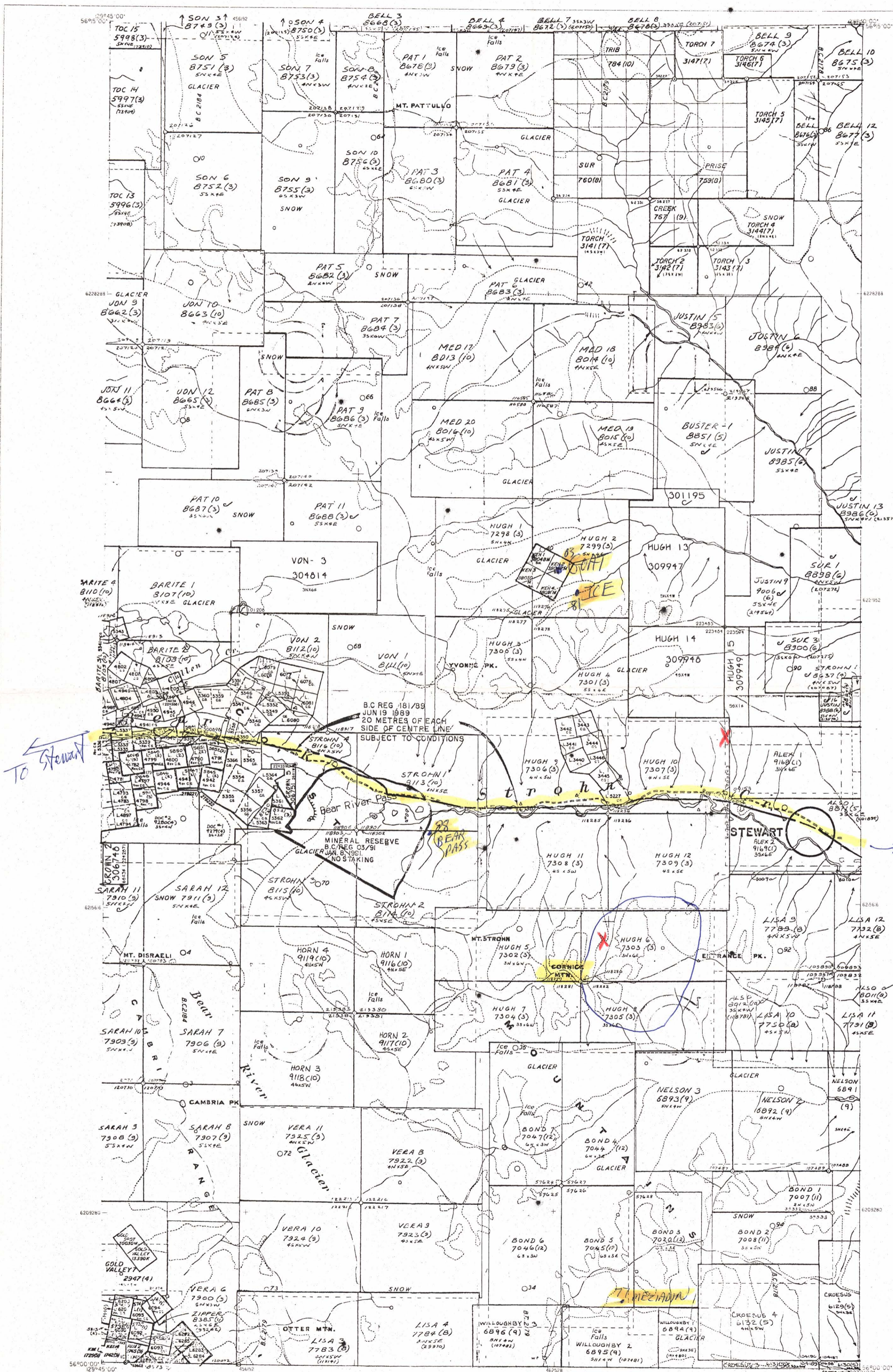

884158
Hugh

104A04E
Oct. 9/92