

MICHAEL J. MOORE 118807

FOX 1 - 22      379156 - 379177

JULY 20/2000

---

GITENNES EXPL. INC 143145

TERRY 3 - 4      381149-50

SEPT ~~21~~ 23/2000





MINISTRY OF ENERGY AND MINES

ENERGY AND MINERALS DIVISION  
MINERAL TITLES BRANCH

MINERAL TITLES REFERENCE

MAP 092107E  
U.T.M. ZONE 10  
LAST MAP UPDATE: 2000 JUL 20

ORIGINAL PRODUCED AT 1:31 680

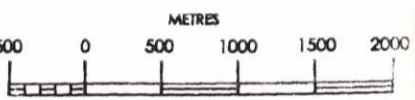

ADMINISTRATIVE AREAS

MINING DIVISIONS: NICOLA,  
KAMLOOPS

LAND DISTRICTS:

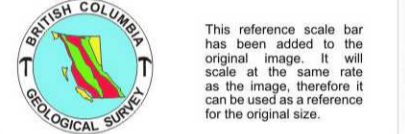
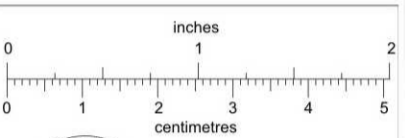

ALIENATIONS

- NO STAKING AREAS
- NO STAKING RESERVES
- PARKS
- ECOLOGICAL RESERVES
- RECREATION AREAS
- INDIAN RESERVES

CONDITIONAL AREAS

- SUBJECT TO CONDITIONS RESERVES
- SECTION 19 RECREATION AREAS
- 1 POST CLAIM AREAS
- AREAS SUBJECT TO URANIUM / THORIUM REGULATIONS

MINERAL TENURE

- MINERAL CLAIM
- MINERAL LEASE
- INDUSTRIAL MINERAL CLAIM
- CLAIM NAME
- TITLE NUMBER
- OLD TITLE NUMBER
- TAG NUMBER
- LEGAL POST
- WITNESS POST
- FORFEITED TENURE
- VERIFIED
- SURVEYED
- REVERTED C.G.
- MINERAL CLAIM
- CROWN GRANTED
- OPEN FOR STAKING

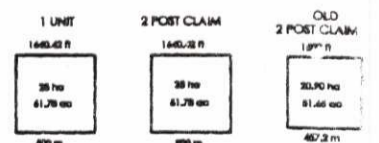

THIS MAP IS PREPARED ONLY AS A GUIDE TO THE LOCATION OF MINERAL TENURE AS SHOWN ON THE LOCATOR'S SKETCHES. FOR CURRENT OR MORE SPECIFIC INFORMATION, APPLICATION SHOULD BE MADE TO THE MINING DIVISION CONCERNED.

09210W	09210E	09209W
09209W	09209E	09208W
09208W	09208E	09207W

INDEX TO ADJOINING MAPS

M 092107E

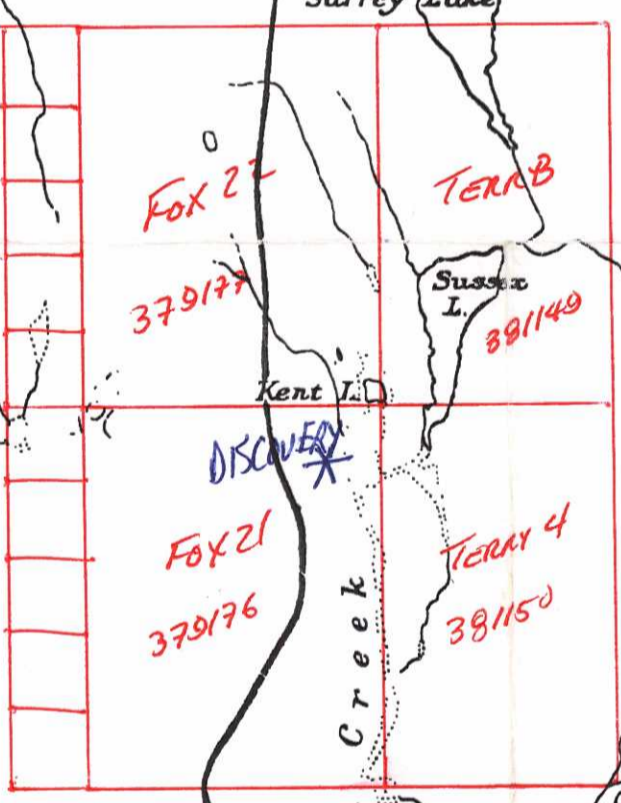
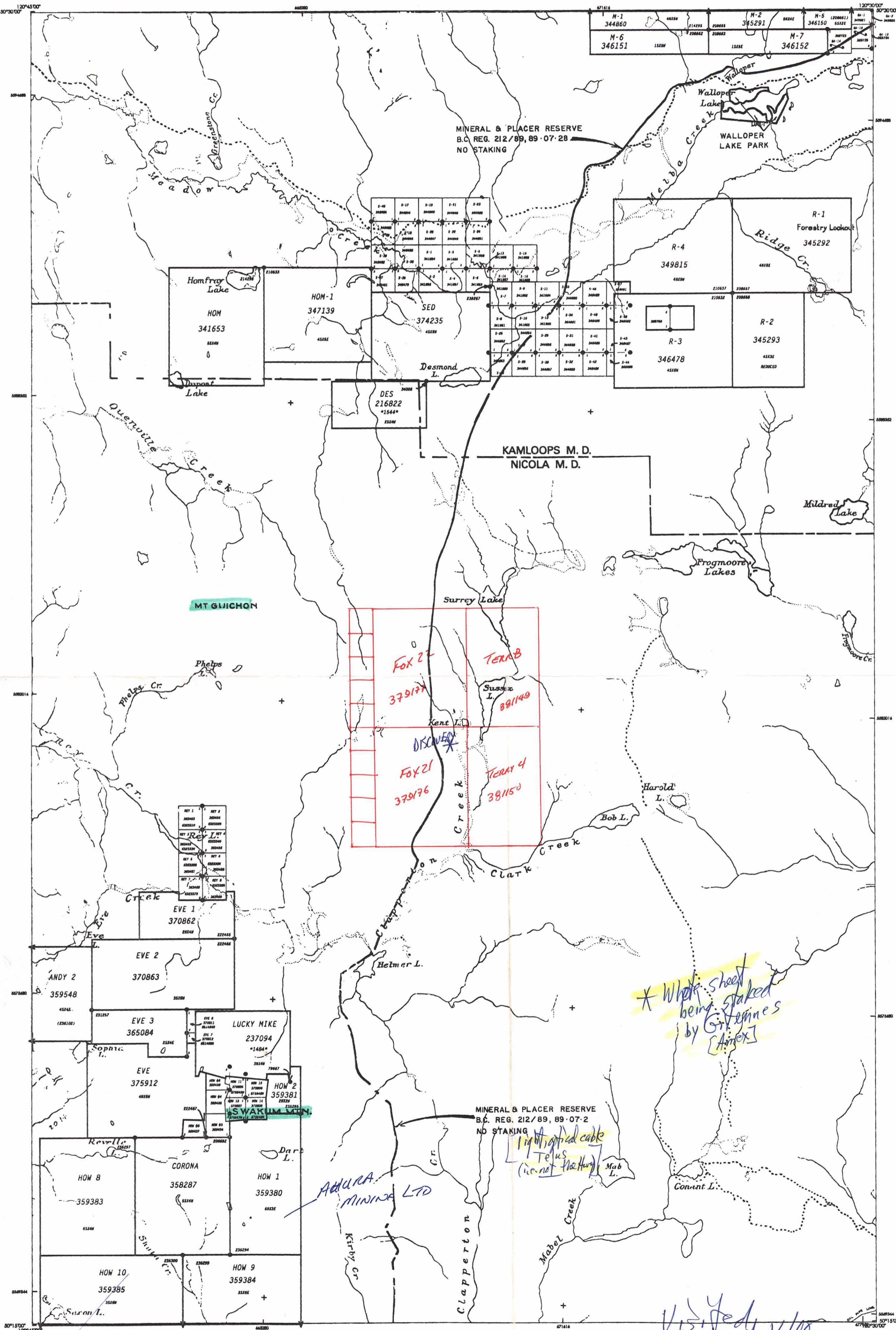

*X Where sheet being staked by Greenes [Anex]*

MINERAL & PLACER RESERVE  
B.C. REG. 212/89, 89-07-2  
NO STAKING

*light optical cable  
Telus  
(ie not the Hub)*

*ADDURA MINING LTD*

*Visited  
Mon Oct 16/00  
105*

*FOX  
883073*