

LEGEND

LITHOLOGIES

Eocene

Ootsa Lake Group

- 11 Felsic dykes
- 11c Quartz eye rhyolite porphyry

EARLY TO MIDDLE JURASSIC

Hazelton Group

6 Andesites

- 6a Lapilli to breccia tuff
 - 6a₁ strong sericite-clay altered
 - 6a₂ strong sericite-clay altered with chaledony stockwork
 - 6a₃ vuggy chaledonic breccia
 - 6a₄ strong sericite-clay altered andesite with jasper matrix crackle breccia
 - 6a₅ chlorite-pyrite breccia
 - 6a₆ intense oligoclase-sericite-biotite-pyrite altered
- 6b Fine-grained massive andesite
 - 6b₁ strong sericite-clay altered
 - 6b₂ chlorite-pyrite breccia
 - 6b₃ plagioclase (oligoclase)-muscovite-pyrite chaledony breccia
 - 6b₄ chaledony-epidote breccia
 - 6b₅ intense oligoclase-sericite-biotite-pyrite altered

6c Feldspar porphyry

6g Maroon feldspar porphyry

- 6h Amygdaloidal andesite
- 6i Augite-feldspar phyrlic andesite lapilli tuff
- 6j Maroon massive-bedded siltstone-coarse-grained sandstone

5 Epiclastics, Tuffs and Siltstones

- 5a Fine (sharp) laminated graphitic argillite-siltstone and grey felsic ash tuff and siltstone
- 5b Finely laminated argillite-siltstone and grey felsic ash tuff and siltstone

ALTERATION & MINERALIZATION

- | | | |
|-----------------|-----------------|----------------|
| AS arsenopyrite | BA barite | BI biotite |
| CL chlorite | CY clay | DO dolomite |
| EP epidote | GL galena | HE hematite |
| MG magnetite | MS sericite | PF plagioclase |
| PO pyrrhotite | PR pyrrargyrite | PY pyrite |
| QZ chalcedony | SP sphalerite | |

ALTERATION INTENSITY

- 1 weak 2 moderate 3 strong

SYMBOLS

- 178°-45°/78.3 m Diamond drill hole (Azimuth, dip, length)
- 3.200 39.0 Assay Interval: Au (g/t) Ag (g/t)
- 2.02,25.2/8.1m Composite assay interval: Au (g/t) Ag (g/t)/length (m)
- ~ ~ ~ ~ Fault/Shear
- — — Geological contact
- ← CL → Alteration interval

GIVER SHOWING

chip 2.7 g/t Au, 15.4 g/t Ag / 1.3 m
 grab float 4.4 g/t Au, 38.0 g/t Ag
 average of chips 0.623 g/t Au, 7.1 g/t Ag / 8.2 m
 Axis of VLF conductor

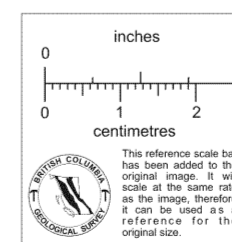
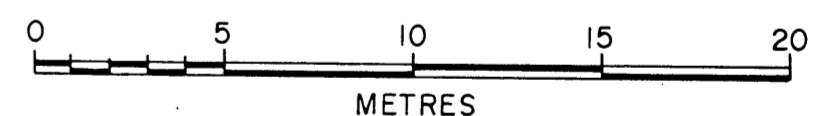
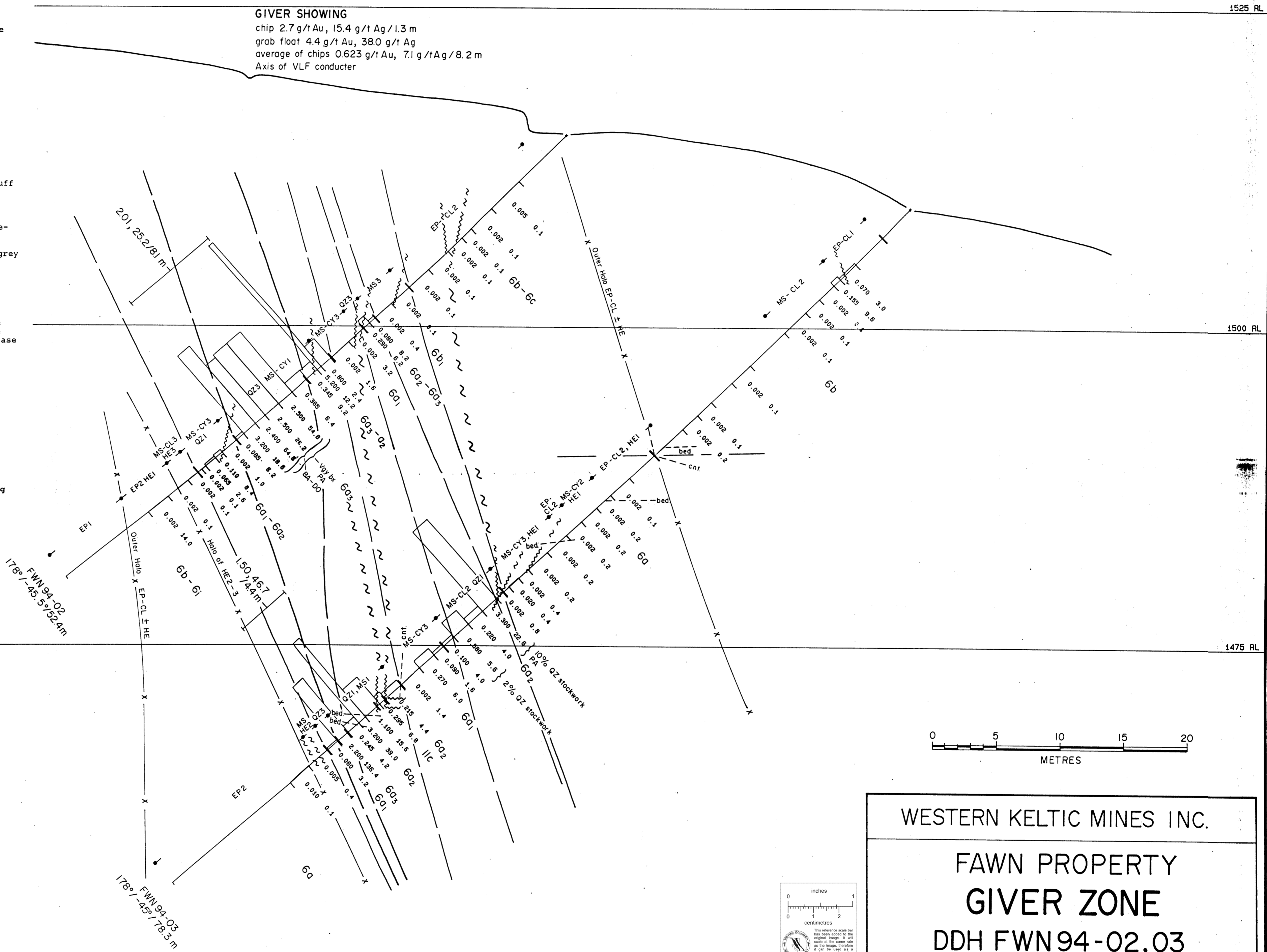

WESTERN KELTIC MINES INC.

**FAWN PROPERTY
 GIVER ZONE
 DDH FWN 94-02,03**

BRITISH COLUMBIA

EQUITY ENGINEERING LTD.

DRAWN:	M.B./J.W.	MINING DIV.:	OMINECA	FIGURE 11
N.T.S.:	93 F/3E	SCALE:	1:200	
DATE:	SEPT, 1994	REVISED:		

NOTE. SECTION LOOKING TOWARDS 268°