

Sample Loc.	Sample No.	L.m.	Cu	Au	Ag	P
6N	1	grak	1.5	.38	.046	9.42
	2	8856	1.5	.38	.046	9.42
	3	8804	13.0	.01	.001	25
	4	8808	1.2	.02	.019	10.80
	5	8811	4.0	.08	.008	4.78
	6	8810	3.4	.05	.059	3.20
	7	8854	1.5	.03	.005	.42
	8	8855	2.0	.06	.036	1.25
5N	9	8842	grak-arg	.01	.001	.03
	10	8870	grak-rhy	.01	.001	.03
	11	8869	grak-flt	.01	.001	.12
	12	8840	grak	.02	.001	.57
	13	8801	1.5	.003	.003	.39
	14	8802	2.0	.008	.008	.94
	15	8807	1.4	.01	.001	.04
	16	8845	1.3	.01	.001	.10
4N	17	8843-8844	5.5	.01	.001	.15
	18	8812	2.0	.01	.032	4.02
	19	8853	grak	.01	.001	.13
	20	8803	6.0	.01	.014	.52
	21	prick	high-grade	.02	.031	3.42
	22	8804	3.5	.02	.019	1.28
	23	prick	high-grade	.01	.039	2.54
3N	24	8805	1.5	.01	.012	.62
	25	8809	grak-chk-may	.01	.004	.07
	26	8808	15.0	.01	.001	.07
	27	8808	1.5	.02	.005	.06

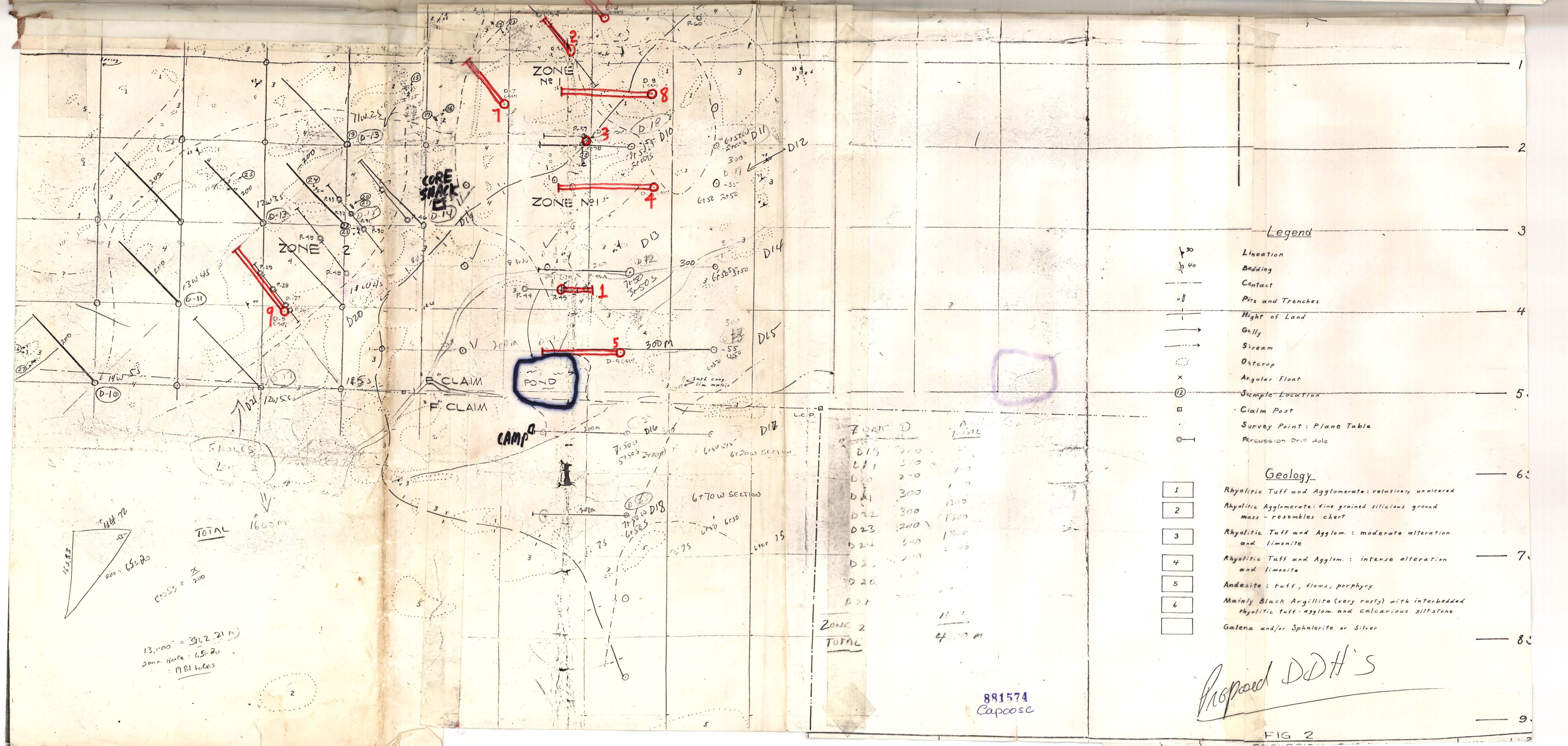
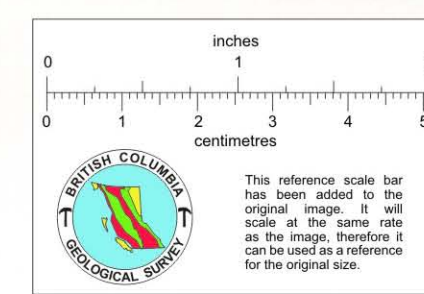
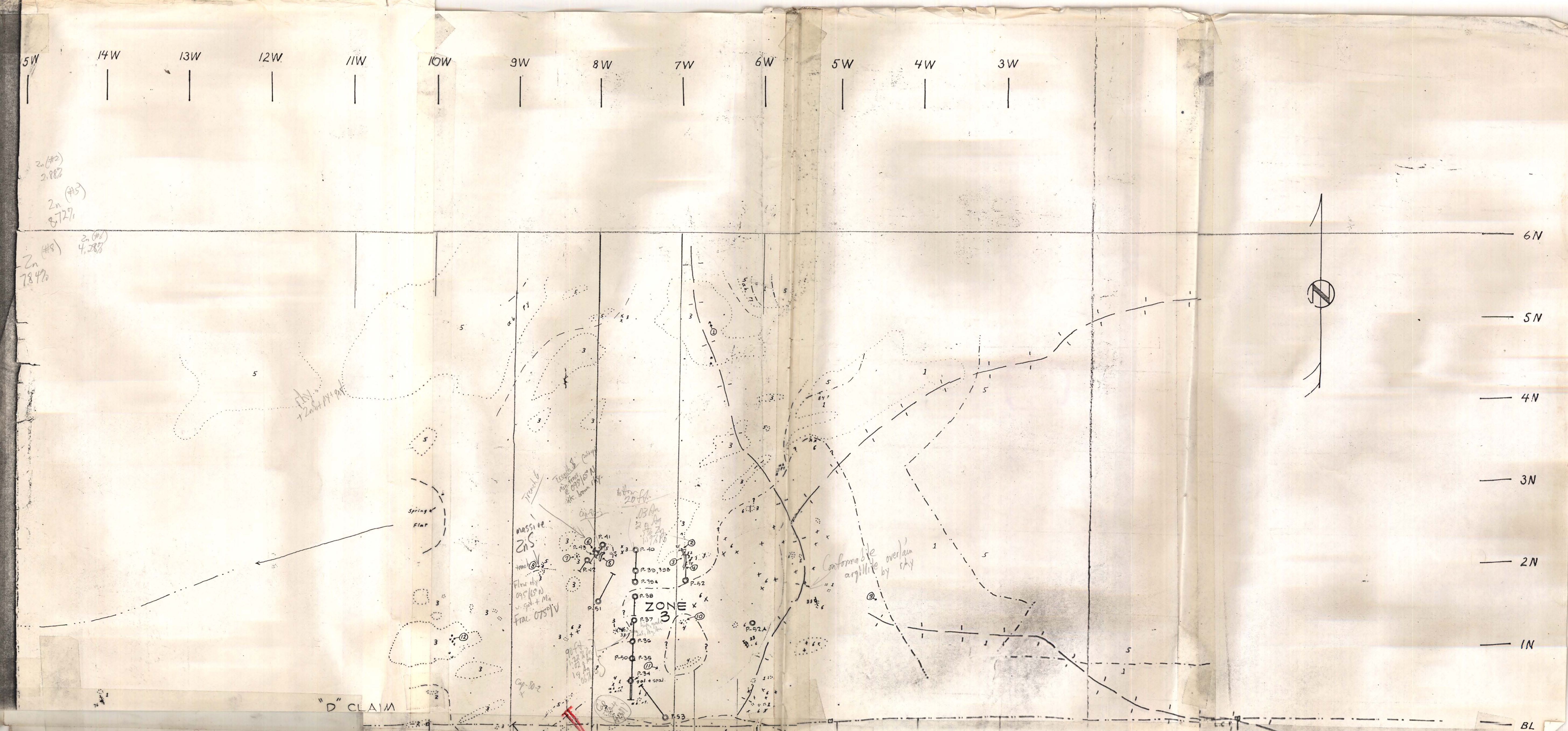

881574
Capose

Proposed DDH's

FIG 2