

Sept. 15/75

Big Onion
93L 124
880824

- drilled 57 percussion holes to a pre-determined depth of 300 ft. Machine rolled over bank + ∴ terminated pdd.
- drilled 3 ddh - excellent chalcocite + cpy in highly alt'd (silicified) intrusive - probably run .7% to >1% Cu.
- chalcocite coating cpy (rather than py)
- cont'd staking by Can. Sup. around area

Excerpts from Aug. 20/75 Assess. Rpt.

- 57 vertical percussion holes totalling 13,200 ft.
- "elongate, altered + pyritised zone along As Hais Ck. developed in + around 2 dike-like masses of Qtz.-dio. po which nearly coalesce at approx. 4500' elev.
- Qtz.-dio. largely enveloped by leucocratic gte. fsp. po + both cut Hazelton Jurassic andesites.
- Cu + MoS₂ min. intimately associated with Qtz.-dio. po + is best developed along the sheared southeastern contact with andesite.
- Leaching is locally intense such that mineralized zones may in some cases have little or no surface expression.
- Total cost of 1975 drill program \approx \$100,000,000

Talk with Geol. Stock re -

July 9/77

BIG ONION



○ Fossils

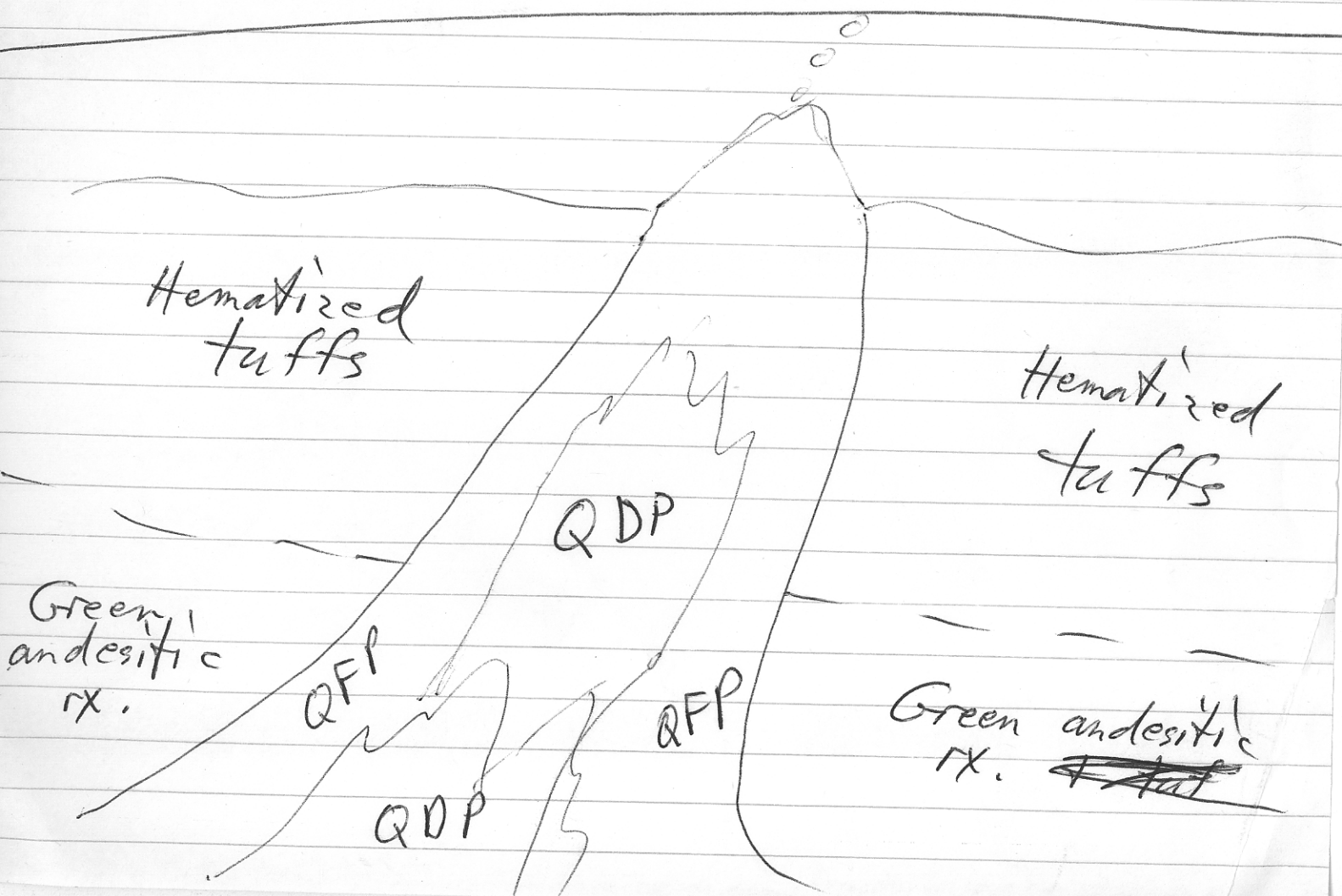

Discussion with John Baker regarding BIG ONION

- Cyprus worked 3 summers
- total ddh. ~ 25,000 ft.
- all angle holes (ie. 45° - 50°)
- holes drilled from 'perimeter' into centre
- no true surface holes!!

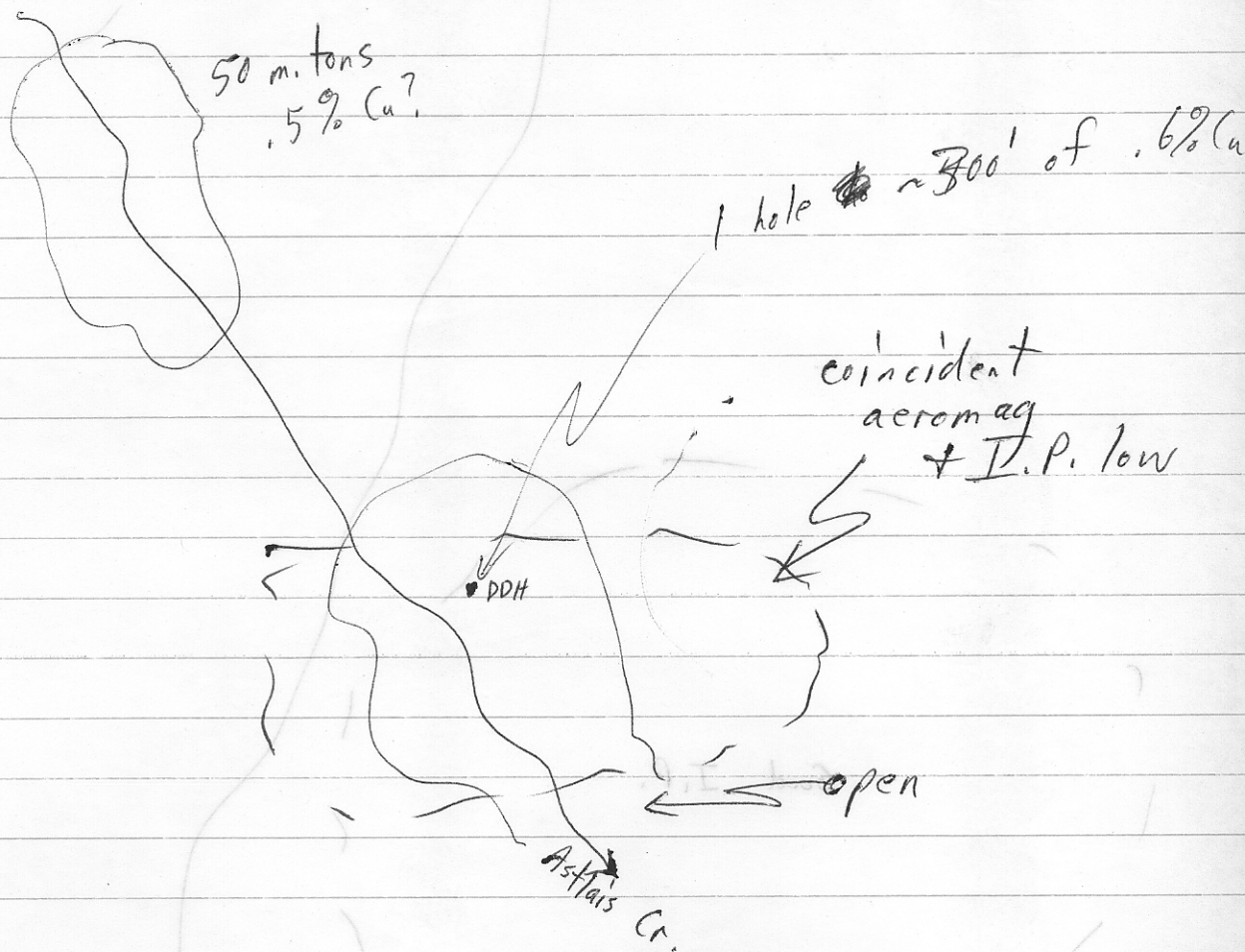
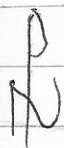

- John feels possible fault down Astlais Cr. which may have offset ore (similar to Morrison)
- Future appears best towards SE (just on north side of road).
- 'North western' orebody still has possibilities to NW.
- Cyprus felt orebody was a cylindrical pipe with no bottom (ie. can drill thru it).
- John sees possibilities of a .6% Cu grade.

[OVER!]

11

Discussion with John Baker regarding BIG ORE

- North Zone
- 3 Summerville
- total depth ~ 25,000 ft
- all angle holes (in 45° - 50°)
- holes drilled from perimeter into center
- no true surface holes

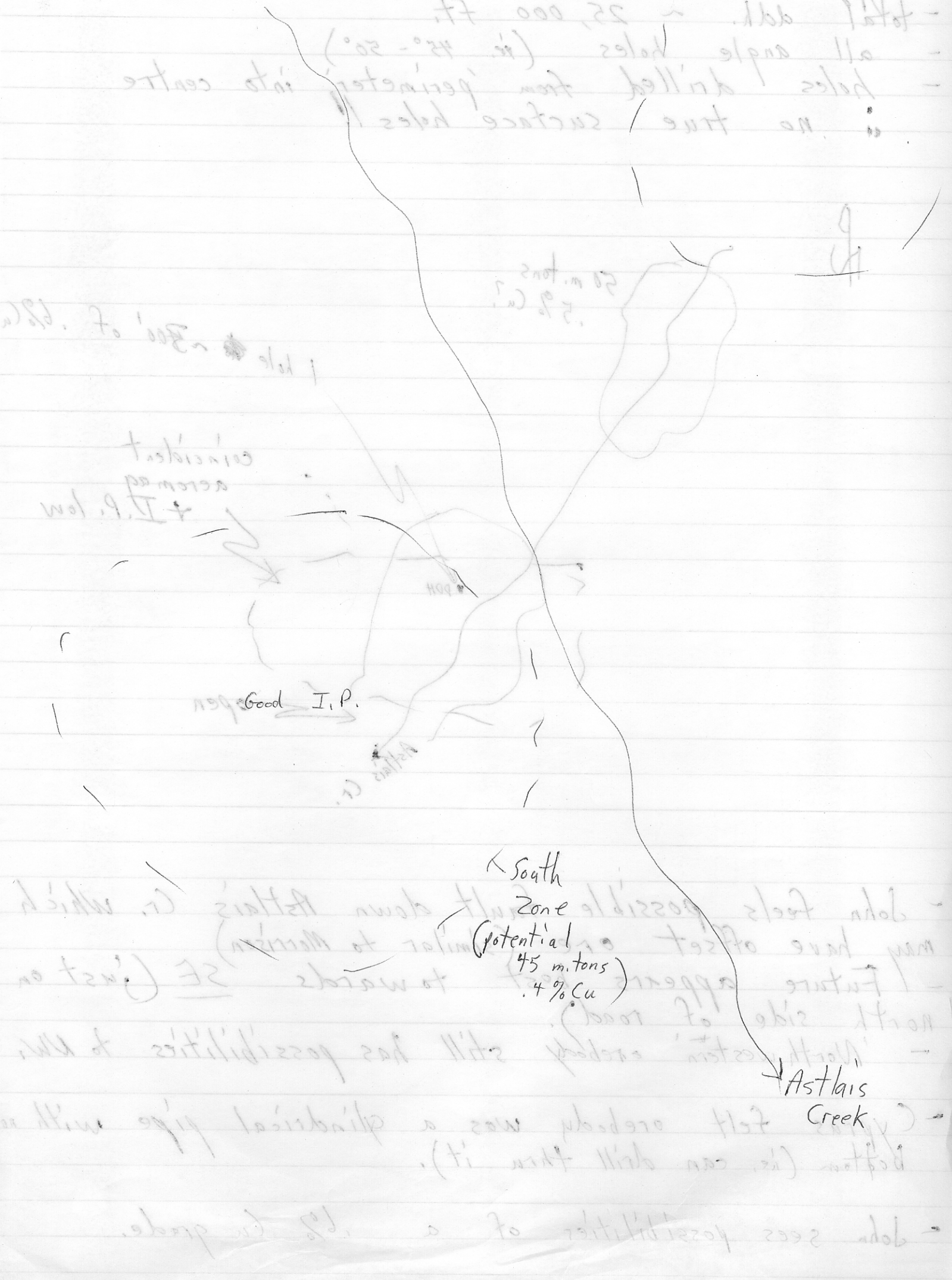

[OVER]

B¹³ ONION

1927

1932

CIMBRIA

Owners - B. Mueller + A. Elmsted

Ganokwa ck.?

1927 Location - right bank of an unnamed ck. which flows into Carr ck. Carr ck. rises in a low pass in the Sabine Mts. & flows into the Bulkley R. Lies about N. 80° E. from Smithers. A car can be taken as far as Macdonald's ranch on the Cronin rd. At a pt. on the Cronin rd. about 3½ miles past Macdonald's ranch a trail leaves the rd. swinging in a northerly direc.

- good cabin at elev. 3700 ft. close to main workings
- Workings consist of 2 X-cut tunnels at pts. 65 ft. apart vertically. The lower is run at elev. 3775 ft. + the upper at 3840 ft. elev. - both bearings at N. 55° W. (mag.)
Length of lower is 165 ft. + upper 50 ft.

Geology - very slightly min. granitic rk. into volcs. Belt trends about N. 35° E. (mag.) + crops out at a pt. about 1000 ft. SW of tunnels, + can be traced at intervals for a distance of upwards of 6000 ft. in NE direction.

Min. consists of iron pyrites + a little Cu stain. No assay values. At about 2000 ft. NE of tunnels, at elev. 4330 ft., granitic rk. is overlain by bed of limonite 5 ft. thick (of recent origin). Granitic rk. is a biotite granite + oteps. between elev. 3700 + 5500

1966 - Ann. Rpt.