

TCS



APR 28 1987

Reclamation Permit

MX-7-5
M-155
PE: 4916

CONFIDENTIAL
Internal Government Use Only

MINERAL RESOURCES DIVISION
INSPECTION AND ENGINEERING BRANCH
VANCOUVER, B.C.

Title Number
Photocopies sent to:
Applied Geology-Vic/Van
Waste Mngment-Surrey
Fish & Wildlife-Surrey
Ministry of Forests-Squam.
on April 24, 1987.....

**NOTICE OF WORK AND RECLAMATION PROGRAM
ON A MINERAL PROPERTY**

1. NAME OF PROPERTY ASHLV. GOLD MINE.....

Number of claims 8 CLAIMS OLD ST. NEW..... Principal Claim Group HALK #1 AND HALK #2
2. LOCATION: Mining Division VANCOUVER, B.C...... NTS Map Sheet (e.g., 82E/9E) 92B-14/W

Lat.° Long.° UTM: E. N.

Access via LOGGING ROAD WELDWOOD T.P.L. 98.....
3. OWNER: Name SHIMS EXPLORATION AND MINING CO. BABKIRK FMC No. 213050 (BABKWE)

Address 2055 COMO LAKE AVE COQUITLAM..... City

Province B.C...... Postal Code V3J-3R4..... Telephone No. 939-4370.....
4. OPERATOR: Name WALTER BABKIRK..... FMC No. 213050 (BABKWE)

Address 2055 COMO LAKE AVE COQUITLAM..... City

Province B.C...... Postal Code V3J-3R4..... Telephone No. 939-4370.....
5. EXPLORATION WORK: Indicate PROPOSED or COMPLETED .

Duration of Exploration Work: From MAY 1 - 1987..... to SEPT. 30 - 1987.....

Name of Field Manager WALTER BABKIRK..... No. of men employed 2-4.....

Geophysical Geochemical

Linecutting (distance, width, method)
6. SURFACE DISTURBANCE OFF MINERAL CLAIMS

Road Access Construction: Total length NIL m Approximate width m Area m²

Campsites: No. of men NIL Size m² **USE EXISTING MINE CAMP VAC.**

Other (specify)
7. SURFACE DISTURBANCE ON MINERAL CLAIMS

(a) Road Construction: Total length NIL m Approximate width m Area m²

(b) Drilling: No. of sites 6? Maximum dimensions: Width 4 m Length 4 m

Depth 50 to 100? m Total disturbed area of drill sites m²

Water source G.R. AND RR DITCHES Method of drill mud disposal NO DRILL MUD USE PITS TO CONTAIN CUTTINGS

(c) Trenches: No. NIL Maximum dimensions: Width m Length m

Depth m Total disturbed area of trenches m²

(d) Test Pits: No. NIL Maximum dimensions: Width m Length m

Depth m Total disturbed area of test pits m²

COPY
FOR OFFICIAL USE ONLY

APR 28 1987
VANCOUVER, B.C.

COPY

BRITISH COLUMBIA
 APR 23 1987
 Ministry of Energy, Mines and
 Petroleum Resources

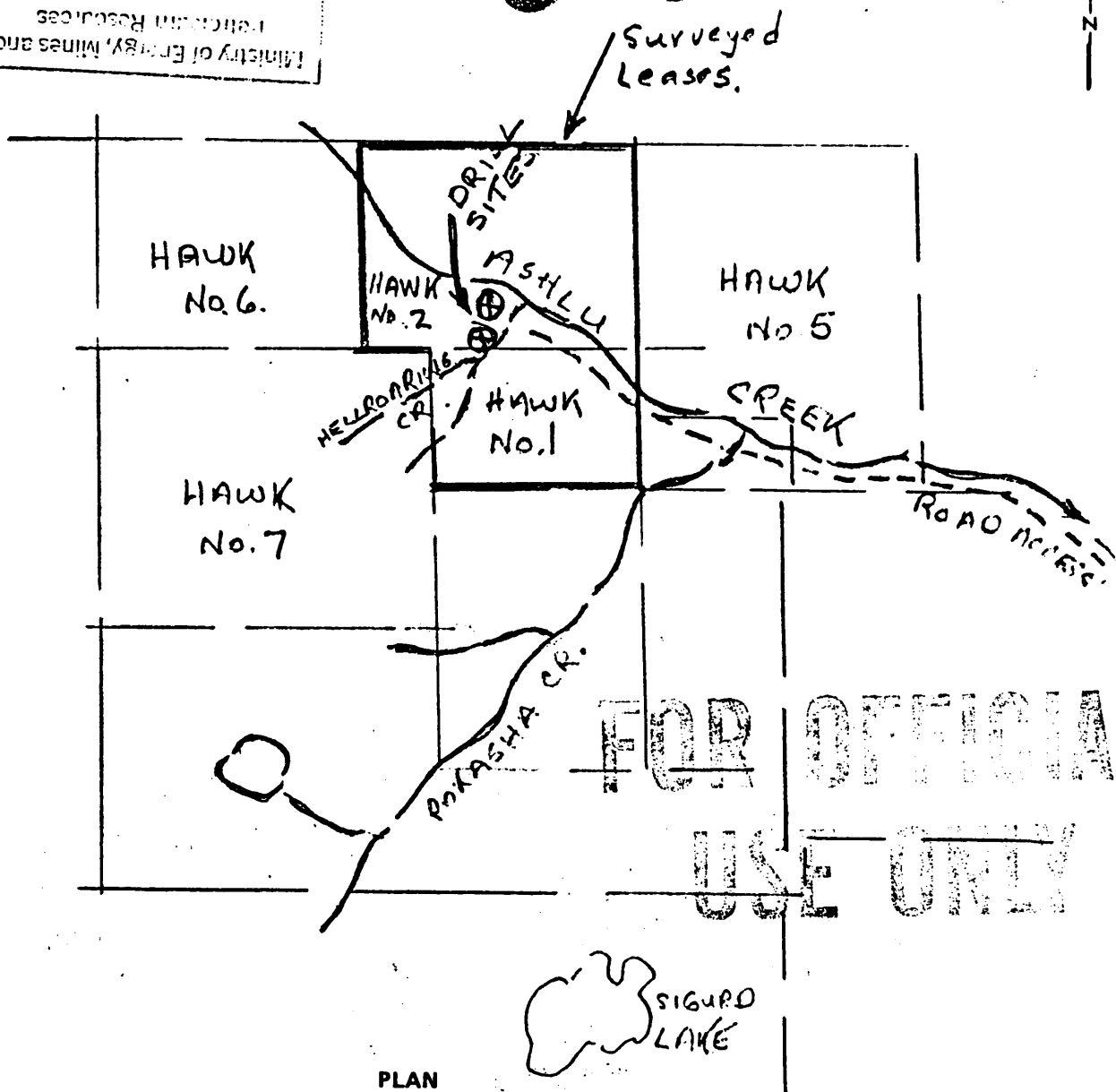

PLAN

Indicate claim boundaries, permanent watercourses, access road and distance to nearest town, proposed surface disturbances including roads, test pits, trenches, portals, drill sites, and camp sites.

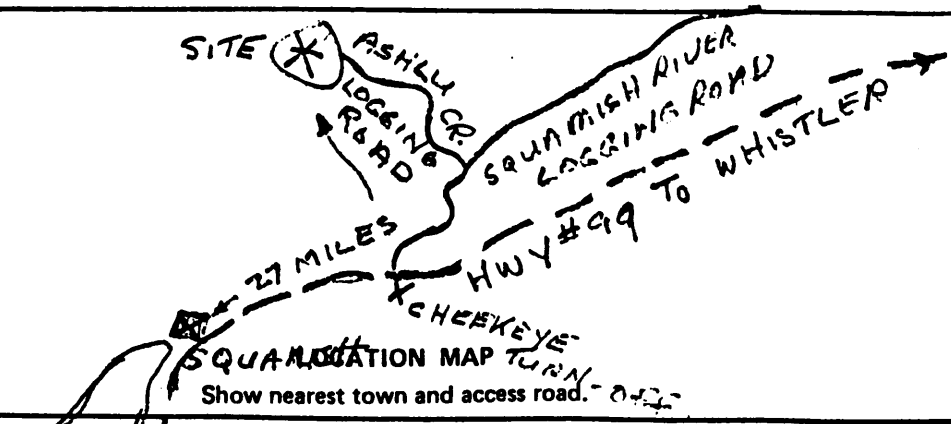

ASTHU - Pavel
Mazacek Apr. 29/87

Dr. to Breckendale

rt. hand side - new hotel
past ~ 2-3 miles

- rt. hand side - restaurant
(Black Forest)

→ turn off to left

- rd. - branch left over
bridge (~ 20 miles)

- Tellurides intrusives
+ WO_3 + 'dyke' - lamprophyre?