

880214

→ Abbott  
Wagner



GAI: TSX Venture  
GARCF: O.T.C

Exemption 12g3 – 2(b)  
SEC File # 82-659

[www.goldenarchresources.com](http://www.goldenarchresources.com)

## News Release

20060629LK

### Abbott Wagner – 43-101 Summary Report Received Summer 2006 Exploration Program

**June 29, 2006, Vancouver, BC – Golden Arch Resources Ltd.** is pleased to announce its intention to initiate a summer exploration program on its 100% owned Abbott Wagner property, which lies within the rocks of the Kootenay Arc, approximately 48 km southeast of the town of Trout Lake, BC.

In a recently compiled, 43-101-compliant summary report, the author, R. Somerville, P.Eng, states: “An historical published mineral resource of 327,000 tons grading 7.81% lead, 6.39% zinc and 295 grams per tonne silver (8.6 ounces per ton) is reported for this property.” However, he cautions that he has not conducted an independent verification of this resource, and therefore the reader should regard this only as interesting historical data, pending confirmation by an independent study. Mr. Somerville recommends a three-phase program to explore the property, including initial rehabilitation of the old mine workings and access road, re-sampling of known showings both on surface and underground, and bulk sampling of significant zones of mineralization.

The Abbott Wagner property has the potential to become a small, seasonal, medium to high-grade surface and underground producer. Silver, lead, zinc, and copper-bearing ore from sulphide-rich quartz veins and sulphide replacement pods in limestone will be direct shipped to the Teck-Cominco smelter. Minor gold and tin values previously found in ore in this district may also enhance the property’s potential.

A claim map will be posted on the Company’s website with this news release.

The recommended work program, has been designed to enable the commissioning of a full 43-101 report which will be completed as part of the overall program.

On behalf of the Board of Directors

“Les Kjosness”

President and Director

The Company’s exploration programs are under the supervision of R.D. Somerville, P. Eng., a Qualified Person under National Instrument 43-101. Mr. Somerville is Vice President and COO of Golden Arch Resources Ltd.

Golden Arch Resources Ltd. is a metals, and oil & gas exploration company based in Vancouver, BC, Canada. Its principal asset is the Mildred Peak Copper, Gold and Silver property located in Arizona, USA acquired in 2002.

*“The TSX Venture Exchange assumes no responsibility for the accuracy of this Release and neither approves nor disapproves thereof.”*

Suite 928 – 470 Granville St., Vancouver, B.C. V6C 1V5  
Tel: (604) 681-8222; Fax (604) 681-8282  
[info@goldenarchresources.com](mailto:info@goldenarchresources.com)

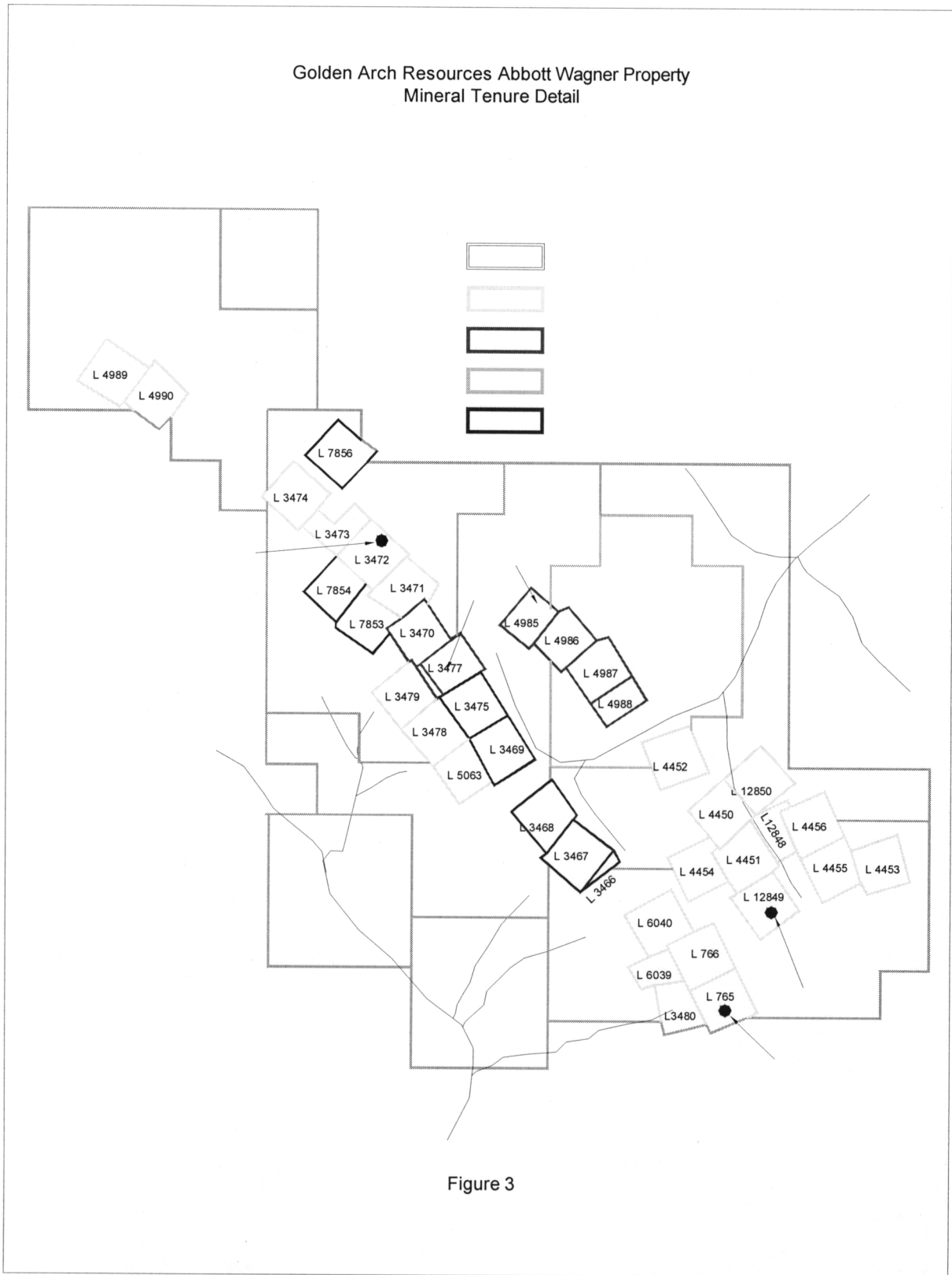

## Schroeter, Tom EMPR:EX

---

**From:** Grieve, Dave A EMPR:EX  
**Sent:** Wed, September 6, 2006 8:33 AM  
**To:** Schroeter, Tom EMPR:EX  
**Subject:** RE: Kootenay Expl'n Exp. Est.

Hi Tom: Somehow I must have forgotten to mention Golden Arch Resources' Abbott-Wagner project. Please see this release:

<http://www.goldenarchresources.com/news/Jun2906.pdf>

We haven't had a notice of work, and I haven't talked to anyone in the company (Les Kjosness is the president). I would estimate \$40k.

Dave

---

**From:** Schroeter, Tom EMPR:EX  
**Sent:** August 30, 2006 3:25 PM  
**To:** Grieve, Dave A EMPR:EX  
**Subject:** Kootenay Expl'n Exp. Est.

Dave - FYI-updates/revisions, pls. Thanks again for last week's field visits.

## Tom

Tom Schroeter, P.Eng./P.Geo.  
Senior Regional Geologist  
Geological Survey Branch  
Mining and Minerals Division  
Ministry of Energy, Mines and Petroleum Resources

Direct Telephone 604 660-2812  
Messages & Enquiries 604 660-2708  
Facsimile 604 775-0313  
email [tom.schroeter@gov.bc.ca](mailto:tom.schroeter@gov.bc.ca)