

880115

Schroeter, Tom EMPR:EX

From: Beryl [TomSchroeter@Telus.net]
Sent: Saturday, November 26, 2005 12:00 PM
To: Schroeter, Tom EMPR:EX
Subject: Fw: Akie Drill Holes.

----- Original Message -----

From: John R. Fraser
To: tomschroeter@telus.net
Sent: Saturday, November 26, 2005 11:41 AM
Subject: Akie Drill Holes.

Tom:

Attached is a working copy of the Akie vertical longitudinal section showing the planned pierce points - these are very approximate - for current holes 30, 31(lost), 32 and 33 (underway). Holes 30 and 32 are within a polygon defined by holes 94 -11, 94 -12, 95 -13 and 95 -18, all relatively high grade holes, used by Inmet to calculate and inferred resource of 13 million tonnes @8.52% Zn, 1.47% Pb and 13.24 gr Ag/t. Each square on the section is 200m by 200m. We are planning a 4th hole (not yet announced), the location of which will be decided once we have visual results for hole 33. On a plan map, the three current holes are located slightly west of the grid baseline and are 200m apart - 30 on 3300S, 32 on 3100S and 33 on 3500S.

Hope that this helps you. It was great to see you and Beryl last night - we have do it again soon.

Regards
John.

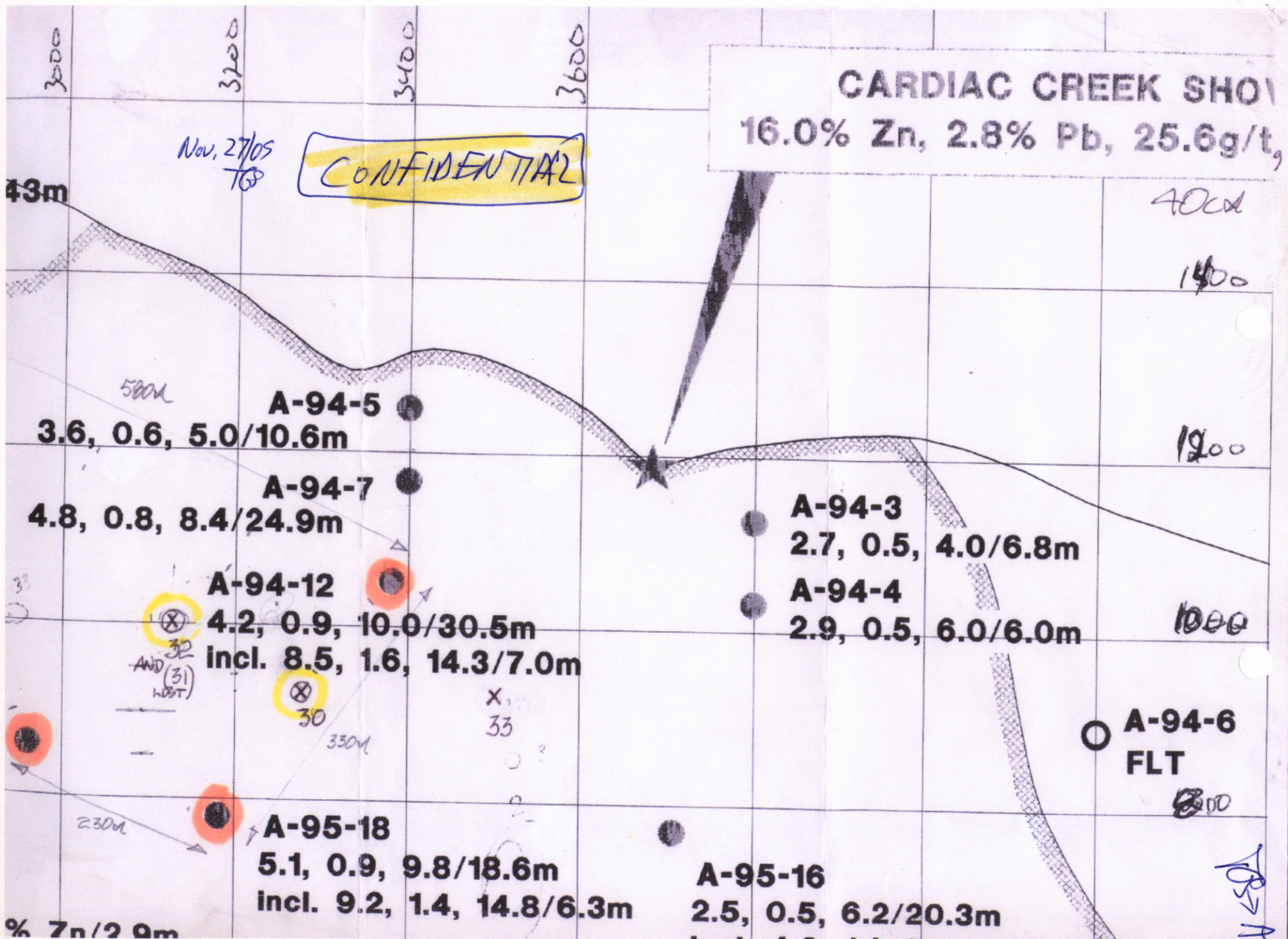

TGS Mike