

PLACER DEVELOPMENT LIMITED
Exploration Department

SAMPLE No.

No 02106

HEAVY MINERAL

SAMPLE TAGS

862608

Date

29/09/88

Taken by

Submitted by

Venture/Proj.

SPRING

Location - NTS/UTM

Remarks

75 m N of Bridge in
North Trout Cr.

OFFICE FILE COPY

PLACER DEVELOPMENT LIMITED
Exploration Department

SAMPLE No.

Nº 02107

HEAVY MINERAL

SAMPLE TAGS

Date 30/09/88

Taken by H-M

Submitted by _____

Venture/Proj. SPRING

Location - NTS/UTM _____

Remarks 100 M N OF SPLIT in

UH Lake Rd on Hall Cr.

OFFICE FILE COPY

PLACER DEVELOPMENT LIMITED
Exploration Department

SAMPLE No.

Nº 02107

HEAVY MINERAL

SAMPLE TAGS

Location - NTS/UTM _____

PLACER LAB COPY

(Mail with Blue copy of Sample Shipment Memo)

PLACER DEVELOPMENT LIMITED
Exploration Department

SAMPLE No.

Nº 02108

HEAVY MINERAL

SAMPLE TAGS

Date 30/09/88

Taken by _____

Submitted by _____

Venture/Proj. SPRING

Location - NTS/UTM _____

Remarks 100 M UP Stream from

Rd. by sample #414.

OFFICE FILE COPY

PLACER DEVELOPMENT LIMITED
Exploration Department

SAMPLE No.

Nº 02108

HEAVY MINERAL

SAMPLE TAGS

Location - NTS/UTM _____

PLACER LAB COPY

(Mail with Blue copy of Sample Shipment Memo)

PLACER DEVELOPMENT LIMITED
Exploration Department

SAMPLE No.

Nº 02109

HEAVY MINERAL

SAMPLE TAGS

Date 30/09/88

Taken by _____

Submitted by _____

Venture/Proj. SPRING

Location - NTS/UTM _____

Remarks 150 m upstream at km
29.9 on Peachland Main.

OFFICE FILE COPY

PLACER DEVELOPMENT LIMITED
Exploration Department

SAMPLE No.

Nº 02109

HEAVY MINERAL

SAMPLE TAGS

Location - NTS/UTM _____

PLACER LAB COPY

(Mail with Blue copy of Sample Shipment Memo)

PLACER DEVELOPMENT LIMITED
Exploration Department

SAMPLE No.

Nº 02110

HEAVY MINERAL

SAMPLE TAGS

Date 30/09/88

Taken by _____

Submitted by _____

Venture/Proj. SPRING

Location - NTS/UTM _____

Remarks 15 M WPS OFF Road on Spring
Creek.

OFFICE FILE COPY

PLACER DEVELOPMENT LIMITED
Exploration Department

SAMPLE No.

Nº 02110

HEAVY MINERAL

SAMPLE TAGS

Location - NTS/UTM _____

PLACER LAB COPY

(Mail with Blue copy of Sample Shipment Memo)

PLACER DEVELOPMENT LIMITED
Exploration Department

SAMPLE No.

Nº 02111

HEAVY MINERAL

SAMPLE TAGS

Date 01/10/88

Taken by _____

Submitted by _____

Venture/Proj. SPRING

Location - NTS/UTM _____

Remarks 50 M UP Stream on N Trout Cr.
OFF WH Late Turn off (Lower one)

OFFICE FILE COPY

PLACER DEVELOPMENT LIMITED
Exploration Department

SAMPLE No.

Nº 02111

HEAVY MINERAL

SAMPLE TAGS

Location - NTS/UTM _____

PLACER LAB COPY

(Mail with Blue copy of Sample Shipment Memo)

PLACER DEVELOPMENT LIMITED
Exploration Department

SAMPLE No.

No 02112

HEAVY MINERAL

SAMPLE TAGS

Date 01/10/88

Taken by _____

Submitted by _____

Venture/Proj. SPRING

Location - NTS/UTM _____

Remarks 40M upstream off Trout Creek
Main at km 28.6

OFFICE FILE COPY

PLACER DEVELOPMENT LIMITED
Exploration Department

SAMPLE No.

No 02112

HEAVY MINERAL

SAMPLE TAGS

Location - NTS/UTM _____

PLACER LAB COPY

(Mail with Blue copy of Sample Shipment Memo)

PLACER DEVELOPMENT LIMITED
Exploration Department

SAMPLE No.

No 02113

HEAVY MINERAL

SAMPLE TAGS

Date 01/10/88

Taken by _____

Submitted by _____

Venture/Proj. SPRING

Location - NTS/UTM _____

Remarks 50 M UPstream at km 30.1
on Trout Cr. Main

OFFICE FILE COPY

PLACER DEVELOPMENT LIMITED
Exploration Department

SAMPLE No.

No 02113

HEAVY MINERAL

SAMPLE TAGS

Location - NTS/UTM _____

PLACER LAB COPY

(Mail with Blue copy of Sample Shipment Memo)

PLACER DEVELOPMENT LIMITED
Exploration Department

SAMPLE No.

Nº 02114

HEAVY MINERAL

SAMPLE TAGS

Date 01/10/88

Taken by _____

Submitted by _____

Venture/Proj. SPRING

Location - NTS/UTM _____

Remarks 10 M E of L.00-67505

OFFICE FILE COPY

PLACER DEVELOPMENT LIMITED
Exploration Department

SAMPLE No.

Nº 02114

HEAVY MINERAL

SAMPLE TAGS

Location - NTS/UTM _____

PLACER LAB COPY

(Mail with Blue copy of Sample Shipment Memo)

PLACER DEVELOPMENT LIMITED
Exploration Department

SAMPLE No.

No 02115

HEAVY MINERAL

SAMPLE TAGS

Date 02/10/88

Taken by _____

Submitted by _____

Venture/Proj. SPRING

Location - NTS/UTM _____

Remarks 75 M. West of 36+47-E -

-1+75 N

OFFICE FILE COPY

PLACER DEVELOPMENT LIMITED
Exploration Department

SAMPLE No.

No 02115

HEAVY MINERAL

SAMPLE TAGS

Location - NTS/UTM _____

PLACER LAB COPY

(Mail with Blue copy of Sample Shipment Memo)

PLACER DEVELOPMENT LIMITED
Exploration Department

SAMPLE No.

Nº 02116

HEAVY MINERAL SAMPLE TAGS

Date 02/10/88

Taken by _____

Submitted by _____

Venture/Proj. SPRING

Location - NTS/UTM _____

Remarks 100 M. Down-stream from line
1400-W 2000-5 in Front Cr.

OFFICE FILE COPY

PLACER DEVELOPMENT LIMITED
Exploration Department

SAMPLE No.

Nº 02116

HEAVY MINERAL SAMPLE TAGS

Location - NTS/UTM _____

PLACER LAB COPY

(Mail with Blue copy of Sample Shipment Memo)

PLACER DEVELOPMENT LIMITED
Exploration Department

SAMPLE No.

Nº 02117

HEAVY MINERAL

SAMPLE TAGS

Date _____

Taken by _____

Submitted by _____

Venture/Proj. _____

Location - NTS/UTM _____

Remarks 10M UPstream R. L2+00 E - 3+25.5
in Trout Creek.

OFFICE FILE COPY

PLACER DEVELOPMENT LIMITED
Exploration Department

SAMPLE No.

Nº 02117

HEAVY MINERAL

SAMPLE TAGS

Location - NTS/UTM _____

PLACER LAB COPY

(Mail with Blue copy of Sample Shipment Memo)

PLACER DEVELOPMENT LIMITED
Exploration Department

SAMPLE No.

No 02118

HEAVY MINERAL

SAMPLE TAGS

Date 02/10/88

Taken by _____

Submitted by _____

Venture/Proj. SPRING

Location - NTS/UTM _____

Remarks 25M. N-E of L 800 E - 3175 N
in dry creek.

OFFICE FILE COPY

PLACER DEVELOPMENT LIMITED
Exploration Department

SAMPLE No.

No 02118

HEAVY MINERAL

SAMPLE TAGS

Location - NTS/UTM _____

PLACER LAB COPY

(Mail with Blue copy of Sample Shipment Memo)

PLACER DEVELOPMENT LIMITED
Exploration Department

SAMPLE No.

No 02119

HEAVY MINERAL

SAMPLE TAGS

Date 03/10/88

Taken by _____

Submitted by _____

Venture/Proj. SPRING

Location - NTS/UTM _____

Remarks 200 M UPstream from Hall Creek

+ Tract Creek Junction off Front Creek.

OFFICE FILE COPY

PLACER DEVELOPMENT LIMITED
Exploration Department

SAMPLE No.

No 02119

HEAVY MINERAL

SAMPLE TAGS

Location - NTS/UTM _____

PLACER LAB COPY

(Mail with Blue copy of Sample Shipment Memo)

PLACER DEVELOPMENT LIMITED
Exploration Department

SAMPLE No.

No 02120

HEAVY MINERAL

SAMPLE TAGS

Date 03/10/88

Taken by _____

Submitted by _____

Venture/Proj. SPRING

Location - NTS/UTM _____

Remarks Across from km 40 on WH Lake

Rd in N. Trout Cr.

OFFICE FILE COPY

PLACER DEVELOPMENT LIMITED
Exploration Department

SAMPLE No.

No 02120

HEAVY MINERAL

SAMPLE TAGS

Location - NTS/UTM _____

PLACER LAB COPY

(Mail with Blue copy of Sample Shipment Memo)

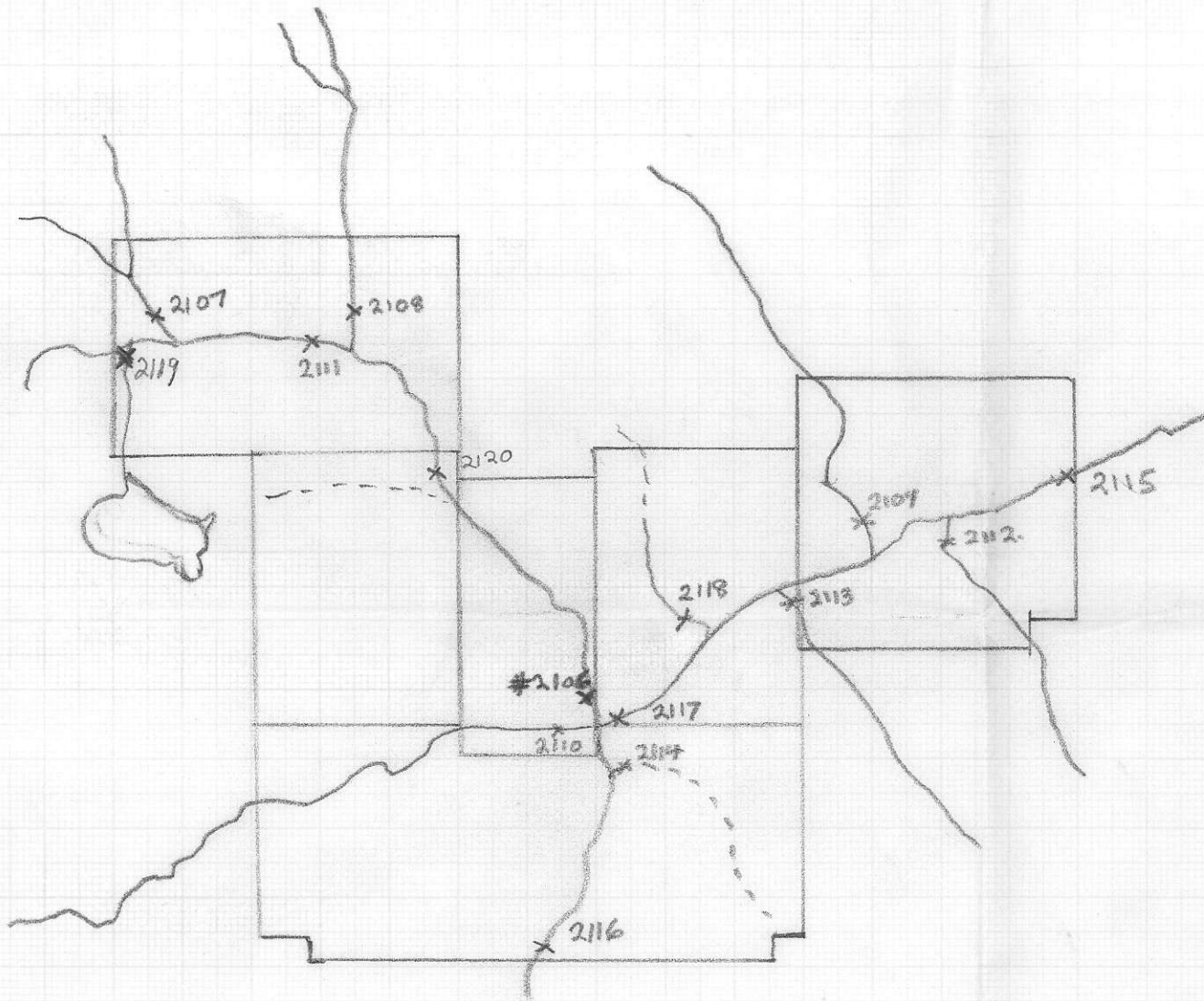

Bulk Sediment
Locations.