

S Platinum Blonde

862528

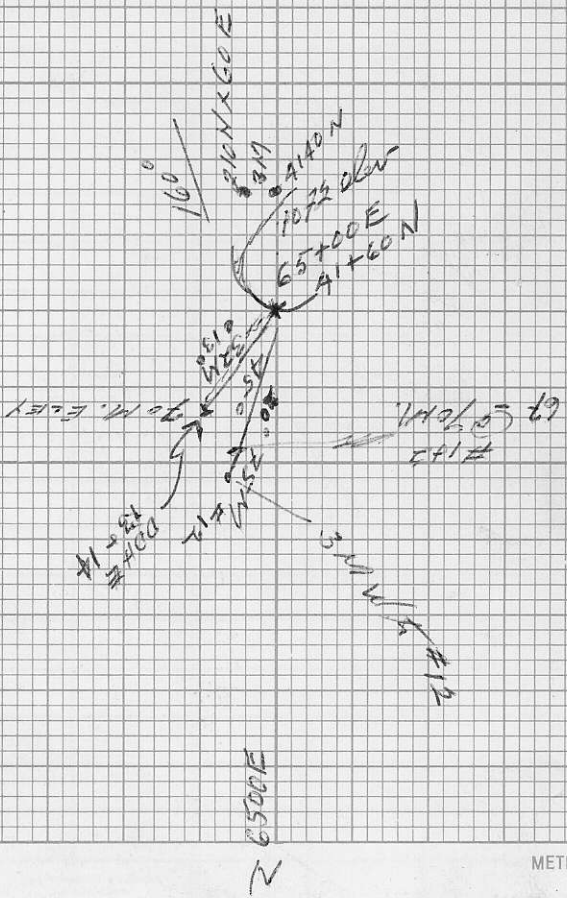

31/5/87

Shaft @ 1090 elev

Hole # 3+4 @ 1100 elev

Correct add 25 M

W

N

77.8  
77.2  
77.1  
77.0  
76.9  
76.8  
76.7  
76.6  
76.5  
76.4  
76.3  
76.2  
76.1  
76.0  
75.9  
75.8  
75.7  
75.6  
75.5  
75.4  
75.3  
75.2  
75.1  
75.0  
74.9  
74.8  
74.7  
74.6  
74.5  
74.4  
74.3  
74.2  
74.1  
74.0  
73.9  
73.8  
73.7  
73.6  
73.5  
73.4  
73.3  
73.2  
73.1  
73.0  
72.9  
72.8  
72.7  
72.6  
72.5  
72.4  
72.3  
72.2  
72.1  
72.0  
71.9  
71.8  
71.7  
71.6  
71.5  
71.4  
71.3  
71.2  
71.1  
71.0  
70.9  
70.8  
70.7  
70.6  
70.5  
70.4  
70.3  
70.2  
70.1  
70.0  
69.9  
69.8  
69.7  
69.6  
69.5  
69.4  
69.3  
69.2  
69.1  
69.0  
68.9  
68.8  
68.7  
68.6  
68.5  
68.4  
68.3  
68.2  
68.1  
68.0  
67.9  
67.8  
67.7  
67.6  
67.5  
67.4  
67.3  
67.2  
67.1  
67.0  
66.9  
66.8  
66.7  
66.6  
66.5  
66.4  
66.3  
66.2  
66.1  
66.0  
65.9  
65.8  
65.7  
65.6  
65.5  
65.4  
65.3  
65.2  
65.1  
65.0  
64.9  
64.8  
64.7  
64.6  
64.5  
64.4  
64.3  
64.2  
64.1  
64.0  
63.9  
63.8  
63.7  
63.6  
63.5  
63.4  
63.3  
63.2  
63.1  
63.0  
62.9  
62.8  
62.7  
62.6  
62.5  
62.4  
62.3  
62.2  
62.1  
62.0  
61.9  
61.8  
61.7  
61.6  
61.5  
61.4  
61.3  
61.2  
61.1  
61.0  
60.9  
60.8  
60.7  
60.6  
60.5  
60.4  
60.3  
60.2  
60.1  
60.0  
59.9  
59.8  
59.7  
59.6  
59.5  
59.4  
59.3  
59.2  
59.1  
59.0  
58.9  
58.8  
58.7  
58.6  
58.5  
58.4  
58.3  
58.2  
58.1  
58.0  
57.9  
57.8  
57.7  
57.6  
57.5  
57.4  
57.3  
57.2  
57.1  
57.0  
56.9  
56.8  
56.7  
56.6  
56.5  
56.4  
56.3  
56.2  
56.1  
56.0  
55.9  
55.8  
55.7  
55.6  
55.5  
55.4  
55.3  
55.2  
55.1  
55.0  
54.9  
54.8  
54.7  
54.6  
54.5  
54.4  
54.3  
54.2  
54.1  
54.0  
53.9  
53.8  
53.7  
53.6  
53.5  
53.4  
53.3  
53.2  
53.1  
53.0  
52.9  
52.8  
52.7  
52.6  
52.5  
52.4  
52.3  
52.2  
52.1  
52.0  
51.9  
51.8  
51.7  
51.6  
51.5  
51.4  
51.3  
51.2  
51.1  
51.0  
50.9  
50.8  
50.7  
50.6  
50.5  
50.4  
50.3  
50.2  
50.1  
50.0  
49.9  
49.8  
49.7  
49.6  
49.5  
49.4  
49.3  
49.2  
49.1  
49.0  
48.9  
48.8  
48.7  
48.6  
48.5  
48.4  
48.3  
48.2  
48.1  
48.0  
47.9  
47.8  
47.7  
47.6  
47.5  
47.4  
47.3  
47.2  
47.1  
47.0  
46.9  
46.8  
46.7  
46.6  
46.5  
46.4  
46.3  
46.2  
46.1  
46.0  
45.9  
45.8  
45.7  
45.6  
45.5  
45.4  
45.3  
45.2  
45.1  
45.0  
44.9  
44.8  
44.7  
44.6  
44.5  
44.4  
44.3  
44.2  
44.1  
44.0  
43.9  
43.8  
43.7  
43.6  
43.5  
43.4  
43.3  
43.2  
43.1  
43.0  
42.9  
42.8  
42.7  
42.6  
42.5  
42.4  
42.3  
42.2  
42.1  
42.0  
41.9  
41.8  
41.7  
41.6  
41.5  
41.4  
41.3  
41.2  
41.1  
41.0  
40.9  
40.8  
40.7  
40.6  
40.5  
40.4  
40.3  
40.2  
40.1  
40.0  
39.9  
39.8  
39.7  
39.6  
39.5  
39.4  
39.3  
39.2  
39.1  
39.0  
38.9  
38.8  
38.7  
38.6  
38.5  
38.4  
38.3  
38.2  
38.1  
38.0  
37.9  
37.8  
37.7  
37.6  
37.5  
37.4  
37.3  
37.2  
37.1  
37.0  
36.9  
36.8  
36.7  
36.6  
36.5  
36.4  
36.3  
36.2  
36.1  
36.0  
35.9  
35.8  
35.7  
35.6  
35.5  
35.4  
35.3  
35.2  
35.1  
35.0  
34.9  
34.8  
34.7  
34.6  
34.5  
34.4  
34.3  
34.2  
34.1  
34.0  
33.9  
33.8  
33.7  
33.6  
33.5  
33.4  
33.3  
33.2  
33.1  
33.0  
32.9  
32.8  
32.7  
32.6  
32.5  
32.4  
32.3  
32.2  
32.1  
32.0  
31.9  
31.8  
31.7  
31.6  
31.5  
31.4  
31.3  
31.2  
31.1  
31.0  
30.9  
30.8  
30.7  
30.6  
30.5  
30.4  
30.3  
30.2  
30.1  
30.0  
29.9  
29.8  
29.7  
29.6  
29.5  
29.4  
29.3  
29.2  
29.1  
29.0  
28.9  
28.8  
28.7  
28.6  
28.5  
28.4  
28.3  
28.2  
28.1  
28.0  
27.9  
27.8  
27.7  
27.6  
27.5  
27.4  
27.3  
27.2  
27.1  
27.0  
26.9  
26.8  
26.7  
26.6  
26.5  
26.4  
26.3  
26.2  
26.1  
26.0  
25.9  
25.8  
25.7  
25.6  
25.5  
25.4  
25.3  
25.2  
25.1  
25.0  
24.9  
24.8  
24.7  
24.6  
24.5  
24.4  
24.3  
24.2  
24.1  
24.0  
23.9  
23.8  
23.7  
23.6  
23.5  
23.4  
23.3  
23.2  
23.1  
23.0  
22.9  
22.8  
22.7  
22.6  
22.5  
22.4  
22.3  
22.2  
22.1  
22.0  
21.9  
21.8  
21.7  
21.6  
21.5  
21.4  
21.3  
21.2  
21.1  
21.0  
20.9  
20.8  
20.7  
20.6  
20.5  
20.4  
20.3  
20.2  
20.1  
20.0  
19.9  
19.8  
19.7  
19.6  
19.5  
19.4  
19.3  
19.2  
19.1  
19.0  
18.9  
18.8  
18.7  
18.6  
18.5  
18.4  
18.3  
18.2  
18.1  
18.0  
17.9  
17.8  
17.7  
17.6  
17.5  
17.4  
17.3  
17.2  
17.1  
17.0  
16.9  
16.8  
16.7  
16.6  
16.5  
16.4  
16.3  
16.2  
16.1  
16.0  
15.9  
15.8  
15.7  
15.6  
15.5  
15.4  
15.3  
15.2  
15.1  
15.0  
14.9  
14.8  
14.7  
14.6  
14.5  
14.4  
14.3  
14.2  
14.1  
14.0  
13.9  
13.8  
13.7  
13.6  
13.5  
13.4  
13.3  
13.2  
13.1  
13.0  
12.9  
12.8  
12.7  
12.6  
12.5  
12.4  
12.3  
12.2  
12.1  
12.0  
11.9  
11.8  
11.7  
11.6  
11.5  
11.4  
11.3  
11.2  
11.1  
11.0  
10.9  
10.8  
10.7  
10.6  
10.5  
10.4  
10.3  
10.2  
10.1  
10.0  
9.9  
9.8  
9.7  
9.6  
9.5  
9.4  
9.3  
9.2  
9.1  
9.0  
8.9  
8.8  
8.7  
8.6  
8.5  
8.4  
8.3  
8.2  
8.1  
8.0  
7.9  
7.8  
7.7  
7.6  
7.5  
7.4  
7.3  
7.2  
7.1  
7.0  
6.9  
6.8  
6.7  
6.6  
6.5  
6.4  
6.3  
6.2  
6.1  
6.0  
5.9  
5.8  
5.7  
5.6  
5.5  
5.4  
5.3  
5.2  
5.1  
5.0  
4.9  
4.8  
4.7  
4.6  
4.5  
4.4  
4.3  
4.2  
4.1  
4.0  
3.9  
3.8  
3.7  
3.6  
3.5  
3.4  
3.3  
3.2  
3.1  
3.0  
2.9  
2.8  
2.7  
2.6  
2.5  
2.4  
2.3  
2.2  
2.1  
2.0  
1.9  
1.8  
1.7  
1.6  
1.5  
1.4  
1.3  
1.2  
1.1  
1.0  
0.9  
0.8  
0.7  
0.6  
0.5  
0.4  
0.3  
0.2  
0.1  
0.0

Handwritten scribbles and lines, possibly representing a geological profile or boundary.

Handwritten text: "Limestone" and "sandstone".

73.00 E  
X 41.80 N

Handwritten text: "sandstone", "conglomerate".

75  
76

016791

4450  
NORTH

44 E

METRIC L  REL

24/6/97. Jimmy Portal

Dip  $N50^{\circ}E$

#1 Structure  $295^{\circ}$  Dip  $65^{\circ}NE$

#2 = Floor of Wings  $20^{\circ}$  Dip  $40^{\circ}E$

LOCATION of Collar  $42+20N$   $44-14E$

115

Banner

A

4300 E

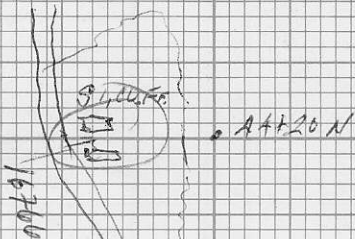

4400 N

4715 E  
43175 N

16767

# ADDIE: Hold

ASE	x	40+80	N	47+00E	42+00N
1111		41+00	N	11 1	42+20
1111		41+20	N	11 1	42+40 N
1111		41+40	N	11 1	42+60 N
11-11		41+60	N	11 1	42+80
11 11		41+80	N	11 1	43+00 N
11 1		42+00	N	11 1	43+20 N
11 11		42+20	N	11 1	43+40
11 11		42+40	N	11 1	43+60 N
11 11		42+60	N	11 1	43+80 N
11 11		42+80	N	11 1	44+00 N
11 11		43+00	N	48+00E	41+80N
11 11		43+20	N	11 11	42+60N
11 11		43+40	N	11 11	42+20N
11 11		43+60	N	11 11	42+40N
11 11		43+80	N	11 11	42+60 N
11 11	x	41+80N	43+40N	11 11	42+80N
11 11		42+00N	43+60N	11 11	43+00N
11 11		42+20	43+80 N	11 11	43+20 N
11 11		42+40	44+00 N	11 11	43+40 N
11 11		42+60	44+20 N	11 11	43+60 N
11 11		42+80		11 11	43+80 N
11 11		43+00			
11 11		43+20			

Jimmy

N

Old in

S 20M = Rad S 42M = 44x100E X 41x87-N

16764 Water for Dump Sample

16763 BS 17LE

Coal trench  
see original silica replacement in mine  
Pb: Zn - Cu, Py  
16765

Dump 10M  
x 6M flat top

1300

20/6/87 Jimmy? Alder Backery  
Cased adit 130° at least 50 feet  
Approx 1M x 2M high. Clean  
break on walls. Shear?



Jimmy

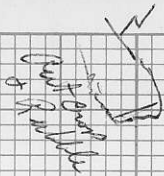

16778

41+80N

ROAD



16779

41+60N



44+06E

METRIC LEVEL

BANNER

W

MAIN

48150 E

16785

16783

16784

16782

16786

3309

16787  
3770  
38

OWDill Mt  
Comp  
quartz  
Mills

33100  
N

METRIC LEVEL

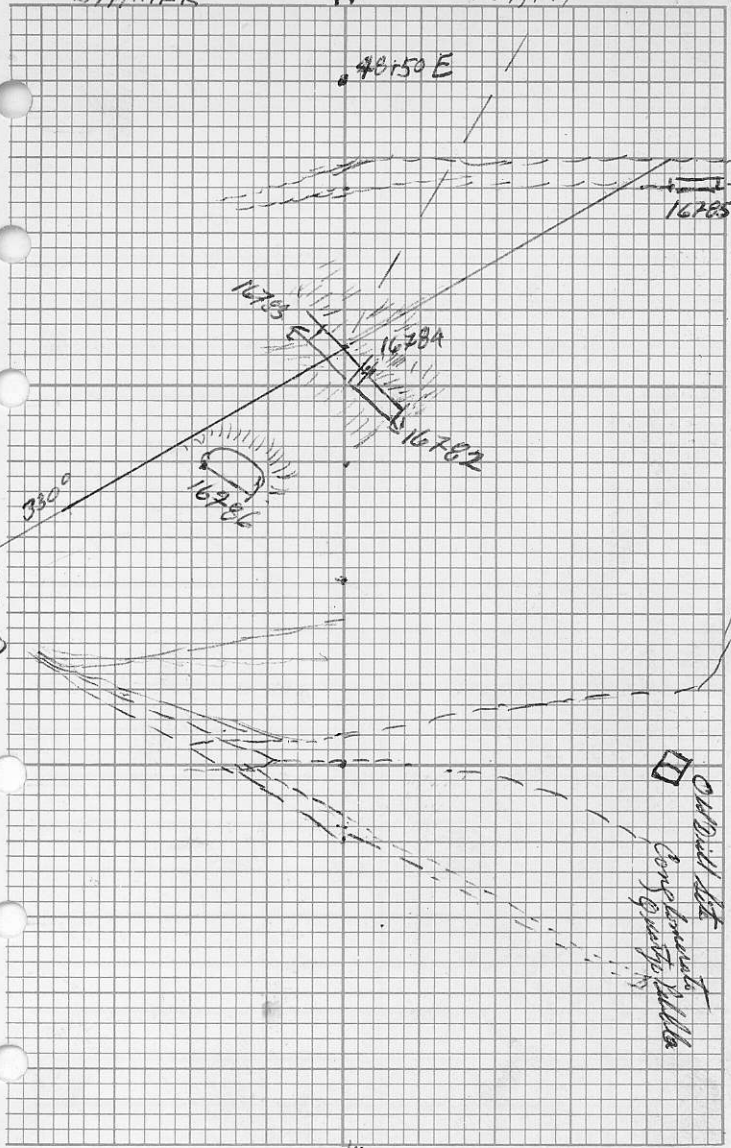

Banner Main Adit

53.3 M at 90° E

$$Portal = 48 E \times 38 + 40 N = 32 M @ 116$$

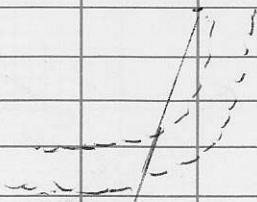

38.00 N  
49.50 E  
X

~~Surface  
Mineralization~~

BANNER ADIT

BANNER

N

H. Co. Drilling

39+40N

37+30N

39+20N

37+60N

57+00N

SI  
16790

16790

SI

16781

400  
E

METRIC LEVEL

~~ROAD~~

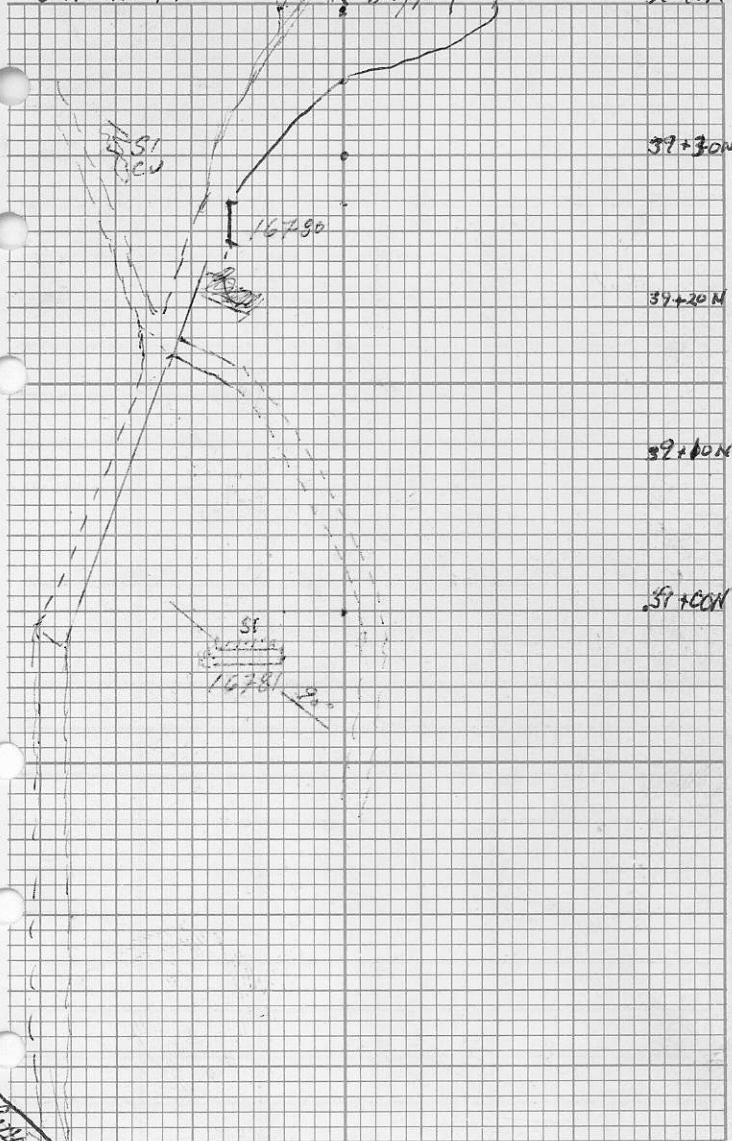

Dead Wood old Hand Trenching.

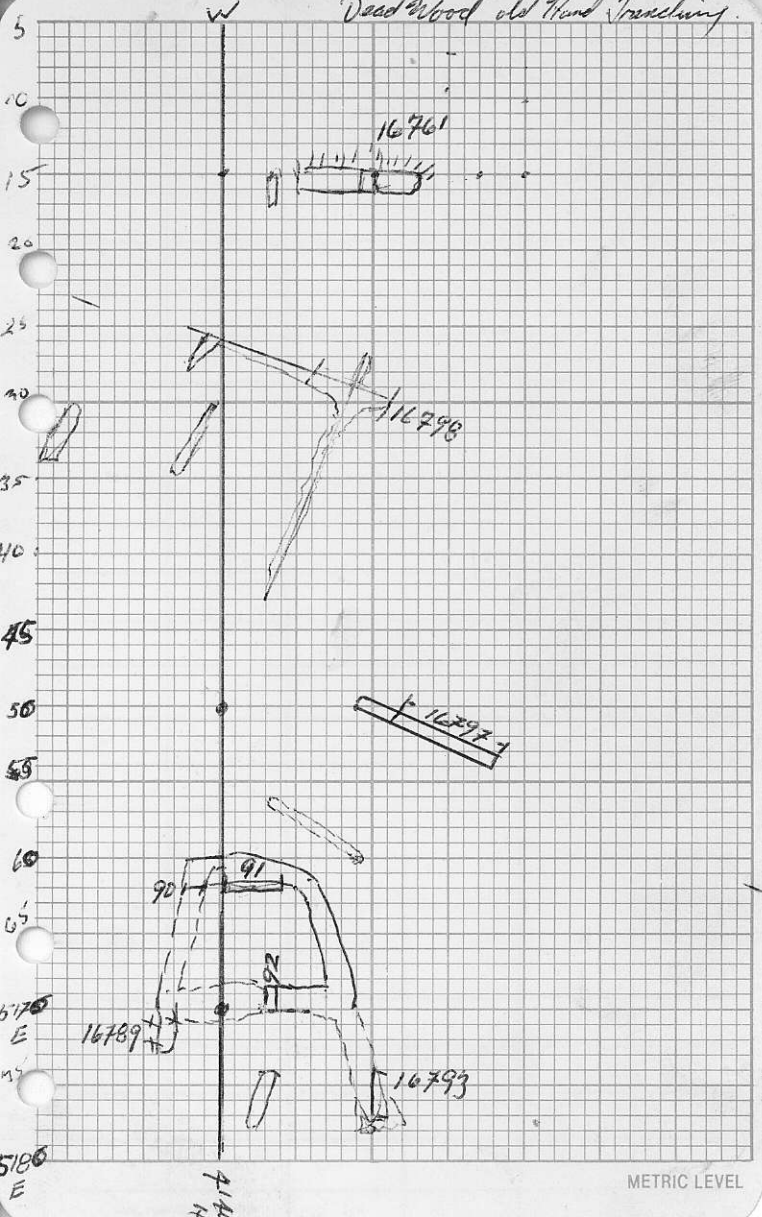

5200 E x 41+40 N

Dead Wood

41+40 <sup>7</sup>/<sub>16</sub> in line = 100M to 51.00 x 41+25 N

52+09 E = 22073 P.T

52+30 = ROAD

Ako  
N

6099  
16865  
A5718

PIT  
16868  
16869

010  
005  
005

A5716

G4100 E

A1100  
N

#8

METRIC LEVEL

		<sup>E</sup>	<sup>N</sup>		
DPH	#8	63+80	44+10	S	-45°
DPH	#7	64+15E	44+21	S	-45°
DPH	#15	64+45	44+20	S	-45°
DPH	#16	n n	n n	S	-60°

$$64+82E \times 44+20N = 6500E \times 4450N$$

$$66+100E-10 \times 45+19N = 4420N$$

$$65+55E \times 44+65N = \text{Old Pit uncorrected}$$

6



# Homestake

SHAKE



41+00N

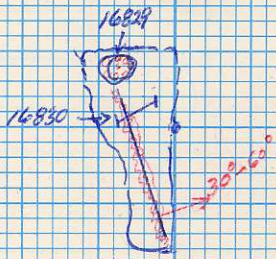

40+50N

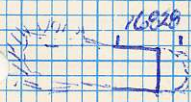
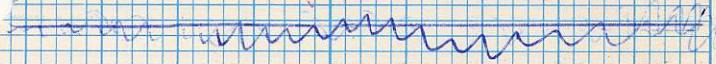

30



40+20N



SHAKE

Kanmer North W

10807

2  
45 Meters  
10 Seep

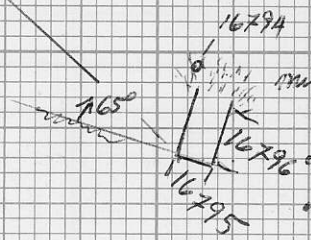

4900  
EAST

N  
10807

METRIC LEVEL

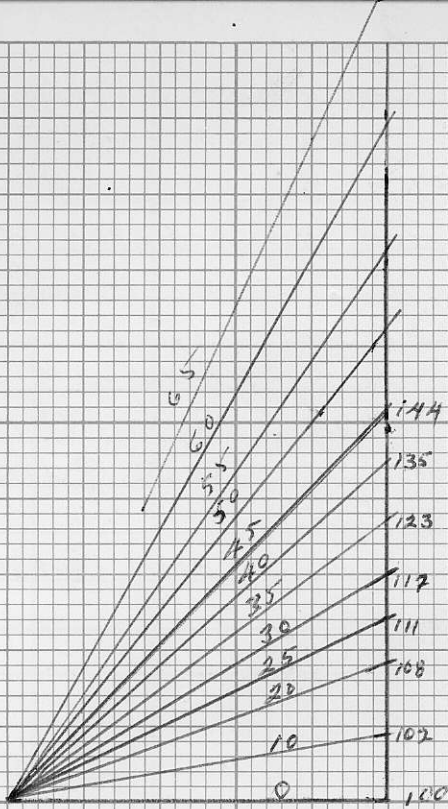

N. Banner Boundary, 18/6/97

100 M S = area fold out line & Gas  
Barrel. Approx 130 M = 4800 EX

41+66N + 10M (from NE Corner BANNER

Approx 160 M = 4700 EX 41+90N + 10M,

= Cliff 1230 M elev. 250 M uncorrected

= Banner IP 30 M North.

I.P. + 99 = 4600 EX 41+60N + 2M

Approx 1175 M elev. IP + 149 M =

Cliffs 1165 M elev. Approx SW Corner  
on lower Road.

Barometer correction - 10 M. @ 4:30 PM

Homestake station.

Prospecting.

3/6/87 Dinesmore Creek. Much  
sheared Rock. Ig. mass. Noted  
fine silica honey comb in pink  
syenite. Some heavy hornblende  
flats, + stalks  $\frac{1}{2}$  inch. Noted  
Pyroxenite dike? 4150' elev N of  
Dinesmore. Cut by alkaline veinlets.  
(N30W!) Found old Prospect  
Pit approx 10' x 10' x 3' Deep.  
on Quartz in Volcanic? Minor  
sulphide.

4/6/87 Worked South side of Lucke  
claims + Lucke Pup anomaly.

Abundant Basalt outcrop exposed  
in road cut on East of Lucke  
Mine outcrop + air subcrop  
of pyroxenite on Lucke Pup.

Sampled mineralized  
silicified zone on road  
cut East south of Union  
Drive -

Two for trip back to pick  
up truck.

## Silt

- 3/6/87 - 87-P1 to P6  
Dinsmore - Notes by Larry Elbert,
- 4/6/87 "Larson" Cr. One Past Creek  
87-P-7 = Main Cr 4600' elev  
100% igneous float - 20% Basic  
Fine - Med sandy Brown silt.
- 87-P-8 N trib. Main Cr  
100% igneous cobbles, mostly acid.
- 87-P-9 Main Cr. 4000' elev  
Fine - Med. Brown sandy. Float 100%  
igneous.
- 87-P-10 South fork. Fine to coarse grey  
Bm. Some organic?
- 87-P-11 Mouth (bridge) of One Past Cr. Med  
Bm Sandy. Conglomerate outcrop
- 87-P-12 Lucke Cr near What Brady  
Cong. outcrop + 50% Basic float.  
Med. Dark grey sandy
- 87-P-13 Dark Red Brown soil over lying  
Rusty sulphide bearing Basic  
1705' elev above Lucke, Borrow Pit.
- 87-P-14 Simonite Springs 0.1 KLM -  
Lucke Road 1310 M elev

Silts

87-P-15 Luske Cr. 4980' elev.

Med sandy silt L. Brn.

87-P-16 Luske Cr. 4540' elev.

Fine sandy silt L Brn.



Prospecting

7/6/87 Worked One Past Creek,  
down from 4600' elev. All igneous  
20% basic = float at this joint. Talus  
on W side high = Basic segregation.  
Lots of Red spongy float.  
Rest of talus appears all Monzonitic  
Diorite. Minor sulphide in talus  
at 1270 Mtr elev. South side.  
= Faulted shear in fresh diorite.

8/6/92 Worked Part day on west  
edge of Lake. Noted New (Feb 20/82)  
P-L Line. Abundant Basic float  
in Lake Cr. Noted Large Red  
Spongy Porphyry cutting Conglomerate  
on P-L east Boundary.



Acco

N

Quartzite  
Top of Bluff

200  
K3  
16837  
16839

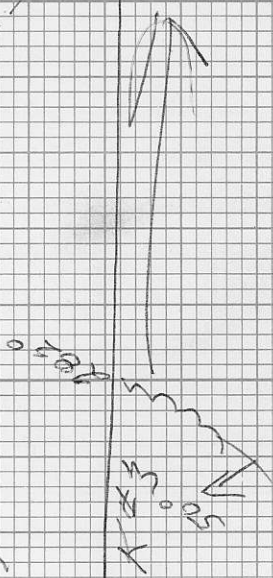
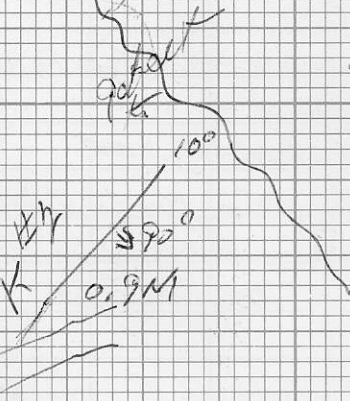
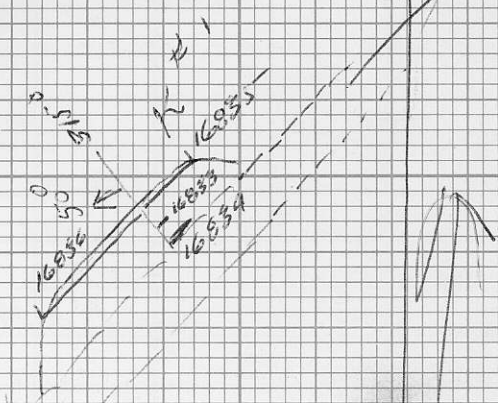

16/7/87 ALCO 442-3207

Pete Kootchie

General Forks

John Nedokus #325

Recent Work, by Noranda

0.17 ~~100~~ = 1.1 M. HB.

Greenmt. Down <sup>#</sup>OK, Work

1st \$2500

\$10,000

2nd \$5000

\$50,000

3rd \$10,000

\$100,000

\$1000 thereafter + 2 1/2% MSR. Buyout & Mill  
Record assessment etc.

21/7/87 Adit Trail

\* 1 Pit = lens - vein 0.3 - 1 M. Main FE & Cu

Strike 70° Dip 60° N.

adit @ 950 elev - from 425' 340°

1-1 Meter faulted sulphid Quartz B.lk.

Some 1" - 2" Veining @ 70° Dip 50° N.

150 M 25° Slope S = Main shaft