

LINE 30800N

LINE 30600N

LINE 30400N

LINE 30200N

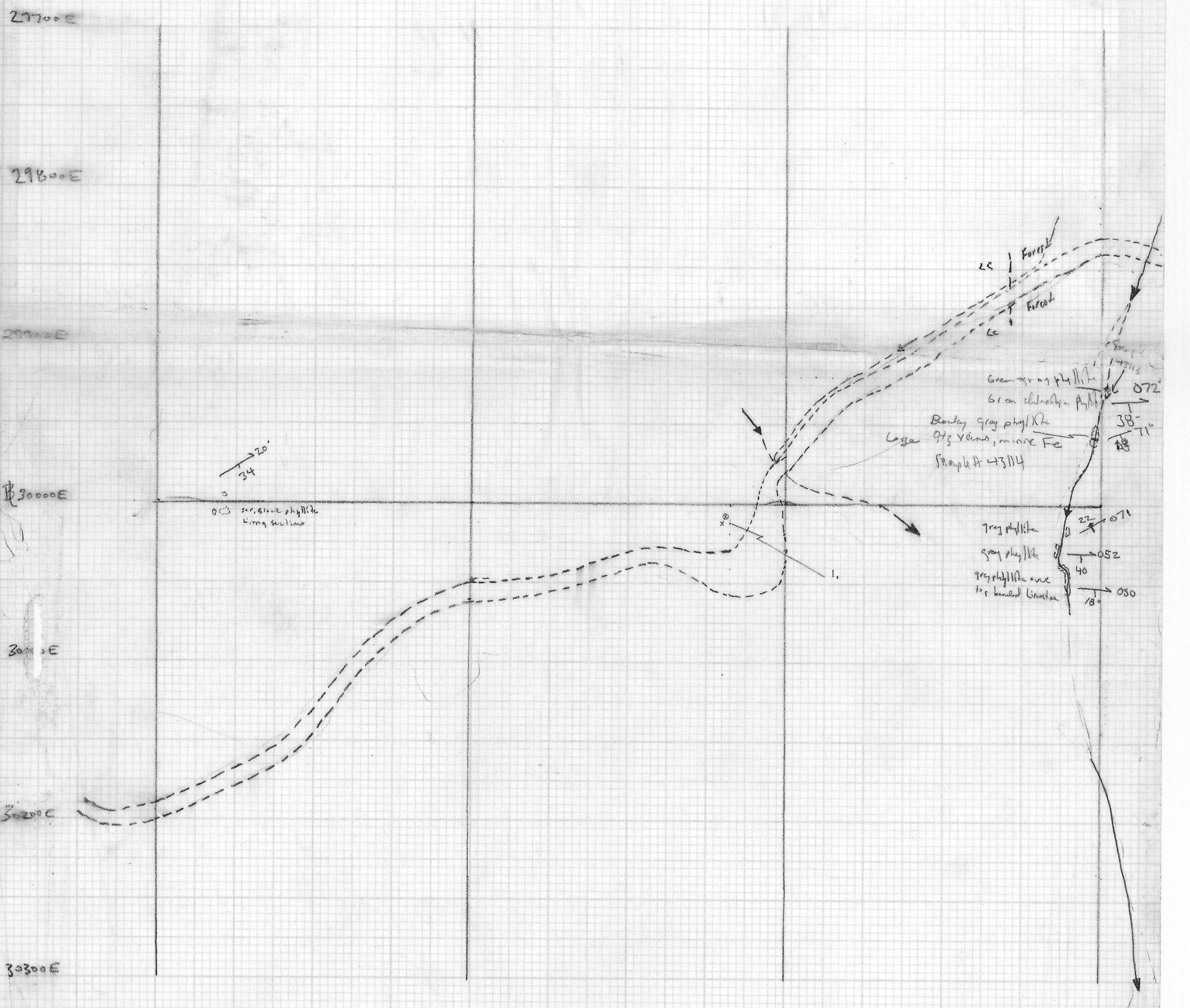

27700E

29800E

29900E

30000E

30100E

30200E

30300E

20'  
34'

DCS ser. silice phyllite  
Laga section

25 Forest  
 25 Forest  
 Green gray phyllite  
 Green chlorite phyllite  
 Dark gray phyllite  
 Laga Qtz veins, minor Fe  
 Sample # 43114  
 072  
 38  
 71  
 22  
 071  
 052  
 40  
 050  
 Trey phyllite  
 gray phyllite  
 gray phyllite over  
 to be banded limestone

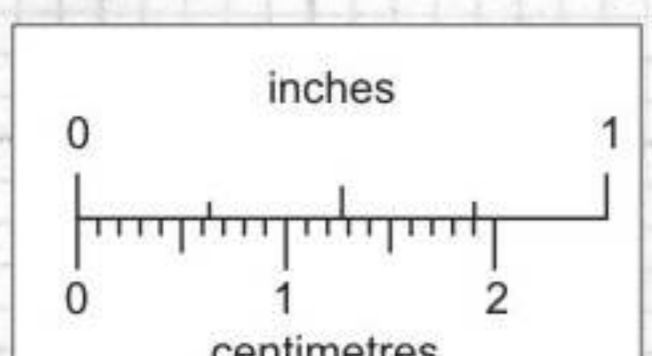

This reference scale bar  
 has been added to the  
 original image. It will  
 scale at the same rate  
 as the image, therefore  
 it can be used as a  
 reference for the  
 original size.

NOBLE  
 862355