

SPRING '89 : CHIP SAMPLING

ZONES C1-C2

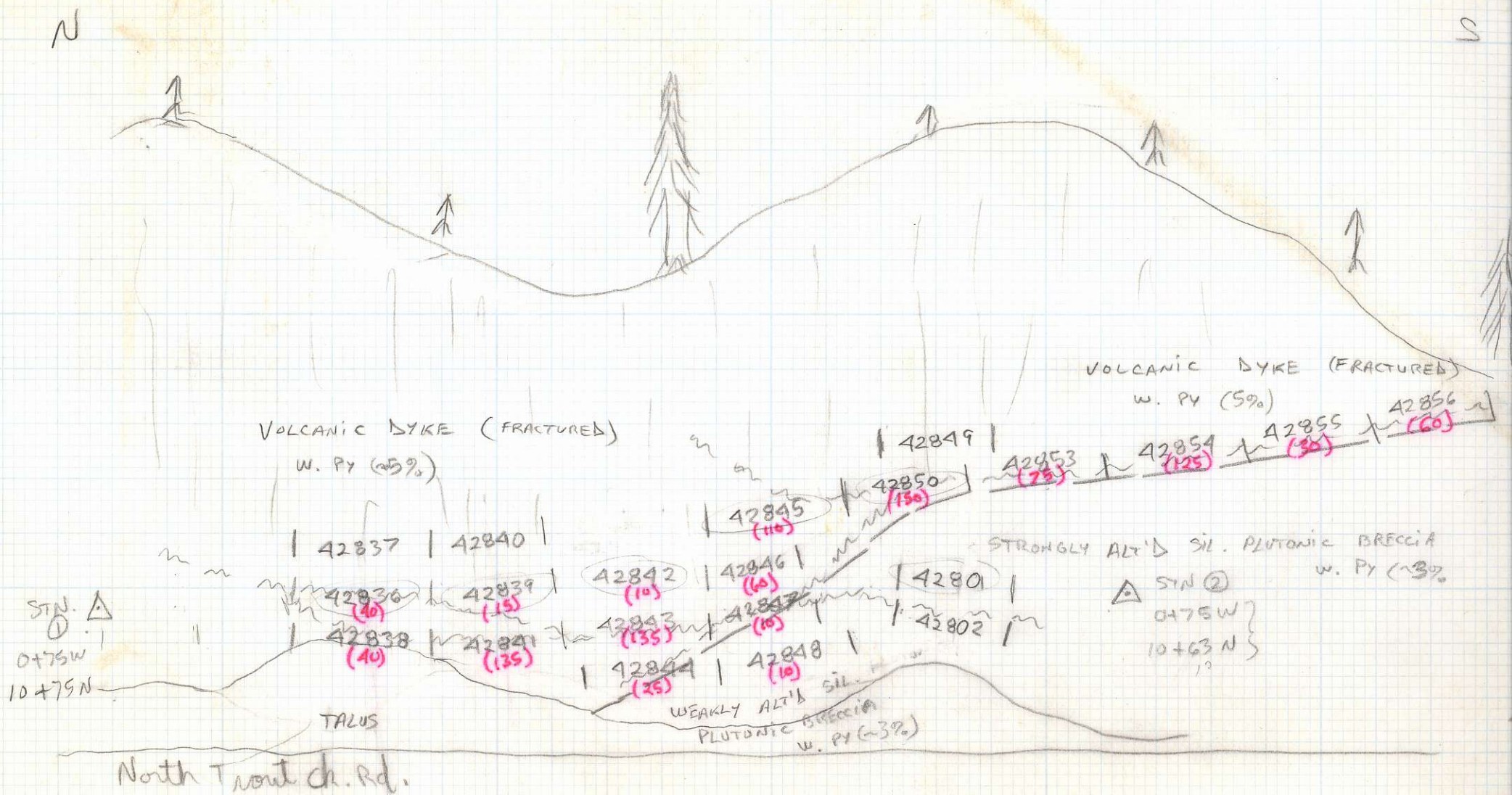

Mainly 1.5 m interval samples

21 SAMPLES

42850: circled samples repeat from '88

SPRING '89 : CHIP SAMPLING
 ZONE C4

810.6/9
 27.7
 1-3

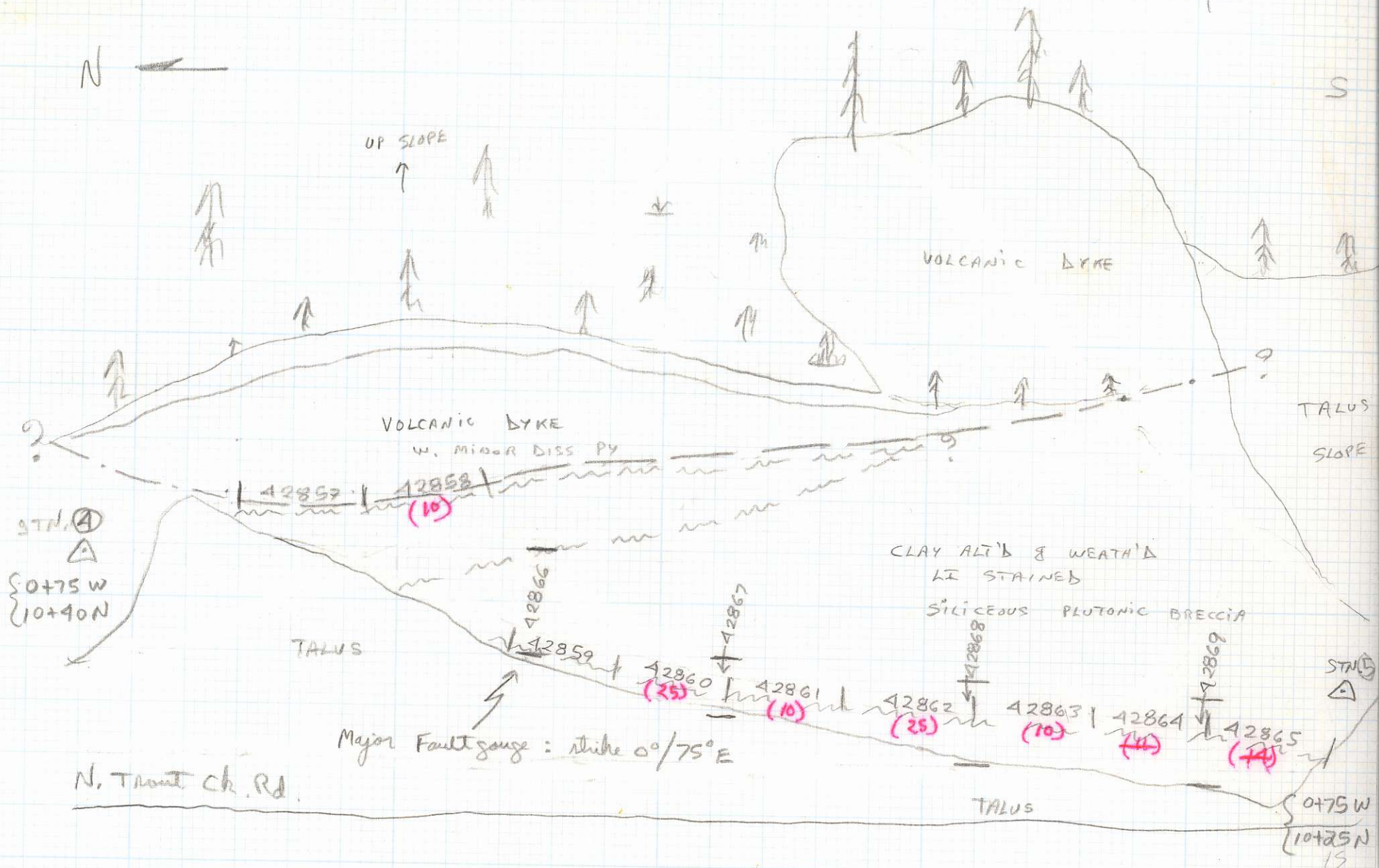

TOTAL = ⑬ SAMPLES

SPRING '89 : CHIP SAMPLING

5/23/89

ZONES C2-C3

N

S

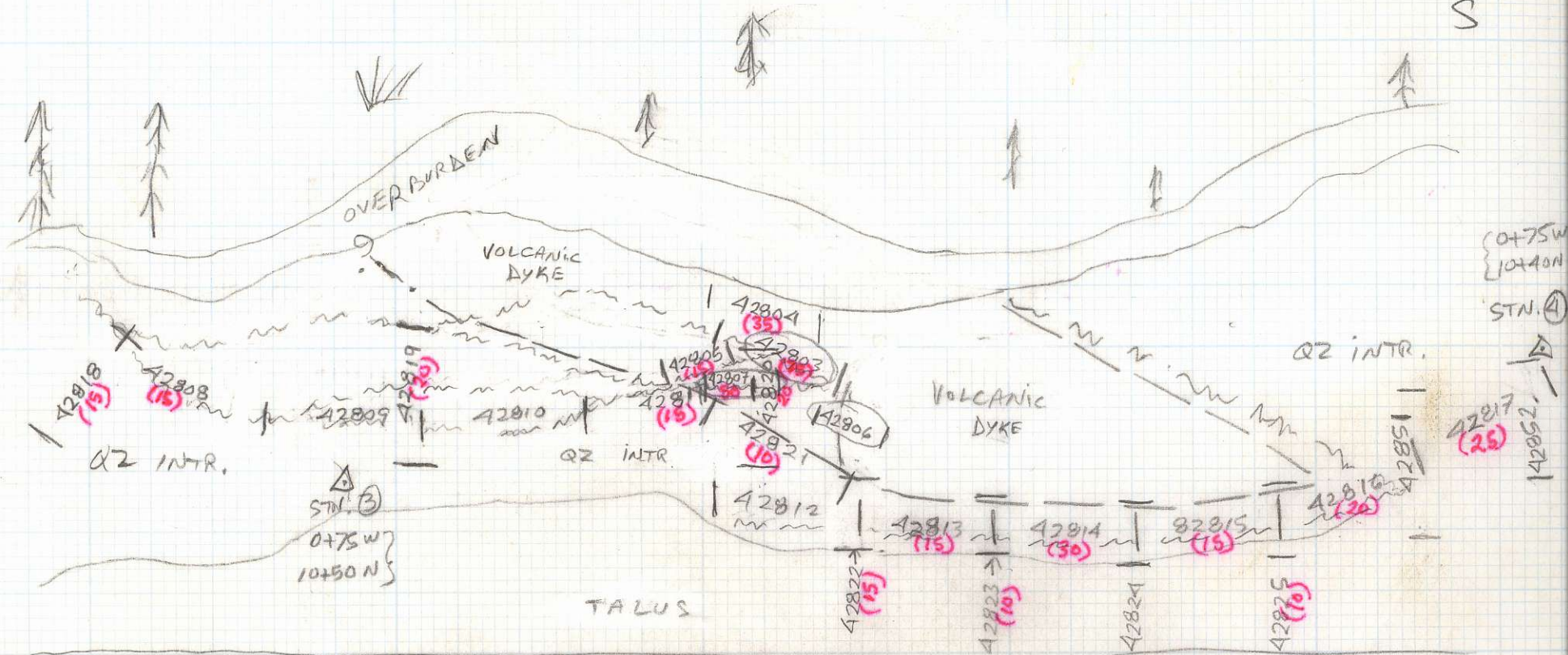

North Trout Ch. Rd

42803 = Repeat sampler from '88

(75) : Au values (ppb)

1.5 m chip samples are largest

TOTAL = (25) SAMPLES

SPRING '89 : CHIP SAMPLING

ZONE PA

(CROSS-SECTIONAL VIEW ALONG ROAD-CUT)

* ALL SAMPLES HAD GOLD VALUES < 5 PPB

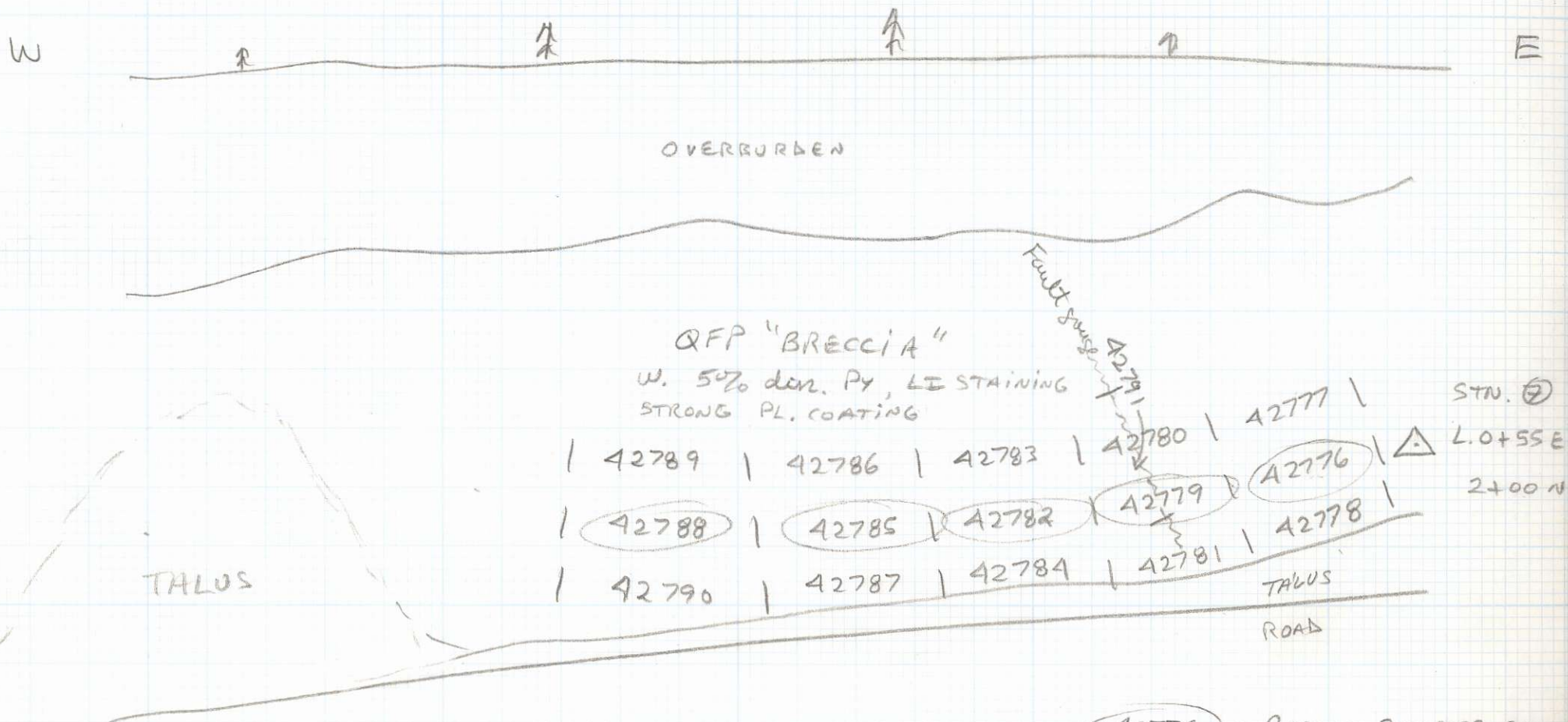

42776 : REPEAT SAMPLES FROM '88 CHIP SAMPLING PROGRAM

TOTAL = 16 SAMPLES

SPRING '89 : CHIP SAMPLING

ZONE N2

(CROSS-SECTIONAL VIEW ALONG ROAD-CUT)

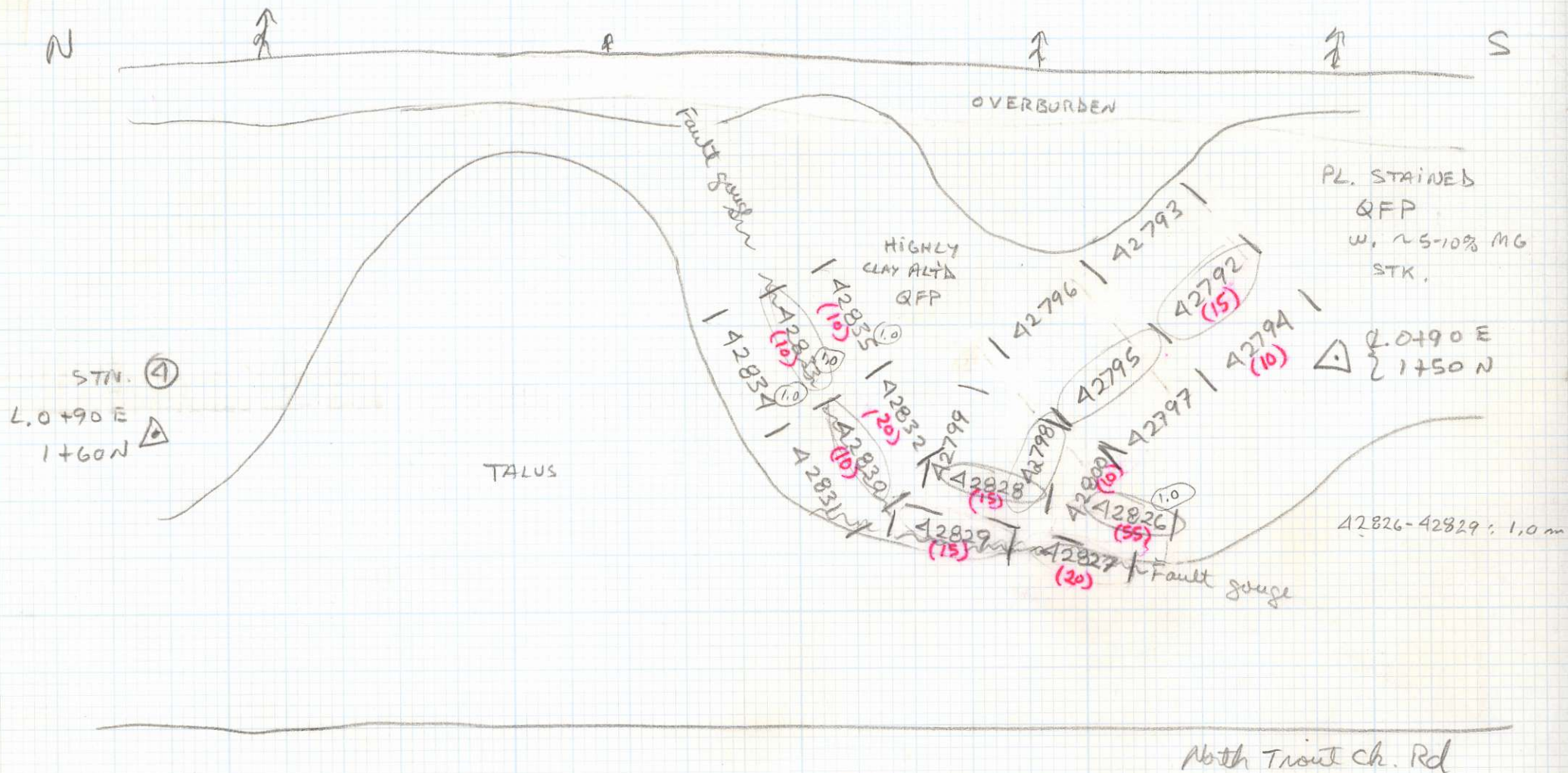

TOTAL = ①9 SAMPLES

④2829 : Repeat samples from '88
(15) : Au values (ppb)