

Electronic Laboratories

OF CANADA LIMITED

862114

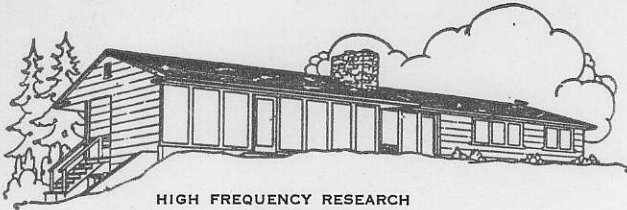

HIGH FREQUENCY RESEARCH
DESIGN ENGINEERING
CERTIFIED RADAR SERVICE AGENCY
PATENT DEVELOPING AND LICENSING
ELECTRONIC CONSULTANTS

TELEPHONE GLENBURN 1494

281 NORTH HOWARD AVENUE
VANCOUVER, B.C.

February 18, 1957

REPORT ON PRELIMINARY MAGNETIC SURVEY ON THE HALO GROUP, ASPEN GROVE (NORANDA PROPERTY), B.C.

The survey was instigated by Mr. G.S. Eldridge who instructed the location of the survey. Samples from the vicinity indicated sufficient magnetite to warrant the use of a sensitive magnetic investigation.

A short survey with an earth inductor magnetic instrument was made on the slope of a hill as instructed by Mr. Eldridge. The accompanying plan indicates results from 11 stations. The results are graphically shown in vector form. These vectors are complete for plan view from combined vertical and horizontal readings and indicate the direction and strength of deviation created by distortion of the earth's magnetic field.

These measurements are made possible by the use of an earth inductor instrument that is not affected by diurnal changes and all readings are permanent.

All readings with the exception of number 4 are consistent and indicate the general direction of maximum magnetic intensity. The stronger readings indicate a bearing to the southwest and readings 1, 2 and 3 appear to be boundary readings.

The centre of strength and mass could only be determined by a more extensive survey so that the centre of concentration is bracketed by boundary readings. The location is indicated by an original stake and drill hole.

Summary:

It is regrettable that time was not available for further work on this property. However, as these readings, close to the terrain, were relatively consistent and strong there is every reason to believe a detailed survey of the area would produce results for relatively economic development of the property.

ELECTRONIC LABORATORIES OF CANADA LIMITED.

D.L. Hings,
President.

DLH:dcp

Enclosure.

NORANDA EXPLORATION COMPANY, LIMITED
PROPERTY SUBMISSION REPORT

N.T.S. No. 92H/15E

PROPERTY NAME Aspen Grove (Dote Claims) COMMODITY Cu

LOCATION Aspen Grove MINING DIVISION Nicola

49°56'N 120°37'W DATE SUBMITTED May 18/73

RECEIVED BY Ivor Saunders

OWNERS Dawood Mines Ltd. (NPL), P.O. Box 1499, Merritt, B.C.

CLAIMS (INCL. EXPIRY DATE) Dote 1-8, 11-18, Expire: 1978.

DESCRIPTION: (INCL. PREVIOUS WORK)

Chalcocite and bornite disseminated in basalt.

Several old workings with high-grade material in dump.

RECOMMENDATIONS Property in questionable location (ie. surrounding village)
* but may be of interest to look at in view of other work we are doing in the area.

SIGNED _____
Ivor Saunders

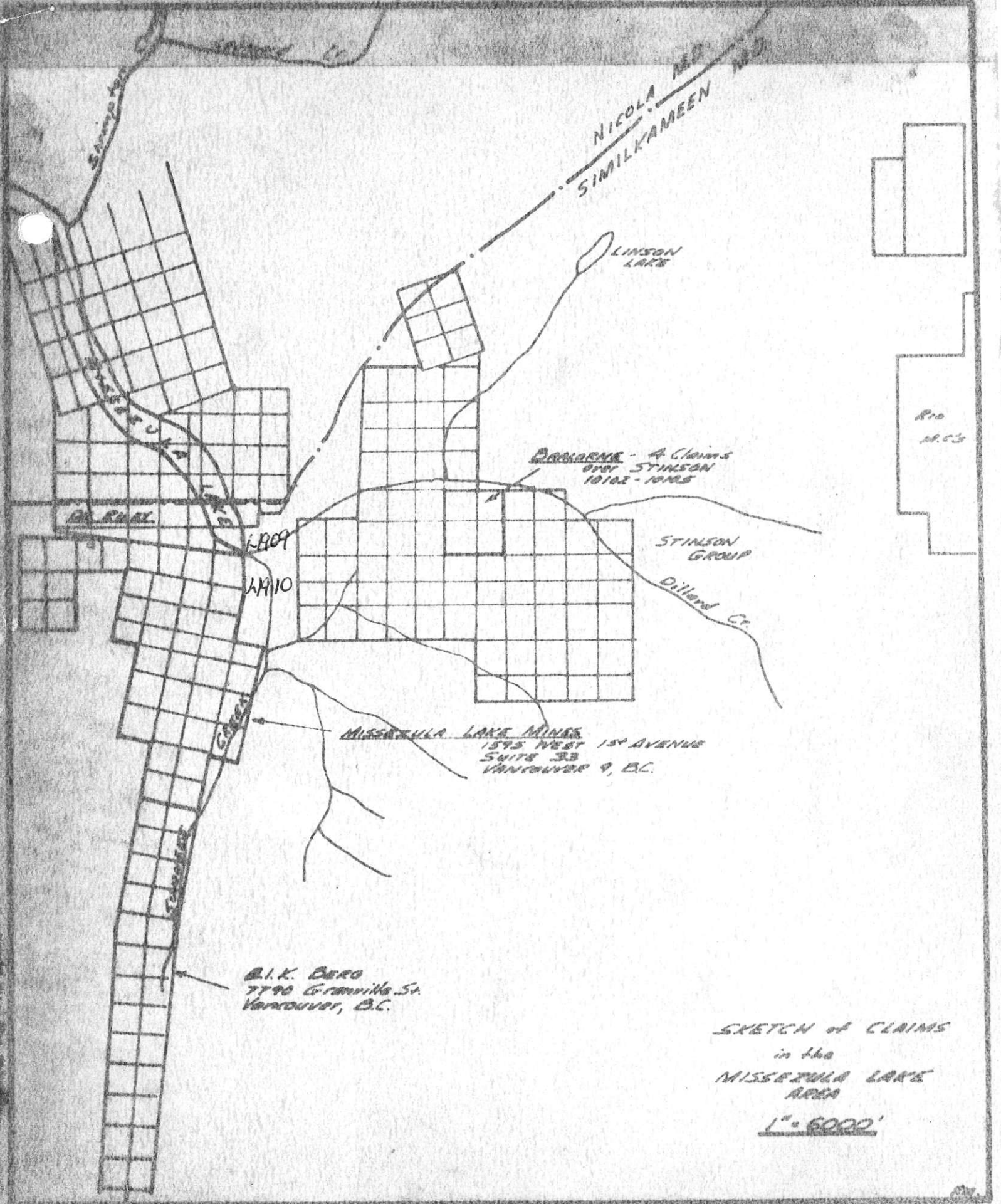

SKETCH OF CLAIMS
 in the
 MISSISSAUGA LAKE
 AREA
 1" = 6000'