

861870
Kootenay Inlet
Property

ACME ANALYTICAL LABORATORIES LTD. 852 E. HASTINGS, VANCOUVER B.C. PH:253-3158 TELEX:04-53124

ICP GEOCHEMICAL ANALYSIS

A .500 GRAM SAMPLE IS DIGESTED WITH 3 ML OF 3:1:3 HCL TO HNO3 TO H2O AT 90 DEG.C. FOR 1 HOUR. THE SAMPLE IS DILUTED TO 10 MLS WITH WATER.
THIS LEACH IS PARTIAL FOR: Ca, P, Mg, Al, Ti, La, Na, K, W, Ba, Si, Sr, Cr AND B. Au DETECTION 3 ppm.
SAMPLE TYPE - COMPOSITE

DATE RECEIVED AUG 11 1983 DATE REPORTS MAILED Aug 15/83 ASSAYER D. Toye DEAN TOYE, CERTIFIED B.C. ASSAYER

GULF TITANIUM FILE # 83-1593

PAGE # 1

SAMPLE #	Mo	Cu	Pb	Zn	Ag	Mi	Co	Na	Fe	As	U	Au	Th	Sr	Cd	Sb	Bi	V	Ca	P	La	Cr	Mg	Ba	Ti	B	Al	Na	K	W
	ppm	ppm	ppm	ppm	ppm	ppm	ppm	ppm	%	ppm	ppm	ppm	ppm	ppm	ppm	ppm	ppm	ppm	%	%	ppm	ppm	%	ppm	%	%	%	%	%	ppm
1-9-COMPOSITE	1	88	2	25	1.3	15	9	387	2.25	22	2	6	2	16	1	2	3	82	.97	.01	2	20	.74	4	.19	2	1.01	.02	.01	2

ACME ANALYTICAL LABORATORIES LTD.
852 E. HASTINGS, VANCOUVER B.C.
PH:253-3158 TELEX:04-53124

DATE RECEIVED AUG 11 1983

DATE REPORTS MAILED Aug 15/83

ASSAY CERTIFICATE

SAMPLE TYPE : ROCK - CRUSHED AND PRULVERIZED TO -100 MESH.
AU BY FIRE ASSAY

ASSAYER D. Toye DEAN TOYE, CERTIFIED B.C. ASSAYER

GULF TITANIUM LTD FILE # 83-1593

PAGE# 1

SAMPLE	AU OZ/TON
1	.062
2	.008
3	.402
4	.396
5	.004
6	.088
7	.372
8	.134
9	.046

WDG AUG 8/83
SAMPLES
I.D. GROUP
ANALYST
GULF TITANIUM LTD



To: Cusac Industries Ltd.,
330 - 890 W. Pender St.,
Vancouver, B.C.
V6C 1J9

ACME ANALYTICAL LABORATORIES LTD.
Assaying & Trace Analysis
852 E. Hastings St., Vancouver, B.C. V6A 1R6
Telephone: 253-3158

ASSAY CERTIFICATE

SAMPLES JUN 8/83
RESULTS JUN 13/83

File No. 83-0735
Type of Samples Rock
Disposition

No.	Sample	Au oz/ton					No.
1	64251	.198	A-2 D'1 from end.				1
2	64252	.265	300' prob along A-2				2
3							3



To: Cusac Industries Ltd.,
330 - 890 W. Pender St.,
Vancouver, B.C.
V6C 1J9

ACME ANALYTICAL LABORATORIES LTD.
Assaying & Trace Analysis
852 E. Hastings St., Vancouver, B.C. V6A 1R6
Telephone: 253-3158

ASSAY CERTIFICATE

SAMPLES JUN 15/83
RESULTS JUN 17/83

File No. 83-0810
Type of Samples Rock
Disposition

No.	Sample	Au oz/ton					No.
1	64253	.845					1
2	64254	.023					2

ACME ANALYTICAL LABORATORIES LTD.
852 E. HASTINGS, VANCOUVER B.C.
PH: 253-3158 TELEX: 04-53124

DATE RECEIVED AUG 20 1983

DATE REPORTS MAILED Aug 22/83

ASSAY CERTIFICATE

SAMPLE TYPE : ROCK - CRUSHED AND PRULVERIZED TO -100 MESH.
AG & AU BY FIRE ASSAY

ASSAYER Dean Toye DEAN TOYE, CERTIFIED B.C. ASSAYER

CUSAC INDUSTRIES LTD

FILE # 83-1749

PAGE# 1

SAMPLE	AU OZ/TON	AU OZ/TON	
63611	.13	.068	} other property. Cusac.
63612	.05	.031	
63613	.31	.446	
w/h. ? AB-BSPILE	.13	.930	} S. Finlayson BLUE MILES
ADIT-2	.10	.852	

W/h.

ACME ANALYTICAL LABORATORIES LTD.
952 E. HASTINGS, VANCOUVER B.C.
PH: 253-3158 TELEX: 04-53124

DATE RECEIVED AUG 29 1983

DATE REPORTS MAILED Sept 2/83

ASSAY CERTIFICATE

SAMPLE TYPE : ROCK - CRUSHED AND PRULVERIZED TO -100 MESH.

ASSAYER Dean Toye DEAN TOYE, CERTIFIED B.C. ASSAYER

GULF TITANIUM

FILE # 83-1891B

PAGE# 1

SAMPLE	AG		AU	
	OZ/TON	OZ/TON	OZ/TON	OZ/TON
S-1	.02	.001	.017	.001
S-2	.01	.017	.001	.002
S-3	.01	.001	.062	.012
S-4	.03	.002		
S-5	.03	.062		
S-6	.04	.012		

L.S. - SEND OF GRIP.
STARSCOPE AUG/83
A-1 ADIT SAMPLES

ACME ANALYTICAL LABORATORIES LTD.
 852 E. HASTINGS, VANCOUVER B.C.
 PH: 253-3158 TELEX: 04-53124

DATE RECEIVED AUG 29 1983

DATE REPORTS MAILED Sept 2/83

GEOCHEMICAL ASSAY CERTIFICATE

A .500 GM SAMPLE IS DIGESTED WITH 3 ML OF 3:1:3 HCL TO HNO3 TO H2O AT 90 DEG.C. FOR 1 HOUR.
 THE SAMPLE IS DILUTED TO 10 MLS WITH WATER. ELEMENTS ANALYSED BY AA: ZN, AG.
 SAMPLE TYPE: SOIL - DRIED AT 60 DEG C., -80 MESH, (PULVERIZED. *P*) because insufficient amount.
 AUX - 10 GM, IGNITED, HOT AQUA REGIA LEACH MIBK EXTRACTION, AA ANALYSIS.

ASSAYER *Dean Toye* DEAN TOYE, CERTIFIED B.C. ASSAYER

GULF TITANIUM

FILE # 83-1891A

PAGE# 1

SAMPLE	ZN PPM	AG PPM	AUX* PPB
1 0	42	.4	5
1 50	21	.3	10
1 100 P*	10	.1	5
1 150	30	.2	5
1 200 P	14	.1	5
1 250 P	130	1.1	35
1 300 P	102	.4	5
1 350	40	.1	5
1 400	110	.1	5
1 450	29	.1	5
1 500 P	27	.1	5
2 100	36	.3	5
2 150	20	.5	5
2 200 P	32	.3	5
2 250	21	.1	5
2 300 P	11	.2	5
2 350 P	150	4.6	15
2 400	48	.4	5
2 450	50	.2	5
2 500	45	.3	10
3 0	88	.4	5
3 50 P	55	.5	5
3 100	46	.4	5
3 150	36	.8	5
3 200 P	22	.5	5
3 250	68	.7	5
3 300	22	.1	5
3 350	140	.4	5
3 400	65	.5	5
3 450	27	.1	5
3 500 P	38	.1	5
4 0 P	28	.1	5
4 50	145	.7	10
4 100	66	.1	5
4 150	220	1.3	10
4 200	230	.4	15
4 250	170	.2	10

STARSCOPE
 AUG 1 1983
 GEOCHEM
 SAMPLES

GULF TITANIUM

FILE # 83-1891A

PAGE# 2

SAMPLE	ZN PPM	AG PPM	AU* PPB
4 300 P	14	.1	5
4 350	54	.3	5
4 400	74	.6	5
4 450	64	.4	5
4 500	58	.3	10
5 0	22	.3	5
5 50	40	.3	5
5 100	55	.3	25
5 150 P	70	.2	5
5 200	295	.3	5
5 250	360	.6	5
5 300 P	50	.5	5
5 350	80	.8	15
5 400	46	.4	5
5 450	40	.2	5
5 500	102	.3	5

STARSCOPE
AUG 1983
GEOCHEM.
SAMPLER

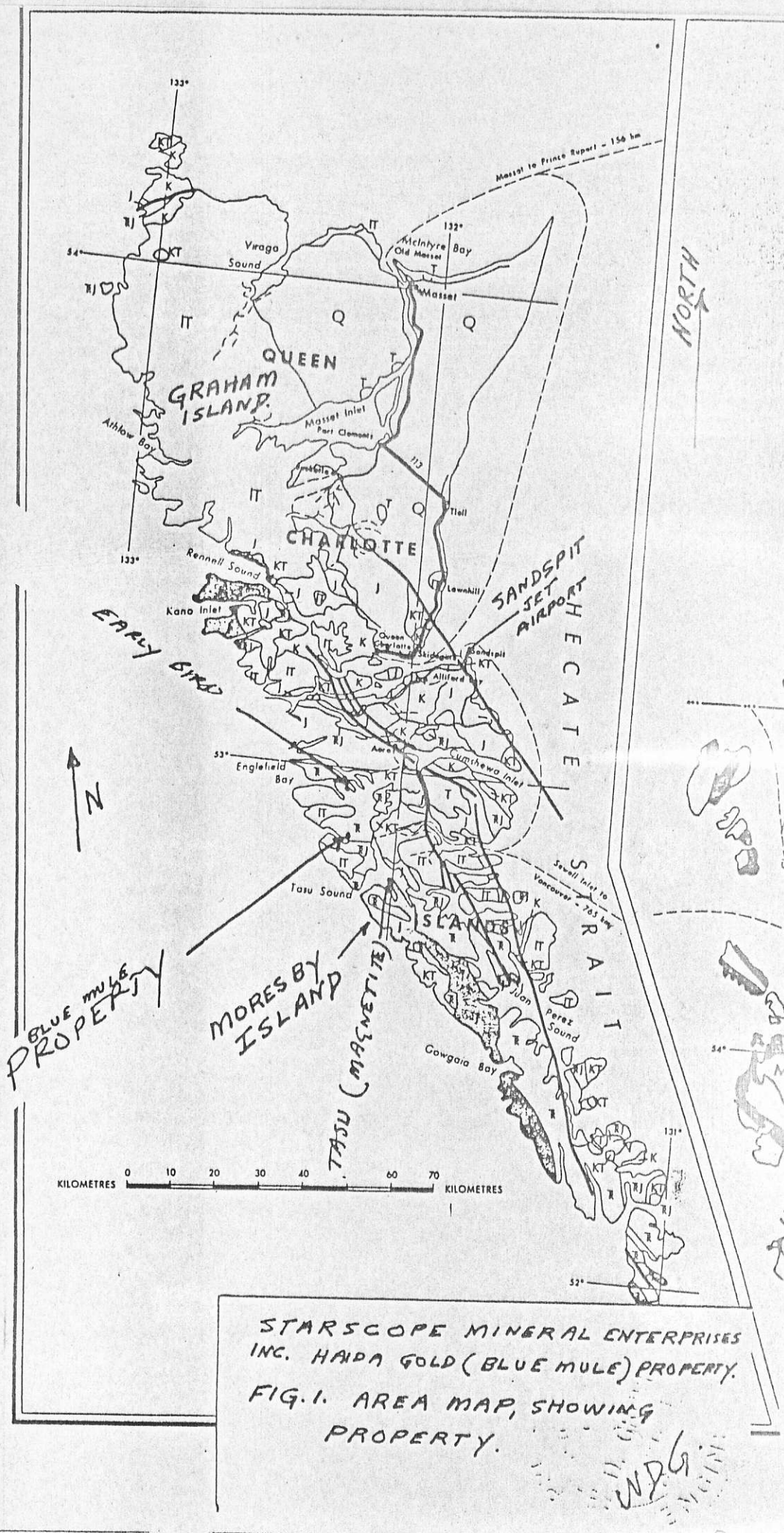

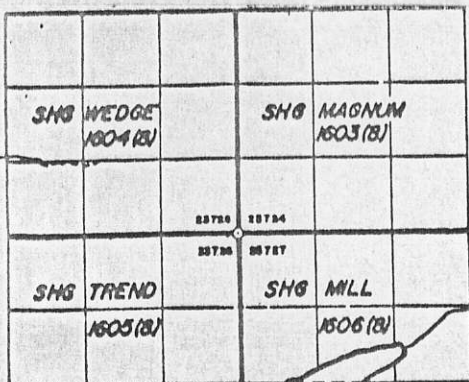

GILL + SWINDLE
CLAIMS -
STARSCOPE
PROPERTY

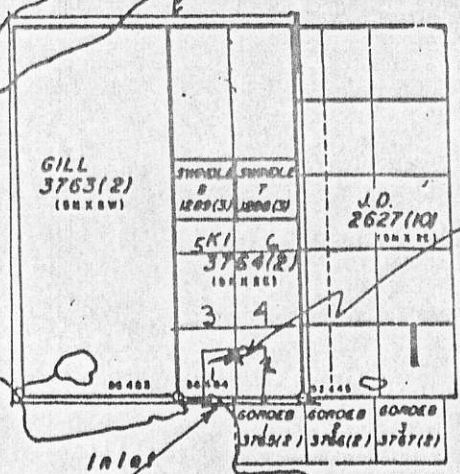

STRAWING
PACEN

ISLAND

1-UNIT
GEOCHEM
GRID

MOUNT
+
RUSS

SW QUADRANT
OF CLAIM
MAP.

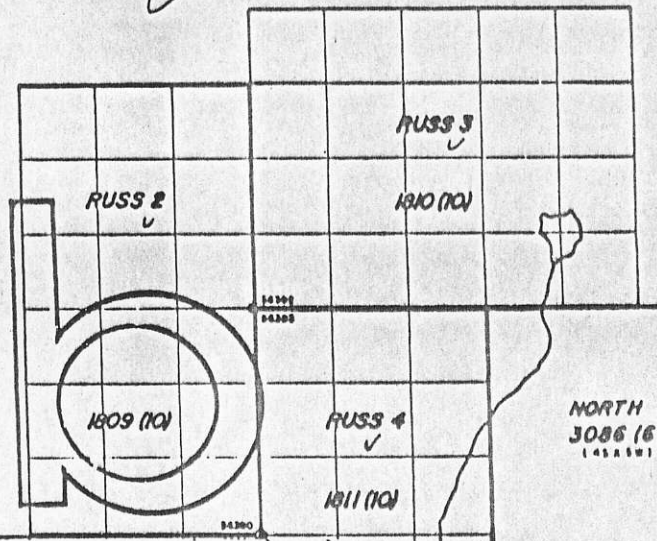

NORTH STAR 1
3086 (6)
(45X4W)

TO SOUTH SEE MAP 103C/9E

MINERAL TITLES REFERENCE MAP 103C/16E

DEPARTMENT OF MINES AND PETROLEUM RESOURCES VICTORIA, B.C.

This map is prepared as a guide only to the location of mineral claims that have not been surveyed. Where the geographic position of a legal corner post has been verified it is indicated with the symbol, Ver. Additional information is available at the Mineral Division concerned.

STARSCOPE MINERAL
ENTERPRISES INC.

HAIDA GOLD (BLUE MULE)
PROPERTY.

FIG. 2. CLAIMS MAP.
NTS 103C/16E.

P A C I F I C

W.D.G.

STARSCOPE MINERAL
 ENTERPRISES INC.
 BLUE MULE PROPERTY.
 FIG. 3
 REGIONAL GEOLOGY
 AFTER SUTHERLAND-BROWN.
 SCALE 2 MILES = 1 INCH.

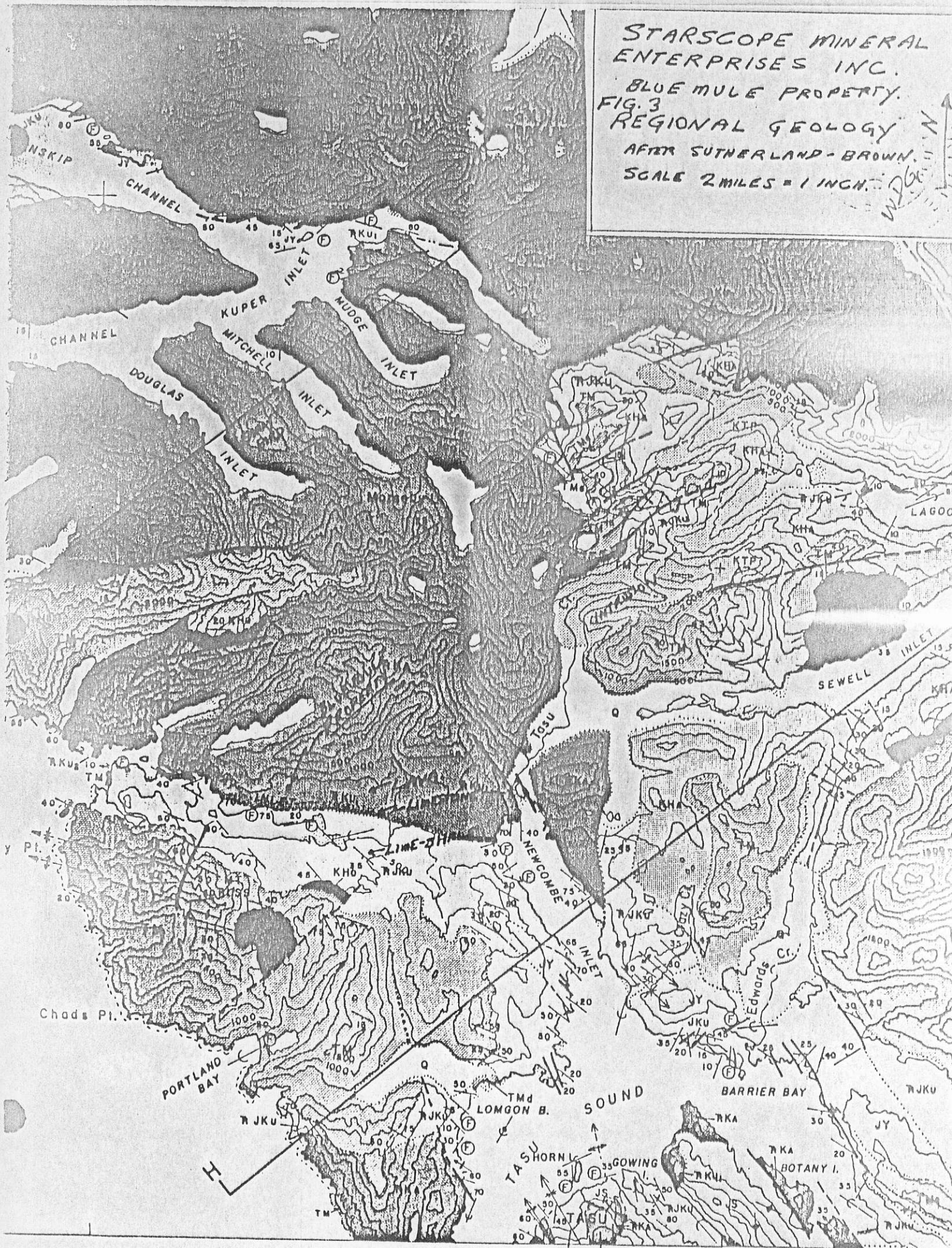

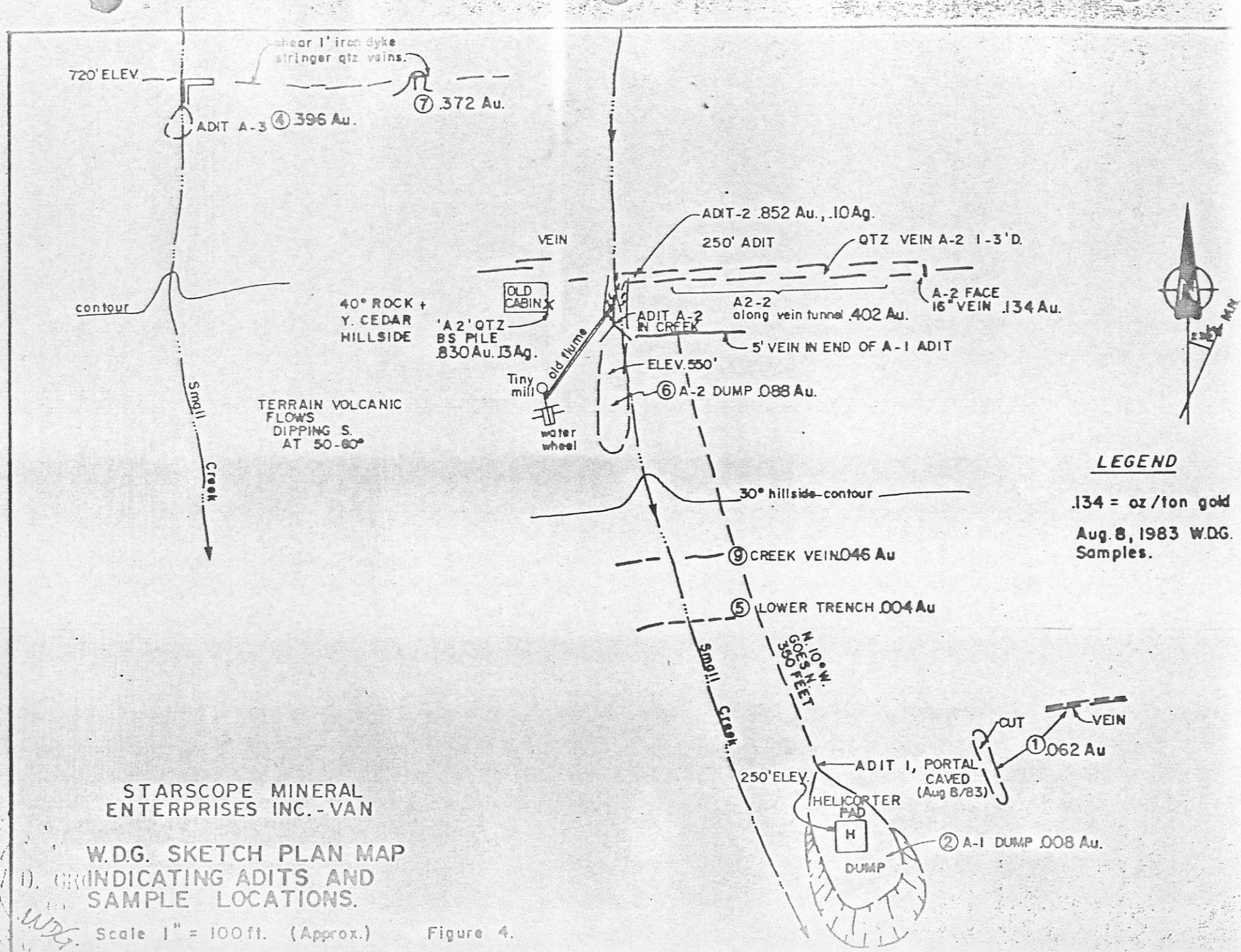

LEGEND

.134 = oz/ton gold
 Aug. 8, 1983 W.D.G. Samples.

STARSCOPE MINERAL ENTERPRISES INC. - VAN

W.D.G. SKETCH PLAN MAP INDICATING ADITS AND SAMPLE LOCATIONS.

Scale 1" = 100 ft. (Approx.)

Figure 4.

W.D.G.

LOWER PORTAL (P-1), SWINDLE CLAIMS

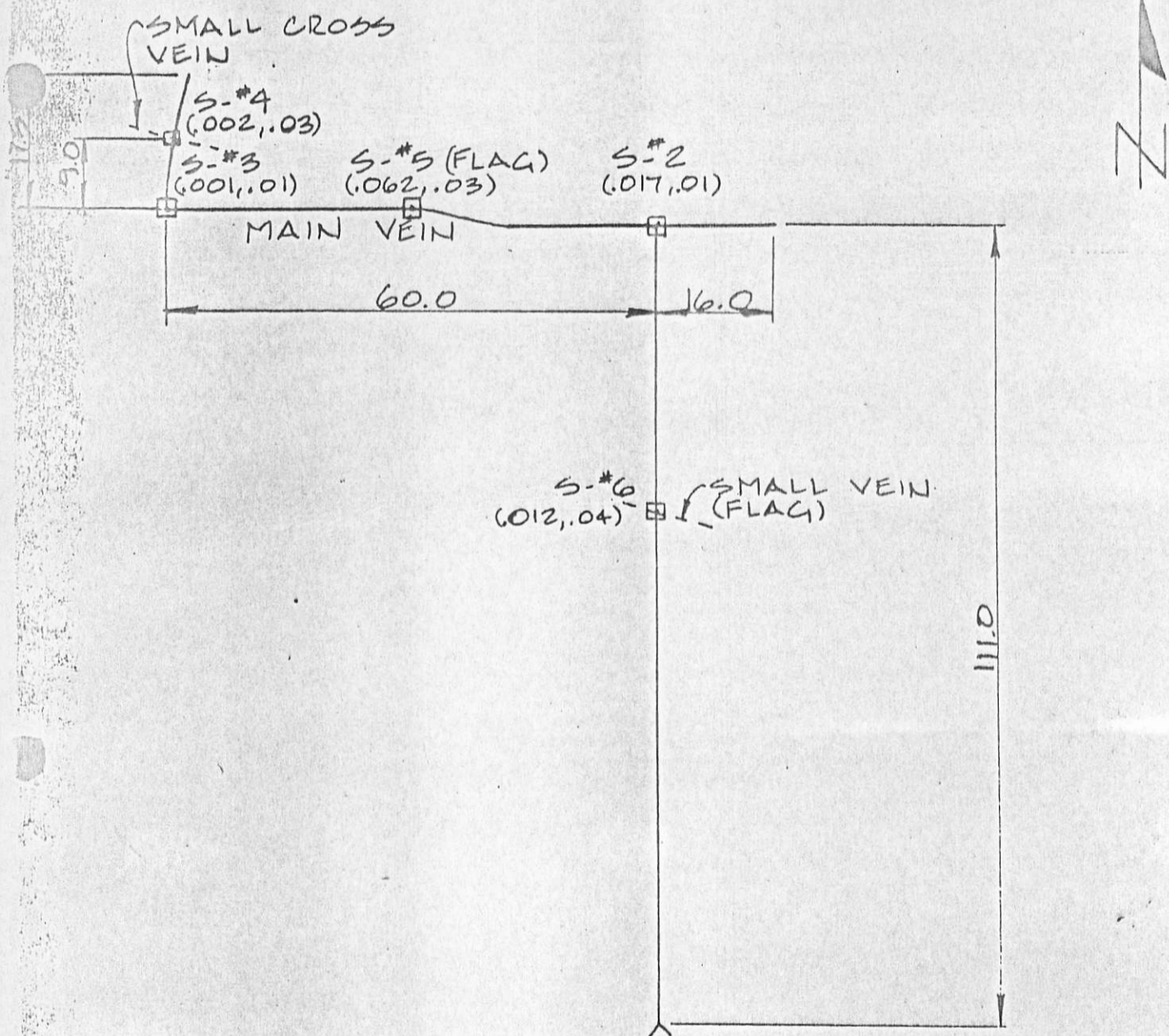

NOTES:

* Main vein is approximately 5'-0" wide throughout. But at end of 16.0M drift to right, vein seems to thin out to approximately 2 1/2'. At end of 60.0M drift to left, vein seems to veer off slightly to the SOUTH.

LEGEND:

Sample information:

eg.: S-#6
(012, .04)
indicates Au oz/ton, Ag oz/ton respectively.

SCALE: 1" = 20 Metres

STARSCOPE MINERAL
ENTERPRISES INC.
VANCOUVER, B.C.

BLUE MULE CLAIM

FIG. 5 A-1 ADIT PLAN,
AFTER D. BRETT / AUG. 1983

SHOWS POSITION OF SAMPLES S1-S6

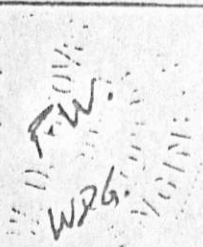

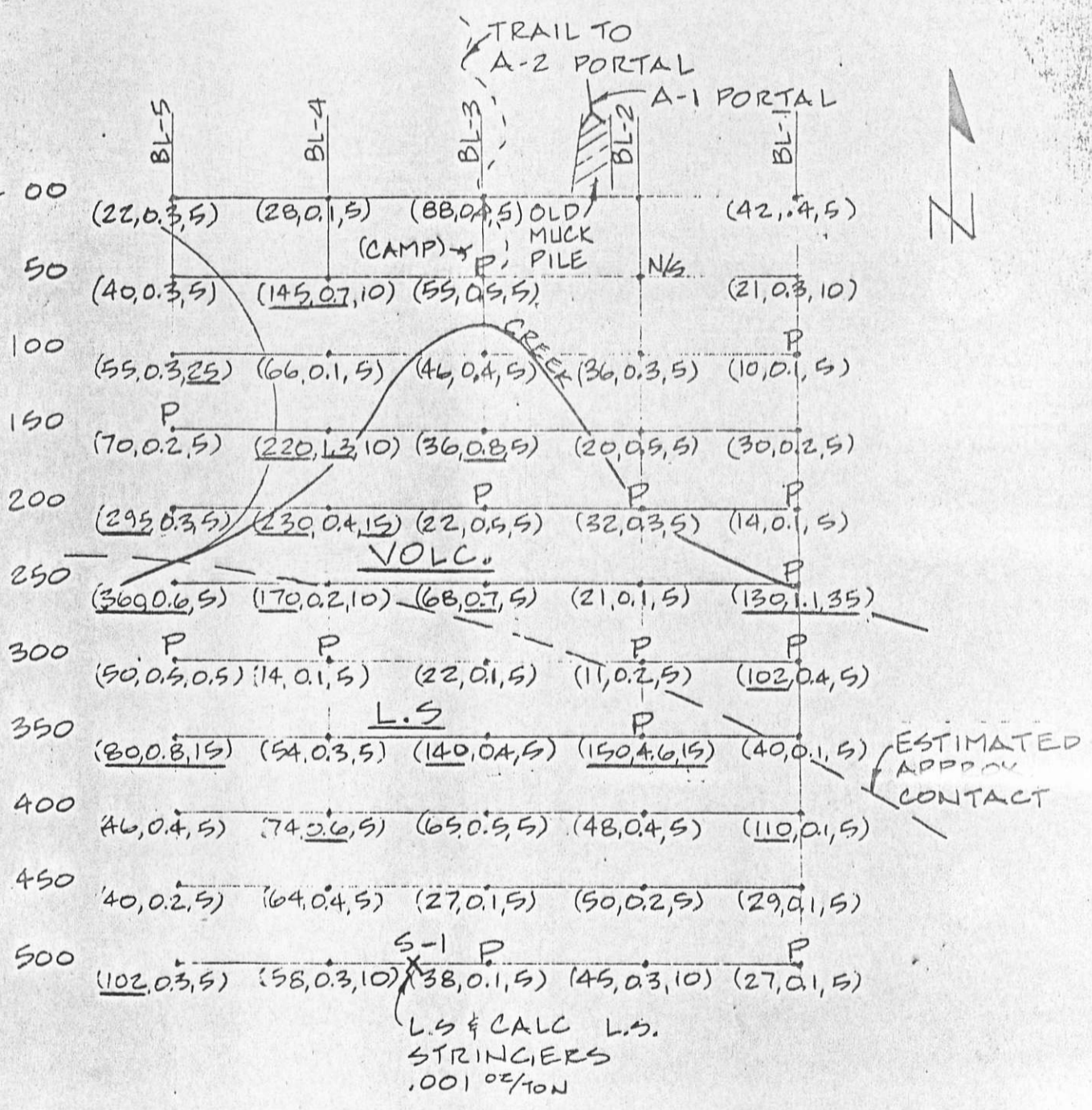

LEGEND:

Sample information:
 eg. (66,0.8,5)
 indicates Zn (PPM), Ag (PPM), Au (PPB)
 respectively. Amounts underlined indicate
 quantities of Zn > 100, Ag > 0.5, Au > 10

STARSCOPE MINERAL
 ENTERPRISES INC.
 VANCOUVER, B.C.

BLUE MULE CLAIM

FIG. 6 - GEOCHEM GRID, SWINDLE
 2-3 CLAIMS, FOR Zn, Ag, Au.

APPENDIX I.

p. 133 & 134.
NORTHWESTERN DISTRICT (No. 1), B. C.
REPORT OF THE MINISTER OF MINES, 1934.

**Halda Gold
Mines, Ltd.**

This company, with registered office at 612 Standard Bank Building, Vancouver, was incorporated in May, 1933, as a private company and later as a public company with an authorized capitalization of 2,000,000 shares of no par value; 400,000 vendors' shares have been issued at 10 cents and 520,000 shares sold at 10 cents. The holdings consist of ten claims located on the South arm of Kootenay harbour, Moresby Island, and are reached by steamer from Vancouver or Prince Rupert to Queen Charlotte City; thence about 30 miles by launch to Kootenay harbour. A good trail extends for about 1 mile from the beach to the showings between elevations of 300 to about 1,000 feet.

The topography of the area is characterized by comparatively steep, rugged, and timbered mountain and ridge slopes to elevations of from 3,000 to about 4,500 feet. In some places, generally marking variations in formation, the steep slopes are bordered by a low-lying, hilly topography. The formation is composed of a belt of andesitic volcanic rocks contiguous to dark calcareous and shaly sediments. The mineralization consists of comparatively erratic quartz-replacement veins with generally tight walls, occurring in the volcanic rocks. The veins strike about east-west, dip steeply south, and are very sparsely mineralized with pyrite, chalcopyrite, and native gold in erratic distribution.

The property was staked as the *Rupert* group in 1930 by E. C. Stevens, of Skidegate, and is partly a restaking of the old *Blue Mule* group and referred to under that heading in the Annual Reports for the years 1920, 1922, and 1923. In 1922 the old *Blue Mule* owners, after carrying out some stripping and open-cutting, built a 100-foot flume, a 14½-foot water-wheel with an 8-foot drive-pulley, four ore-bins, suitable housing, and erected a Ross amalgamating-mill. Some gold was recovered with this equipment, but operations soon ceased. In the 1923 Annual Report the properties are referred to under the heading of *Kootenay* group.

Surface cuts and stripping show the veins to be brecciated and reticulated in structure and from 6 inches to about 6 feet wide, with varying degrees of silicification and a tendency to stringer into the walls. Surface exposures show characteristic sparse mineralization with pyrite, chalcopyrite, and some gold in erratic distribution. The gold is sometimes fairly coarse and visible, but is generally too fine to be detected by the naked eye. From some sections of the vein where gold is not visible it can be panned from the finely crushed quartz. The greater part of the work is being done on what is known as "C" vein. Several veins have been traced for about 100 to 500 feet on the surface.

Exploratory operations by the present company were started in 1933 and continued to the late fall of 1934, when lack of funds necessitated cessation. The work done included surface stripping, trenching, underground drifting, and crosscutting in two adits, with detailed sampling. Operations have been carried out under the management of A. J. [unclear]. An elevation of about 445 feet "C" vein was drifted on in No. 1 adit for a distance of about 200 feet in an easterly direction. This work shows the characteristic vein-structure and mineralization with vein-widths varying from about 18 to 48 inches, and several branch stringers entering the foot-wall. Visible gold in fine distribution was encountered at intervals between the portal and the face of this working, and detailed sampling carried out by the management shows values varying from 0.02 to 1.42 oz. gold per ton, with an average assay value for the length of the working reported to be 0.214 oz. gold per ton across a width of

29 inches. Values seem to be distributed in short lengths or lenses. An analysis of the company assay-plan shows seven of these lenses or pockets in No. 1 adit. Starting from the portal, these are as follows:—

	Gold Oz. per Ton.
Length, 15 feet; width, 18.6 inches.....	0.56
Length, 15 feet; width, 20 inches.....	0.008
Length, 20 feet; width, 35 inches.....	0.435
Length, 10 feet; width, 45 inches.....	0.250
Length, 10 feet; width, 30 inches.....	0.128
Length, 5 feet; width, 38 inches.....	0.21
Length, 40 feet; width, 17.75 inches.....	0.28
Length, 30 feet; width, 21.8 inches.....	0.257
Face: Length, 5 feet; width, 22 inches.....	0.145

These lenses are spaced respectively 15, 20, 10, 10, 10, 10, 35, and 20 feet apart. A summary of these lenses shows a total of 150 feet, averaging 28.57 inches wide, assaying 0.303 oz. gold per ton.

At an elevation of about 218 feet, or 220 feet below No. 1 level, a crosscut adit (No. 3) is reported to have intersected "C" vein at a distance of about 387 feet from the portal, showing at this intersection a width of 30 inches of solid quartz and about 60 inches of small quartz veins and stringers. The vein was drifted on for 50 feet to the east and about 70 feet to the west, exposing characteristic structure with some mineralization. According to the company assay-plan, the east drift shows generally low values, and one possible lens, 10 feet long and 28 inches wide, assaying 0.217 oz. gold per ton. In the face of the east drift the vein is reported to be 22 inches wide, assaying 0.4 oz. gold per ton. According to the mine assay-plan, the west drift on this level also shows generally low values, and one possible lens, 15 feet long and 30 inches wide, assaying 0.19 oz. gold per ton, with the vein in the face, 40 inches wide, assaying 0.05 oz. gold per ton.

On account of the values in this deposit being in the form of free gold in erratic distribution, it is deemed advisable that the channel-sampling should be checked by bulk samples of, say, 1 ton each, which could be shipped to a smelter or to the ore-testing laboratory at Ottawa for value determination. These samples should be taken from raises on several of the short lens-lengths in both adits. Providing this bulk-sampling offers sufficient encouragement regarding values, several other veins which occur on the property would be worth further exploration, and the continuation of the No. 1 adit to explore the section below the higher lenses in the upper level would also be constructive. END