

861648

Wyse Lakes

Carbon Jet-Set

SEND TO

P.W. RICHARDSON  
808-525 SEYMOUR ST.  
VANCOUVER 2, BC

FROM

JUN 21 1973

CMR

Mark  
Rebagliati

SUBJECT

WYSE LAKES - AREA 2 CLAIMS

REFERENCE

DATE

19 JUNE 73

MESSAGE

Dean Paul

Enclosure is a sketch showing the claims situation at Wyse Lakes. Claim CON 9, 10, 19, 20 and the northern halves of 7, 8, 17, 18 over staked the OP claims held by Dominion Lake Mines. This makes the situation a little tight but still leaves us enough room to work in.

M. Mark

REPLY FROM

DATE

1" = 1000'  
WYSE LAKES  
AREA 2  
19 - JUNE - 73

OP CLAIMS DOMINIC LAKE MINES

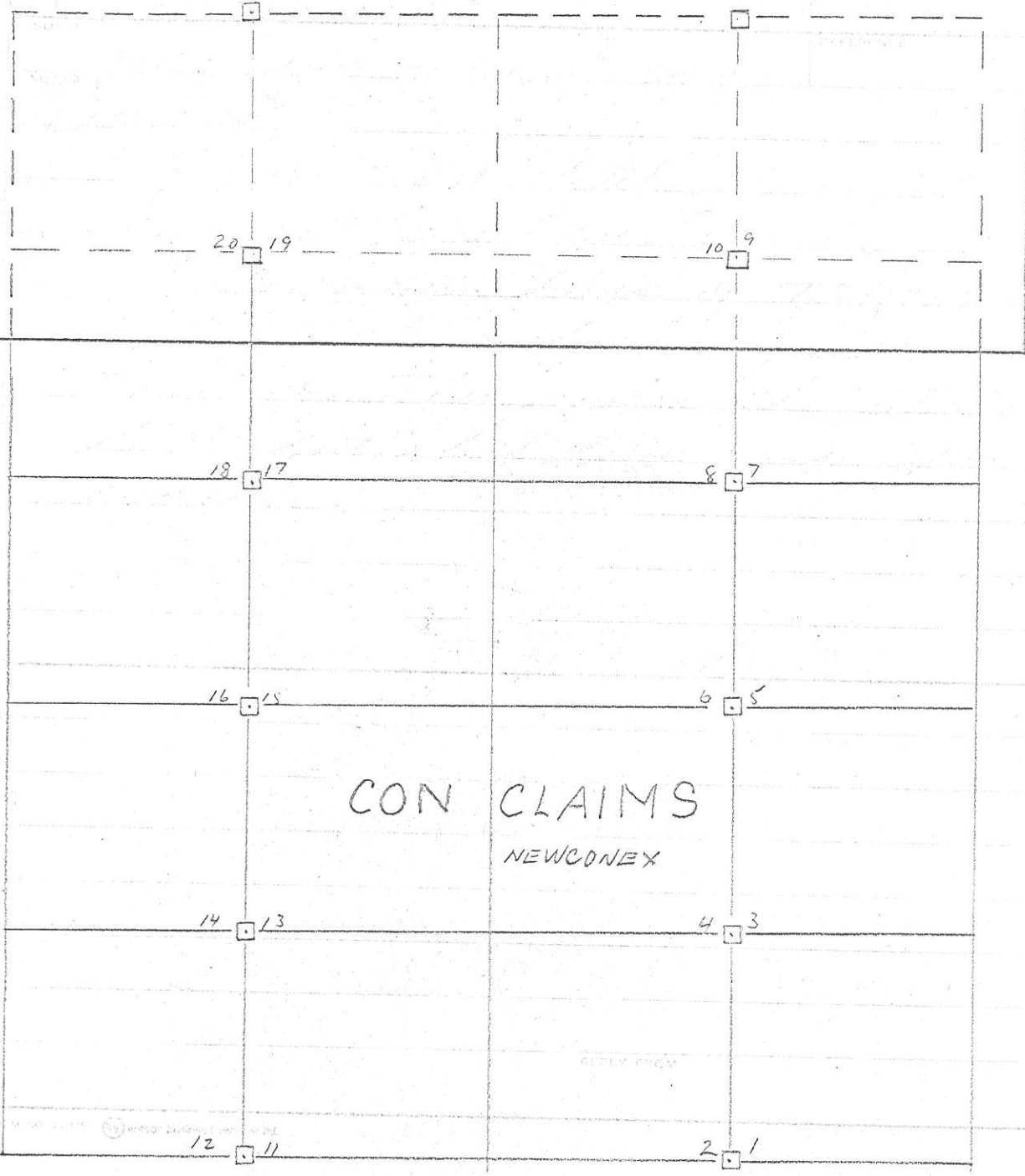

CON CLAIMS  
NEWCONEX

1" = 1000'  
WYSE LAKES  
AREA 2  
19-JUNE-73