

4481

TURAM ELECTROMAGNETIC SURVEY
KUSP GROUP, SUMMIT LAKE, B. C.

JULY, 1978

861564

R. O. CROSBY & ASSOCIATES LTD.

RICHARD O. CROSBY & ASSOCIATES LTD.

Geophysicists

REPORT ON A
TURAM ELECTROMAGNETIC SURVEY
OVER PORTIONS OF THE KUSP GROUP,
SUMMIT LAKE AREA, BRITISH COLUMBIA

for

DR. J. R. WOODCOCK

by

RICHARD O. CROSBY, P. Eng.

Claims: KUSP 1, 2, 4, 5, (incl.)

Location: South-east of Summit Lake,
about 16 kilometers from
NAKUSP, B. C.

TABLE OF CONTENTS

	Page
INTRODUCTION	1
GEOLOGY	1
DISCUSSION AND RESULTS	1
CONCLUSIONS AND RECOMMENDATIONS	2

FIGURE 1 - LOCATION MAP

FIGURE 2 - KUSP CLAIMS

FIGURE 3 - E.M. PROFILES L 1+00 E & L 2+00 E

FIGURE 4 - E.M. PROFILES L 0+60 W & L 0+20 E

FIGURE 5 - CONDUCTOR AXES

REPORT ON A
TURAM ELECTROMAGNETIC SURVEY
OVER PORTIONS OF THE KUSP GROUP,
SUMMIT LAKE AREA, B. C.

INTRODUCTION

During the period July 16 to July 19, 1978, a geophysical party under the direction of Mr. R. F. Sheldrake, completed four Turam Electromagnetic profiles over a portion of the KUSP property in the Summit Lake Area, B. C. (Figure 1).

The property is located southeast of Summit Lake, about 16 kilometers from Nakusp, B. C. A Scintrex SE-71 Turam unit operating on frequencies of 400 and 800 hertz was employed on the survey.

The survey was conducted along three lines oriented north-south. The northwest corner of the loop was located at 0+20 W and 1+60 S.

A total of about 500 meters of survey was completed.

GEOLOGY

The KUSP property is underlain by Triassic volcanics of the Slocan group. Mineralization in the area is reported to be copper, lead, zinc and gold.

DISCUSSION AND RESULTS

The results of the survey are shown on Figures 3 and 4 in profile form on a scale of 1:1000. Field strength ratios and phase differences are plotted on vertical scales of 1 cm = 10% and 1 cm = 10° respectively.

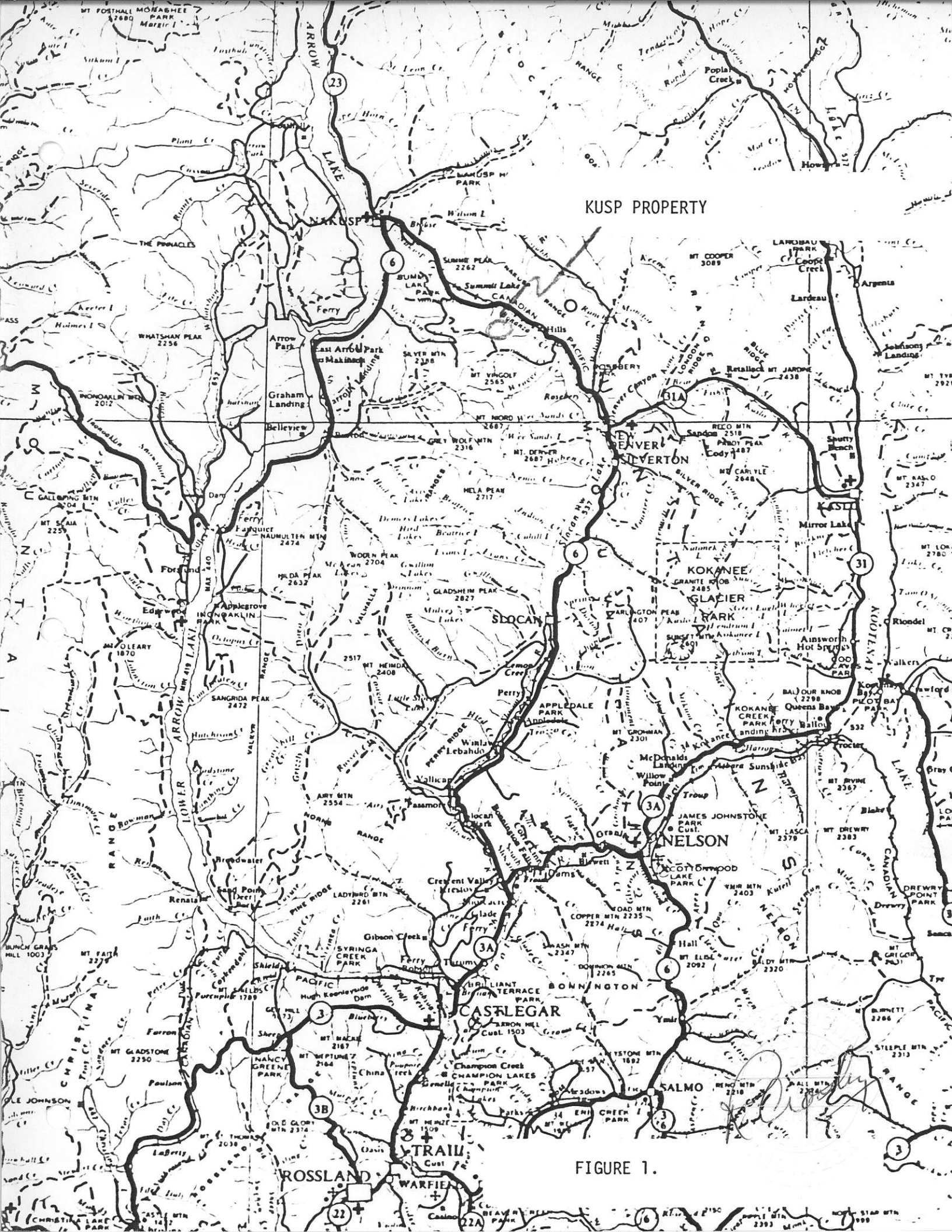

KUSP PROPERTY

FIGURE 1.

Figure 2

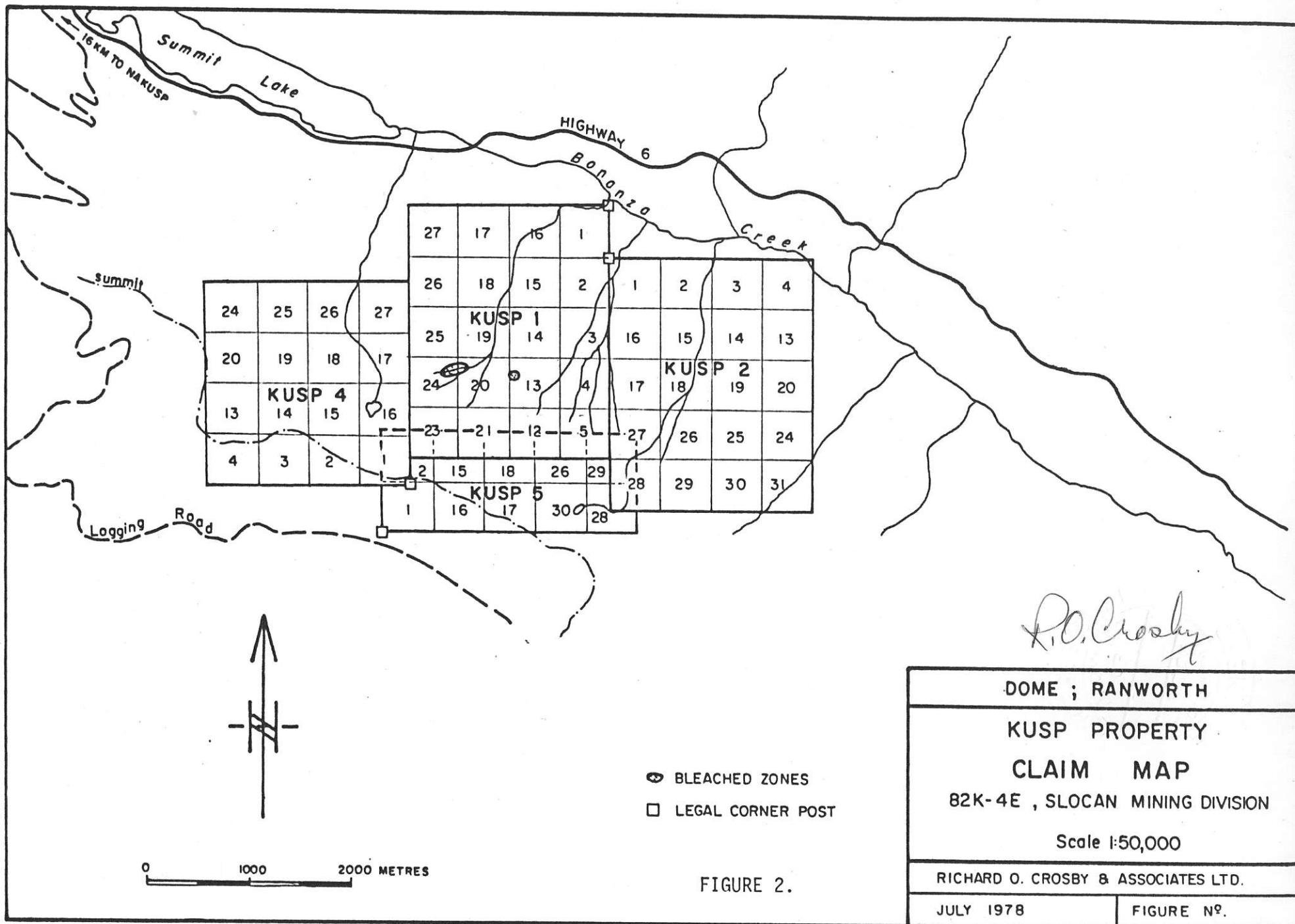

R.O. Crosby

DOME ; RANWORTH	
KUSP PROPERTY	
CLAIM MAP	
82K-4E , SLOCAN MINING DIVISION	
Scale 1:50,000	
RICHARD O. CROSBY & ASSOCIATES LTD.	
JULY 1978	FIGURE N ^o .

FIGURE 2.

120 100 80 60 40 20 0 20 40 60

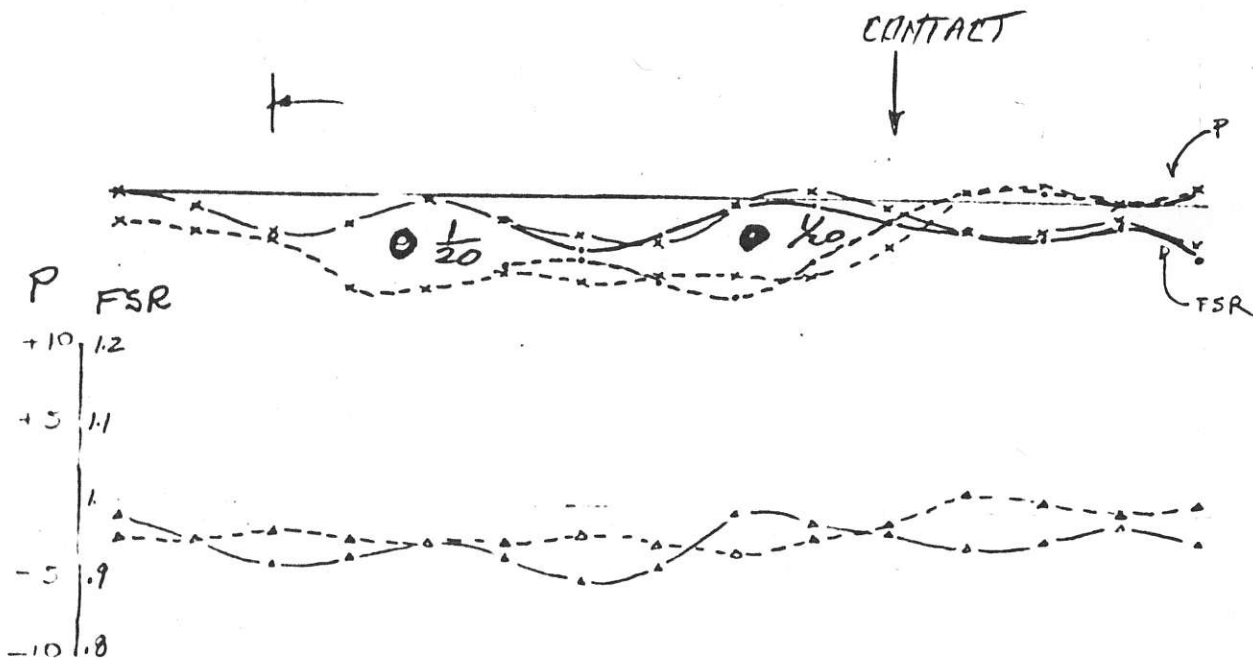

L 1+00 E
800 HERTZ

L 1+00 E 400 HERTZ.

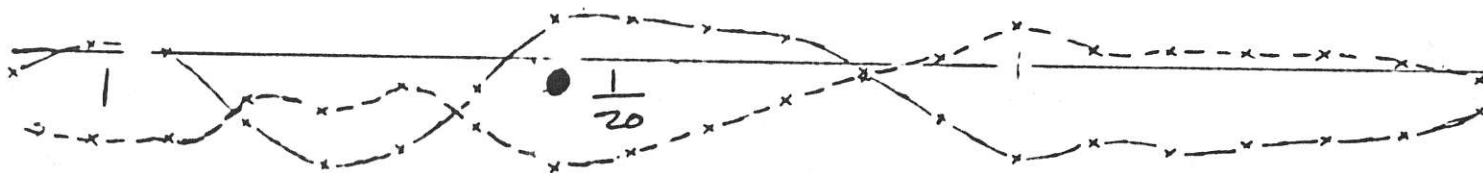

L 2+00 E
800 HERTZ.

FIGURE 3.

R.O. Crosby

120S 100 80 60 40 20 0 20N 40 60 80

F.S.R.	P
1.20	+10
1.10	+5
1.00	0
0.90	-5
0.80	-10

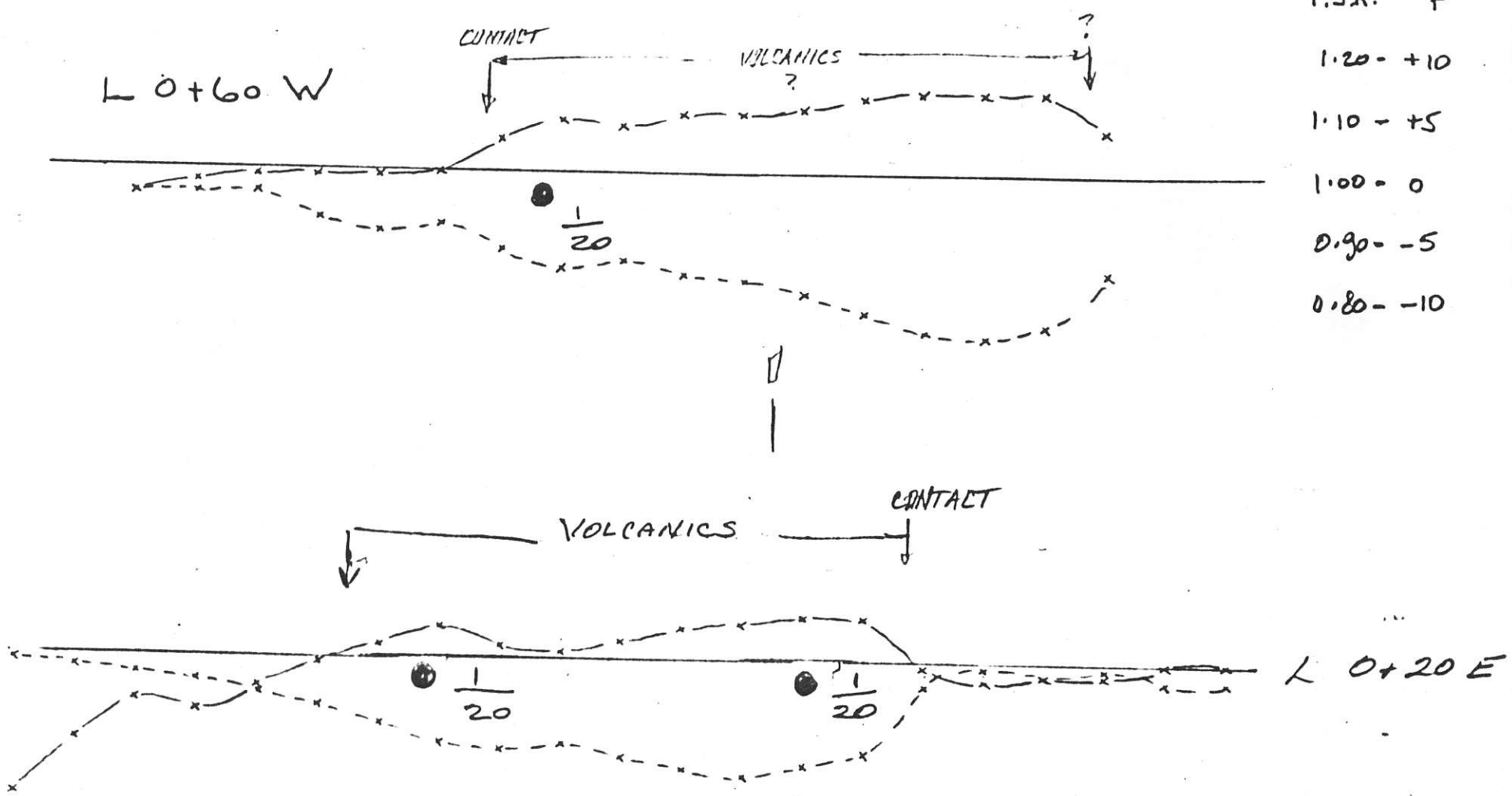

● $\frac{1}{20}$ GT (MHOS)
 ● $\frac{1}{20}$ depth (m)

R.O. Craby

FIGURE 4.

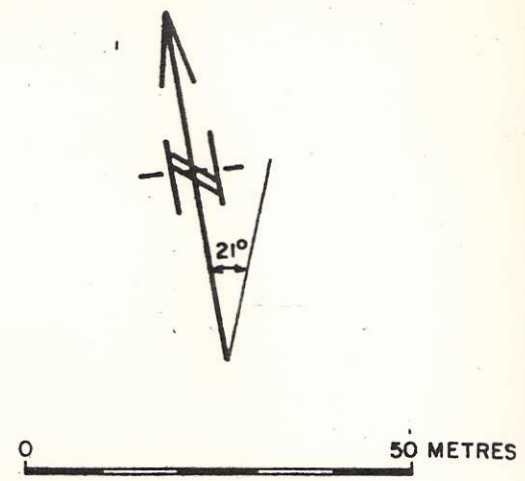
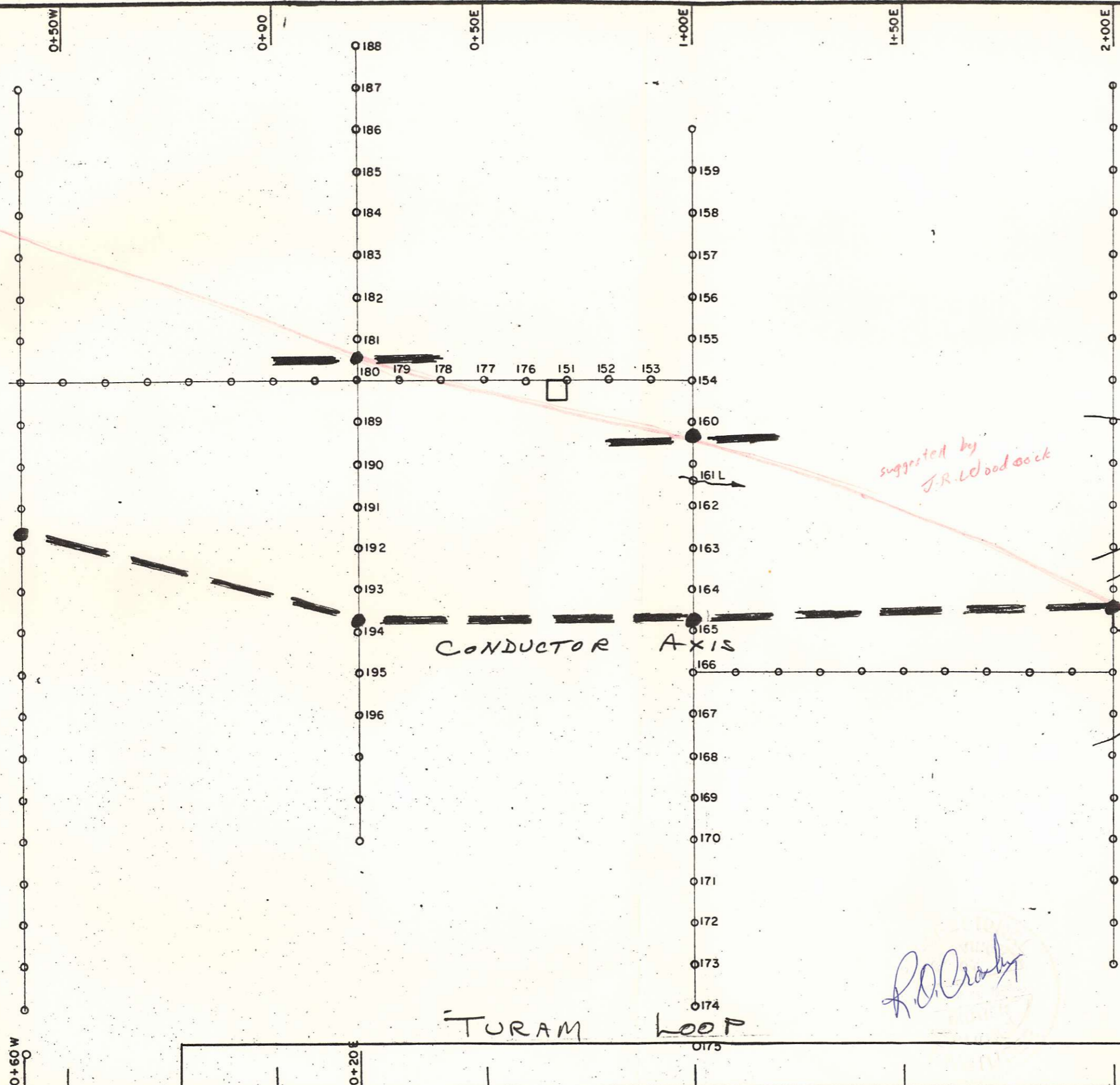

O180 SAMPLE NUMBER - SOIL
 O161 L " " - SILT

CONDUCTOR AXIS

*suggested by
 J.R. Woodcock*

0+70S

TURAM LOOP

R.D. Crosby

DOME ; RANWORTH	
KUSP PROPERTY ZONE 1	
CONDUCTOR AXES SCALE 1 : 1000	
J. R. WOODCOCK CONSULTANTS LTD.	
JULY 1978	FIGURE NO. 5

Line 1+00 E was completed at both 400 and 800 Hz. The higher frequency yield better results, so lines 2+00 E and 0+20 E were surveyed at 800 Hz.

The electromagnetic data clearly indicate 2 conductors located approximately 20 meters below the surface of the ground.

The conductors are in the vicinity of geologic contacts and therefore may represent either these contacts or massive sulphide mineralization.

CONCLUSIONS AND RECOMMENDATIONS

The Turam survey has revealed two conductive zones which warrant testing by diamond drilling.

Conductor locations are shown on Figure 5. Drill collar locations will be dependent upon the topography.

Respectfully submitted,

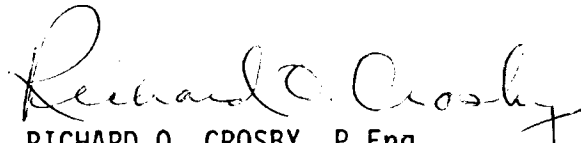

RICHARD O. CROSBY, P.Eng.

CERTIFICATION

I, Richard O. Crosby, of the City of Vancouver, Province of British Columbia, hereby certify as follows:

1. I am a Consulting Geophysicist with offices at 422 - 510 West Hastings Street, Vancouver, B. C.
2. I am a registered Professional Engineer of British Columbia. I graduated from Washington State University in 1951.
3. I have practiced my profession for 23 years.
4. I have no interest, direct or indirect, in the mineral claims discussed in this report.
5. I did not examine the permit area, but I am not aware of any claim conflict and believe that the data presented herein is reliable.
6. I consent to the use of this report in, or in connection with the prospectus, or in a statement of material facts relating to the raising of funds for this project.

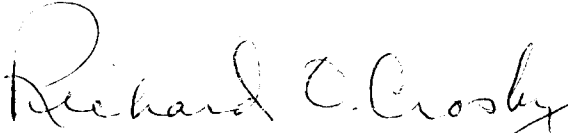
DATED at VANCOUVER, BRITISH COLUMBIA, this 31st day of August, 1978.

RICHARD O. CROSBY, B.Sc., P.Eng.

ASSESSMENT DETAILS

CLAIMS: KUSP 1, 2, 4, 5.

LOCATION: SUMMIT LAKE AREA, B. C.
SLOCAN MINING DIVISION.

CLIENT: DR. J. R. WOODCOCK
VANCOUVER, B. C.

TYPE OF SURVEY: TURAM E.M.

OPERATING MAN DAYS: 4 DATE STARTED: JULY 16, 1978

CONSULTING MAN DAYS: 1 DATE FINISHED: JULY 19, 1978

TOTAL MAN DAYS: 5

CONSULTANT: RICHARD O. CROSBY
422 - 510 West Hastings Street
Vancouver, B. C.

ELECTRONIC OPERATOR:

RONALD F. SHELDRAKE
Maple Ridge, B. C.

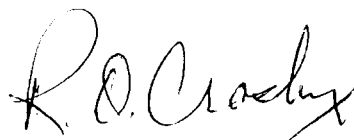

R. O. CROSBY, P.Eng.