

CORDILLERAN ENGINEERING LTD.

1980 GUINNESS TOWER, 1055 WEST HASTINGS STREET, VANCOUVER, B.C. V6E 2E9 TEL: (604) 681-8381

DELIVERED BY COURIER

July 4, 1988

861495

Placer Dome Inc.
Suite 1600 - 1055 Dunsmuir Street
Bentall 4
Vancouver, B.C.
V7X 1P1

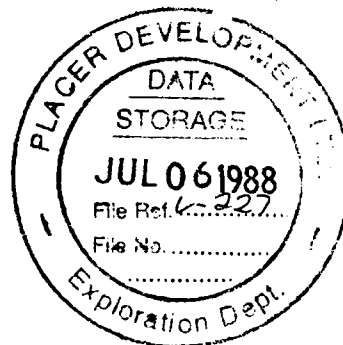

Attention: Mr. E. Kimura
Exploration Manager
Western Canada

Copy to: → Mr. L. C. Reinertson to Bob H. For Filing
Senior Vice-President
Exploration

Dear Mr. Kimura:

**OKA & ELK Properties
Progress Report
Period: June 1-30, 1988**

On the Oka property during the month of June, 16 (88-19 to 34) reverse circulation drill holes were completed and two were deepened (88-15 & 16), fulfilling the proposed drilling in the Iron Horse and Bolivar West areas. Results up to hole 20 have been received with hole 15 returning 4572 ppb Au over 3.0m and hole 20 returning 6802 ppb Au over 4.6m. A complete list of values greater than 300 ppb is attached. Also enclosed is a compilation map showing areas of reverse circulation drilling as well as a current drill plan of completed holes in the Iron Horse area. The drill was double shifted as of May 30 and 2641.86m were drilled in 16 holes as of June 30 for an average drill rate of 96m per day. Two days of drilling were lost to down time fishing for dropped rods. Estimated date of completion of drilling is July 10.

Linecutting on the Elk property is currently underway with an estimated completion date of July 7. Bids are being accepted for the construction of the road to the Siwash North trench area and work is estimated to begin on July 10. Mobilization to the Elk property and camp construction will begin on July 2 and soil sampling is planned to start on July 5.

Yours very truly,

CORDILLERAN ENGINEERING LTD.

W. Jakubowski
Project Geologist

WJ/lis

OKA PROPERTY 1988
REVERSE CIRCULATION DRILL SUMMARY RECORD To June 25, 1988

HOLE NO.	NORTHING	EASTING	ELEV'M #	SECTION	INCLINATION degrees	AZIMUTH degrees	O'BURDEN #	CLANE	REC'Y #	DATE START	DATE FINISH	REMARKS	DEPTH #	TOTAL #
								IRON						
OK88-1	520860.4	291734.1	1341.0		-90	0	2.43	MORSE		APR 30	MAY 2		151.64	151.64
-2	520908.6	291640.6	1354.7		-90	0	1.21	" "		MAY 2	MAY 5		141.12	292.76
-3	520959.6	291541.0	1358.2		-90	0	.76	" "		MAY 5	MAY 7		152.10	444.86
-4	521060.6	291543.7	1346.0		-90	0	.45	" "		MAY 8	MAY 9		121.31	566.17
-5	521094.5	291512.7	1345.4		-55	351	.60	" "		MAY 10	MAY 13		102.11	668.28
-6	521060.5	291735.5	1304.0		-90	0	1.21	" "		MAY 13	MAY 14		42.67	710.95
-7	521011.8	291840.0	1296.6		-90	0	3.04	" "		MAY 14	MAY 15		92.96	803.91
-8	521059.1	291943.7	1277.2		-90	0	.60	" "		MAY 15	MAY 16		78.64	882.95
-9	521037.7	291797.6	1295.8		-55	0	1.52	" "		MAY 16	MAY 17		120.40	1002.95
-10	520959.4	291746.9	1327.6		-90	0	.76	" "		MAY 18	MAY 19		74.68	1077.63
-11	520987.9	291635.0	1349.0		-90	0	.60	" "		MAY 19	MAY 20		118.87	1196.50
-12	521017.3	291353.4	1381.4		-90	0	.60	" "		MAY 20	MAY 22		161.94	1348.44
-13	521028.0	291178.7	1392.3		-90	0	.60	" "		MAY 22	MAY 24		151.79	1500.23
-14	520781.6	291817.1	1320.0		-90	0	1.52	" "		MAY 24	MAY 25		94.49	1594.72
-15	520857.8	291550.2	1314.9		-90	0	.76	" "		MAY 26	MAY 28		151.94	1746.66
-15	Extension of									JUN 8	JUN 9		61.11	1807.77
-16	520804.7	291638.6	1298.5		-90	0	.76	" "		MAY 28	MAY 30		151.94	1959.71
-16	Extension of									JUN 7	JUN 7		61.11	2020.82
-17	520767.9	291743.4	1301.4		-90	0	1.52	" "		MAY 30	MAY 31		137.16	2157.98
-18	520698.3	291794.1	1281.7		-90	0	.60	" "		MAY 31	JUN 1		120.61	2288.59
-19	520749.9	291646.5	1276.1		-90	0	.60	" "		JUN 1	JUN 4		194.62	2483.21
-20	520764.9	291546.9	1271.0		-90	0	.60	" "		JUN 5	JUN 6		213.96	2696.27
-21	521098.7	291509.7	1344.0		-90	0	.91	" "		JUN 9	JUN 10		131.06	2827.33
-22	521064.2	291630.7	1329.1		-90	0	.60	" "		JUN 11	JUN 11		45.72	2873.05
-23	520658.4	291641.2	1224.7		-90	0	.60	" "		JUN 11	JUN 13		200.71	3073.76
-24	520650.9	291542.2	1205.2		-90	0	.60	" "		JUN 16	JUN 17		194.61	3268.37
-25					-90	0	1.21	OKA 8		JUN 18	JUN 20		194.61	3462.98
-26					-90	0	.60	OKA 9		JUN 20	JUN 21		121.92	3584.90
-27					-90	0	.60	OKA 9		JUN 21	JUN 22		121.92	3706.82
-28					-90	0	.60	OKA 9		JUN 22	JUN 23		121.92	3828.74
-29					-90	0	.60	OKA 9		JUN 23	JUN 24		124.97	3953.71
-30					-90	0		OKA 9		JUN 24	JUN 25		121.92	4075.63

NOTE: DRILL DOUBLE SHIFTED (20 HOURS/DAY) STARTING MAY 30.

OKA PROJECT
SUMMARY OF SIGNIFICANT RESULTS
RC Holes 88-1 to 88-20
June 25, 1988

<u>HOLE #</u>	<u>FROM (ft)</u>	<u>TO (ft)</u>	<u>INTERVAL (ft)</u>	<u>Au ppb</u>
1	15	20	5	671
2	105	110	5	590
4	240	245	5	305
	325	330	5	1440
	330	335	5	335
	380	385	5	335
5	205	210	5	550
	210	215	5	320
	225	230	5	1560
	230	235	5	5230
	235	240	5	750
	240	245	5	7450
	250	255	5	520
	275	280	5	320
	290	295	5	1390
	295	300	5	345
	305	310	5	950
6	50	55	5	505
14	80	85	5	845
15	505	510	5	5925
	510	515	5	3220
	515	520	5	560
	535	540	5	330
	550	555	5	390
16	20	25	5	625
	465	470	5	1290
	620	625	5	1080
	630	635	5	670
	655	660	5	320
	695	700	5	3430
19	130	135	5	1020
	395	400	5	420
20	10	15	5	390
	130	135	5	570
	135	140	5	810
	160	165	5	610
	290	295	5	315
	330	335	5	615
	375	380	5	355
	380	385	5	310
	385	390	5	1570
	390	395	5	2580
	395	400	5	12045
	400	405	5	5780
	415	420	5	305

OKA PROJECT

SUMMARY OF SIGNIFICANT RESULTS
RC Holes 88-21 to 88-34
July 22, 1988

<u>HOLE #</u>	<u>FROM (ft)</u>	<u>TO (ft)</u>	<u>INTERVAL (ft)</u>	<u>Au ppb</u>
21	335	340	5	850
	340	345	5	360
	355	360	5	360
	360	365	5	305
	390	395	5	3420
	395	400	5	660
	405	410	5	530
25	635	640	5	405
26	340	345	5	14330
	345	350	5	535
	350	355	5	521
27	40	45	5	590
	55	60	5	675
	95	100	5	380
	155	160	5	693
	160	165	5	412
	285	290	5	540
28	15	20	5	525
	55	60	5	550
	170	175	5	480
29	185	190	5	430
	230	235	5	410
30	90	95	5	550
31	5	10	5	3380
	10	15	5	430
32	5	10	5	480
	25	30	5	355
	30	35	5	325
	150	155	5	1520
	155	160	5	650
	440	445	5	7070
445	450	5	360	
34	15	20	5	305
	30	35	5	1040
	145	150	5	355

OKA Drill Section 650E

Looking West

1:1000

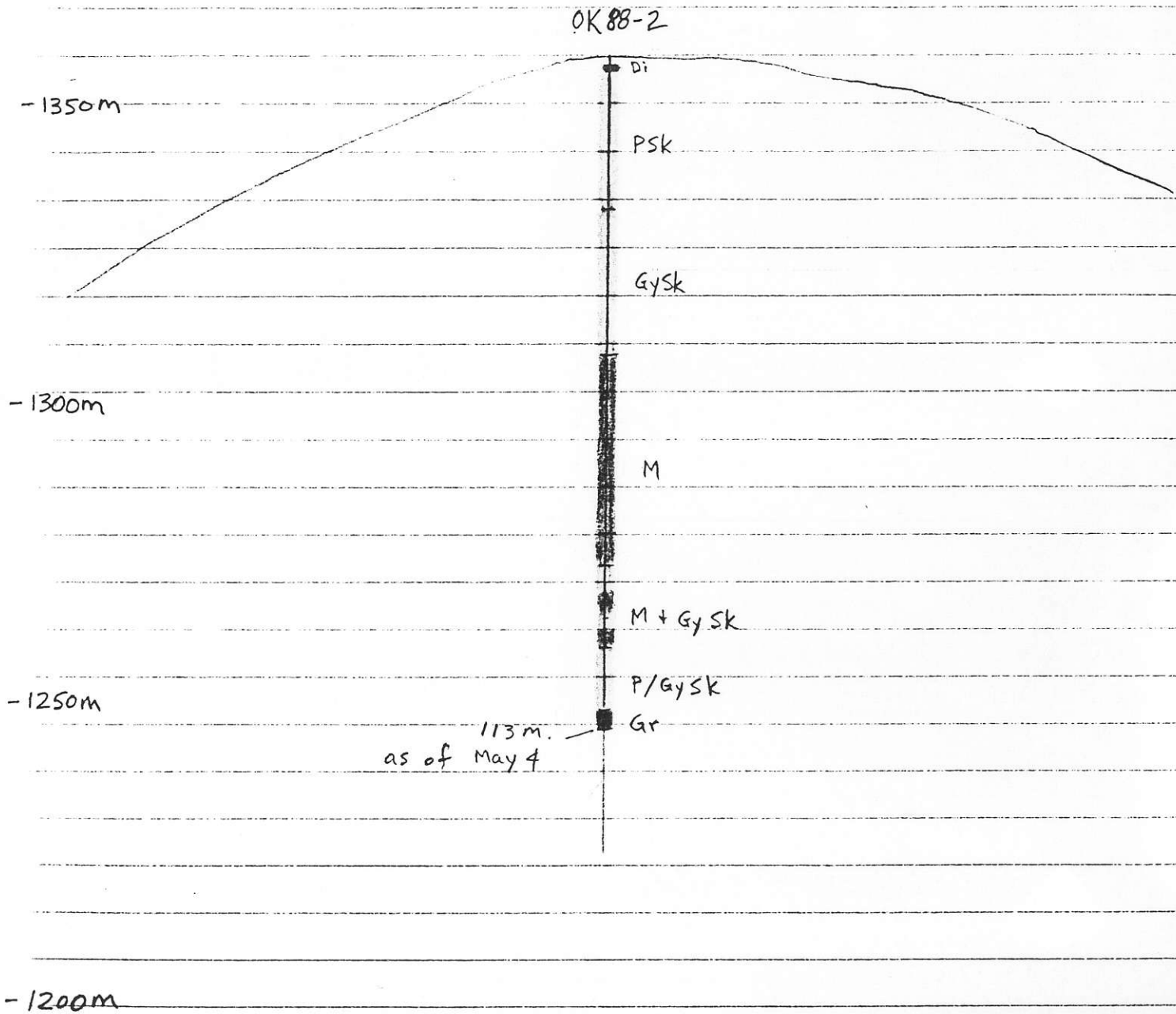

CORDILLERAN ENGINEERING LTD.

1980 GUINNESS TOWER, 1055 WEST HASTINGS STREET, VANCOUVER, B.C. V6E 2E9 TEL: (604) 681-8381

DELIVERED BY COURIER

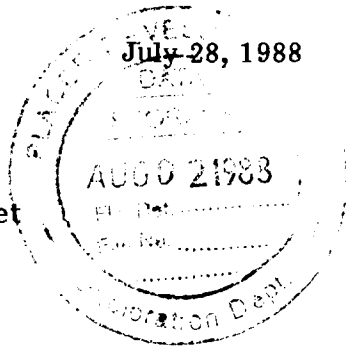

Placer Dome Inc.
Suite 1600 - 1055 Dunsmuir Street
Bentall 4
Vancouver, B.C.
V7X 1P1

Attention: Mr. E. Kimura
Exploration Manager
Western Canada

Copy to: → Mr. L. C. Reinertson ✓
Senior Vice-President
Exploration

Dear Mr. Kimura:

OKA & ELK Properties
Progress Report
Period: July 1-31, 1988

On July 19 the Oka drill program was completed for a total of 5988.48m in 43 holes. During the report period, six holes were drilled in the Bolivar East area. There were four holes drilled in the Bolivar Road area, a follow-up hole was drilled in the Iron Horse area 50m west of OK 88-5 and two holes were completed in the Cap area. Sample results have been received up to hole 34 and the significant results are appended.

You will also find attached a current compilation map and individual drill plans of the five areas which received drill investigation. The drill chip processing facility was dismantled on July 21 and the crew has mobilized to the Elk project.

Linecutting on the Elk property was completed on July 11 and approximately half of the 50m station soil sampling has been completed. Road work to the Siwash North trench area is 2/3 complete and the excavator will be mobilized to the property on July 23 with work beginning on July 25 as scheduled.

Yours very truly,

CORDILLERAN ENGINEERING LTD.

W. Jakubowski
Project Geologist





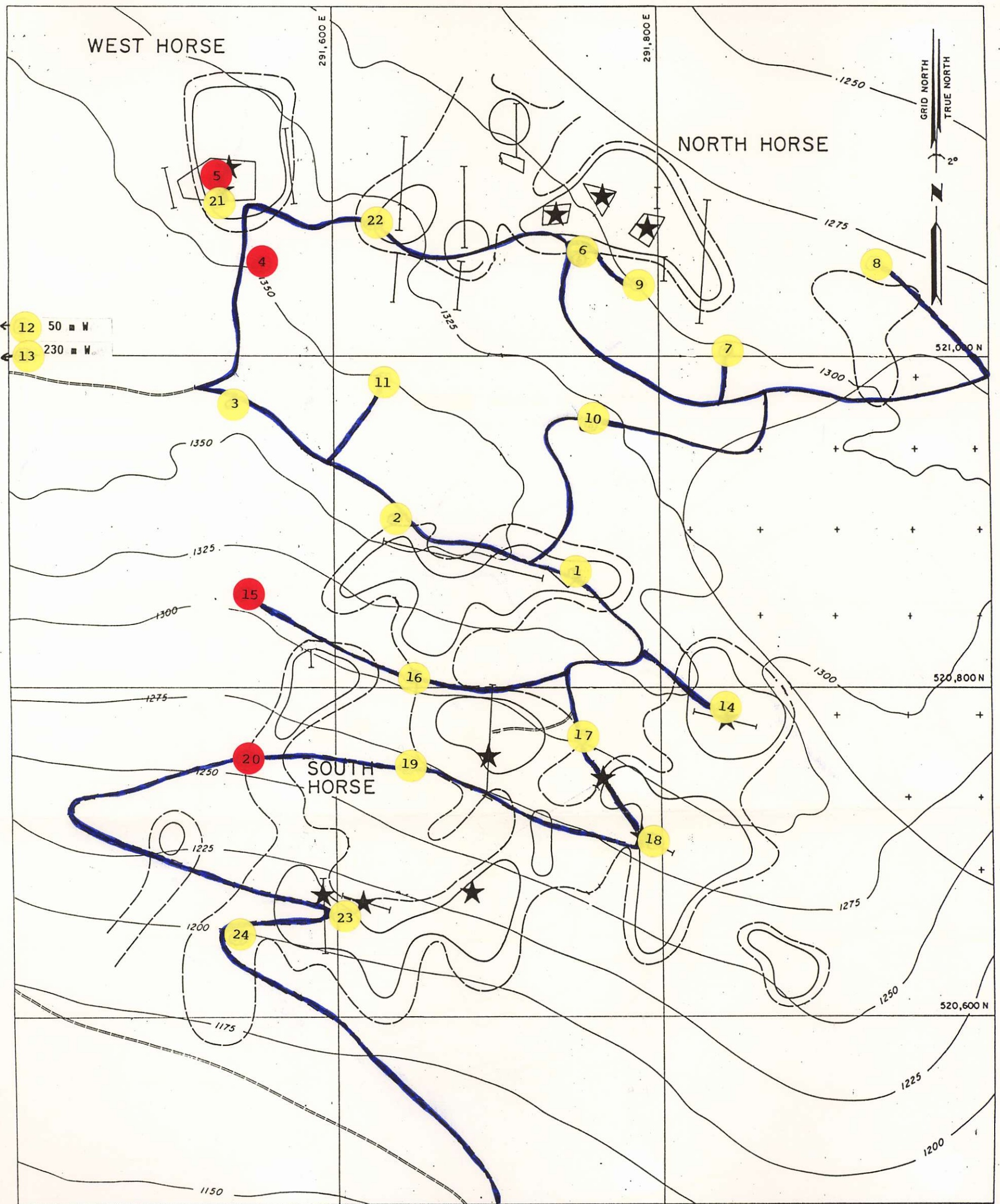







WJ/lis

cc JWS, Az, WJ, JDR



NOTE: RESULTS FROM HOLES 21 TO 24 NOT YET RECEIVED (June 25, 1988)

LEGEND

-  1987 Trench
-  1987 Strip Area
-  ≥ 50 ppb Au in Soil
-  ≥ 20 ppb Au in Soil
-  Gold Showing: ≥ 0.05 oz/ton Au in grab or chip sample
-  Marble and skarn; diorite dikes and sills
-  (Quartz) diorite
-  10 1988 reverse circulation drill hole
-  5 1988 reverse circulation drill hole with values >1000 ppb Au
-  Access road
-  -1200- Topographic contour in metres
-  UTM grid co-ordinates

FAIRFIELD MINERALS LTD.

OKA PROPERTY
IRON HORSE AREA

PROPOSED 1988 DRILL PLAN

OSOYOOS MINING DIVISION, BRITISH COLUMBIA
N.T.S. 82E/13W

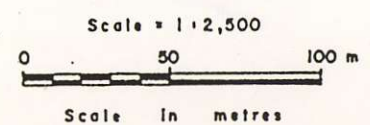

CORDILLERAN ENGINEERING LTD.
1980-1055 W. HASTINGS STREET
VANCOUVER, B.C. V6E 2E9

JUNE, 1988

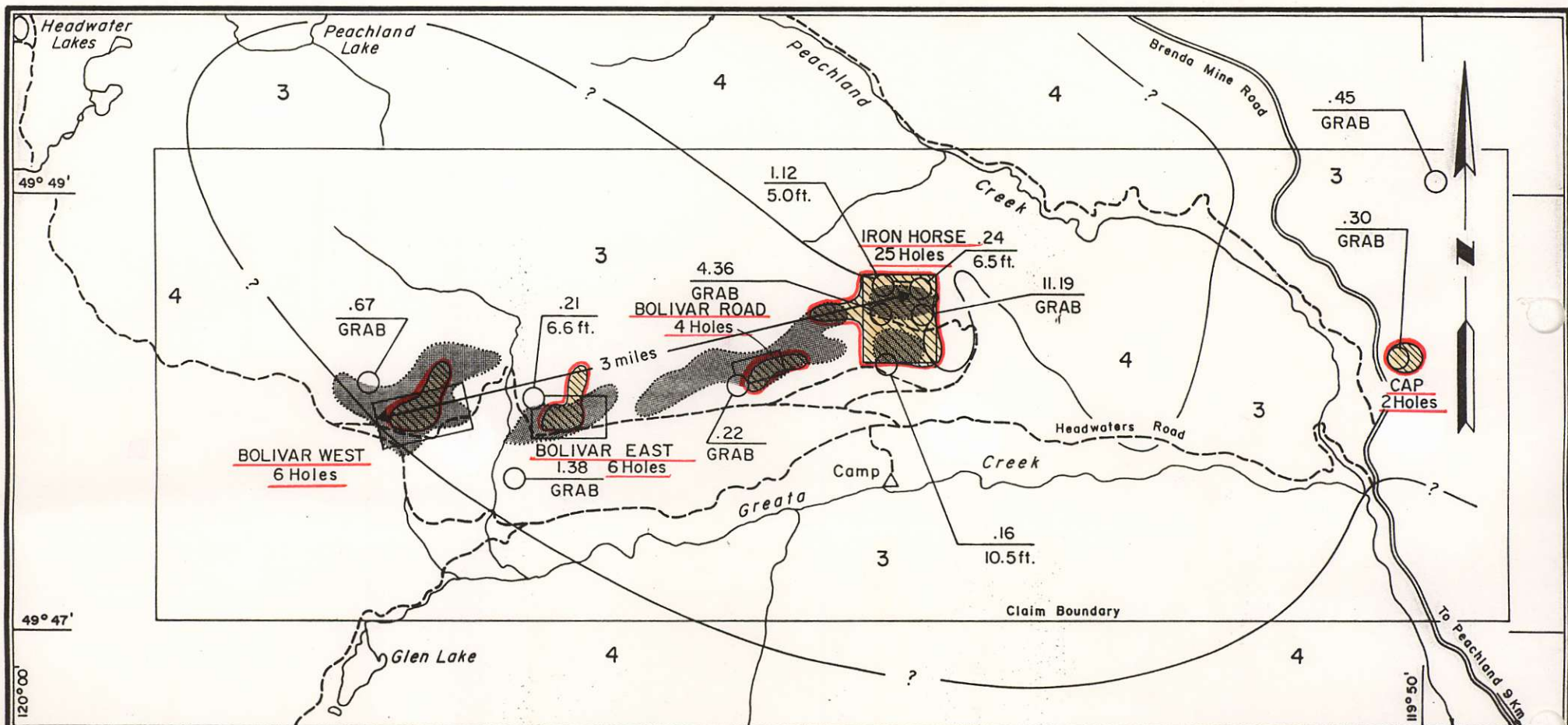

LEGEND

- 4 GRANODIORITE
- 3 LIMESTONE AND SKARN; ARGILLITE SANDSTONE AND MINOR GREENSTONE
- Au SOIL GEOCHEMICAL ANOMALY
- 1987 TRENCHING AREA
- GOLD SHOWING: $\frac{\text{oz / Ton Au}}{\text{Sample Length}}$
- AREA OF REVERSE CIRCULATION DRILLING



FAIRFIELD MINERALS LTD. COMPILATION MAP OKA GOLD PROPERTY SOUTH OKANAGAN AREA

N.T.S. 82E/13W OSOYOOS MINING DIVISION, B.C.

Scale 1:50,000



Scale in Miles

CORDILLERAN ENGINEERING LTD.
1980-1055 W. HASTINGS STREET
VANCOUVER, B.C. V6E 2E9

JULY 31, 1988

E.T.K.

CORDILLERAN ENGINEERING LTD.

1980 GUINNESS TOWER, 1055 WEST HASTINGS STREET, VANCOUVER, B.C. V6E 2E9 TEL: (604) 681-8381

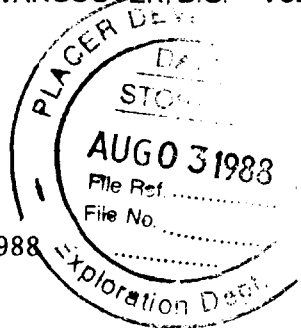

July 29, 1988

Placer Dome Inc.
#1600 - 1055 Dunsmuir
P. O. Box 49330
Bentall Postal Station
Vancouver, B.C.
V7X 1P1

Attention: Mr. L. Reinertson
Sr. Vice President-Exploration

Dear Sirs:

Oka Property

Enclosed is a copy of the claim map covering the OKA property area. The OKA 12, 13, 14 and 15 claims were added in June, 1988 to cover a similar geological setting to the Iron Horse showing area. Garnet skarn with local pyrite, pyrrhotite, sphalerite zones is exposed on the OKA 13 claim.

The BRAE 2 and BIO claims are owned by N. Lenard from Westbank and the DAL 1 to 11 claims are registered in contract stakers' names, still to be transferred. Most of these claims were staked in July 1988. We have soil sampled the new OKA claims and have some weak gold values to be followed-up. Some of the gold anomalies extend onto the adjoining BRAE 2 claim.

Yours very truly,

CORDILLERAN ENGINEERING LTD.

J. D. Rowe, B.Sc.

JDR/lis

cc Ed Kimura

UKA AREA CLAIMS
NTS. 82E/13W
1:50,000
JULY 22, 1988

