

# M 1041/4W

(FOR PLACER SEE P1041/4W)

130'00"

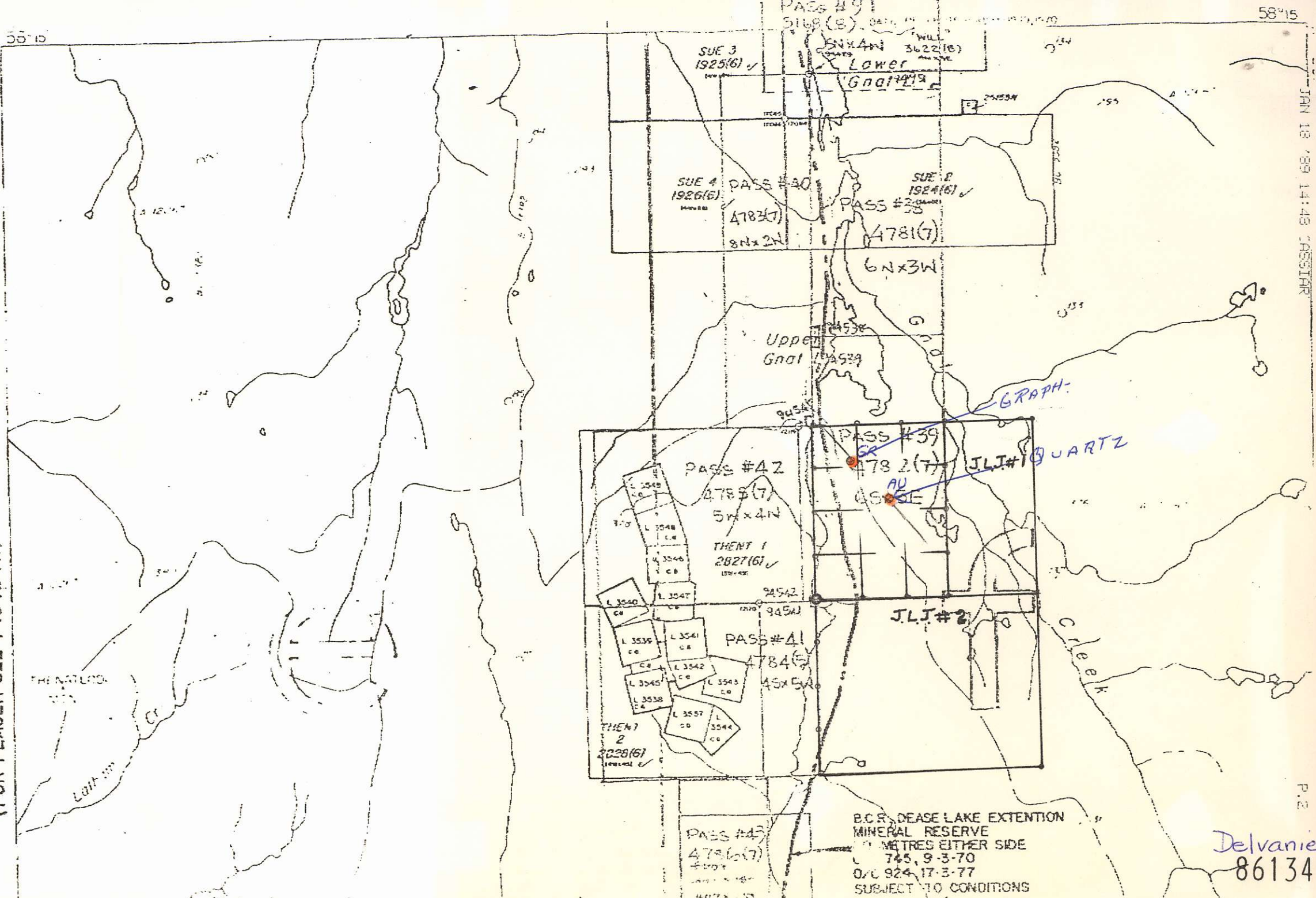

B.C.R. DEASE LAKE EXTENTION  
 MINERAL RESERVE  
 10 METRES EITHER SIDE  
 L 745, 9-3-70  
 O/C 924, 17-3-77  
 SUBJECT TO CONDITIONS

Delvanie  
 861345

58°15'

JAN 18 1989 14:48 CASSIAR

P. 13

DELVANIA  
M.M.R. 1935

GEOLOGY: COMPOSED OF BOSS OF GABBRO, VARYING IN TEXTURE FROM FINE TO COARSELY HOLLOCRYSTALLINE AND FROM FINE TO COARSELY PORPHRITIC. THIS INTRUDES SLATES AND QUARTZITES. SEVERAL THIN REMNANTS OF PYRITE QUARTZITE ROOF ROCKS. IN PLACES HYBRIDIZED BY PARTIAL DIGESTION IN THE INTRUSIVE ARE PRESERVED ALONG THE EASTERLY SLOPE OF DELVENIE MOUNTAIN, THESE ARE CHARACTERIZED BY RUSTY OUTCROPS. SLATE ROOF ROCKS ARE MORE COMMON AT LOWER ELEVATION ON THE EASTERLY SLOPES.

THE MINERAL DEPOSIT CONSISTS OF A REPLACEMENT ZONE WITH A INDICATED WIDTH OF 20-34 FT., TRACED FOR 1200' BY NUMEROUS OPEN-CUTS. ALL EXPOSURES ARE EXTENSIVELY OXIDIZED, BUT IN THE DEEPER CUTS THERE IS CONSIDERABLE PYRITES. PYRROTITE, CALCOPYRITE, ARSENOPYRITE IN A GANGE OF ALTERED QUARTZ AND SOME BARITE

ASSAYS

AU.-TR.	AG.-TR.	CU.-1.7 PC.	A.-2.1 PC.
AU.-TR.	AG.-TR.	CU.-0.3 PC.	A.-2.0 PC.
AU.-.02	AG. TR.	CU.-1.7 PC	A.-2.3 PC.