

NORTH GULLY, ALT. ZONE
KIN PROPERTY

AUGUST 26 / 89

860940

ROB. P.
MARC D.

SCALE
← 25 m →

E

STEELY N DIPPING STRUCTURES $\approx 80^\circ$ N
POSSIBLY INTENSE VERTICAL FAULTING

W

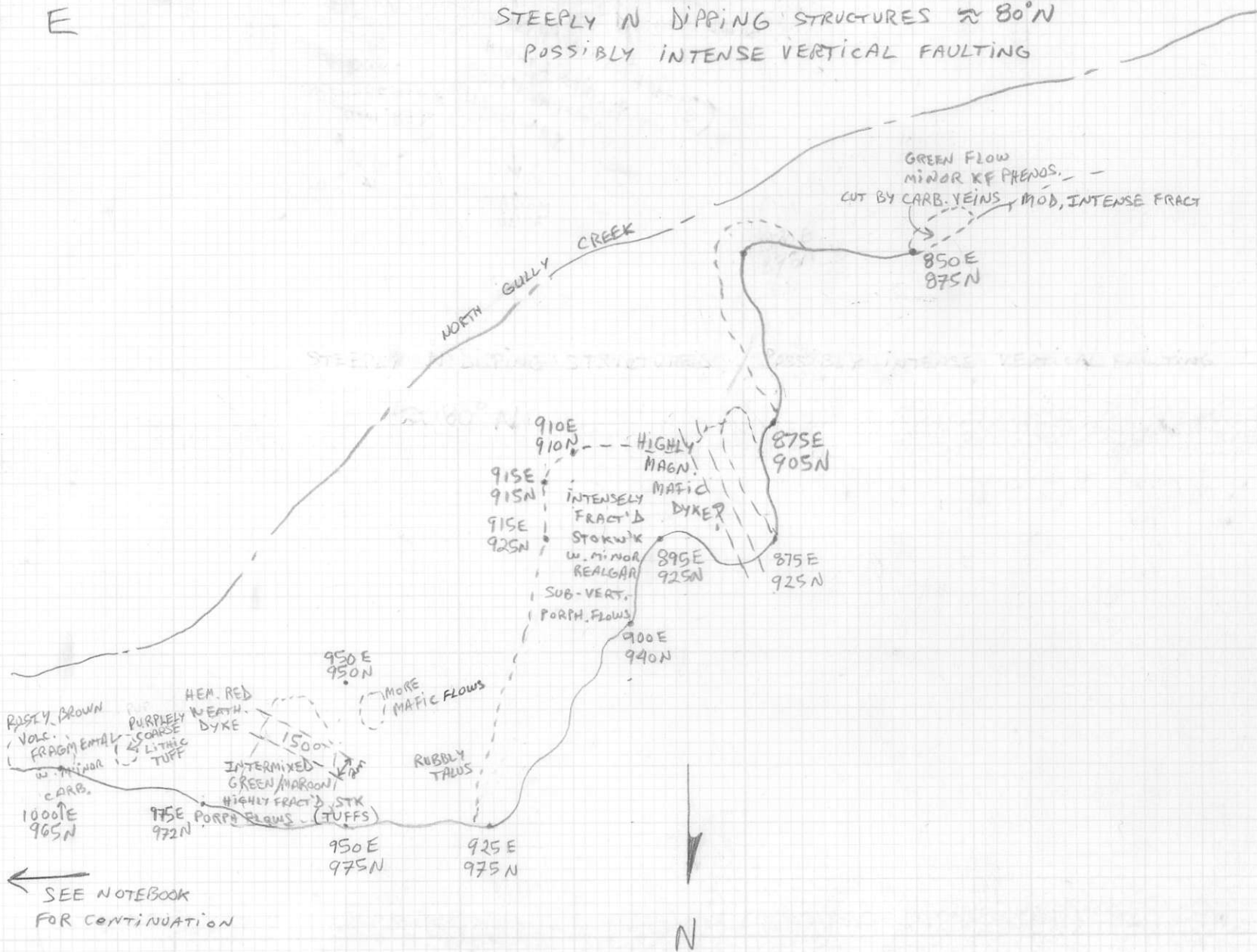

KIN '89 ALTERATION ZONE (CLIFF)

△: CONTROL PTS.

W

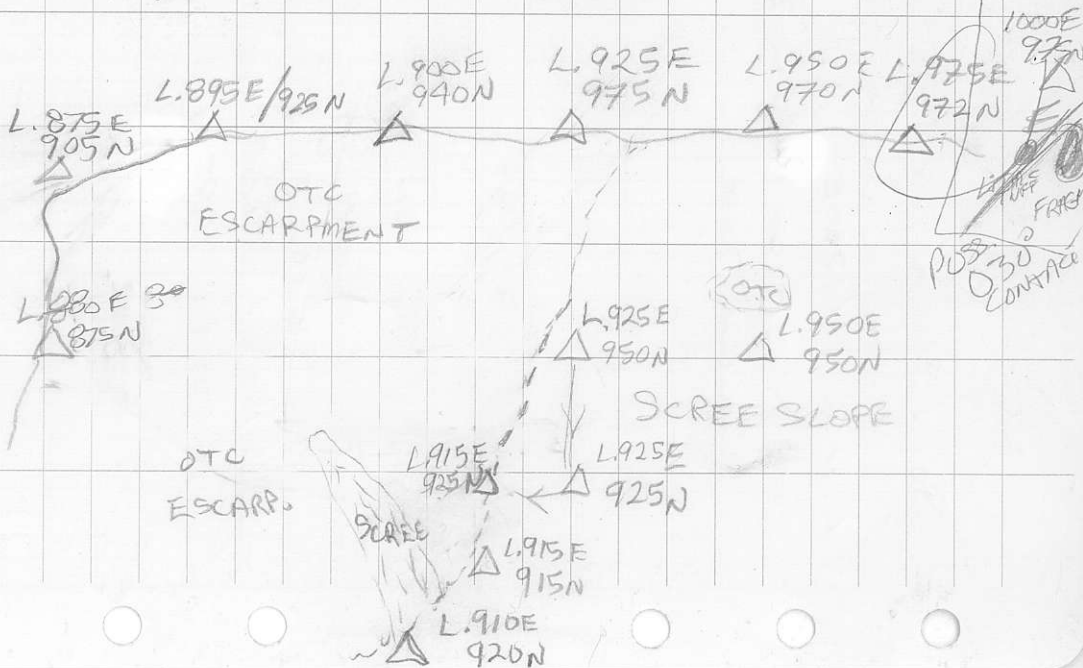

AUG 24 / 89

KIN '89

SOIL SAMPLING / PROSPECT

L. 1150 N / 1200 E

⇒ ~~SBOC~~ on Ridge Crest
Vesicular Lava

AUG. 25 / 89

GRID PREP ON KIN

- Begin L. 1650 N going East
from B.L. 1000 E 250m
- L. 1600 N intersect B.L. 1000 E
AT 1000 E, 1595 N

NORTH GULLY CR.

SCALE

100 m

W

E

1000E
965N



FIELD(S)

AUG. 25 / 89

KIN '89

North Gully Mapping / Prospect

- Sample # 43203

Reagan (~25%) in a fragmental
clay alt'd volc. L. 1040 E
960 N

BIG BEND GEOLOGY

→ Possible fault trending 060°
w. a ^{purplish} greenish lithic tuff ~~exposed~~
on the N. side

South side on the bend is a
red-maroon weath'd volcanoclastic

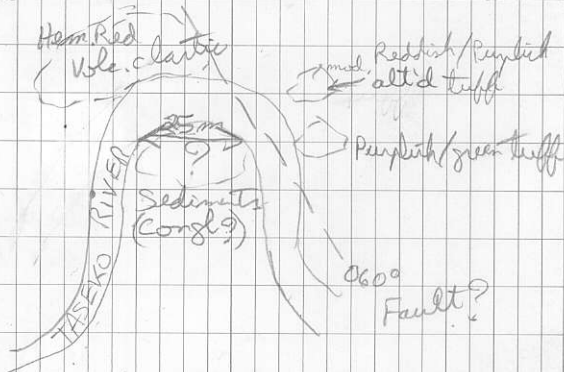

R. D. PENHALL LTD., MADE IN VANCOUVER, CANADA
DUKSBAR WATERPROOF

ALL STRUCT. TRUNCATED BY
POSS. FAULT 060°

PURPLISH
TUFFS

POSS CONTACT

VOLCANIC
CLASTICS

Bedding 030°

steeply dipping
070° E

T. RIVER

ACROSS CK. WE SEE

POSS. COARSE CONGL. / GREYWACKE W. SIMILAR
BEDDING TRENDS

KIN SOUTH GULLY

W ^{UPD} ^{IN MIX AND FLOW} CLASTIC 13204 (taken along the N

0450/060° NW
CONTACT

CARB. STKW
IN MIX AND FLOW

45° FLOW BANDING
040°

LITHIC
TUFF

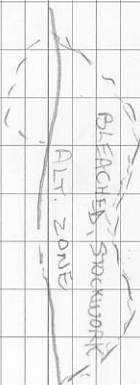

BLEACHED STOCKWORK

ALT. ZONE

DARK PURPLE GREEN
LITHIC TUFF

RED MARBON
VOLCANIC
CLASTIC

TASEKO

E RIVER

FIELD (S)

Aug. 23 / 89

HM SAMPLING / PROSPECTING

- 1) OTC of C.G. CONGLOMERATE
on S side of Cone Ch. \approx
L. ~~1800~~ N, 1725 E
1825

Open gully matrix w. rounded
mixed fragments

- 2) OTC: CONGLOM.

+ GRAB SAMPLE
of dark Fine-gr.
CONG? 2200E

OTC
CONGLOM.

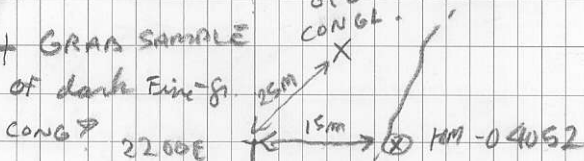

Possible Draw ?
at 5000 N / 4700 E

ROADSIDE OTC just outside
claim boundary (W);

GRITTY, OPEN CONGL.

Bedding? $325^{\circ} / 45^{\circ}$ SW (joint set)
* Bedding at 030°

* ROCK SAMPLE # 43202

TAKEN \approx L. 1600 N
2225 E

→ SUBOC OR BLDR ?

MX, dense, fine-gr'd, dark
greenish black, w. weakly
magnetic w. fine dir. glauy
shards; rough, convoluted surface