

860842

KAMLOOPS

N ASTRONOMIC

STAKED

TECK CORPORATION LTD

STAKED

MD-3

MD-2

MD-1 KNUT

COMINCO

ABERMIN

STAKED

COMINCO



OVERSTAKED AREA

KMS.



SCALE 1:50 000



SALOR SCIENTIFIC INC.

MD CLAIMS-KNUTSFORD, B.C.  
KAMLOOPS MD. 921/9W

CLAIM MAP

J.D.M.

88-12-30 PLATE NO. 6

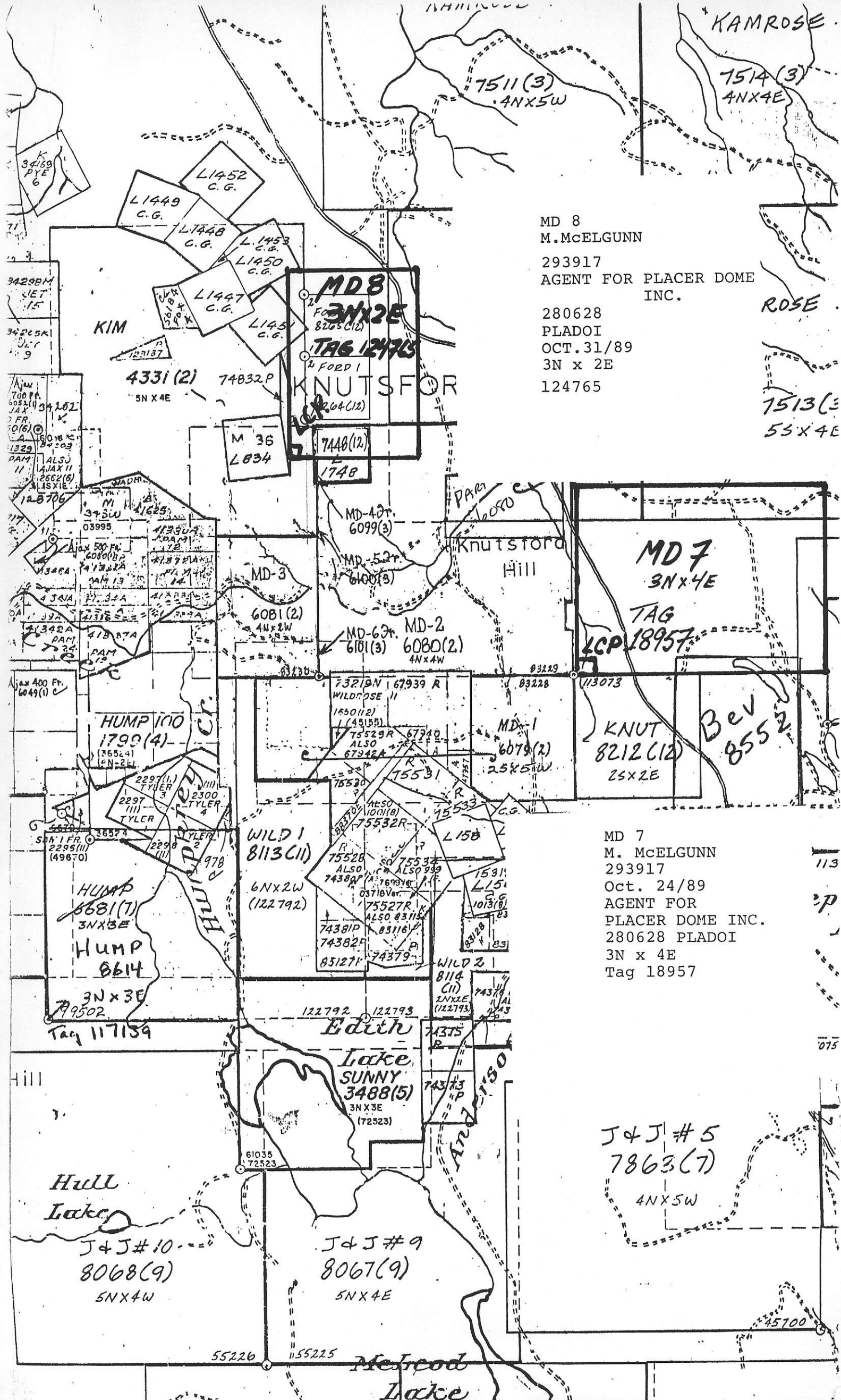

MD 8  
 M. McELGUNN  
 293917  
 AGENT FOR PLACER DOME  
 INC.

280628  
 PLADOI  
 OCT. 31/89  
 3N x 2E  
 124765

ROSE  
 7513(3)  
 55 X 4E

MD 7  
 3N X 4E  
 TAG  
 LCP 18957  
 KNUT  
 8212(12)  
 25 X 2E  
 Bev  
 8552

MD 7  
 M. McELGUNN  
 293917  
 Oct. 24/89  
 AGENT FOR  
 PLACER DOME INC.  
 280628 PLADOI  
 3N x 4E  
 Tag 18957

J & J # 5  
 7863(7)  
 4N X 5W

113  
 2P  
 075

KIM

KNUTSFOR

Knutstorg Hill

HUMP 100  
 1790(4)

WILD 1  
 8113(11)  
 6N X 2W  
 (122792)

HUMP  
 8681(7)  
 3N X 3E  
 Hump  
 8614  
 3N X 3E  
 Tag 117159

Edith  
 Lake  
 SUNNY  
 3488(5)  
 3N X 3E  
 (72523)

Hull  
 Lake

J & J # 10  
 8068(9)  
 5N X 4W

J & J # 9  
 8067(9)  
 5N X 4E

McLeod  
 Lake

RPI file.

PA

RPI file  
24680

# McPHAR GEOPHYSICS LIMITED

INDUCED POLARIZATION AND RESISTIVITY SURVEY  
PLAN MAP

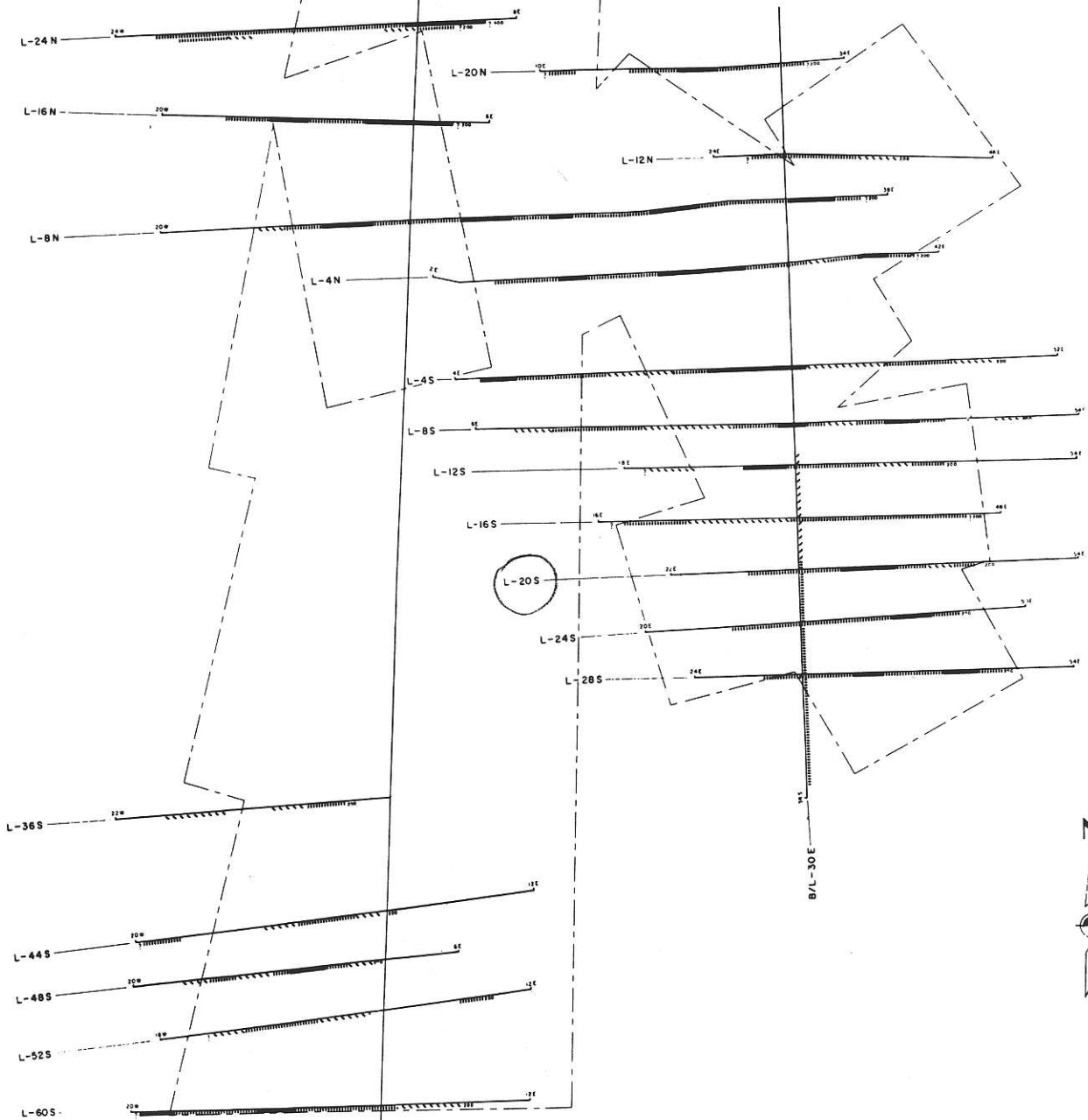

Surface projection  
of anomalous zones

- Definite
- Probable
- Possible

Number at the end of anomaly  
indicates spread used

## KIMBERLEY COPPER MINES LIMITED

KIMBERLEY PROPERTY, KAMLOOPS AREA, KAMLOOPS M.D. - B.C.

KIMBERLEY PROPERTY BOUNDARY

0 1/4 1/2 MILE