

- ROCK TYPES**
- X | Hypabyssal andesite : fine to coarse grained and porphyritic chlorite altered
 - U | Ultramafics chlorite-actinolite altered, fine to coarse grained, magnetite bearing
 - A | Diorite medium grained
 - Shear zone : orientation as indicated
 - Massive quartz
 - Quartz diorite dyke
 - Mafic dyke
 - Breccia : monomict, clast or matrix supported clast type according to other rock symbol
 - foliation
 - quartz vein (thickness)
 - gouge
 - carbonate vein (thickness)
- ALTERATION**
- C Clay alteration (includes sericite and unknown bleached zones)
 - S Silica alteration
 - L Chlorite / talc alteration
 - Cb Carbonate alteration
- MINERALIZATION**
- py pyrite
 - po pyrrhotite
 - cp chalcopyrite
 - aspy arsenopyrite
 - mr mariposite

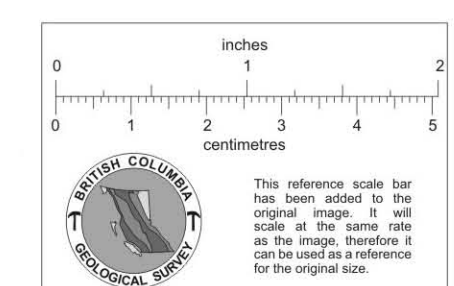
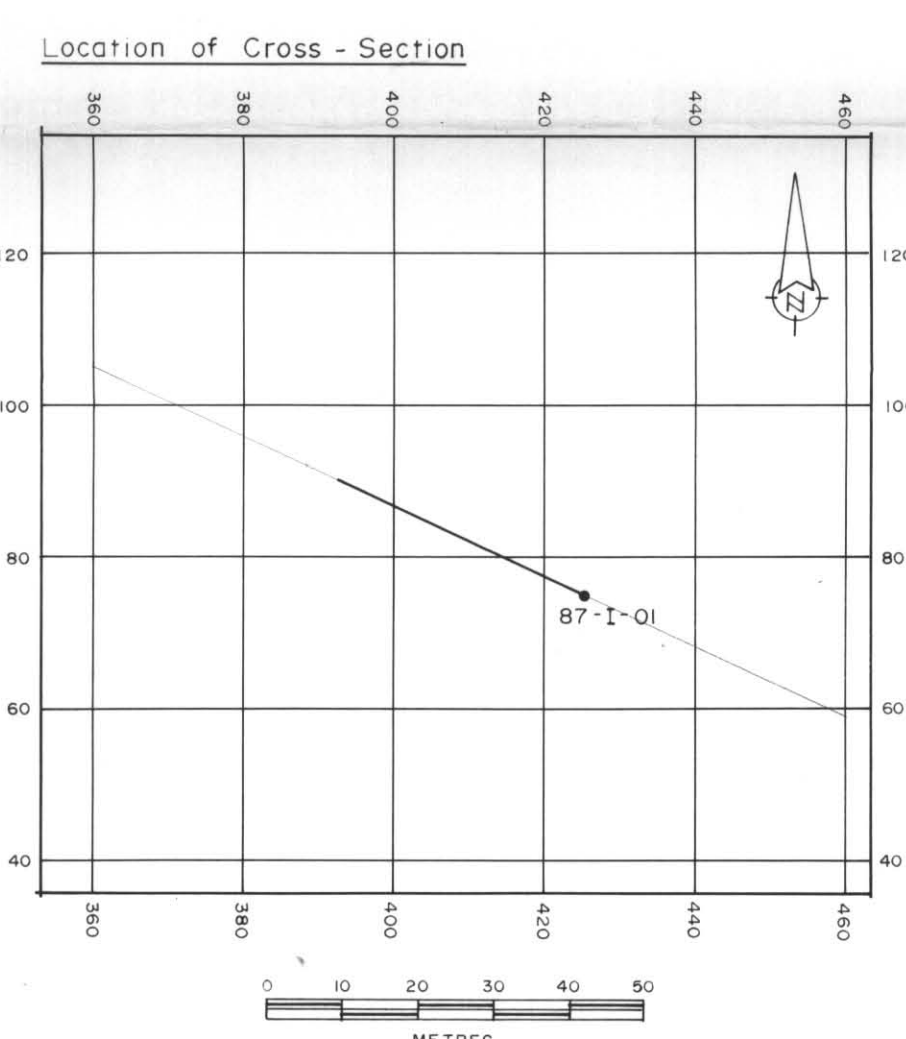

EASTFIELD RESOURCES LTD.
 INDATA PROJECT
 OMINECA M.D., B.C.

DIAMOND DRILL HOLE
87 - I - 01
 (-45°)

Scale 1 : 200
 Date Sept. 1988
 BY M.V.S. / M.C.-D.

Figure 93 N/6