

① 13 Aug 1988

NAT CLAIMS

860412

Loc. N 4850N 2060E
on main creek

Otc forming banks of
main creek for about 30m
along creek. Creek flowing
at 030° Az.

- Highly altered & sheared
intrusive rock of unknown
composition. Texture mg-cg.
- Strong Fe-carbonate and
talc alteration w/ wk-
pervasive silicification and
minor quartz veining (< 5-10cm)
- Dissem mg-cg specular
hematite.

The whole length of
the otc is same.

Shear 085 Az / $60-90$ SE
Sp. MG-NAT-1

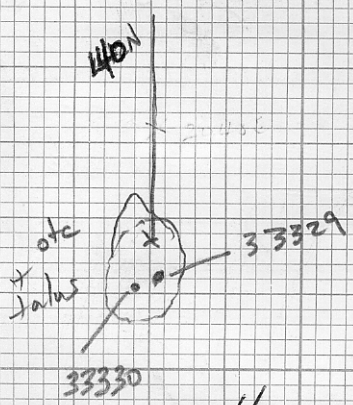
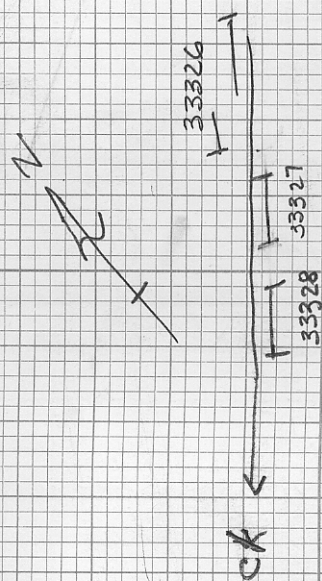

25 m
from end
line

med gr. dk green UM

(2)

3 chip samples taken as
per sketch # 33326

33327

33328

33331 400N 2140E

33332 400N 2240E

NAT

Aug 10

L3000N 2860E: RD
2520E: 0/2 OF
FE CARB ALT. INTR.
WITH OR MICROVENING

* MUST COME BACK!
AND SAMPLE

2580N 2500E: CREEK

0/0 DOWN STREAM

2225N 2500E: BIG CREEK

2000N 2500E: INITIAL
POST IS SW A7 030

NAT 1 - 495144 M

2200N 2940E: CREEK II

TO LINE

2600N 2920E: DRY CREEK
BED.

3600N 2700E: CREEK
@ 070N

2560N 2540E : 40L

0% OF FE CARB ALTERED
INTR WITH OF V'S & C'S

- 4600N 2860E creek

4800N 2660E - ARCL 0%

14 Aug 88

5600N 2560E : CREEK

→ 070

4780N 2680E : DK

GREY TO BLACK,
FISSILE TO FRIABLE
ARGL. ~~ALIGNED AS~~

ENVELOPES AROUND

OCCASIONAL 0.5-1.5 cm

CALCITE VEINS, SUB || TO BEDDING

BEDDING : 255 / 54° SE

SAMPLE: 33307

L48

CK

o/c LOM

33307

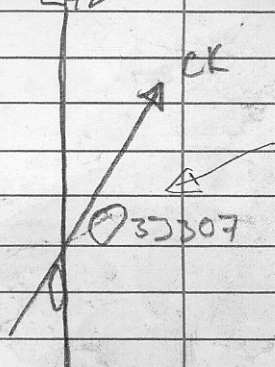

4820N 2630E: SAME
ARGL AS OVERLEAF.

CANYON VEINLETS ARE ALL $< 2m$
+ NOT SUB II TO
BEDDING.

BEDDING: $290/59^{\circ}SW$

SAMP: 33308

0/c IS 8m ALONG
CREEK ~~RED~~ CUT.

2580N 2500E

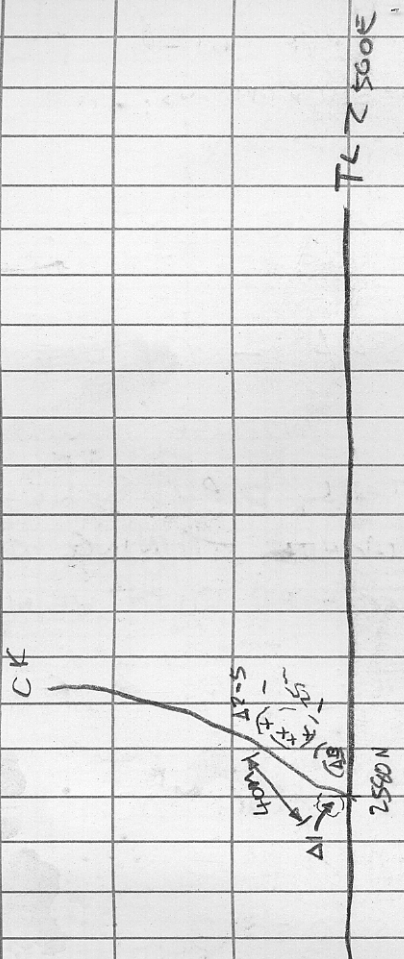

Δ1 Fe - CB ALTERED

INTRUSIVE WITH PYROMORPHIC
 QZ MICROVEINS. NO
 APPARENT SX'S

SAMP : 33309 2m chip
 SP-NAT-5

Δ2 SAA - QZ VEINING

MORE INTENSE, WITH
 VERTICAL DIP. SOME
 MALACHITE STAINING OCCURS,
 ASSOCIATED WITH VEINING

SAMP : 33310 2m chip.

Δ3 S₂ FROM Δ2

SAA, VERTICAL QZ
 VEINS 0.5 - 3cm
 SEEM TO PINCH OUT
 QUICKLY OVER 1m LENGTH

SAMP: 33311 2m chip.

VEINS STRIKE 160/90

EXTENSION GASH FILLINGS?

ORIGINAL ROCK TYPE

IS INDISTINGUISHABLE DUE
TO ALTERATION

(ALMOST LOOKS LIKE
LISTWAENITE!)

STRONG SILICIFICATION IS
ASSOCIATED WITH THE
VEINING.

ALL SAME SITE AS
D 784

SAA, QZ VEINING

SEEMS TO FOLLOW

CONJUGATE JOINT

SETS 100/80° SW

* 154/15° SW

SAMP: 33312 3m chip.

Δ5 (D 785)

8m ROUND FROM Δ4
SOS, QZ VEINING HAS
DECREASED TO THE
OCCASIONAL 1cm VEIN.
HOST ROCK APPEARS TO
BE MORE LIMONITE STAINED
- MORE FE-CB? ACT?

A SMALL SHEARED ZONE
4cm WIDE, HORIZONTAL
SHOWS SMALL, DEFORMED
QZ GASHES, 1m LONG ZONE

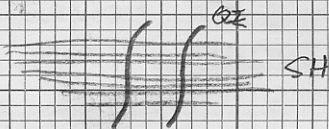

SAMP: 33313 3m CHIPS

430

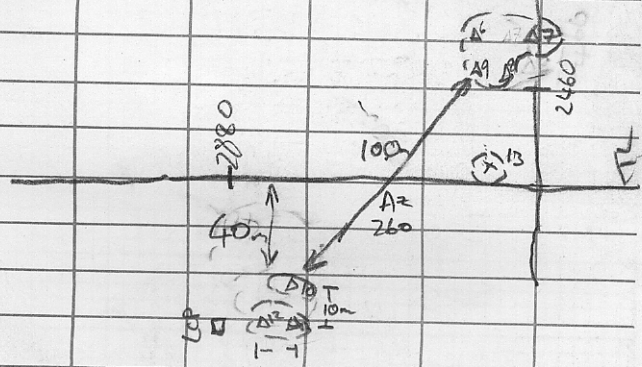

A5 FE-CB ALT. INTRUSIVE
AS IN CREEK, WITH
0.5 - 2cm QZ VEINS
160/90 ORIENTATION.

SAMP: 33314 3m CMP.

20m Az 140 FROM 300N
2380E

A7 30m Az 320 FROM
3000N 2360E.

SOS, FEWER QZ VEINS.

SAMP: 33315 3m CMP.

A8 10m Az 140 FROM
3000N 2440E

SOS, SAA.

SAMP: 33316 2m CMP

Δ9 10m Az 140 From
3000N 2460E
SAA, THOUGH MORE
QZ MICROVEINING.

SAMP: 33317 3m CHIP.

Δ10

SAA, QZ MICROVEINING
AS STRINGERS.

SAMP: 33318 2m CHIP.

Δ11

SAA, ONLY OCCASIONAL
QZ MICROVEINS.

3m FROM D787

ORIGINAL ROCK TYPE
HARD TO DETERMINE DUE
TO ALT, BUT SEEM
TO HAVE RELECT INTRUSIVE
TEXTURE

SAMP: 33319 3m CHIP.

A 12

SAA, WEATHERS IRREGULARLY,
 CB WEATHER OUT, LEAVING
 SILICIFIED RIDGES.

SAMP: 33320 Zn CHIP.

A 13

SMALL % 80_n

AZ 285 FROM A 11

SOS, HIGH DENSITY OF
 QZ VEINS 092/22° N

ONE 3cm VEIN CONTAINS
 LT GREEN NEEDLES (TØ?)

SAMP 33321 Zn CHIP.

CLAIM POST

NAT 5 496172 M

NAT. 6 496173 M

LOCATED: 59.0m AZ

230 FROM TL 2500E, 2880N