

RECEIVED
JUL 27 1988

PROPOSED DRILL HOLES

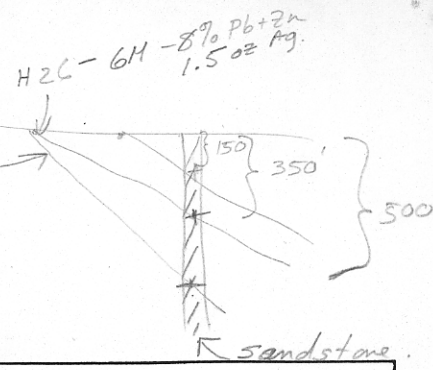

Ag zones cut off fast → 1-1.5oz in wall rock.
15M-20M O/B @ 45°

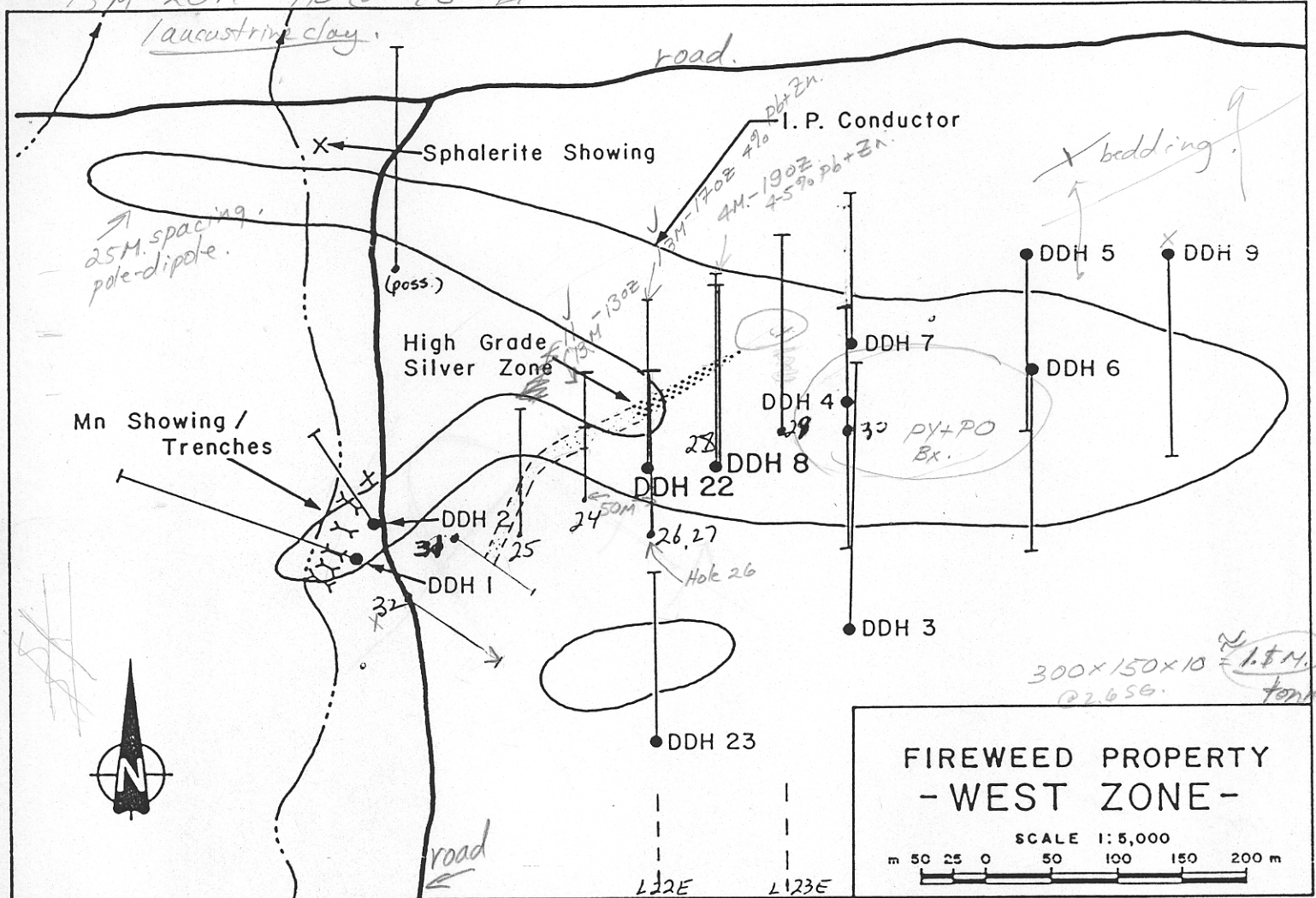

FIREWEED PROPERTY
- WEST ZONE -
SCALE 1:5,000
m 50 25 0 50 100 150 200 m

HOLE	LOCATION	DEPTH	ACTUAL	DIP	AZIMUTH	footage	Total
✓ 24	21+50E 0+75N	140 m	142 m	-45°	0°	466	466
✓ 25	21+00E 0+50N	150 m	107 m	-45°	0°	350	816
✓ 26	22+00E 0+45N	180 m	180 m	-45°	0°	590	1406
✓ 27	22+00E 0+45N	180 m	198 m	-60°	0°	650	2056
✓ 28	22+50E 1+00N	200 m	224 m	-60°	0°	735	2791
✓ 29	23+00E 1+25N	215 m		-45°	0°		
30	20+35E 0+80N	140 m		-45°	135°		
? (poss)	23+50E 1+50N	225 m		-45°	0°		
32	20+00E 0+50N	140 m		-45°	135°		
? (poss)	20+00E 2+50N	250 m		-45°	0°		
? (poss)	~19+50E 0+50S	140 m		-45°	135°		
? (poss)	24+00E 2+25N	140 m		-45°	0°		

860202