



Suite 525
890 West Pender Street
Vancouver, B.C. Canada
V6C 1J9
Telephone (604) 684-6463
Fax (604) 684-5392

Proposal for Cazador Explorations Hanson Lake Program, 1990

Following discussions with E. Kimura on 10th February 1990, this rough draft revision has been made for the 1990 field program on the Central Claims of the Hanson Lake Property of Cazador Explorations Ltd. This material has not been reviewed or approved by Cazador, but it is hoped that it may fit the common objectives of Cazador and PDI.

The program would require the production of an adequate base map to permit proper control in the field for all types of surveys and drill locations. Recent photography will permit inclusion of clear-cuts, roads and some of the earlier trenching on such a base map.

Completion of the first phase geochemistry and geophysics would be carried out in late May/ early June, in order to close off the anomalous areas identified to date and to give good focus to bedrock/subcrop testing to follow on after the results of this work have been reviewed in late July. The areas outlined in pink on the attached map would be given priority in this work.

Completion of geological mapping, supported by prospecting and rock sampling, would be undertaken concurrently with the geophysics and geochemistry surveys. Particular emphasis would be given to the anomalous areas already defined by the 1988-1989 work. An initial study of surficial geology would be made to establish probable transportation directions of the cover as an aid to interpreting the geochemical signatures.

Bedrock/subcrop testing would follow a review of the data generated in the early part of the summer. This may be accomplished by pitting and trenching with a backhoe or by shallow percussion drilling, or a combination of both. The cost for this, indicated in the estimates below, would be for a minimum amount of work.

Some flexibility to increase or decrease the amount of geochemical/geophysical/geological coverage could be applied to adjust the actual costs to meet budget limits with precision. The costs indicated below do not leave room for expansion of the programs to include a full-scale drilling program.

Rough Cost Estimate:

Base map - orthophoto	\$15,000*
Geochem/geophysics	⁵⁰ \$45,000*
Geology and prospecting	30 \$40,000
Bedrock/subcrop sampling	⁵⁰ \$25,000*
Report and data processing	\$ 8,000
Contingency (10%)	\$13,000
Total	\$145,000

(* not checked in detail)

10 February 1990.

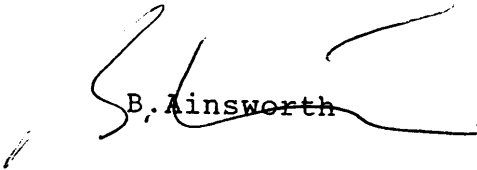
B. Ainsworth

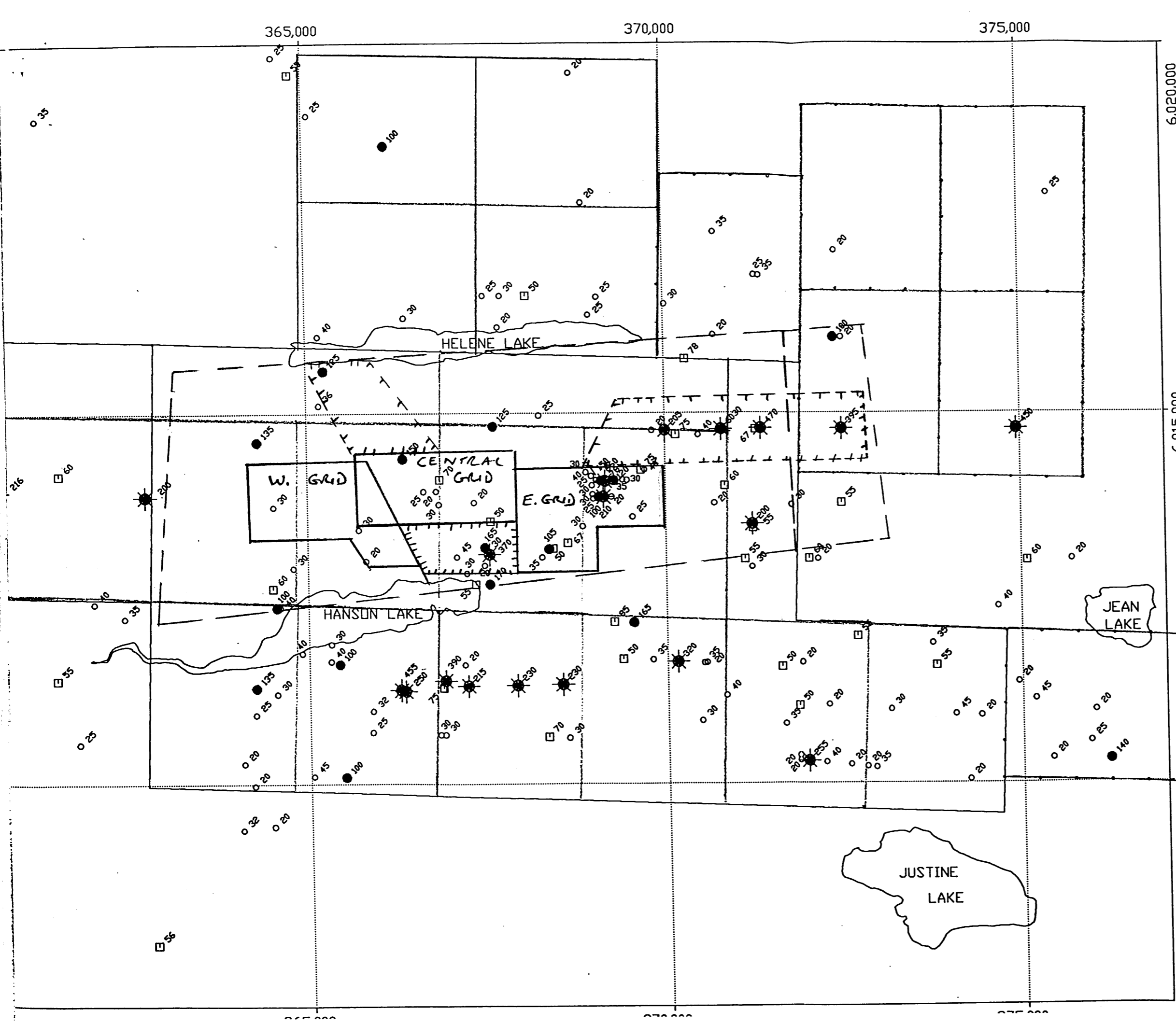

ENDAKO REGIONAL GEOCHEM

- AU 20 - 50 PPB
- AU 50 - 100 PPB
- AU 100 - 200 PPB
- ★ AU > 200 PPB

--- GEOLOGICAL MAPPING AREA
 + + + + GC/GP GRIDS (1990)

DATA PLOTTED ON THIS MAP:
 DIRECTORY: /PLACER1_2E/EXPLWORK/E

	FIELD	FILE
POINTS:	AU1	AU20PPB.LOCASS
POINTS:	AU1	AU20PPB.LOCASS
---	SEG	93K236.TOPD
---	SEG	CLAIM.CAZ

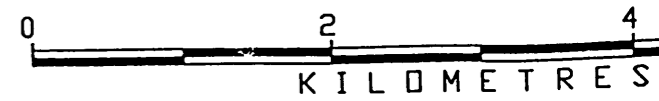
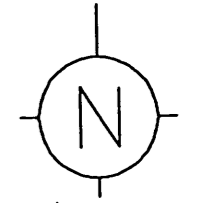

CAZADOR EXPLORATIONS LIM

HANSON LAKE PROPERTY

DRAWN	BJR
DATE	89/06/13
SCALE	1:50000

ENDAKO REGION