

Security

842781

§

Courte

Survey §

Geological

Notes

SEPT 1981

T. Oliver

M486

$$H = K_s + C$$

where  $C = 0$

$$H = K_s$$

where  $K_s = \text{Stadia  
interval}$

this  $K_s = 100 \quad H = 100$

where the angle is  
 $90^\circ$

So on an inclined  
plane

$$H = \cos K_s$$

Vertical components

October 13, 1981

security dsrlet

Surveying

$A_2 \approx N$  determined from  
compass decl  $26.5^\circ$

T. Oliver & D. Francis

T FS/06 <sup>FS</sup> Brng Rep't H1 <sup>±</sup> Yang diam

T-Diver # Francis Oct 19, 1981

S-81-1

640 ± 2.46'38" ~~15.5~~

S-81-2 ✓ 000° —

1711.7m

note S-81-1 to S-81-2 of determin-  
ed by compass Brng. N, 26.5° decl

S-81-1 to

64

S-81-3 ✓ 286° 15' 46" ↘ 65° 02' 00" -1° 45' 08" 62.4 ✓

S-81-3 <sup>S-81-4</sup>/<sub>S-81-2</sub> 310 59 57 1-261 58 03 89 89° 53' 05" 62.35 ✓  
11-212 56 42

S-81-4 ✓ <sup>S-81-5</sup>/<sub>S-81-3</sub> 149 02 03 149 02 35 .69 101° 18' 54" 61.75 ✓

S-81-5 ✓ <sup>S-81-6</sup>/<sub>S-81-4</sub> 210 38 50 .53 92° 40' 30" 60.32 ✓

S-81-6 ✓ <sup>S-81-7</sup>/<sub>S-81-5</sub> 174 10 30 .54 89° 16' 42" 73.5 ✓

Foggy, to foggy to survey

oct 14, 1981

Security Islet

a Sunny  
October

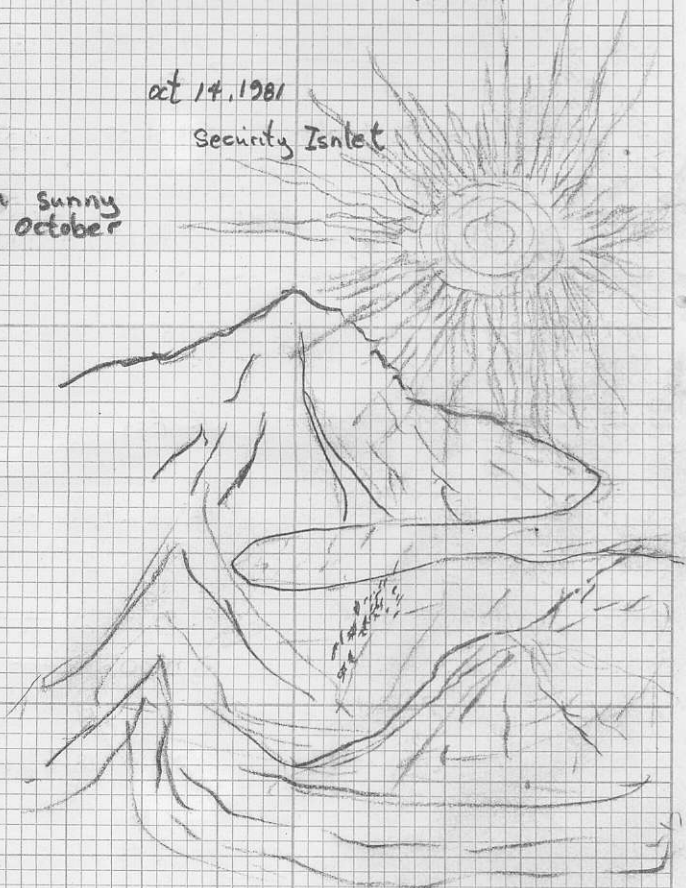

surveying from magnetic  $\delta$  N determined  
26.5° E

$\Delta$	Fs / bs	fs - brng	Fs Rpt. #	Vang	hi	Chas A
S-81-7	S-81-8 / S-81-6	223 24 50	—	92 43 35	.58	91.3
S-81-8 ✓	S-81-9 / S-81-7	130° 50' 10"	—	114° 26' 55"	.66	18.0
	Oct 15 <sup>th</sup> 1981					
S-81-9 ✓	S-81-10 / S-81-8	259 43 30	—	84 31 30	.64	69.3 ✓
S-81-10 ✓	S-81-11 / S-81-9	170 59 55	—	95 16 10	.56	60.9 ✓
S-81-11 ✓	S-81-12 / S-81-10	203 52 20	—	77° 18' 10"	.56	67.2 ✓
S-81-12 $\Delta$	S-81-10 / S-81-11	348 32 00	—	95° 00' 55"	.68	— ✓
S-81-12 ✓	S-81-13 / S-81-11	92° 28' 25"	—	167° 24' 10"	.68	110.5 ✓
S-81-13 $\Delta$	S-81-11 / S-81-12	31° 13' 40"	—	82° 35' 10"	.55	— ✓
S-81-13 $\Delta$	S-81-10 / S-81-12	41° 36' 40"	—	83 12' 00"	.65	— ✓
S-81-12 ✓	S-81-14 / S-81-11	235° 13' 50"	—	81° 29' 20"	.68	73.7 ✓
S-81-14 ✓	S-81-15 / S-81-12	204° 07' 40"	—	85° 12' 45"	.69	110.8 ✓
S-81-15 ✓	S-81-16 / S-81-14	160° 55' 55"	—	87° 18' 45"	.71	87.15 ✓
$\Delta$	S-81-12	350° 24' 50"	—	97° 01' 50"	.71	— ✓

		15/10/81				
T	Fs / Bs	ts-brng	vang	'HI'	Chain	
S-81-16 ✓	S-81-17/S-81-15	165° 22' 25"	88° 55' 20"	0.68	78.2 ✓	
S-81-17 ✓	S-81-2/S-81-16	288° 39' 20"	101° 50' 05"	0.68	84.0 ✓	
S-81-17 ✓	Δ S-81-3 / "	260° 48' 20"	97° 52' 10"	0.68		✓
*	S-81-2 to S-81-1	—————		111.7m		

Loop #1 completed  
15/10/81

note Δ = Triangulation point

8-17	to	16	333°
17	to	2	- 245°
16	to	15	347°
15-14	-		010°
14-12	-		338°
12-11	-		245°
11-10	-		216
10-9	-		230
9-8	-		150
8-7	-		200
7-6	-		157
<del>4-5</del>	-		310
4-3	-		163 ✓
3-2			-032° ✓



October 18, 1981  
Sunday

security Islet property

≈ Security ≈

Surveying of

#2 loop

$\pi$	Fs / bs	ang	ang	HI	Chainage
S-81-1	✓ S-81-17/S-81-2	33° 07' 20"	81° 30' 45"	0.52	—
S-81-1	✓ S-81-18/S-81-2	191° 57' 15"	44° 59' 55"	0.52	108.7
	Δ ✓ S-81-3	286° 16' 45"	91° 34' 25"	0.52	—
S-81-18	Δ ✓ S-81-17/S-81-1	12° 16' 30"	82° 53' 20"	0.49	—
S-81-18	✓ S-81-19/S-81-1	151° 10' 00"	91° 47' 00"	0.49	55.9
S-81-19	Δ ✓ S-81-17/S-81-18	34° 00' 00"	83° 41' 15"	0.47	—
S-81-19	✓ S-81-20/S-81-18	255° 44' 00"	91° 00' 40"	0.47	105.2
		<sup>255 43 25</sup>	<sup>91 00 30</sup>		
S-81-20	✓ S-81-21/S-81-2	188° 00' 22"	97° 29' 10"	0.62	59.6
S-81-20	✓ S-81-22/S-81-2	246° 27' 30"	90° 55' 10"	0.62	56.0
S-81-21		triangulation point on			
S-81-21	top of peak			0.66	
S-81-23	S-81-2	—	93° 00' 00"	0.56	—
S-81-23	Δ S-81-17/S-81-2	006° 57' 08"	90° 40' 55"	0.56	—
"	Δ S-81-1/S-81-2	009° 36' 47"	94° 41' 55"	0.56	—
"	Δ S-81-18/S-81-2	21° 12' 22"	98° 08' 25"	0.56	—
"	Δ S-81-4/S-81-2	352° 52' 59"	94° 28' 50"	0.56	—
"	Δ S-81-3/S-81-2	359° 56' 53"	95° 13' 18"	0.56	—
S-81-23	S-81-21/S-81-2	319° 39' 38"	88° 43' 10"	0.56	67.93

18/10/81

Compass bearing to station

S-81-1 to S-81-7 = 32°

" to S-81-18 = 191°

S-81-18 to S-81-19 = 156°

" 19 to " 20 = 230°

21 to 20 = 020°

23 to 2 = 030°

24 to 25 = 354°

25 to I = 053°



October 19, 1981

Security Inlet  
property

T. Oliver & D. Francis

$\pi$	Fs/Bs	FS A°	Vang°	H <sub>I</sub>	chain
S-81-26	S-81-24	—	79° 53' 48"	0.68	calc
S-81-26 A	S-81-25/S-81-24	333° 33' 38"	81° 05' 43"	0.68	calc
S-81-26	S-81-27/S-81-24	322° 20'	90° 30' 50"	0.68	81-85
station 00005-1000E @ 28.5 m					
S-81-26	000m	@ 310°	+24.2m		
o/c Qtz vein x 1.0m					
scarp like 160/70° NE					
Local drusy pods o/c on strike					
8.0m					
+7m @ 300° Qtz stockwork x 0.3m width					
md Qtz @ 147°/80 NE					
exposed x 4m					
+13m @ 150° Qtz stockwork x 1.0m md Qtz					
144°/78 NE strike length 6m					
S-81-27	S-81-28/S-81-26	155° 08' 40"	91° 08' 55"	0.63	63.0m
S-81-28	S-81-29/S-81-28	167° 07' 55"	97° 01' 10"	0.61	45.42
Δ	S-81-7	131° 35' 58"	91° 22' 33"	"	—
Δ	S-81-6	142° 07' 03"	91° 57' 55"	"	—

19/10/81



qtz  
vein,  
with SiO<sub>2</sub>

160/70 NE

S-81-26

147/80 NE

10m

144/78 NE

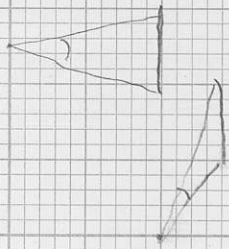

144  
180  
-----  
324

147  
+180  
-----  
227

$\bar{A}$	$F_s / B_s$	$f_s \text{ } ^\circ \text{ang}$	$V_{ang} \text{ } ^\circ$	HI	Chain
S-81-29	S-81-30/S-81-28	185° 35' 50"	102° 30' 12"	0.59	60.9
S-81-30	S-81-31/S-81-29	277° 16' 03"	80° 08' 08"	0.66	29.92
S-81-31	S-81-32/S-81-30	109° 43' 03"	81° 43' 10"	0.59	86.6
S-81-32	S-81-3/S-81-31	122° 03' 20"	86° 19' 45"	0.67	38.8

Loop #2 completed

19/10/81



Oct 20, 1981

Security donlet  
property

T. Oliver &  
D. Francis

Oct 20, 1981

Note HI = height above ground

T. Oliver &amp; D. Francis

stadia Rod in  $\frac{1}{10}$  of feet~~Sighting #~~ #0

C = 100

sta / bs hor ang V ang Stadia HI

Sighting #

# 1 / ✓ 5-81-1 / 5-81-2 200° 30' -10° 40' 0.43 62" 0

braided stock work x .3m

o/80E, drusy cavities + cub Qtz

exposure x 1.0m

md silicification

✓ to station 8E26s 275° 05' +120 15' 62"

#2 ✓ ditto 19° 40' ±000 1.2 62"

Splayed Qtz vein x .3m, drusy

@ 40/80 SE +005°/80E, md seq

exposure x 3m on strike

#3 ✓ ditto 348° 10' +140 1.18 62"

Qtz stringer, v. 10m width md Qtz

@ 090°/80 SE, exposure x 3.0m

poor exposure

5.16



10 m

#1 1/10

#2  
10/20 SE

#3

sighting	sta / lbs	Hor ang	Vert ang	stadia	HT
#4	✓ S81-3/S81-2	88° 30'	-5° 50'	(88) .88	

Qtz vein  $\frac{1}{2}$  braided, flood Qtz md 5.0'  
 x .3m width  
 040 / ?? 80 SE,

2nd exposure, braided Qtz vein, breccia, md Qtz  
 000 / x2m hinge to 25°/?

of 1.0 m width exposure x 3 m  
 5 → ditto 38° 20' -420 1.08 5.0'

#5 ✓ Qtz stringer, braided, wk Qtz  
 exposure x .2m x .2m  
 @ 349° / dip steep

to ✓ station SE 255 From S-81-4  
 3m @ 254°

to ✓ station SE 29+50 S from S-81-5  
 5m @ 131°

#6 S81-6/S81-5 02° 40' +000° 1.76<sup>st/65</sup> . 62"  
 Qtz Bz x md → strong NPd  
 exposure x 1x1m  
 locally drusy, flooded

#7 ✓ ditto 7° 50' -3° 10' 1.35<sup>width</sup> 62"  
 Qtz braided stockwork x 1.0m (on strike)  
 x 2.5m md Qtz  
 Local drusy cavities 348/80 E

METRIC  
 FIELD (S)

F. D. PERHALL LTD. MADE IN VANCOUVER CANADA  
 DUKSBAR WATERPROOF



Sighting	sta/bs	hor $A^\circ$	Vang	Stadia	HI
#8	ditto	$8^\circ 05'$	$-2.30'$	53.72 1.73	1.60 62"
Qtz stockwork x 1m exposure, on strike x 3m width					
drusy, euh Qtz terminations, local vein Bx moderate S.O <sub>2</sub>					
005/80 E					
#9	ditto	$13^\circ 30'$	-2.15	<sup>60.55</sup> 1.95	62"
#9 braided Qtz stockwork x 50/m					
wk to md S.O <sub>2</sub> local Vn Bx					
@ 10/vertical					
#10	ditto	12.0	$-2.10^\circ$	2.60	62"
Qtz Stockwork + Breccia md Qtz					
Zone 5m x 3m					
@ (stockwork) $315^\circ/75$ SW, + drusy cav					
Breccia (xct @ $335^\circ$ & $275^\circ$ ) stockwork					
note zone (Bx + SW) @ $160^\circ$ for 20m scattered o/c					
#11	ditto	$339^\circ 50'$	$-0^\circ 40'$	1.07	62"
@ #11 sample S-5m-211					
Qtz stockwork + Bx x 2.5 x 1m					
md $\rightarrow$ st Qtz $05^\circ/65$ E					
note minor Pyrite!					
#12	ditto	$304^\circ 20'$	$+4^\circ 40'$	0.76	62"
Poor exposure Qtz Vn SW + Bx x 1.5m-03					
@ md $\rightarrow$ st Qtz $215^\circ/90??$					

R. D. PENHALL LTD. MADE IN VANCOUVER, CANADA  
DURABLE WATERPROOF

METRIC  
FIELD (S)

# 15

← 16



10

# 17

# 18

# 19

BE 245

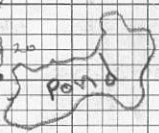

Sighting	Sta / bs	Hor A°	Vang	Stadia	HI
----------	----------	--------	------	--------	----

#13 ✓	5816/5815	303° 30'	+11.10	1.07	62"
-------	-----------	----------	--------	------	-----

Small Qtz stringer x.5m drusy

wk Qtz

318/Vertical

#14 ✓	ditto	259° 40'	+9° 50'	0.92	62"
-------	-------	----------	---------	------	-----

Lge Qtz Vn + Bz & Sw (braided) strong Qtz  
(Qtz flooding)

12x4m @

316/80 (255°)

Locally drusy

15+16 ✓	ditto	232° 40'	+4° 40'	1.20	62"
---------	-------	----------	---------	------	-----

#15 Lge Qtz braided Stockwork + bz <sup>st</sup> flood

Shearing @ 344° & Vn orientation

zone 7x5m

Large Qtz stockworks @

#17 ✓	ditto	215° 10'	+4.40	1.70	62"
-------	-------	----------	-------	------	-----

Small Qtz Stockwork + Vn Bz md → st

exp 1m . 3m

local drusy cavities

352/85 W to vertical

#18 ✓	ditto	204° 00'	-1° 10'	1.20	62"
-------	-------	----------	---------	------	-----

#19 Small Pod Qtz bz, st

1.1m

#19	ditto	174° 10'	-5° 40'	0.44	62"
-----	-------	----------	---------	------	-----

#20 small braided stringer zone wk Qtz

1x0.2m

194°/Vertical



78 500 11 10

$$\begin{array}{r} 250 \\ - 180 \\ \hline 70 \end{array}$$

sighting	sta / bs	Hor Ang	Vert Ang	stadia	HT
#20 ✓	5-816/5-815	30° 20'	-15° 40'	0.62	62"
@ 20 sample 5m-210 Qtz bx Znc, st - flood @ 000/85 E?? 4.0.5 m					
BE 245 ✓	ditto	37° 30'	-9° 10'	0.96	62"
#21 ✓	5-817/5-816	73° 05'	-4° 40'	4.0	57"
from end of outcrop to #21 @ 074°, 15m width R-2m L-2m orientation 55/75 SSE <del>3.66 57</del> Qtz Bx & stockwork, st Qtz, flooded & Vein Breccia					
#21 ✓	"	"	"	"	"
3m R, 2m L orientation 45/80 - (to Vertical) Braided Qtz SW. + bx & stringers st Qtz, flooded					
#22 ✓	ditto	72° 40'	-4° 50'	3.66	57"
orientation 045° / 2m L 0m R Qtz stockwork + bx flood Sbx ditto as #21					
#23 ✓	ditto	72° 10'	-5° 05'	3.36	57"
4m R 3m L orientation, preferred 025° / 75 NW ditto description					

R. D. PENHALL LTD., MADE IN CANADA  
 DUNSBRAK MANUFACTURING CO.



10m

# 30

11°
11°
11°
11°
11°

Trench

#21

sighting	Sta/bs	Hor Ang	V Ang	Stadia	HT
#24 ✓	07/06	71°30'	-5°20'	3.33	57"
scattered o/c					
2m L 5m R					
Preferred orientation on stockworks					
060°					
ditto description					
#25 ✓	"	70°30'	-6°40'	2.82	57"
2m L 1m R					
fracture or shear zones??					
@ 102°					
strong Qtz flood + Bx & Braided stockwork					
045/70 NW					
#26 ✓	"	88°20'	-7.0°	1.11	57"
3m L, 2m R					
to Right stockwork bse					
to left strong Qtz flood @ 030/80 RSE (120°)					
Veins in this sect 1.2m wide					
stockwork, preferred orientation					
170°					
#27 ✓	"	100°30'	-5°05'	0.91	57"
2m L, 3m R					
left strong veining & Qtz flood					
024°					
R- stockwork Bx zone, strong					

Sighting	Sta/bx	Hor A°	Vert Vang°	stadia	HI
#28 ✓	S81-7/81-6	113°20'	-5°40'	.76	57"
R-O (no dc) R 3.0m					
Strong Qtz, bx flood (R), & stockwork orientation 175°					
#29 ✓	ditto	143°00'	-3°40'	.70	57"
L-O (no dc) R 2m					
Strong Qtz Bx + stockwork numerous engulfed CB fy orientation 042°					
stringers @ 020/70 & 045/90					
#30 ✓	ditto	176°50'	-2°30'	0.71	57"
L-O R 3m					
strong Qtz Bx & stockwork (canastamisting) Qtz flood, strong stockwork orientation @ 140°, 015° & zone @ 025°					
#31 ✓	ditto	196°40'	-0°30'	0.95	57"
2m R Qtz stockwork & Flooded Bx zone @ 020°					
#32 ✓	ditto	205°20'	-1°10'	1.19	57"
Trench, R 2m, 3.5m wide					
note R					
#33 ✓	ditto	213°00'	-2°40'	1.49	57"
Qtz Bx zone x 2m R md → st zone orientation 035°					

R. D. PENHALL LTD. MADE IN VANCOUVER, CANADA  
DURABLE WATERPROOF

METRIC FIELD (S)

Sighting sta/b5 Hor A° Vang° stadia HI

#34 ✓ 5-81.7/81.6 217°10' -2°30' 1.83 57"

1m L, 1m R

st Qtz SW + Bx

orientation @ 360°/80 E

strongest zone →

#35 ✓ ditto 219°00' -2°00' 2.15 57"

oml 1.5m R

st Qtz SW + In Bx

orientation @ 030/90

#36 ✓ ditto 220°40' -2°10' 2.34 57"

st Qtz stack work + Bx, strong flooding

1m R 2.5m L

orientation @ 015/80 E (strongest zone)

#37 ✓ ditto 232°20' +1°30' 2.83 57"

splay zone x ~~1.6m~~ @ 163/

1.6m

Qtz strungers + flooding, strong

steep dip

20/10/81

EOD

(end of day)

Oct 22, 1981

Security don't let  
property

T. Oliver & D. Francis

Sighting #	Sta./bs	Hor Ang	Vert Ang	Stadia	HI
------------	---------	---------	----------	--------	----

# 38 ✓	S-81-9/81-B	323° 50'	+27°	.78'	54"
--------	-------------	----------	------	------	-----

Qtz vein, x 2.0m · 0.2m o/c

Strong zone o/c @ 008/80-85 E

poor exposure

# 39 - ✓	ditto	279° 30'	+12° 40'	1.12	54"
----------	-------	----------	----------	------	-----

Small Qtz vein o/c, md Qtz

0.5 x 0.2m @ 170/80 E

# 40 ✓	ditto	244° 40'	-1° 50'	1.56	54"
--------	-------	----------	---------	------	-----

Qtz-bx zone strong flooding,

small o/c, 3x.3m N Pd, on strike

with main structure.

# 41 ✓	ditto	246° 50'	-1° 50'	1.43	54"
--------	-------	----------	---------	------	-----

braided Qtz SW + bx zone st Qtz fl  
stockwork @ 005/90? (near vertical

2.0m · 1.0m

# 42 ✓	ditto	251° 20'	000°	1.16	54"
--------	-------	----------	------	------	-----

Qtz fl + bx zone st Qtz  
~~on strike~~ part of main structure,

fault scarp, @ 30/85 SB 4x1.5m



Sighting	sta/bn	Hbr Ang°	Vang°	studen	HJ
#43 ✓	81-7/81-B	259°30'	+1.30'	1.06	54"
braided Qtz sw + anastomosing Qtz stringers					
Splay zone? md + st Qtz 2.1m					
© 15°/80° parall to main zone					
#44 ✓	ditto	255°50'	000°	0.96	54"
Qtz sw + st Qtz fl o/c 3 = 1.5m					
local Qtz bz, main structure © 35/85 SE					
#45 ✓	ditto	267°50'	+2.40'	0.83	54"
Qtz sw + md Qtz 1.1m splay zone					
© 10°/steep 80-90°					
#46 ✓	ditto	270°20'	+3.30'	0.54	54"
Qtz sw + fl - st <sup>B*</sup> scarp like to west					
strongest zone R-1.0m / 1.0m o/c 6m on					
strike © 28°/steep, 80-90°WNW					
#47 ✓	ditto	306°40'	+23°20'	0.40	54"
Qtz - vns, <sup>st+fl</sup> scarp like, poor exposure					
4.2m © 30°/90					

Sighting	sta/bs	Hor $A^\circ$	vang $^\circ$	stadia	HI
----------	--------	---------------	---------------	--------	----

# 48	✓ 81-9/81-8	31° 50'	+1540'	.70	54"
------	-------------	---------	--------	-----	-----

R. 1.5m h 2.0m on strike 9m

st. Qtz fl local drusy pads & Qtz Bx

strongest zone @ 30 / steep 80-90 p 20 / 85 NNE

az 81-9 to 81-10 Bs-81-8

H = 259 42 12 /  $\sqrt{\phantom{x}} = 81^\circ 21' 20''$

S-81-10 / Bs S-81-9 to TSP #1

HI =                      Hor  $^\circ$  =                      vang  $^\circ$  =

stadia =

Security dsnet

T. Orwen

Oct 24 / 81

T	Fs	Bs	Hor A°	V Ang	H/T
S-81-2 ✓	S-81-23	S-81-1	32° 38' 15	87° 09' 58"	0.85
" ✓	S-81-24	S-81-1	38 55 02	86 31 22	0.85
" ✓	S-81-25	S-81-1	48 08 55	87 32 23	0.85
S-81-1 ✓	S-81-23	S-81-2	222 14 57	85 29 05	0.75
" ✓	S-81-24	S-81-2	231 31 34	84 34 07	0.75
" ✓	S-81-25	S-81-2	245 56 28	85 41 15	0.75
S-81-17 ✓	S-81-23	S-81-2	318 15 50	89 20 40	0.73
" ✓	S-81-24	S-81-2	324 54 10	89 01 46	0.73
" ✓	S-81-25	S-81-2	333 38 00	90 18 20	0.73

Security

Oct 25, 1981

T. Oliver

sighting sta/b's Hor<sup>o</sup> Vert<sup>o</sup> stadia HI

TSP<sup>th</sup> 5-81-10/81-9

(written later)

there is rain and snow  
and wind, my fingers are frozen  
it's too cold to do anything out  
here!

I sense a change in the  
weather, heavy fog & rain for  
two days, I sense that  
it is time to vacate our  
hilly mountain home

T	FS	BS	Hor Ang Vang
5-81-3	5-81-32	5-81-2	175 23' 40" - 5 34 50

Courte D.D.H

Survey

# 1 34

Oct 27, 1981

T. Oliver  
D. Francis

sta/bs	FS	Hor A°	Vert	stadia	HI	
—	Decl	26.5°	E	—	—	
SC-81-1/SC-81-2	✓ SC-81-2	090° Mag	87 21 40	1.68	30.5"	
SC-81-4/SC-81-2	✓ SC-81-2	21E 10S	334 10 20	$\frac{72 \ 10 \ 20}{-2 \ 10 \ 20}$	1.048	30.5"
SC-81-1/SC-81-2	✓ SC-81-2	DDH #1	267 36 04	77 03 04	1.43	30.5"
* SC-81-1/SC-81-2	✓ SC-81-3	267° 02' 20"	72 14 52	<del>5.80</del>	30.5"	
SC-81-3/SC-81-1	✓ SC-81-4	216° 14' 15"	93 10 55	0.54	21.5"	
SC-81-4/SC-81-3	✓ SC-81-5	187 42 17	113 54 15	0.83	31.0"	
SC-81-5/SC-81-4	✓ SC-81-6	78 26 34	77 44 56	2.07	24"	
<p>△ SC-81-5 in ck canyon ck to bs 5 m canyon 7m wide</p> <p><u>Base d</u></p>						
SC-81-6/SC-81-5	✓ SC-81-7	252 10	79 37 00	1.27	20.5"	
<p>@ SC-81-6 ck 5 m E</p>						
SC-81-7/SC-81-6	✓ SC-81-8	166 07 35	59 05 55	4.76	31.0"	
<p>• note course sb showing app 6m @ 330°</p> <p>note to collar DDH #4 3m @ 350°</p>						



238  
2  
476

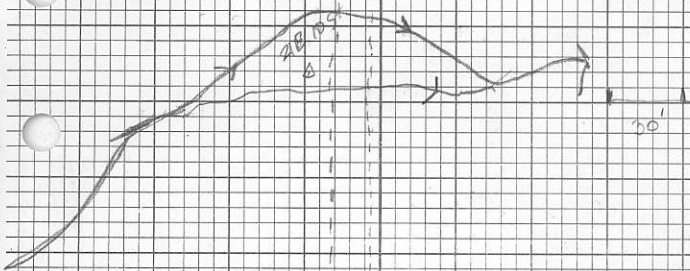
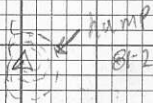

~~8-1~~

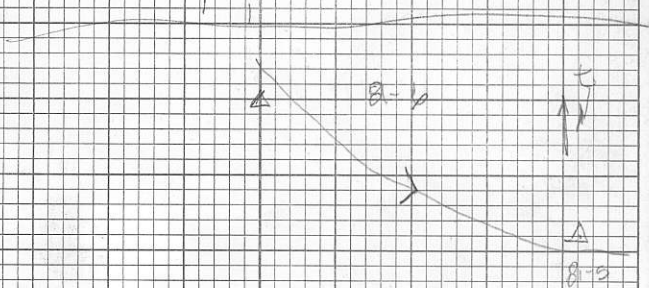
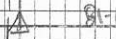

	By	Compass
a)	7 → 8	008°
	7 → 6	185°
	6-5-	126°
	3-4-	023
	4-5-	045
	3-1-	185°

DDH 4 (course)

Remember to subtract 2m from

el S-C-BI-8 → el DDH<sup>#</sup>4

27/10/81

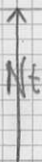

is there any Au here

10m

course  
Sb showing

Sb

Sb



S-81-7

Volcanic Rocks (strongly altered)  
qw Quartz stringers  
containing stibnite



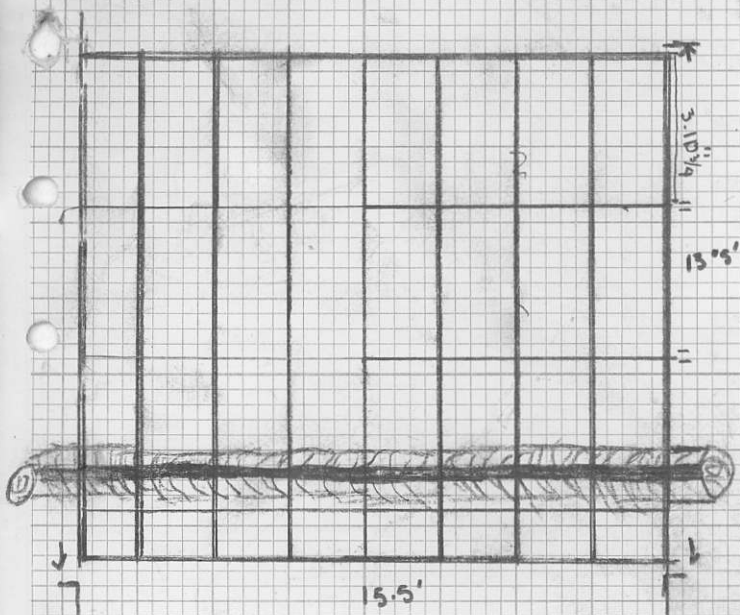

$$2 \times 4 = 16.0' (2)$$

$$2 \times 4 = 15'5" (2)$$

$$2 \times 4 = 13'1" (4)$$

4.8 sheets 1/2" plywood  
(8)