

SARAH

July 12 / 81  
SJM

M491

842729

6613

July 12  
15. 11+11  
DH NB-SM

1) 66N 55E

med-dk br sandy  
alt 5020 silt  
Some rust

2) 55+ 50E

med br silt sandy  
Some rust  
alt 5020

3) 56E

light-med br  
silt sandy  
alt 5020

4) 56+ 50E

light-med br  
15% clay  
silt

020°

JULY 12

17 MPA

SIN DH MB

N

1) 55E

2) 55+50 E

3) 56E

ROAD N 28° E

4) 56+50

5) 57E

ROAD N 44° E

6) 57+50E

58E

58+50

59

59+50

60E

60+50E

60

1000 (road)  
30°  
5/12

5) 57E

alt 4940

med br silt sandy

6) 57+50E

alt 4920

Road at 57+40E  
N° 44° E

7) 58E

alt 4950

light med br  
silt, clay 10%

8) 58+50E

alt 4930

med br silt sandy

9) 59E

alt 4880

med br silt  
sandy

59 + 50E  
10) 4840 - alt

med-dk br  
silt sandy

July 12  
1R MFA  
SSM DH  
MB

11) 60E

4780 alt

med br  
silt sandy

12) 60 + 50E

alt dk br silt

4720

pebbly

4750 road loop

300 ft

13) 61E

alt 4740

med br silt sandy  
10% clay

14) 61 + 50E

alt 4680

light med br

silt 15% clay

15) 62E  
alt 4640

med br  
Silty sandy

16) 62 + 50E  
alt 4560

med br  
Silty sandy

62 + 90E rd.

17) 63E  
alt 4510

med-dk br  
Very silty  
Sandy

July 1942  
W. H. H.  
5770  
1942

• 61E

• 61+50E

• 62E

• 62+50E

~~ROAD 176~~ ↓ 62+90

• 63E

July 13

DM

113



July 13  
Iron Mtn.  
DH. T. B. S. M.

BN 55-63E

- 1) 55E light med br slight  
alt 5000 silt sandy rust
- 2) 55+50E light br cldy 20%  
alt 5025 silt sandy
- 3) 56E light br clay 35%  
alt 4980 silt sandy
- 4) 56+50E med br clay 20%  
56+40 road silt sandy  
310  
alt 4960
- 5) 57E med-dk br  
silt sandy  
alt 4970  
road 57+35E  
N 38%
- 6) 57+50E light-  
alt 4940 med br  
slight orange  
silt
- 7) 58E med br orange  
alt 4930 silt sandy
- 8) 58+50E med-dk br  
alt 4865 silt sandy
- 9) 59E med-dk br  
alt 4840 silt sandy

R. D. PENHALL LTD. MADE IN VANCOUVER, CANADA  
DURABLE WATERPROOF

67N

July 13  
1877  
S. H. D. H.  
188

55E

55+50E

56E

56+49 ~~ROAD~~ N 31° E  
56+50E

57E

~~ROAD~~ 57+50E

57+50E

58E

58+50

59E

59+50E

60E

60+50E

61E

61+50E

62E

62+50E

63E

- 10) 59+50E <sup>light</sup> med br  
alt 4820 clay 30%  
silt sandy
- 11) 60E  
alt 4815 light br  
clay 30%  
pebbles
- 12) 60+50E med br - orange  
alt 4790 clay 20%
- 13) 61E  
alt 4680 med br  
silt, sandy  
10% clay
- 14) 61+50E  
alt 4640 med br  
silt  
pebbles  
clay 10%
- 15) 62E  
alt 4600 med br - orange tint  
silt, sandy
- 16) 62+50E light br  
alt 4560 heavy clay  
silt 50%
- 17) 63E stony clay  
alt 4540 dk red-br

R. D. PENHALL LTD. MADE IN VANCOUVER, CANADA  
DUNSBANK WATERPROOF

July 13  
16 min  
5311 OH NB

68N - 63-5E



57+5E ←

~~ROAD~~ 80°



- 1) 63E med-dk br  
alt. 4500 clay 10%  
silt sandy
- 2) 62+50E light med br pebbles  
alt. 4540 10% clay  
silt sandy
- 3) 62E med br  
alt. 4580 pebbles  
silt sandy
- 4) 61+50E med-dk br  
alt. 4585 silt sandy
- 5) 61E med br  
alt. 4620 silt sandy
- 6) 60+50E light-med  
alt. 4740 or silt  
10% clay
- 7) 60E med br  
alt. 4810 clay 20%  
silt sandy
- 8) 59+50E light-med silt  
alt. 4820 or 20% clay
- 9) 57E med br  
alt. 4840 silt

R.D. PENNALL LTD. MADE IN VANCOUVER, CANADA  
DUNSBARK WATERPROOF

July 17  
1944  
Sun. 11  
1944

10) 58+50E med br  
alt 4780 silt sandy  
15% clay

11) 58E light med  
alt - 4800 br  
road at 57+75E Clay 30%  
N 80° E

12) 57+50E light br  
alt 4800 clay 40%  
silt sandy

13) 57E light-med  
alt 4840 br clay 40%  
pebbly

14) 56+50E  
alt 4800 med br  
silty sandy

15) 56E light br  
alt 4825 silty sandy  
clay 40%

16) 55+50E alt 4840  
silt, clay med br - orange  
30%

17) 55E med br clay 15%  
alt 4920 silt

R. D. PENHALL LTD. MADE IN VANCOUVER, CANADA  
DUCKBAK WATERPROOF

METRIC  
FIELD(S)

65N-55E →

JULY 13  
1944

1) 55+50 E  
4980 a/t

med br clay 20%  
silt sandy

2) 56E  
a/t 4940

light-med br  
clay 30%  
pebbles

3) 56+50E  
4880

light br  
clay 20%  
silt

4) 57E  
a/t 4820

light-med br  
silt sandy

5) 57+50E  
a/t 4815

med br  
silt sandy

(see Derek Hodge notes)





July 14/87  
R. Mtn

45N

SIM

- 1) 50+50E alt 5160 light-med br clay 20%  
silt sandy
- 2) 50E alt 5155 49+60E Road 60° med br silt sandy
- 3) 49+50E alt 5220 light-med br clay 10%  
silt sandy
- 4) 49E alt 5260 med br clay 10%  
silt
- 5) 48+50E alt 5300 light-med br orange tint  
clay 15%  
silt sandy
- 6) 48E 5280 heavy clay 50%  
light br-blue  
silt
- 7) 47+50E alt 5300 med or-br  
silt sandy
- 8) 47E alt 5260 light-med  
br-orange  
fint  
silt sandy

R. D. PENHALL LTD. MADE IN VANCOUVER, CANADA  
DURABLE WATERPROOF

50+50E

50E

49+50

~~48+50~~  
- 49

48+50

48

47+50

47E

46+50

46E

45+50

45E

44+50

44E

43+50

43E

9) 46+50E  
alt 5240  
med gray-br  
heavy clay 50%  
silty sandy

10) 46E med br  
alt 5245 clay 15%  
pebbles

11) 45+50E med br-or  
alt 5260 clay 10%  
silt

12) 45E light-med  
alt 5275 br  
silt clay 15%

13) 44+50E light med  
alt 5320 br-or  
clay 50%  
silt

14) 414E light-med br silt  
alt 5300 Clay 15%

15) 43450E light br-or  
alt 5280 clay 30%  
silt

16) 43E5 med br silt  
alt 5260 clay 10%  
orange tint

off 43E-45N  
by 24M North of 45N on  
43E ETL.

R. D. PENHALL LTD. MADE IN VANCOUVER, CANADA  
DURABLE WATERPROOF

July 14

5/5

40N-43-50E

July 1981  
11:15 AM  
55M

- 1) 43E med-br  
alt 5300 pebbles  
clay 10%
- 2) 43+50E light-med br  
alt 5320 silt, sandy
- 3) 44E med br  
alt 5340 clay 10%  
silt sandy
- 4) 44+50E light-med br  
alt 5320 silt sandy
- 5) 45E alt med br  
5280 silt clay 10%
- 6) 45+50 med br  
alt 5260 silt sandy
- 7) 46E 5240 med br - or clay 10%
- 8) 46+50E med br - orange  
alt 5260 silt clay 36%
- 9) 47E med br - or  
alt 5310 clay 20%  
silt
- 10) 47+50 light-med br  
alt 5300 pebbles clay 10%
- 11) 10 m away

FIERRA #3  
CLAIM 69093  
IN 2E  
JAN 29 81

R. D. PENHALL LTD. GREEN VANCOUVER CANADA  
DUNSBRIX WATERPROOF

11) 48E

med-dk br.

alt 5300

Silt 10% CI

12) 48+50

light-med br

5320

Silt Clay 15% CI

13) 49E

med br

alt 5280

Silty sandy

14) 49+50E

med-dk br

alt 5220

Silt sandy

15) 50E med-dk br.

alt 5140

Silt sandy

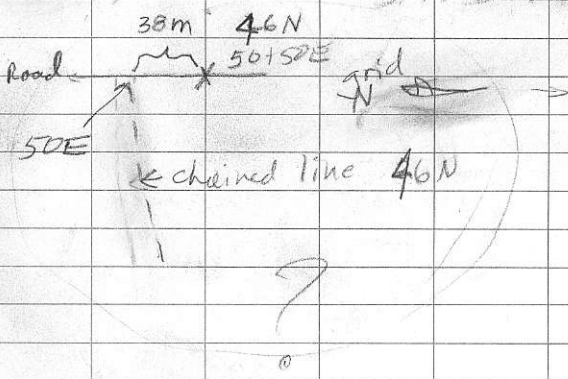

R. D. PENHALL LTD. MADE IN VANCOUVER, CANADA  
DUKSBAM WATERPROOF